



MARK XLII

1/1TH SCALE LIMITED EDITION COLLECTIBLE  
BLUETOOTH WIRELESS SPEAKER

EN. Quick Start Guide

CT. 快速進入門指南

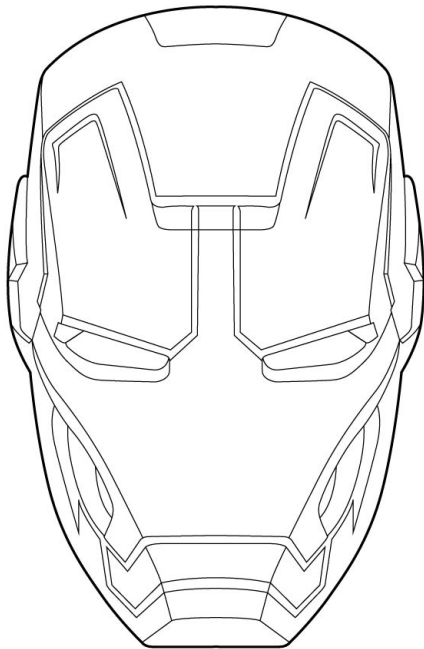

**CAMINO** Copyright ©2015 Camino International Limited. All Rights Reserved.  
Flat A, 3rd Floor, International Industrial Building,  
501-503 Castle Peak Road, Cheung Sha Wan, Kowloon, Hong Kong.

The CAMINO logo is a registered trademark of Camino International Limited.  
All brand names are registered trademarks are the property of their respective owners.

**www.caminousb.com**  
**Questions or Comments : usb@caminotoys.com**

In the interest of better quality and value, we are constantly improving and updating our products.  
Consequently, pictures on this package may sometimes vary from the product enclosed.  
Please keep this packaging since it contains important information.  
Please retain this address for future reference.  
Colors and decorations may vary. Each sold separately, subject to availability.

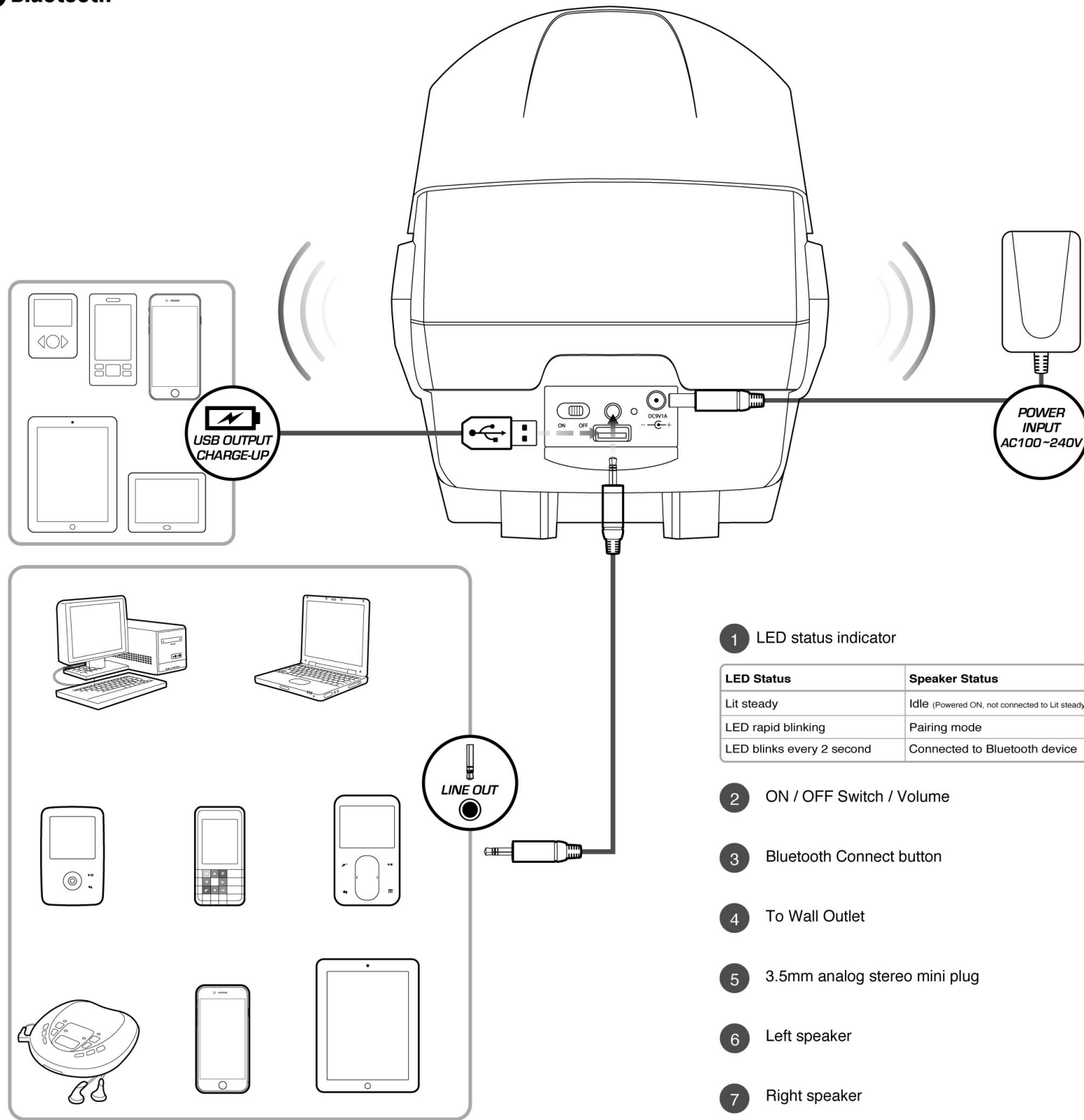

1 LED status indicator

LED Status	Speaker Status
Lit steady	Idle (Powered ON, not connected to Lit steady Bluetooth device)
LED rapid blinking	Pairing mode
LED blinks every 2 second	Connected to Bluetooth device

2 ON / OFF Switch / Volume

3 Bluetooth Connect button

4 To Wall Outlet

5 3.5mm analog stereo mini plug

6 Left speaker

7 Right speaker

## 2. Enjoy audio from Bluetooth devices

### a. Powering Up the speaker

Turn scroll wheel up to turn on speaker.  
The LED status indicator will lit steady indicating the speaker is currently ON.

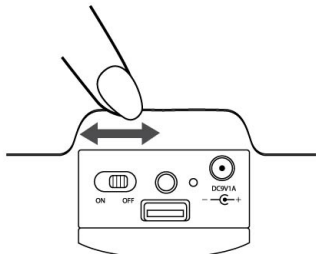

### b. Establish *Bluetooth* Connection

To allow pairing to other Bluetooth devices, Press and hold the Bluetooth button until 2 beep tones are heard and LED blinks rapidly.

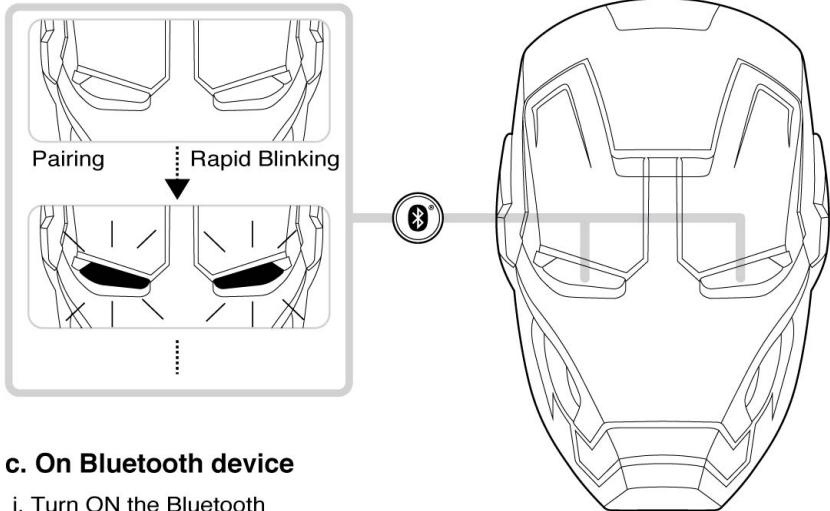

### c. On Bluetooth device

- Turn ON the Bluetooth
- Search for IRONMAN.
- Pair and connect to IRONMAN. If prompted for passcode,
- Pairing successful, ready to stream music.

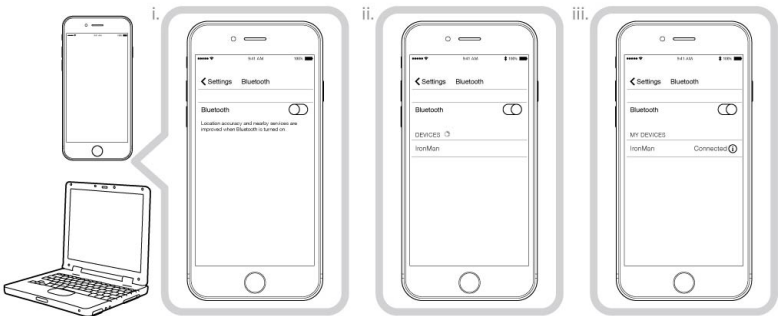

Note: The above are generic steps to pair to a Bluetooth device, for more specific instructions on *Bluetooth* connectivity for your device, please consult your manufacturer's manual.

### d. Ready to stream music via Bluetooth

Scroll volume wheel up or down to increase or decrease volume. You may also adjust your source device volume settings to increase or decrease volume.

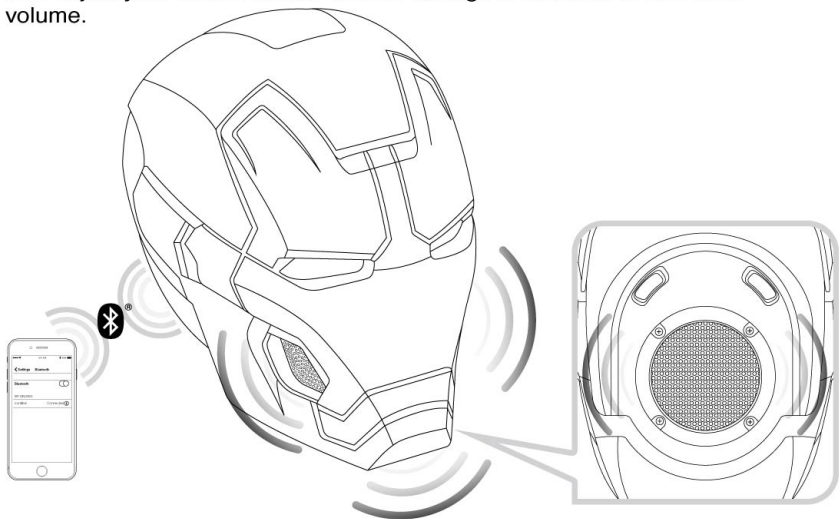

## 3. Reconnections between Bluetooth

You can reconnect your paired *Bluetooth* device to your speaker easily. Select 'IRONMAN' entry on the *Bluetooth* device to reconnect. Any of the 8 previously connected *Bluetooth* devices would be able to re-connect to IRONMAN when the T3150 Wireless is powered ON and not connected to any device.

Note : The IRONMAN is able to remember up to 8 paired devices in its memory bank, eliminating the need to re-pair again should any of these devices connect to the IRONMAN. Should a 9th device be paired to the IRONMAN, the 1st device will be erased from the IRONMAN memory banks. At any one time a maximum memory of 8 devices are being retained.

## 4. Toggle between last two connected Bluetooth devices

You can toggle between devices to enjoy your favorite music from another paired Bluetooth device by following these steps to establish connection.

Actions Press Bluetooth button once  
Indicators LED status indicator goes off and blinks at every 2 second interval  
Status Ready to stream music

Note: Ensure your next paired device's Bluetooth feature is ON and ready to accept connections.

## 5. Return to default setting

You can return the IRONMAN to default settings and erase its memory of paired devices by following these steps.

**Actions** Press and hold the Bluetooth button for 10 seconds while the speaker is ON  
**Indicators** A long beep tone is heard. LED Status Indicator blinks rapidly  
**Status** Memory cleared. Speaker is in pairing mode. Ready to accept connection from other Bluetooth devices.

---

## **USB Port:**

- 1、USB Port is Insert the U disk can play the music inside only. Not transfer data via the connection to the computer.
- 2、Micro USB is connecting to DC 5V USB cable to charge the speaker only. Not transfer data via the connection to the computer.

## **FCC Statement:**

This equipment has been tested and found to comply with the limits for a Class B digital device, pursuant to part 15 of the FCC Rules. These limits are designed to provide reasonable protection against harmful interference in a residential installation. This equipment generates, uses and can radiate radio frequency energy and, if not installed and used in accordance with the instructions, may cause harmful interference to radio communications.

However, there is no guarantee that interference will not occur in a particular installation. If this equipment does cause harmful interference to radio or television reception, which can be determined by turning the equipment off and on, the user is encouraged to try to correct the interference by one or more of the following measures:

- Reorient or relocate the receiving antenna.
- Increase the separation between the equipment and receiver.
- Connect the equipment to an outlet on a circuit different from that to which the receiver is connected.

This device complies with part 15 of the FCC rules. Operation is subject to the following two conditions: (1) This device may not cause harmful interference, and (2) this device must accept any interference received, including interference that may cause undesired operation.

**Note: Modifications to this product will void the user's authority to operate this equipment.**