

# REMOTE CONTROL CAR

## Instruction manual





# Attention

This product contains small parts do not allow children under 3 years old to play;  
This product contains electronic components, Do not enter water or use in a humid environment; Battery chargers should check their wires regularly.  
Plug, housing and other parts are damaged, and should stop using when found damaged.

## Matters needing attention

1. The small detachable parts should be put away and don't let children swallow.
2. If the operation site has radio interference, please select another site for operation.
3. When the remote control power supply is low, please stop the operation immediately.
4. For dismantled packaging, please do not discard it anywhere to avoid pollution Environmental health.
5. Please store your remote control model in a dry, cool place.
6. Do not store near fire or in a hot, humid place.
7. When the battery is soaked with water, please wipe the water thoroughly, such as there is deformation, please stop using.

## Battery usage precautions

1. The car body uses a Li-ion 7.4V rechargeable battery pack;
2. The remote control uses 3 1.5V"AA "batteries;
3. Please note that the battery is properly installed when installing or replacing the battery;
4. The rechargeable battery can only be charged under adult supervision;
5. Do not mix old and new batteries or different models;
6. After the battery is exhausted, it should be removed from the model car or remote control;
7. The terminal should not be short-circuited;
8. Non-rechargeable batteries are not rechargeable;
9. The rechargeable battery should be removed from the model car before charging;
10. Please do not break down the bad battery or battery pack and throw it into the fire or water, so as to avoid accidents.
11. The rated input voltage of the charger must be in line with the local household voltage.
12. During the charging process, the charger and battery appear warm, It's a common phenomenon.
13. This model car is prohibited to use non-original batteries.

# Product configuration



Remote control unit

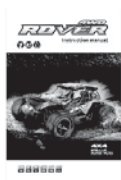

instruction book



Screwdriver



USB charger



R-type metal pin X6



Lithium-ion battery pack

## Disassemble the model car body

### Pull out the pin and remove the shell

Make sure all accessories are connected correctly, first remove the R-pin from the model car. Take off and remove the car shell.

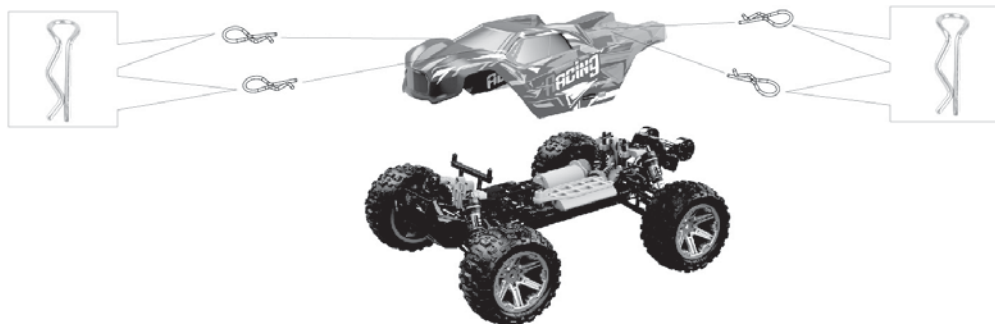

## USB charger precaution



### Attention

- (1) USB charger is not suitable for input current greater than 4A
- (2) When the input current is greater than 4A, the USB charger starts the protection mode and all the indicators are off.

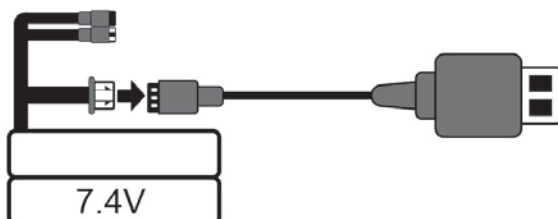

# Remote control battery assembly

1.Remove the battery cover.

Battery cover

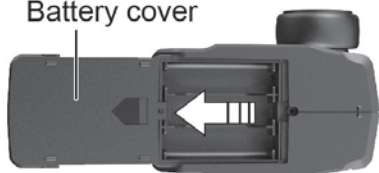

2.Install 3 AA alkaline batteries as shown in the illustration.Note that the battery is installed correctly

3x"AA" Batteries  
for -transmitter  
(Not Included)

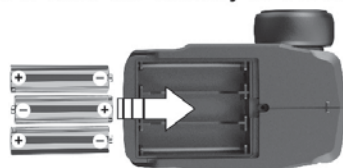

3.Close the battery cover.

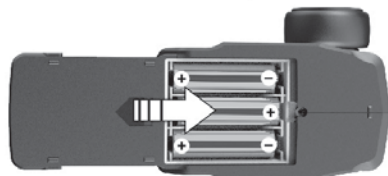

1. Please don't mix with old and new or different types of batteries.
2. Please replace the exhausted battery in time, and please do not use the leaky battery
3. Check the battery power on the remote control regularly. If the battery power is insufficient, the transmitting and receiving effect will not be good. In this case, the model car may get out of control, leading to an accident.

## Charging the car battery

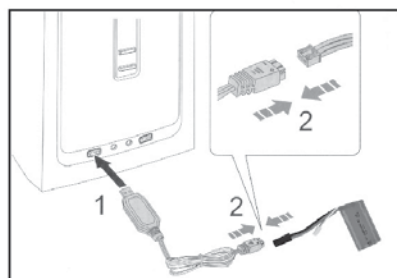
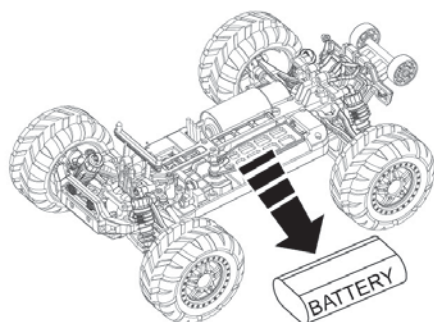

1. Remove the chassis battery as shown in the figure.
2. Connect the USB charging cable, insert the USB cable into the USB charging device port to charge.
3. The charging time is about 3.5 hours.
4. **USB indicator Description:**
  - 1) When charging the battery, the red light (power light) is always on, and the green light (charging indicator light) flashes slowly in frequency mode, indicating that the battery is charging normally.
  - 2) After the battery is fully charged, the red light (power light) goes out, the green light stops flashing and becomes normally on.

### Warning:

Do not use non-factory version of the rechargeable battery, so as to avoid damage to the performance of the model car, and do not leave it unattended when charging. Children can charge under the guidance and supervision of adults. Do not use batteries with leakage or damaged packaging.

# Remote control function introduction



- A. Power Switch
- B. Steering trim
- C. Throttle percent Switch
- D. Throttle reverse Switch
- E. Directional reverse Switch
- F. Steering D/R



- 1. Throttle Forward
- 3. Direction left turn
- 5. Brake
- 2. Brake
- 4. Direction right turn



## Operating model car

### A. Power Switch



First turn on the remote control power switch, the remote control light flashes, indicates that it is searching for the model car that needs to be coded, and then opens the model car power switch (long press the model car power switch for 2-3 seconds). The indicator light of the model car stops flashing and turns to bright, indicating that the code has been matched successfully.

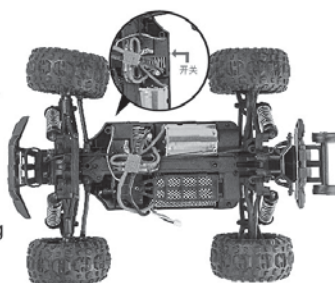

**Note:** When operating the code, do not pull the trigger or dial the steering control wheel to avoid the default wrong throttle or steering input signal. After completing the code, the direction control wheel and plate machine can be operated.

### B. Steering trim



Use the ST.TRIM knob to adjust the position when the model car is unable to drive in a straight line. When the model car turns left, the ST.TRIM knob should be fine-tuned clockwise. When the model car turns to the right, the ST.TRIM knob should be fine-tuned counterclockwise.

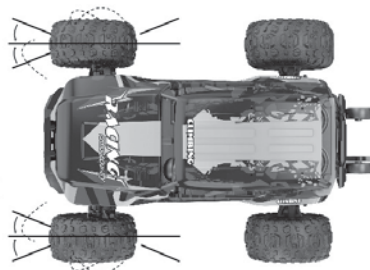

### C. Throttle percent Switch



**TH.D/R knob operation:**  
Turn clockwise to speed up the model car, Turn counterclockwise to slow down the model car.

**Suggestion:**  
Do not adjust the speed too fast when using the model car for beginners, so as not to damage the model car!



# Operating model car

## D. Throttle reverse Switch



- When the switch is turned to the left, pull the trigger with your finger to drive the model car forward;  
Push the trigger forward quickly with your finger as the brake;  
Push the trigger normally forward with your finger to drive the model car backwards.
- When the switch is turned to the right, push the trigger forward with your finger, and the model car moves forward;  
Pull the trigger back for the brake.  
Pull the trigger backwards with your finger, and the model car will drive backwards.

## E. Directional reverse Switch

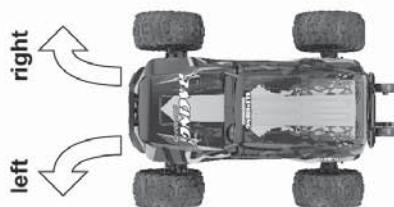

- When the ST.REV switch is turned to the left or the steering wheel is turned clockwise, the model car will turn to the right; Turn the wheel counterclockwise, The model car will turn to the left.
- When the ST.REV switch is flipped to the right or the steering wheel is turned clockwise, the model car will turn left; Turn the wheel counterclockwise, The model car will turn right.

## F. Steering range



- Turn the ST.D/R knob clockwise to increase the steering Angle
- Turn the ST.D/R knob counterclockwise to reduce the steering Angle

1

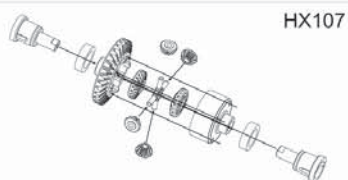

HX107



HX020  
HX204

HX202

HX011

HX107

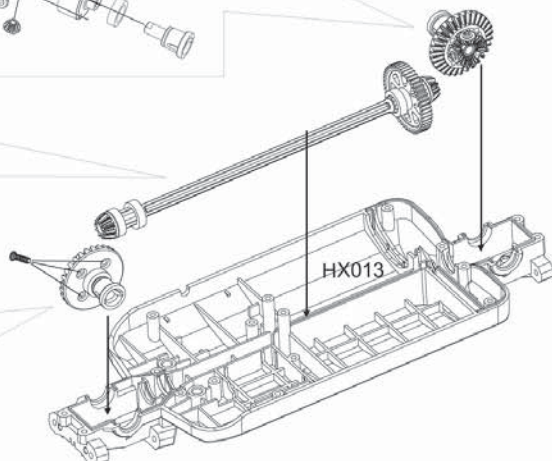

HX013

2

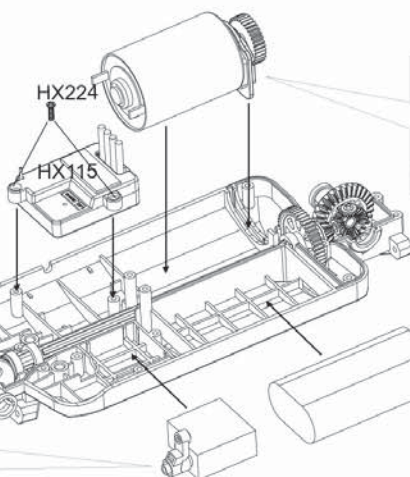

HX224

HX115



HX227

HX016

HX009

HX101



HX102

HX116

HX216

3

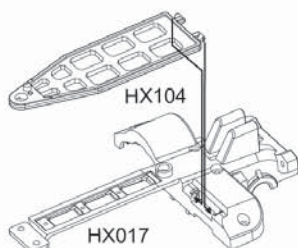

HX104

HX017

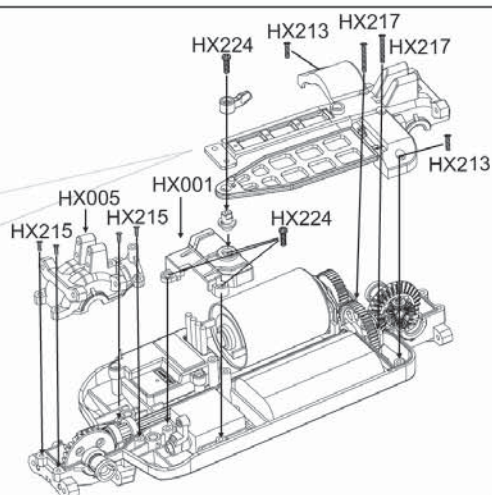

HX224

HX213

HX217

HX217

HX213

HX005

HX001

HX215

HX215

HX224

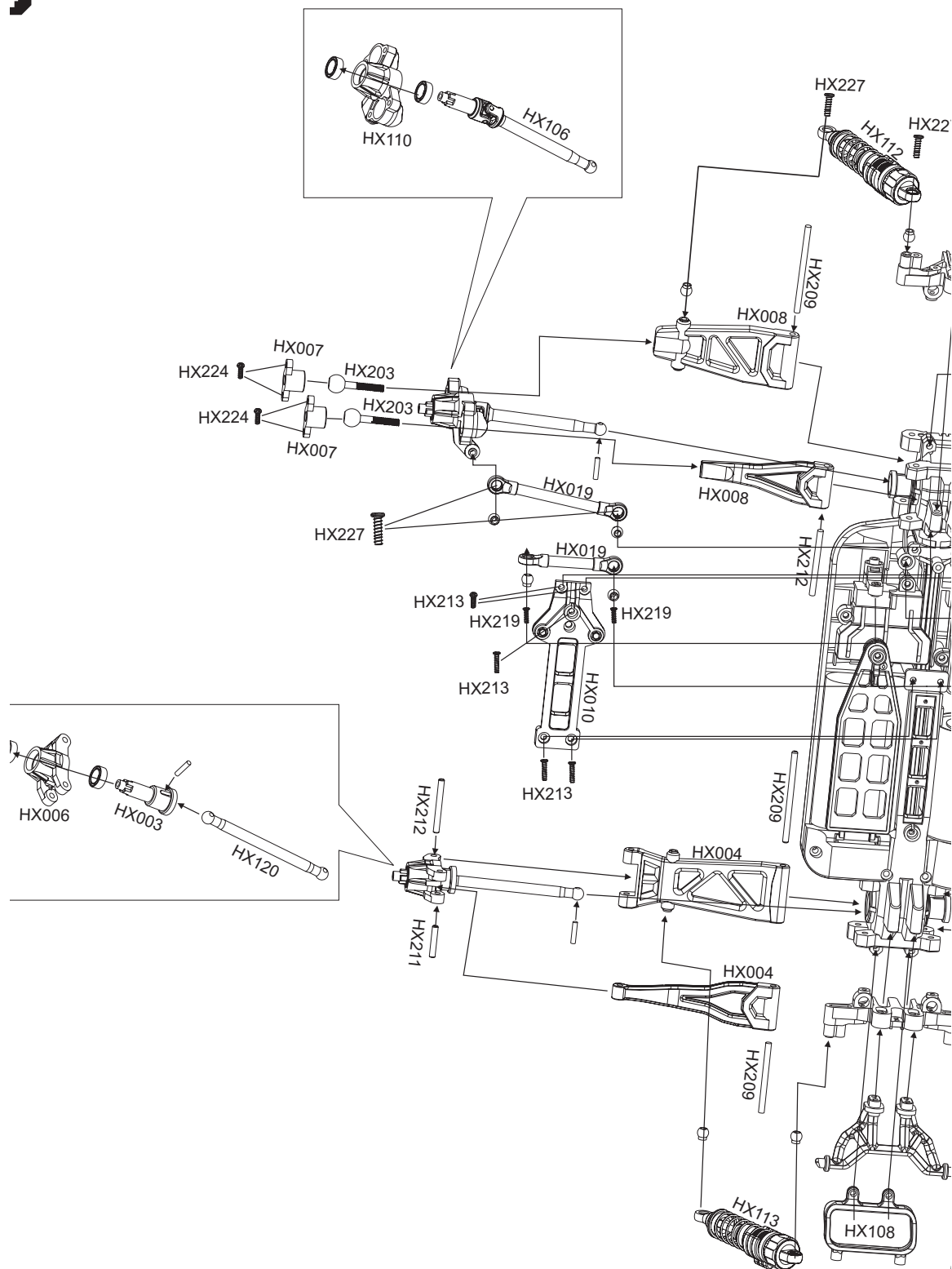

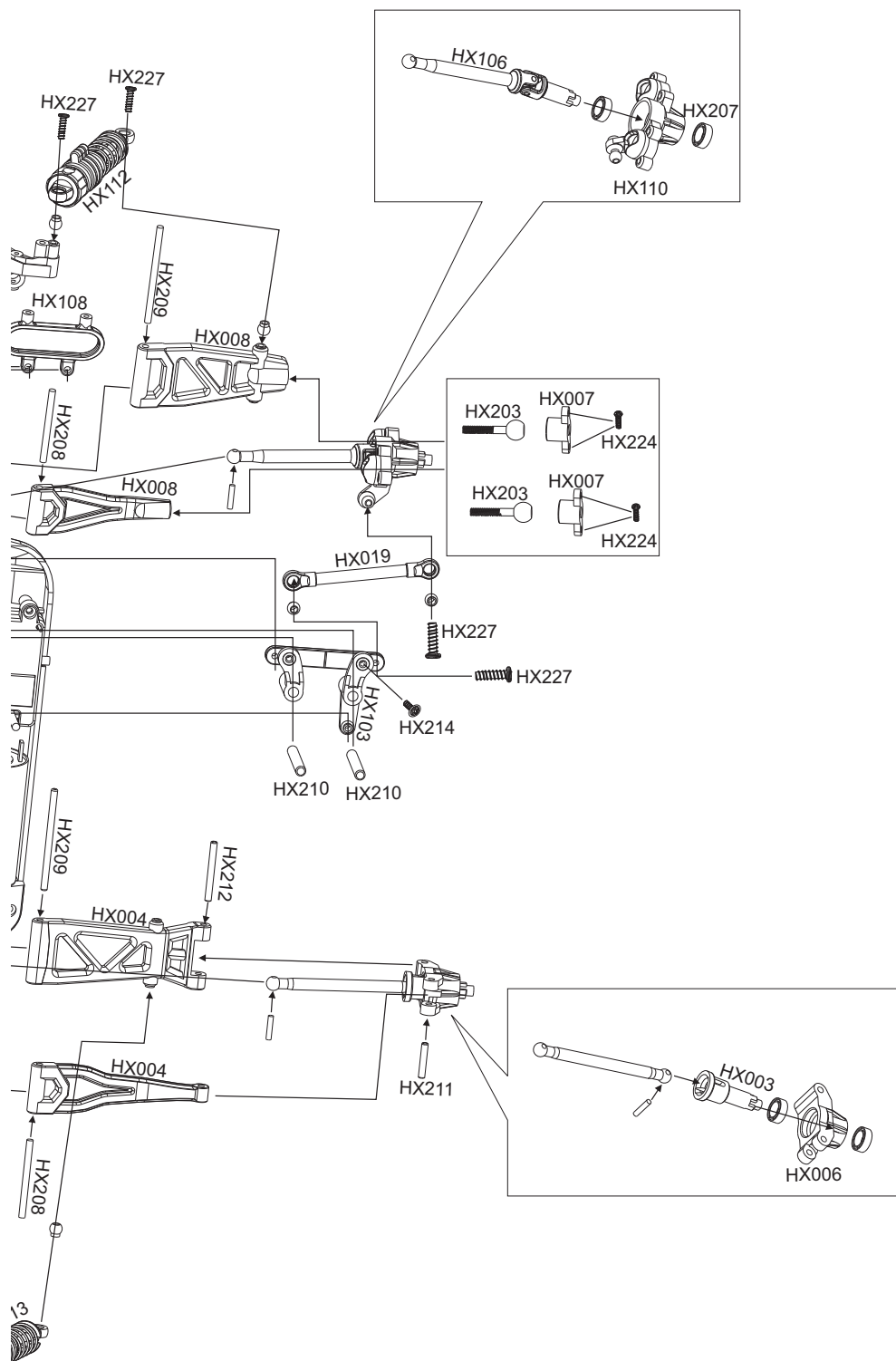

5

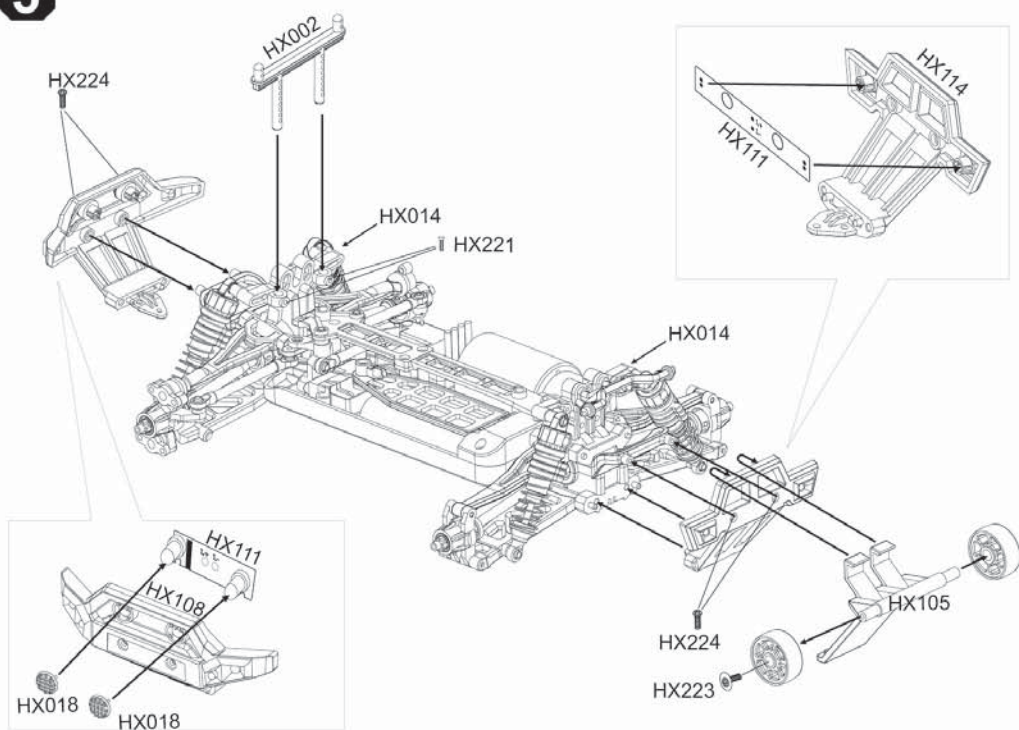

6

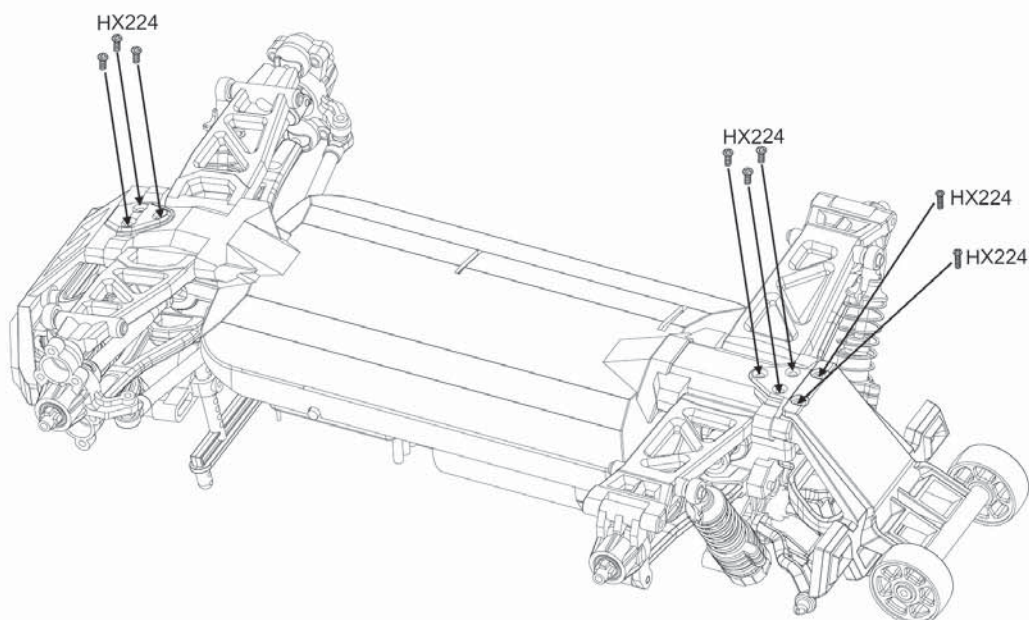

**7**

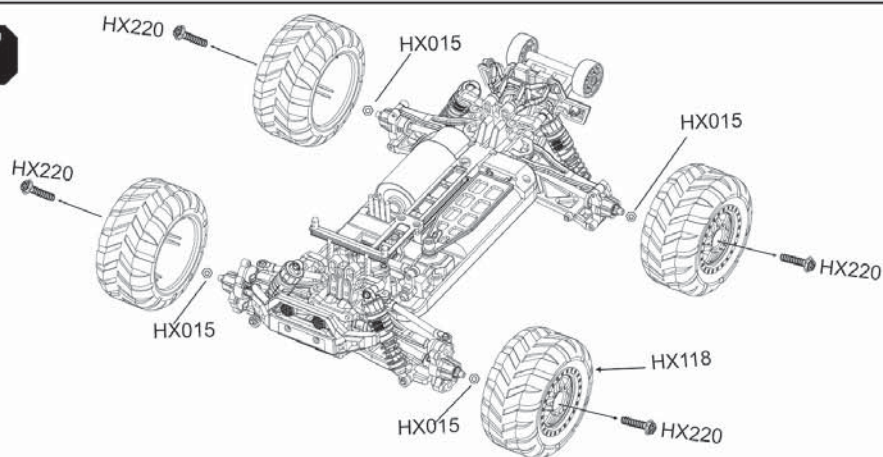

**8**

Screw  
HX226

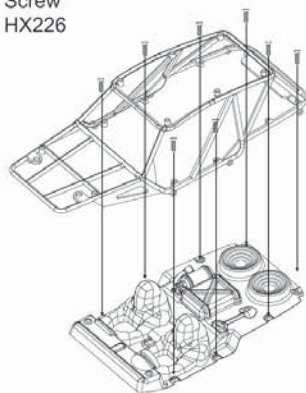

**9**

Screw  
HX226

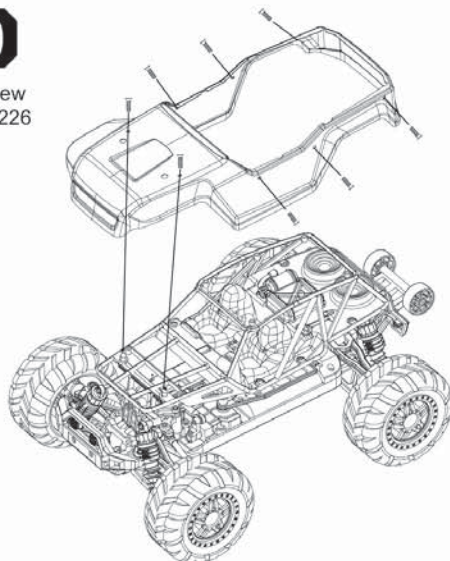

**10**

Screw  
HX226

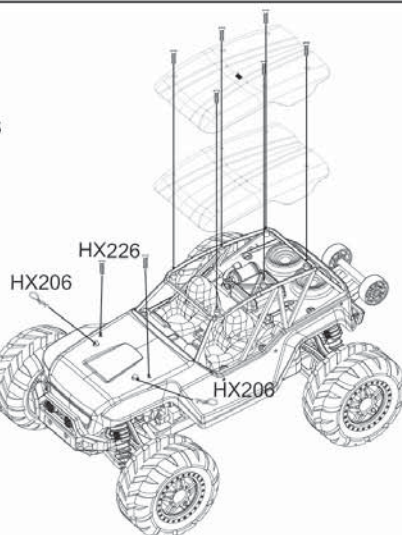

# Parts List

HX001

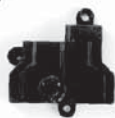

Steering gear press

HX002



Front and rear  
hood brackets

HX003



Rear axle cup

HX004



Swing arms back  
up and down

HX005

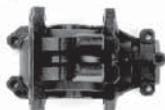

Head cover

HX006



Rear axle seat assembly

HX007



Steering head seat cover

HX008



Swing arms up  
and down forward

HX009



Motor mount (large)

HX010



Second floor

HX011



Master gear

HX012



Motor rear protection

HX013



Car bottom

HX014



Universal front and rear  
shock absorbers for big feet

HX015



Tire adapter

HX016



Motor stud

HX017



hood

HX018



lampshade

HX019



Long steering  
link assembly

HX020



Drive loose teeth

HX021



Rear hood bracket

HX022



Rear support

HX023



Front and rear  
collision avoidance

# Component List

HX101



540 strong magneto

HX102



Steering gear  
arm punching set

HX103



Steering gear  
bend arm assembly

HX104



Battery lock

HX105



Header assembly

HX106



Front drive shaft

HX107



The differential  
is converted

HX108



Front anti-collision  
assembly

HX109



Battery

HX110



Front axle  
seat assembly

HX111



Front and rear  
light assembly

HX112



Front long  
shock absorber

HX113



Rear long  
shock absorber

HX114



Rear anti-collision  
assembly

HX115



Brush tuned receiver

HX116



Steering engine

HX117



Data cable USB

HX118



直径84

Tire

HX119



Remote control unit

HX120



Rear propeller shaft

HX121



Damper table  
screw assembly

HX122



Tail assembly

HX123



Tire

HX124



Tire

# Alloy List

HX201



(4.8X2.5MM)

Iron bead ball head

HX202



(long158MM)

Pivot hexagon axis

HX203



Steering ball  
head screws

HX204



(8X12X3.5MM)

Ball bearing

HX205



Screwdriver

HX206



K-type metal pin

HX207



(6.35X9.5X3.2MM)

Ball bearing

HX208



(2.6X30MM)

Half screw

HX209



(2.6X43MM)

Swing arm shaft tip

HX210



(4X29.5MM)

Steering optical axis

HX211



(2.6X14MM)

Rear swing arm  
optical shaft tip

HX212



(2.6X26MM)

Half screw

HX213



(2.6X14MM)

Self-tapping screw

HX214



(2.5X6X6MM)

Machine screw  
with cover

HX215



(2.8X10MM)

Self-tapping screw

HX216



(2.6X6X14MM)

Self tapping  
screws with cover

HX217



(2.6X25MM)

Self-set screw

HX218



(2.3X10MM)

Self-tapping screw

HX219



(2.5X8MM)

Machine screw

HX220



(3X8X14MM)

Hexagonal self-tapping  
screws with cover

HX221



(2.6X6MM)

Self-tapping screw

HX222



(2.8X12MM)

Self-tapping screw

HX223



(2.6X10X10MM)

Self tapping  
screws with cover

HX224



(2.6X8MM)

Self-tapping screw

# Alloy List

HX225



(2.6X8MM)

Self-tapping screw

HX226



(2X5MM)

Self-tapping countersunk  
head screws

HX227



(2.5X12MM)

Machine screw

HX227



(3X4MM)

Headless screws

HX228



Front and rear  
shock absorbers

HX229



(4.8X3MM)

Iron bead ball head

# List of Car Shell Styles

HX09



HX10



HX11



HX12





# FCC Warning Statement

Changes or modifications not expressly approved by the party responsible for compliance could void the user's authority to operate the equipment. This equipment has been tested and found to comply with the limits for a Class B digital device, pursuant to Part 15 of the FCC Rules. These limits are designed to provide reasonable protection against harmful interference in a residential installation. This equipment generates uses and can radiate radio frequency energy and, if not installed and used in accordance with the instructions, may cause harmful interference to radio communications.

However, there is no guarantee that interference will not occur in a particular installation. If this equipment does cause harmful interference to radio or television reception, which can be determined by turning the equipment off and on, the user is encouraged to try to correct the interference by one or more of the following measures:

- Reorient or relocate the receiving antenna.
- Increase the separation between the equipment and receiver.
- Connect the equipment into an outlet on a circuit different from that to which the receiver is connected.
- Consult the dealer or an experienced radio/TV technician for help.

This device complies with part 15 of the FCC Rules. Operation is subject to the following two conditions: (1) This device may not cause harmful interference, and

(2) this device must accept any interference received, including interference that may cause undesired operation.

The device has been evaluated to meet general RF exposure requirement. The device can be used in portable exposure condition without restriction.