

Model WMIC2

Wireless Sound System

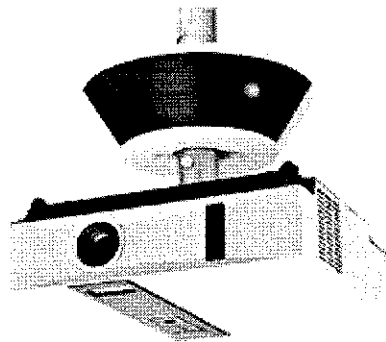

User's Guide



DUKANE iHear

Introduction

Thank you for buying this product.

- If you need service contact your dealer or call Dukane.
- Please read the User's Manual before using.
- Receiver Amp: Electronic equipment specification:
Input: DC12V  2A 
Rating: 110V - 240V
- MIC Tx: Electronic equipment specification:
Input: USB DC 5V to charge the transmitter.

DUKANE CORP AV SERVICE DEPT
2900 Dukane Drive
St Charles, IL 60174
800-676-2487
Fax 630-584-5156
avservice@dukane.com
www.dukane.com/av/service

Notice

FCC Radiation Exposure Statement

The equipment complies with FCC radiation exposure limits set forth for uncontrolled equipment and meets the FCC radio frequency (RF) Exposure Guidelines in Supplement C to OET65. The equipment has very low levels of RF energy that it is deemed to comply without testing of specific absorption ratio (SAR).

1. Changes or modifications are not expressly approved by the manufacturer could void the user's authority to operate the equipment. Changes or modifications to the device may void FCC and CE compliance. In frequently used radio links should be tested regularly to protect against undetected interference or fault.
- 2 This device complies with Part 15 of the FCC Rules. Operation is subject to the following two conditions:
 - (1) this device may not cause harmful interference, and
 - (2) this device must accept any interference received, including interference that may cause undesired operation. See 47 CFR Sec. 15.19(a)(3)We have not approved any changes or modifications to this device by the user. Any changes or modifications could void the user's authority to operate the equipment. See 47 CFR Sec. 15.21

Danger

3. Don't modify this product in any way. Such action could cause a fire, electric shock, serious personal injuries or product damage. Only a distributor or service center can provide maintenance and repair.
4. Please keep away from flammable or explosive gases when using this product.
5. If any liquid or object enters the product, stop use of the product. Please contact the distributor or a service center, and don't continue to use the product.
6. Operating this product with wet hands could cause electric shock.
7. Don't use this product while in an aircraft.

Warning

1. For safety reasons, please keep the product and accessories out of reach of small children or animals to avoid accidents such as:
 - swallowing the product or accessories. If this happens please see a doctor immediately.
 - Some small parts of product could cause personal injuries.
2. Do not place this product in a high temperature environment, high or low temperature environments may negatively effect the internal parts, or even result in fire.
Do not place in: microwave oven, radiator, or refrigerator, since this may cause the product battery to explode.

Caution

1. If a credit card is held near the speaker, it will be demagnetized. Please keep credit cards away from this product.
2. A malfunction of this product will occur if using a power adapter that doesn't match the one supplied with the product.
3. Painting this product is prohibited. Do not paint this product. Painting will affect it's normal use.
4. Do not hit or drop the product.

Packing List

Components

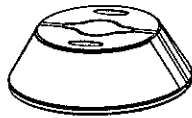

Speaker – Receiver

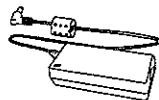

Switching adapter

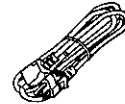

Power Cord



3.5mm Audio Cable

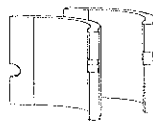

Foam

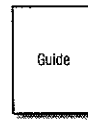

Quick Start Guide



Wireless Mic
Transmitter



USB Cable



Lanyard



Collar Clip Mic

Optional components

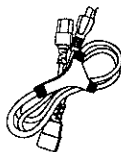

Y--Cable (Optional)

Instruction

Speaker

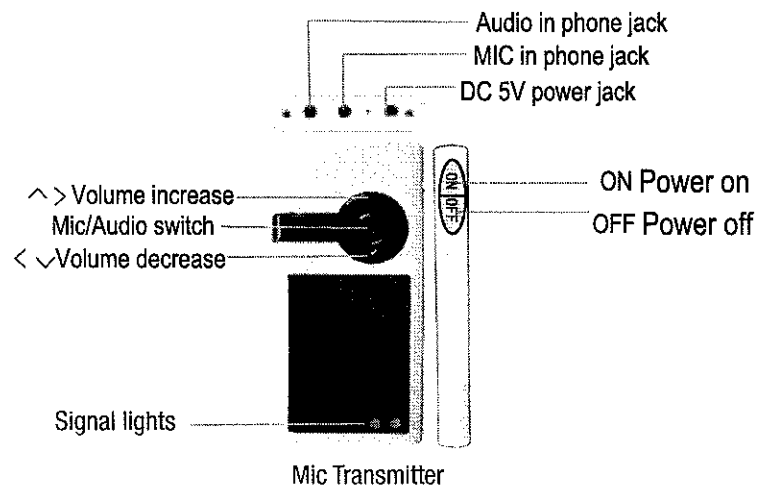
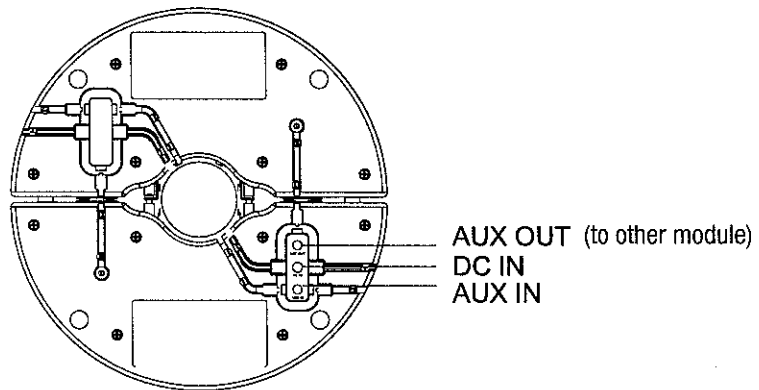

Caution

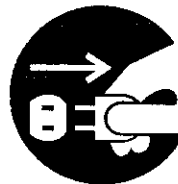
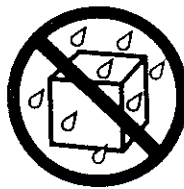
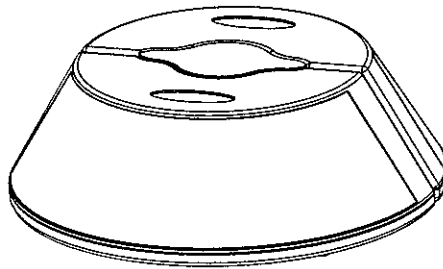

Special note: The center button on the mic transmitter switches the audio between the AUDIO IN port and the MIC IN port. This could be the reason that the Mic is not heard.

Speaker assembly

1

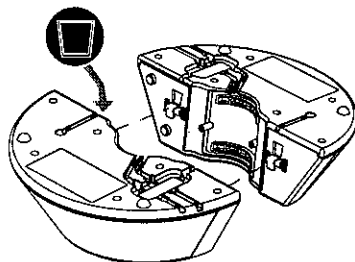

2

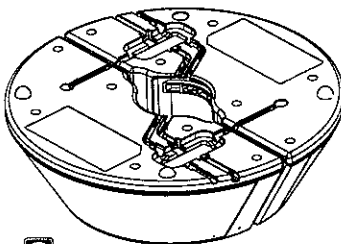

3

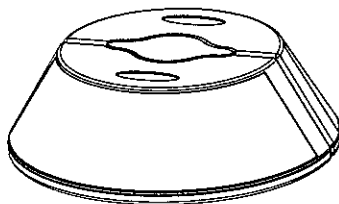

Installation

- 1** Put the foam pads on the inner side of speaker.

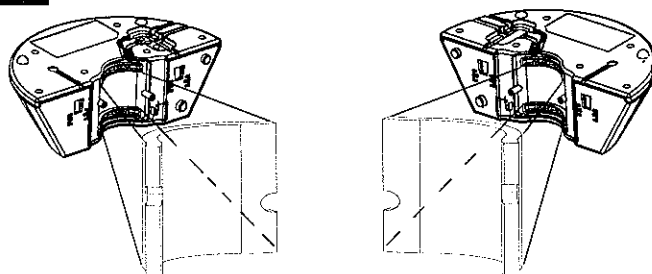

- 2** Connect main module and auxiliary module by metal hooks and locate on the pole.

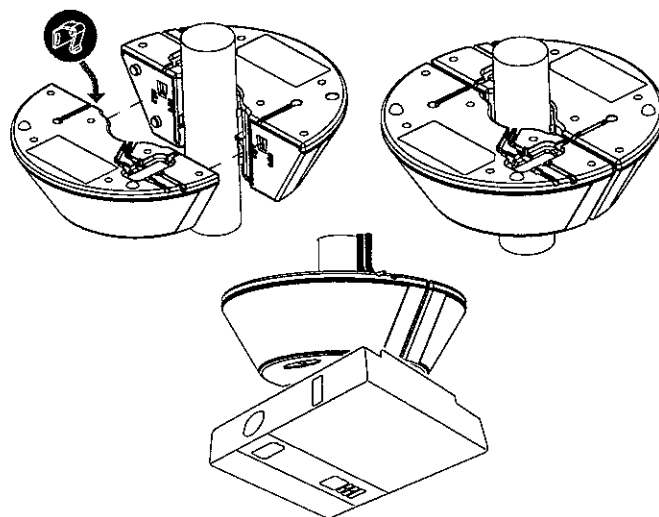

Audio Source Connection

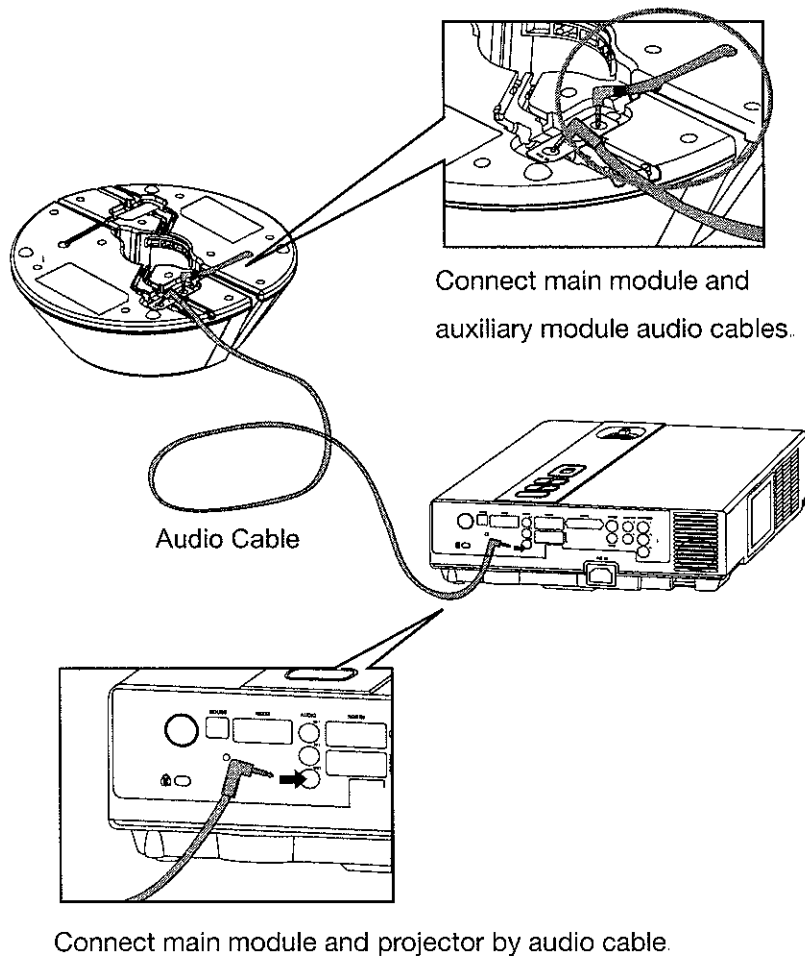

Power Connection

A:

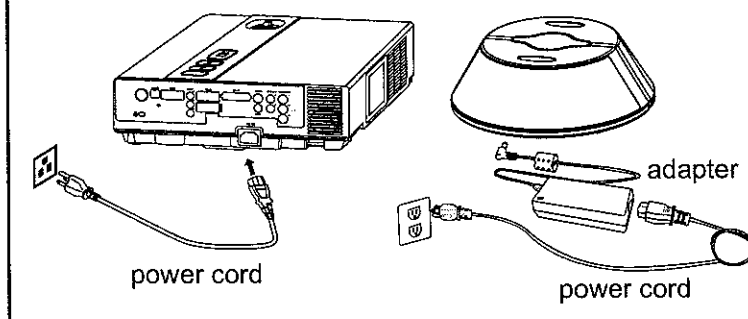

B:

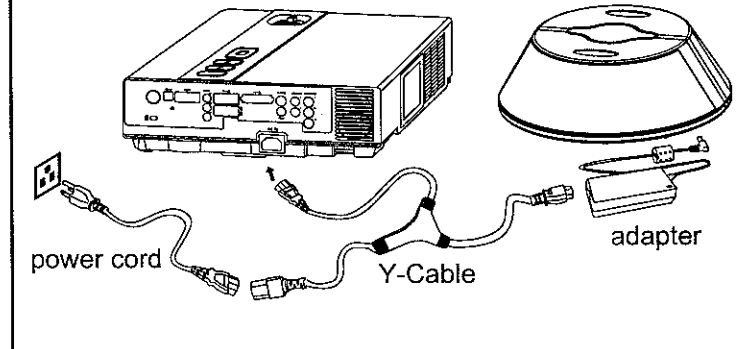

Connecting Components

Wireless microphone connection:

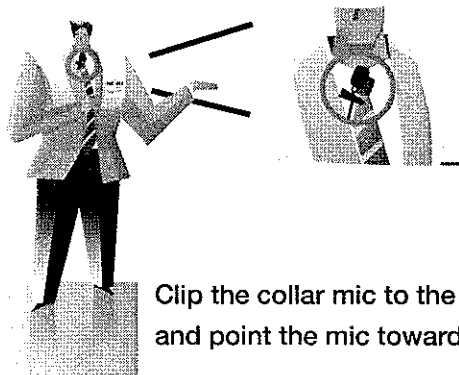
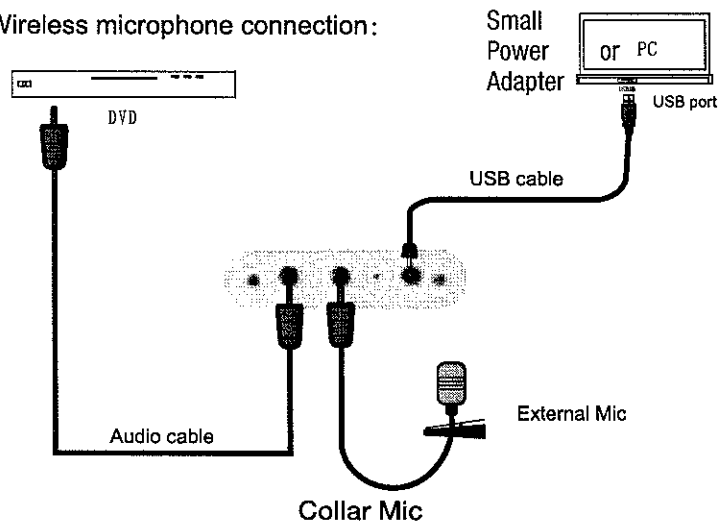

Clip the collar mic to the necktie or collar and point the mic toward the throat.

Light Signal Specification

Blue Light	Red Light	Light Instruction
OFF	OFF	Power off
Quick flashing		Matching state (seeking)
Slow flashing		Match successfull in connecting state
Slow flashing		MIC mode if flash one time every 2.5s
Slow flashing		Audio mode if flash two times every 2.5s
	ON	Charging, red light tuns off automatically after charging complete
	Slow flashing	Low power and need to charge if flash one time every 2.5s
	Quick flashing	NO signal connection between mic and speaker

Matching Procedure

1. Turn on the mic, frequency matching procedure needs 3 seconds.
2. After the mic Red/Blue LED's are alternately flashing a "Beep - Beep" sound will be heard. This means the mic and speaker-receiver are paired (matched).
3. Matching distance is under 10 feet between mic and speaker.
4. Make sure the bottom of mic transmitter is not blocked.

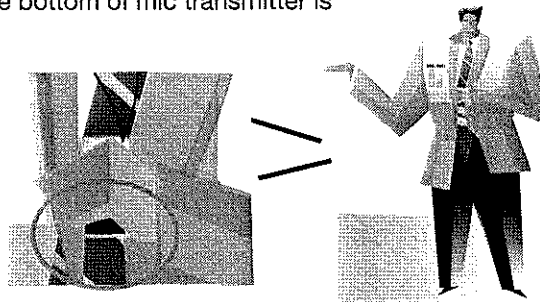

Troubleshooting

1. Q: The mic transmitter is ON but no sound is heard.
A:
 1. Please make sure the mic transmitter is within 10 feet of the speaker unit..
 2. Please make sure the mic transmitter has power. The LED signal lights flash.
 3. Please make sure the speaker has power.
2. Q: No signal light on the mic transmitter after it has been turned ON.
A: Please charge the mic transmitter.
3. Q: Low voice (sound) when using the mic transmitter.
A: Manually adjust the volume button to increase volume..
4. Q: The mic transmitter doesn't work when charging is attempted.
A: Please check to see if the power adapter is plugged in.
5. Q: The system can't complete matching process.
A:
 1. Please make sure the mic distance is within 10 feet of the speaker.
 2. Please make sure the power is ON.
6. Q: How long can the mic be used?
A: The complete charging process requires at least 4 hours of continuous charging. The mic can be used at least at least 8 hours. The mic transmitter red LED will begin to slowly flash (every 2 seconds) once there is less than 1 hour of operating time remaining.

Special note: The center button on the mic transmitter switches the audio between the AUDIO IN port and the MIC IN port. This could be the reason that the Mic is not heard.

DUKANE CORP AV SERVICE DEPT
2900 Dukane Drive
St Charles, IL 60174
800-676-2487
Fax 630-584-5156
avservice@dukane.com
www.dukane.com/av/service

12-00015-00

Spec

Product Name : Wireless Microphone
Model Type : WMIC2
Brand Name : DUKANE

ITEM	TX SPEC
Operation Voltage	3.6~5V
Operation Current	<50mA
Frequency Range	2409~2476MHz
Channel	40
Modulation	GFSK
TX PO	< 10mW
Input Impedance	10K Ohm
Input Voltage	2.8Vp-p(Max)
Audio Delay	<1.5ms
Dynamic@1kHz	81dB
Analyzer@1kHz	90dB
Distortion THD	0.1%
Antenna Type	Internal Trace Antenna
Antenna Gain	-4.24dBi
TX Distance	MAX 30 Meter
Charged	Lithium Battery USB Charged
Outline	
Interface	External Audio in/Microphone in
SIZE	L:82.4mm W:42mm H:10mm
Weight	28.8 g