



HearSound™

Better Hearing. Better Listening. Better Life.™

Quick Start Guide HSSPKR



Want an easier setup?

Scan here

for quick step-by-step
video instructions

OR Type in the website address
www.hearsoundusa.com/setupvideos

What's in the package?



HearSound™

Better Hearing. Better Listening. Better Life.™

SoundBall

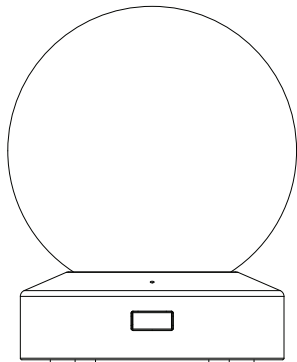

3.5MM female to
RCA Audio adapter

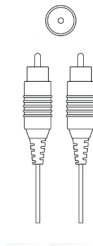

Transmitter

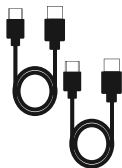

2 x USB charging/
power cables



2 x USB power
adapter



1 x optical audio
cable

URGENT – remove protective plastic tips
from both ends of OPTICAL cable.



1 x 3.5mm stereo
audio cable

Step 1: Charge the speaker

Plug in charging cable to back of speaker.

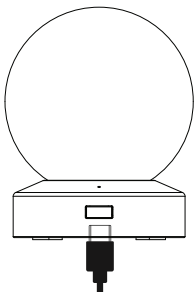

Indicator light will start flashing.

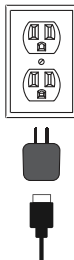

We recommend charging the speaker for 8 hours before first use.
This will help extend the life of the rechargeable battery.

Step 2: Connect to your TV

HearSound supports three kinds of audio output from your TV:

- optical (best sound quality)
- line-in or AUX (better sound quality)
- coaxial (good sound quality)

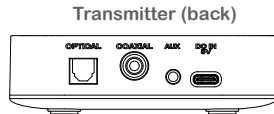

Step 1: Look at the back or side of your TV to find the audio output connection options.

Step 2: Plug the cable into the TV audio outputs on your TV to the matching input on the rear panel of the HearSound transmitter.

Note: The optical and AUX cables are included in this package.

Please remove tips from Optical cable before use.

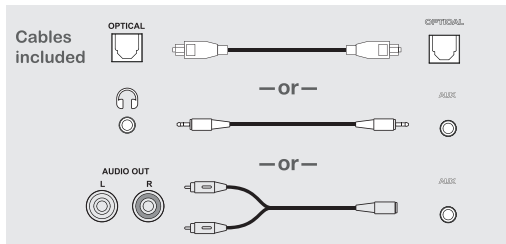

Step 3: Plug in the transmitter

Plug one end of an included charging cable into the DC IN 5V jack on the back of the transmitter.

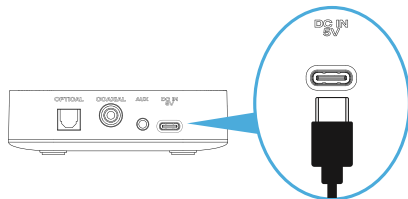

If your TV has a USB power outlet, plug the other end of the charging cable into this outlet. Otherwise, plug it into an AC outlet using the included USB power adapter.

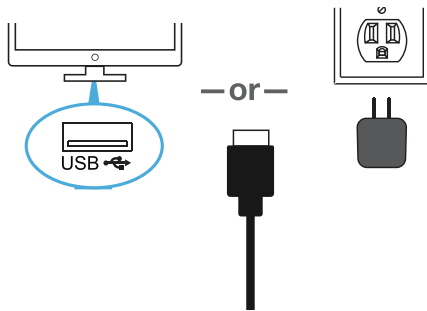

Step 4: Pair the speaker and transmitter

1. The transmitter turns on automatically when you plug it in (if it doesn't, press and hold the  button to turn the transmitter on manually).

Press the transmitters source button to choose the input you are connected to (optical, coaxial or aux).

2. Turn on the speaker by pressing and holding the Power button. Once the speaker is on press the volume + a few times to set the volume to about 50%. The light on the speaker should be blinking indicating that it is in pairing mode. After a few seconds both the Transmitter Light and the Speaker Light should be solid which means they are connected. You should now hear audio playing thru the speaker. Adjust the volume to the level that works best for you.

TIP: If you are not receiving audio through your speaker and the indicator light is not solid blue, your system is not paired. To pair, press the hold button on the transmitter for at least 2 seconds and the indicator lights start flashing. Then you will press the tone button on the speaker until you hear a BEEP and let go. Then the indicator light on the speaker should start blinking. Once paired, both units will turn solid blue.

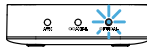

The indicator light will start blinking on the transmitter's front panel.

If the transmitter's indicator light isn't blinking, press and hold the transmitter's PAIR button to enter pairing mode.

3. **IF YOU ARE STILL NOT RECEIVING AUDIO** – You will need to adjust your audio settings of your TV (refer to your TV's instruction manual to adjust audio settings. You are not receiving audio because your TV requires a setting change to output digital audio to Optical Out. Using your TV remote control, utilize your remote to go to settings usually using a MENU button and go to Audio Settings. There should be a setting for PCM or Digital Audio. If you can choose PCM choose this. Now check your headset – you should now be hearing audio. If you are still not able to receive audio please contact us at support@hearsoundusa.com and we will set up an appointment to walk you thru your set up.

Step 5: Place the transmitter

The transmitter can be placed near your TV or mounted to the back of it.

How to mount the HearSound transmitter:
Find where you want to mount the transmitter on your TV and make sure the spot is clean and dry. Peel the cover from the transmitter's bottom to expose the mounting adhesive. Press and hold the transmitter to the back of your TV for 10 seconds. Then gently release.

Note: Before mounting, ensure the transmitter and cable can easily reach the input connection on your TV.

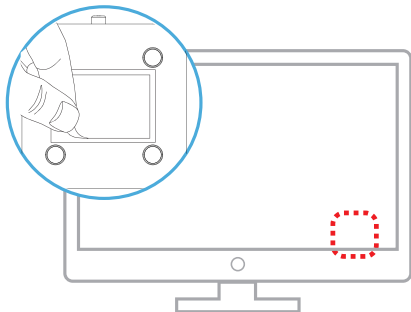

FCC WARNING

This device complies with part 15 of the FCC Rules. Operation is subject to the condition that this device does not cause harmful interference (1) this device may not cause harmful interference, and (2) this device must accept any interference received, including interference that may cause undesired operation.

Any changes or modifications not expressly approved by the party responsible for compliance could void the user's authority to operate the equipment.

NOTE: This equipment has been tested and found to comply with the limits for a Class B digital device, pursuant to Part 15 of the FCC Rules. These limits are designed to provide reasonable protection against harmful interference in a residential installation. This equipment generates, uses and can radiate radio frequency energy and, if not installed and used in accordance with the instructions, may cause harmful interference to radio communications. However, there is no guarantee that interference will not occur in a particular installation.

If this equipment does cause harmful interference to radio or television reception, which can be determined by turning the equipment off and on, the user is encouraged to try to correct the interference by one or more of the following measures:

- Reorient or relocate the receiving antenna.
- Increase the separation between the equipment and receiver.
- Connect the equipment into an outlet on a circuit different from that to which the receiver is connected.
- Consult the dealer or an experienced radio/TV technician for help.

The device has been evaluated to meet general RF exposure requirement. The device can be used in portable exposure condition without restriction.



HearSound™

Better Hearing. Better Listening. Better Life.™

For complete instructions, see the User Guide that comes in this package.