

Philyra

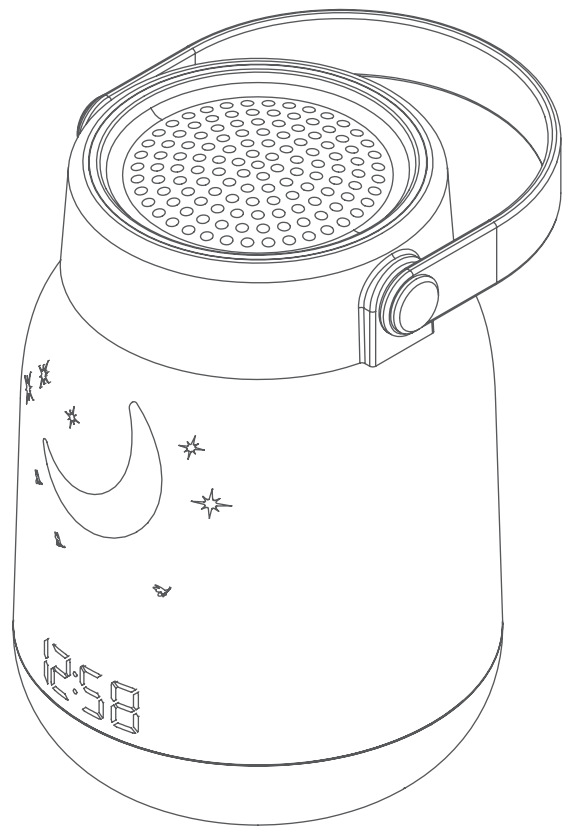

Firefly

Fairytale summer night firefly light bluetooth speaker  
Model: A20030



## INSTRUCTION MANUAL



### BUTTON OVERVIEW

	POWER/BT Button		
	Time Button		VOL+ Button
	Timer Button		VOL- Button
	Alarm Button		Light Button
	Time On/Off Button		Music Button

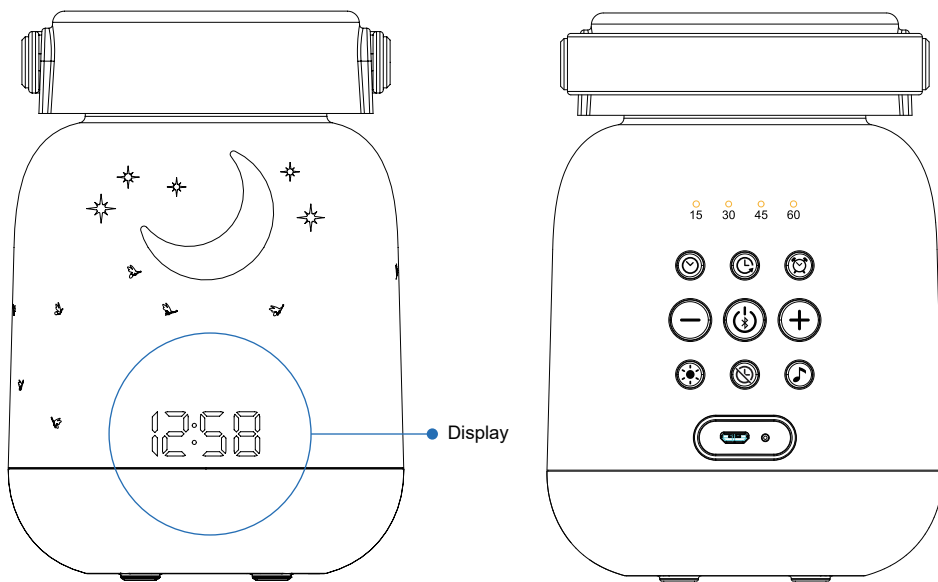

### INSTRUCTIONS

#### Power/BT Button

1. Press and hold the POWER / BT button for 2 seconds to turn on the device (with Bluetooth activated by default) . The indicator light will blink when enter pairing mode.

2. To turn the device off hold the POWER / BT button for 5 second. The device, Bluetooth, voice playback and night lights will be turned off at the same time.

3. Double-click the POWER / BT button to Exit connection. Back to pairing mode and the blue indicator light will start to blink quickly.

4. While in voice mode, short press to return to the Bluetooth status

5. To turn off the bluetooth, hold the POWER / BT button for 2 second.

NOTE: TIME display time is automatically adjusted to dim level if there is no operation in 5 minutes

#### VOL+ Button

1. Short press to increase volume by 1 level (total 16 levels), long press VOL+ to increase volume quickly, display will show the volume level when adjusting the volume.

#### VOL- Button

1. Short press to decrease volume by 1 level (total 16 levels), long press VOL- to decrease volume quickly, display will show the volume level when adjusting the volume.

#### Music Button

1. When unit is on, short press the SOUND button to switch to next sounds, the music symbol on the screen will lights up accordingly (The volume changes to level 2 in about 3 seconds).

Press the music button once to change the sounds in order of :

1. Summer night
2. Brook
3. Wind
4. Ocean
5. Rain
6. RainForest
7. Campfire
8. Thunderstorm
9. Heartbeat
10. Whitenoise
11. Brahms Lullaby
12. Twinkle Twinkle Little Star
13. Moonlight Sonata
14. Schubert Serenade
15. Edelweiss
16. Red River Valley
17. Meditation from Thaïs
18. Mozart's Lullaby

2. When playing sounds, long press SOUND button for 2 seconds to turn off sound.

#### Light Button

1. When unit is on, short press the Light button to change light modes. Press and hold the Light button for 2 seconds to turn off on the lights including firefly, moon and stars.

2. When in off mode, Press the light button for 2 second to turn on firefly mode.

#### Timer Button

1. When unit is on, short press the TIMER button to set timer to 15/ 30/ 45/ 60 minutes or off.

#### Alarm Button

1. Short Press Alarm button to turn on/off alarm and display will show the alarm sign.

2. Long press the ALARM button to set alarm time, minutes flash and can be adjusted via pressing VOL +/VOL- button.

3. With minutes set then short press ALARM button to switch hours and hours will flash accordingly, short press VOL +/VOL- button to set hours, then short press the ALARM button to select the alarm sound among beep and 18 built-in sounds via short pressing VOL + / VOL-, the display show -bb- -01 ~ -18 accordingly, do not operate after sound selected for 10 seconds, alarm will set and come back to time display.

as shown in figure below:

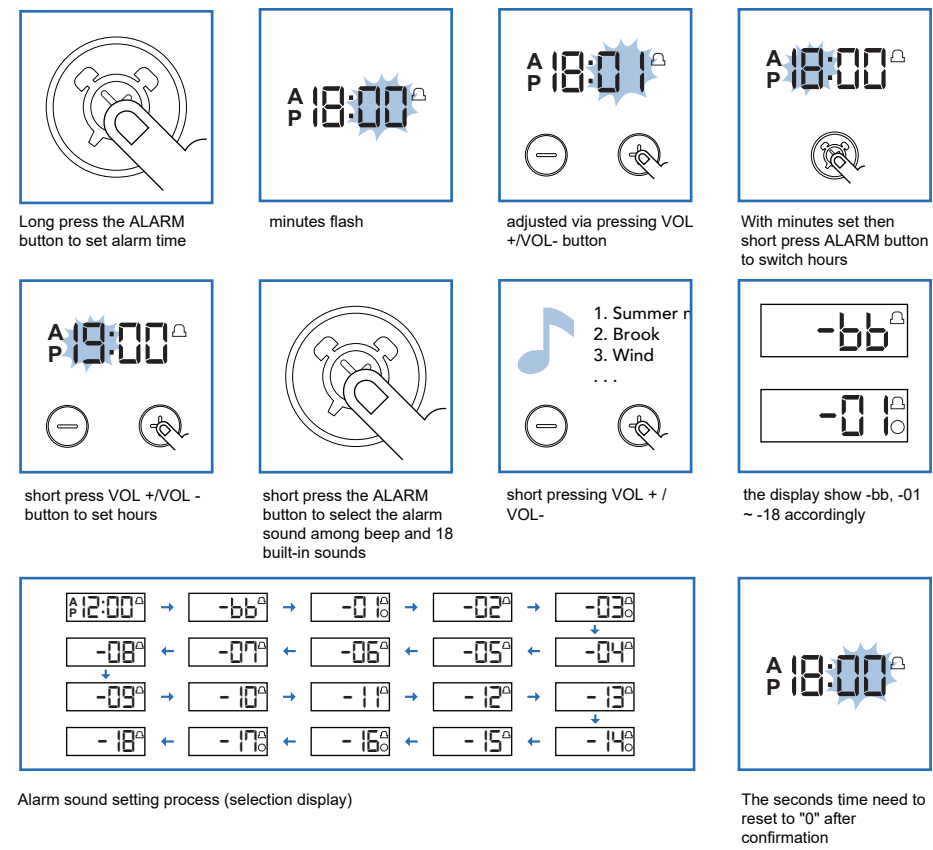

3. When alarm is ringing. Press any button to enter 5-minute snooze time (can snooze Max. 3 times), Press and hold the ALARM button for 2 seconds to turn off alarm.

4. After turn off the alarm button. If need to reset this alarm, press the alarm button and the alarm sign will turn on. then you can enter the last alarm set time.

#### Time Button

1. Press and hold TIME button for 2 seconds to start setting time, the minutes flash indicating it adjustable, short press VOL +/VOL- button to increase/decrease minutes.

2. With minutes set, press TIME button to set hours, the hours flash and can be adjusted via VOL +/VOL- button.

3. After hours set press TIME button again to finish time setting.

4. When the LCD display Time mode, short press the TIME button to change your screen brightness (high/low).

#### Time On/Off Button

1. The time display can be activated or deactivated by pressing the TIME ON/OFF button.

#### VOL+/VOL- Button

1. Press and hold the VOL + button / VOL- button simultaneously for 5 seconds will reset unit to factory mode, the TIMER indicators 15, 30, 45, 60 will light up and flash for 5 seconds indicate reset successfully.

Note: The product will shut down when battery voltage is lower than 3.3V.

#### Type-C (BACK)

1. Plug the Type-C cable with the Power adapter on your device, and then connect to your power source.

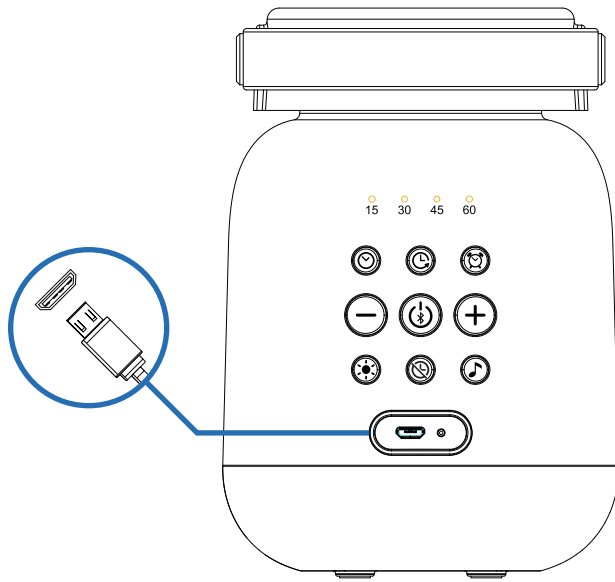

#### BLUETOOTH

1. Enable Bluetooth on your smartphone or other device (if it isn't already enabled). Choose "Philyra Firefly" from the list of pairing options on your smartphone. (If it's not in the list, choose "SCAN" from your phone's Bluetooth menu.) The device gives an audio signal when it's finished pairing and connecting to your smartphone. The indicator turns solid blue.

##### Bluetooth Wireless Connection Tips

- Make sure the Bluetooth capability of your device is turned on.
- The Bluetooth wireless connection works up to a range of roughly 33 feet (10meters). This range may vary, however, based on other factors, such as room layout, wall material, obstacles, your device's Bluetooth performance, etc. If you're having problems connecting to this speaker, move closer to it.
- If your device asks you for a password to connect, use "0000".
- Ensure that the volume of the Bluetooth device is turned to the maximum (or at least 75%).



### CAUTION

This device was tested for typical body-worn operations. To comply with RF exposure requirements, a minimum separation distance of 5mm must be maintained between the user's body and the handset, including the antenna. Third-party belt-clips, holsters, and similar accessories used by this device should not contain any metallic components. Body-worn accessories that do not meet these requirements may not comply with RF exposure requirements and should be avoided. Use only the supplied or an approved antenna.

This device is in compliance with the essential requirements and other relevant provisions of Directive 2014/53/EU. All essential radio test suites have been carried out.

1. Use careful with the earphone maybe possible excessive sound pressure from earphones and headphones can cause hearing loss.

2. CAUTION - RISK OF EXPLOSION IF BATTERY IS REPLACED BY AN INCORRECT TYPE. DISPOSE OF USED BATTERIES ACCORDING TO THE INSTRUCTIONS

3.The product shall only be connected to a USB interface of version USB 2.0 BT-2402-2480MHz Max Power:-2.64dBm.

This device complies with part 15 of the FCC Rules. Operation is subject to the condition that this device does not cause harmful interference (1) this device may not cause harmful interference, and (2) this device must accept any interference received, including interference that may cause undesired operation.

Any changes or modifications not expressly approved by the party responsible for compliance could void the user's authority to operate the equipment.

NOTE: This equipment has been tested and found to comply with the limits for a Class B digital device, pursuant to Part 15 of the FCC Rules. These limits are designed to provide reasonable protection against harmful interference in a residential installation. This equipment generates uses and can radiate radio frequency energy and, if not installed and used in accordance with the instructions, may cause harmful interference to radio communications.

However, there is no guarantee that interference will not occur in a particular installation. If this equipment does cause harmful interference to radio or television reception, which can be determined by turning the equipment off and on, the user is encouraged to try to correct the interference by one or more of the following measures:

-- Reorient or relocate the receiving antenna.

-- Increase the separation between the equipment and receiver.

-- Connect the equipment into an outlet on a circuit different from that to which the receiver is connected.

-- Consult the dealer or an experienced radio/TV technician for help.

To maintain compliance with FCC's RF Exposure guidelines, this equipment should be installed and operated with minimum distance between 20cm the radiator your body. Use only the supplied antenna.

FCC ID: ZY9-A20030

IC Caution:

- English:

This device complies with Industry Canada licence-exempt RSS standard(s). Operation is subject to the following two conditions: (1) This device may not cause interference, and (2) This device must accept any interference, including interference that may cause undesired operation of the device.

- French:

Le présent appareil est conforme aux CNR d'Industrie Canada applicables aux appareils radio exempts de licence. L'exploitation est autorisée aux deux conditions suivantes:

(1) l'appareil ne doit pas produire de brouillage, et

(2) l'utilisateur de l'appareil doit accepter tout brouillage radioélectrique subi, même si le brouillage est susceptible d'en compromettre le fonctionnement.



### FEATURES

- built-in 3.7V 2200mAh lithium battery
- 18 sounds
- LED Alarm clock
- Bluetooth5.0 with Built-in Speaker
- Electronic LED clock
- 15/30/45/60 Sleep Timer

### 12 MONTH LIMITED WARRANTY

Shenzhen Tianxingtai Optonics Technology Co., Ltd. (the "Company") warrants to the original retail purchaser of this product that should this product or any part thereof, under normal use and conditions, be proven defective in material or workmanship within 12 months from the date of original purchase, such defect(s) will be repaired or replaced with new or reconditioned product (at the Company's option) without charge for parts and repair labor. To obtain repair or replacement within the terms of the warranty, the product is to be delivered with proof of warranty coverage (e.g. dated bill of sale), specification of defect(s), transportation prepaid, to an approved warranty station. For the return address, please scan the QR code on the product or packaging. This Warranty is not transferable and does not cover product purchased, serviced or used outside the United States or Canada. The warranty does not extend to the elimination of externally generated static, noise, or loss of range or audio/ video quality due to external factors, to costs incurred for the installation, removal or reinstallation of the product, or to damage to digital media devices or memory. The warranty does not apply to any product or part thereof which, in the opinion of the company, has suffered or been damaged through alteration, improper installation, mishandling, misuse, neglect, accident or exposure to moisture. This warranty does not apply to damage caused by an AC adapter not provided with the product or by removal or defacement of factory serial number/barcode labels.

THE EXTENT OF THE COMPANY'S LIABILITY UNDER THIS WARRANTY IS LIMITED TO THE REPAIR OR REPLACEMENT PROVIDED ABOVE AND, IN NO EVENT, SHALL THE COMPANY'S LIABILITY EXCEED THE PURCHASE PRICE PAID BY PURCHASER FOR THE PRODUCT.

This Warranty is in lieu of all other express warranties or liabilities.

ANY IMPLIED WARRANTIES, INCLUDING ANY IMPLIED WARRANTY OF MERCHANTABILITY OR FITNESS FOR A PARTICULAR PURPOSE, SHALL BE LIMITED TO DURATION OF THIS WARRANTY. ANY ACTION FOR BREACH OF ANY WARRANTY HEREUNDER, INCLUDING ANY IMPLIED WARRANTY, MUST BE BROUGHT WITHIN A PERIOD OF 24 MONTHS FROM THE DATE OF ORIGINAL PURCHASE. IN NO CASE SHALL THE COMPANY BE LIABLE FOR ANY CONSEQUENTIAL OR INCIDENTAL DAMAGES WHATSOEVER.

No person or representative is authorized to assume for the Company any liability other than expressed herein in connection with the sale of this product. Some states/provinces do not allow limitations on how long an implied warranty lasts or the exclusion or limitation of incidental or consequential damage so the above limitations or exclusions may not apply to you. This Warranty gives you specific legal rights and you may also have other rights which vary from state/province to state/province.

Manufacturer: Shenzhen Great Power Innovation And Technology Enterprise Co., Ltd. Manufacturer Address: No. 331, No. 335, Guiyue Road, Datu Community, Guanlan Street, Longhua District, Shenzhen

Distribution: Shenzhen Tianxingtai Optonics Technology Co., Ltd. Tel: 46-0755-21671965