

RETROSPEKT

# tx-90

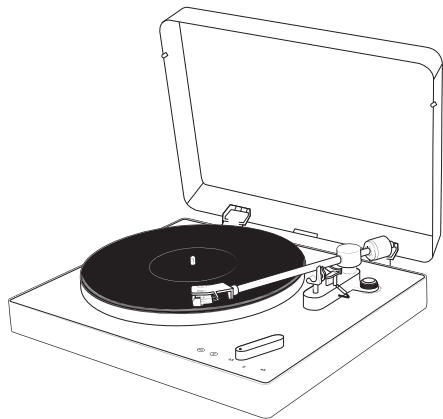

**BELT DRIVE TURNTABLE  
WITH BLUETOOTH®**

Please read this user manual completely before operating this unit, and retain this booklet for future reference.

## IMPORTANT SAFETY INFORMATION

**CAUTION:** To reduce the risk of fire or electric shock, do not expose this appliance to rain or moisture.

**WARNING:** To prevent electric shock, do not use this plug with an extension cord, receptacle or other outlet unless the blades can be fully inserted to prevent blade exposure.

Choose unit installation location carefully. Avoid placing it in direct sunlight or close to a source of heat. Also avoid locations subject to vibrations and excessive dust, cold or moisture. Keep away from sources that hum, such as transformers or motors.

Do not open the device as this may result in damage to the circuitry or electrical shock.

Be sure not to handle record with dirty fingers. Never play a record that has a crack on the surface.

When removing the power plug from wall outlet, always pull directly on plug, never pull cord.

To protect stylus, put white protective needle cover on over stylus after use.

Do not attempt to clean unit with chemical solvents as this might damage the finish.

Use a clean, dry cloth for cleaning.

In order to shut off power to this product completely, unplug the power cord from wall outlet. Unplug unit if you do not intend to use it for an extended period of time.

## LOCATION OF CONTROLS

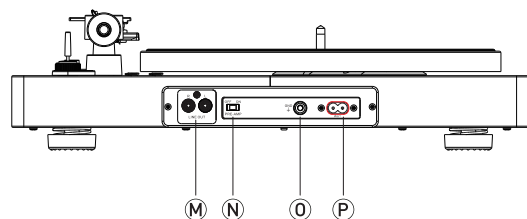
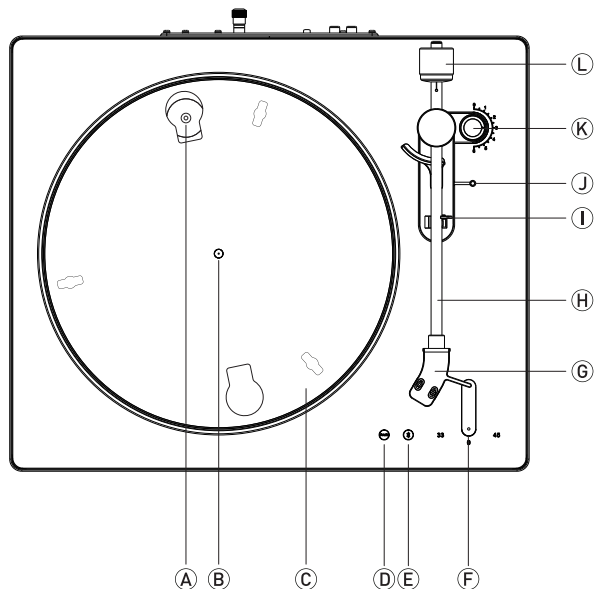

- |                          |                           |
|--------------------------|---------------------------|
| (A) Drive Pulley         | (I) Tone Arm Holder       |
| (B) Spindle              | (J) Tone Arm Lift Lever   |
| (C) Turntable Platter    | (K) Anti-skating Knob     |
| (D) Pair                 | (L) Counterweight         |
| (E) Bluetooth® Button    | (M) RCA Line Out          |
| (F) 33/Off/45 RPM Switch | (N) Pre-amp On/Off Switch |
| (G) Stylus               | (O) Ground Connection     |
| (H) Tone Arm             | (P) AC Power Socket       |

## SET-UP

---

The DRIVE BELT is pre-installed on the bottom of the TURNTABLE PLATTER, but you will need to connect it to the DRIVE PULLEY in order for the turntable to function properly.

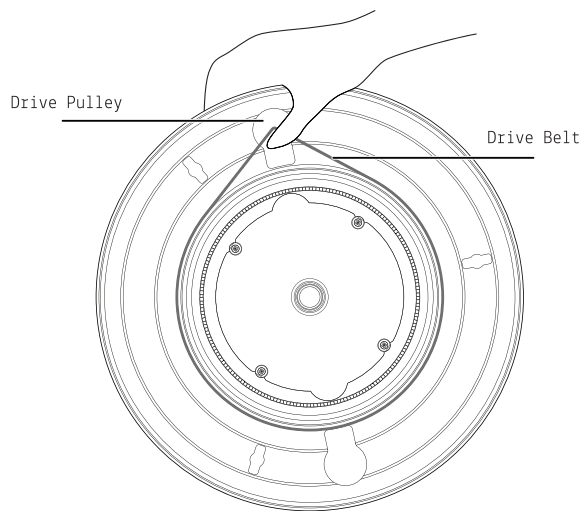

### Setting up DRIVE BELT:

Make sure DRIVE BELT is not twisted, then use your thumb to stretch it until it reaches round hole in platter.

*NOTE: Make sure you place the belt on metal track and not on section with teeth.*

Still holding belt, flip platter over, then place it onto spindle in center of turntable.

Align round hole in platter with DRIVE PULLEY then use your finger to hook belt onto pulley.

Place turntable mat on platter.

*NOTE: When removing platter from turntable, remove mat first, grasp platter and pull it upward.*

## POWER

---

Plug one end of power cord into AC POWER SOCKET on back of turntable, then plug other end into a power outlet.

### NOTES:

*We strongly recommended operating your turntable only from the type of power source indicated on the marking label.*

*To prevent interference, avoid bundling audio signal cables together with the AC power cord.*

## SPECIFICATIONS

---

Power Requirements AC 120 V ~ 60 Hz

Power Consumption 5 W

Dimensions (W x D x H) 440 x 384 x 127 mm (approx)

Weight 4.10 kgs

Motor DC servo motor

Drive System Belt Drive

Speeds Off/33-1/3 rpm, 45 rpm

Wow Flutter Less than 0.25% (WTD)

S/N Ratio 55 dB

Cartridge Type Moving Magnetic Cartridge (AT3600L)

RCA Out 200-280 mV (5 cm/sec at 1 KHz - 10 dB)

Phono Out 3-4 mv (5 cm/sec at 1 KHz - 10 dB)

### BLUETOOTH TRANSMITTER

Bluetooth Version Bluetooth v5.3

Bluetooth Profiles A2DP, AVRCP

Bluetooth Frequency Range 2.402 GHz - 2.480 GHz

Operating Distance 7 meters (30 ft.)

## DUST COVER

---

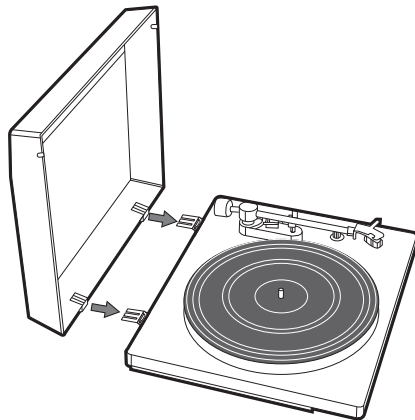
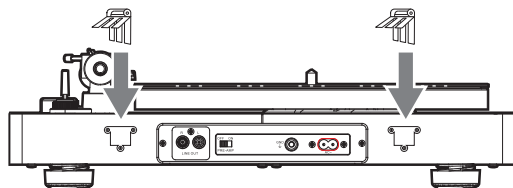

Install dust cover:

Insert dust cover hinges into hinge bases on back panel of unit.

Slide dust cover onto hinges.

## COUNTERWEIGHT

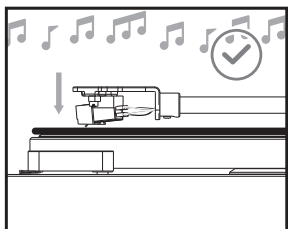
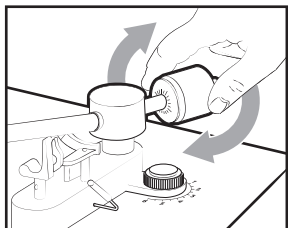
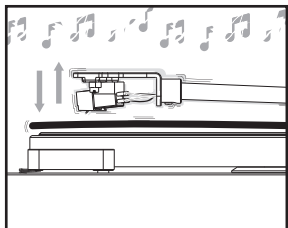

The COUNTERWEIGHT on the TONE ARM adjusts the needle pressure. If pressure is too much, sound is distorted. If pressure is too little, skipping can be more frequent.

Hold counterweight with black number ring towards you, then slightly push counterweight into end of tone arm. When you hear the second click counterweight has been installed correctly.

Remove stylus cover.

Set ANTI-SKATING KNOB to 0(zero).

Release lock catch, push tone arm lifter forward so tone arm leaves base, then push tone arm left to position above turntable. *CAUTION: Make sure needle does not contact any part of your turntable.*

Turn counterweight so tone arm is horizontal. You can move counterweight forward or backward on tone arm.

Hold counterweight to keep it from moving, then carefully rotate front black number ring so 0 is in 12 o'clock position. *Note: Do not turn counterweight. The black number ring turns separately.*

Hold both counterweight and black number ring together. Rotate them counter-clockwise one full circle, then set ring to 1.0 so 1.0 on dial is in 12 o'clock position. Then set tone arm to  $3.5 \pm 0.5$  grams of downward force (recommended tracking weight) for this needle.

## SPEAKERS

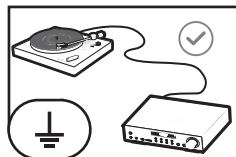
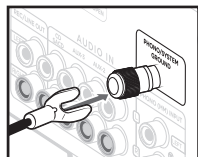
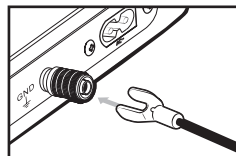
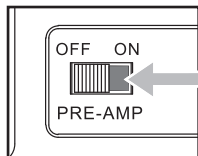
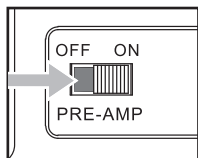
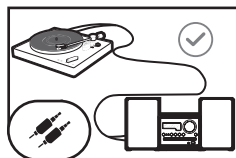
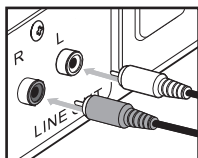

### RCA connection:

Plug red and white connectors on included RCA cable into RCA LINE OUT sockets on back of turntable – red to red, white to white.  
Plug other end of cable into your speakers – red to right speaker, white to left speaker.  
Toggle PRE-AMP SWITCH to select output mode.

## ON/OFF SPEED

Power off

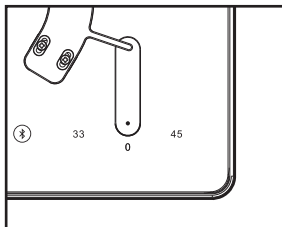

33 RPM

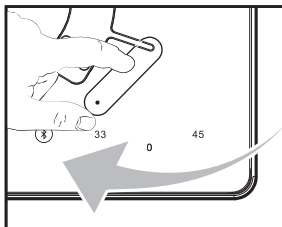

45 RPM

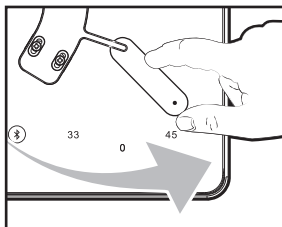

## OPERATING

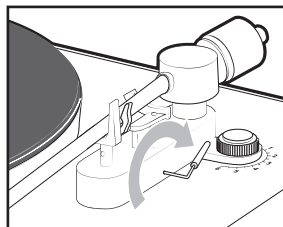
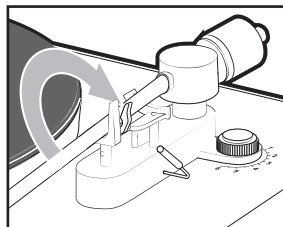
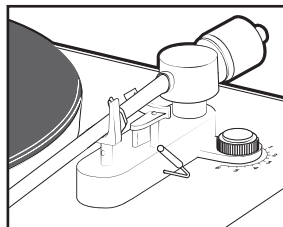

Gently open top cover.

Place a vinyl record on turntable. *NOTE: When playing a 45 RPM record, use included 45 RPM adapter.*

Select appropriate speed by turning RPM SWITCH to 33 or 45.

Remove tone arm-rest lock catch to release tone arm.

Push tone arm lifter forward to raise tone arm.

Gently push tone arm to left over turntable.

Push tone arm lifter backward to lower tone arm so stylus touches record and starts to play.

To pause or stop playing, push tone arm lifter forward to raise tone arm. *NOTE: When end of record is reached, rotation stops.*

When playing is completed, push tone arm lifter forward to raise the tone arm, then move arm back to tone arm rest. Push tone arm lifter down to lower tone arm.

## ANTI-SKATING

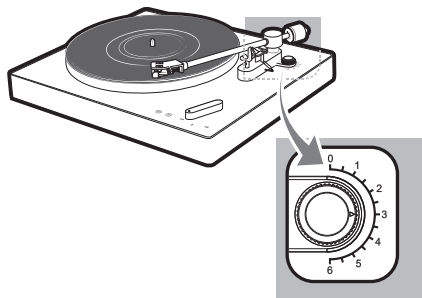

While adjusting ANTI-SKATING KNOB, leave tone arm and balance weight alone to prevent damage to stylus needle.

While record is playing, a small inward force pulls the tone arm towards center of record. If this force is too much, adjust the anti-skating knob to apply an outward force. Normally you should set anti-skating compensation to its minimum setting. If turntable is still experiencing excessive skipping while nearing the center spindle, try increasing anti-skating. Increase by one increment at a time, then test.

### NOTES:

*If a record can't playback entire tracks, we recommend resetting anti-skating knob to 0 (zero).  
In case of substantial use of back-cueing, scratching or reverse-direction operation, less – or no – anti-skate compensation may be preferred.*

## REPLACING THE STYLUS

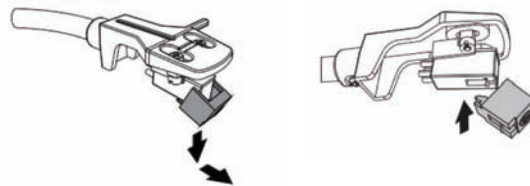

STYLUS should last about 300 hours under normal use. However, we recommend replacing it as soon as you notice a change in sound quality. Prolonged use of a worn-out stylus can damage records.

Turn RPM SWITCH to OFF to turn off power.

Remove stylus by pulling it downward and forward at same time.

Insert new stylus upwards into slot under head, then push upward until tip locks into place.

### CAUTION:

*Do not unnecessarily remove or bend stylus.*

*Do not touch needle.*

*Keep out of reach of children.*

Stylus part number: Audio-Technica AT3600L

## BLUETOOTH®

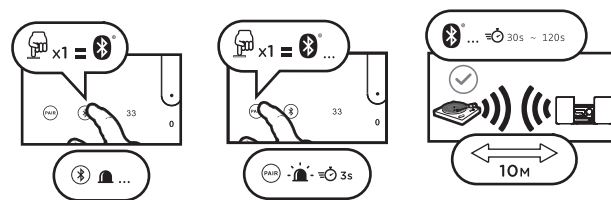

1. Turn on your home Bluetooth amplifier device.
2. Power on Bluetooth function by touching BLUETOOTH BUTTON. Pair indicator LED will flash.
3. When connected successfully, pair indicator LED will turn solid white.
4. Adjust the volume only by Bluetooth amplifier device.
5. Press **PAIR** button again to disconnect.

If external Bluetooth receiver can display a Bluetooth connection name, "TX-90" will be displayed



CLEANING

Only use a clean, dry cloth.  
Never use chemicals, detergents or abrasives.  
When not in-use, close the dust cover to prevent dust or other dirt from getting onto your turntable.

*CAUTION: Spilled liquids will damage your turntable. If something spills on the turntable, immediately wipe it clean with a soft, clean cloth.*

TROUBLESHOOTING

My turntable doesn't turn on.	Make sure Power cord is connected to turntable and working power outlet.
I don't hear sound from the speakers	Increase volume on external speaker.  If using LINE OUT socket, make sure RCA cable is connected correctly and securely.
The sound is noisy.	Turn off appliances (like a TV) near turntable or move it farther away from nearby appliances.
My turntable is on, but doesn't respond.	Remove power cord and all power supply devices, wait one minute, then plug turntable back into power outlet.
The sound is noisy when I use my turntable for a period of time.	Replace stylus.

My turntable won't pair with a Bluetooth device.	Press Bluetooth pairing button to ensure turntable is switched to transmitting mode.  Make sure Bluetooth speaker is turn on and in Bluetooth mode.  Move Bluetooth speaker closer to turntable.  See manufacturer's instructions included with Bluetooth speaker.
Bluetooth pairing failed.	Make sure Bluetooth speaker is not connected to another Bluetooth device. If it is connected to another device, turn off device or delete Bluetooth connection name from unit's list of devices.  Make sure Bluetooth speaker uses BQB-certified receiver.

WARNING:  
To reduce risk of fire or electric shock, do not expose this appliance to rain or moisture.

CAUTION:  
Use of controls or adjustments or performance of procedures other than those specified may result in hazardous radiation exposures.



To reduce risk of electric shock, do not remove cover or back.

No user serviceable parts inside. Refer servicing to qualified service personnel.

If this product is experiencing problems during operation, contact qualified service centers, and do not use the product in defective states.

The main plug is used as the disconnect device. The socket-outlet should be near the equipment and be easily accessible. The marking information is located at the bottom of device. The symbol with ~ indicates AC voltage.



This equipment is a Class II or double insulated electrical appliance. It has been designed in such a way that it does not require a safety connection to electrical earth.

This device complies with Part 15 of the FCC Rules. Operation is subject to the following two conditions: (1) This device may not cause harmful interference, and (2) this device must accept any interference received, including interference that may cause undesired operation.

NOTE: This equipment has been tested and found to comply with the limits for a Class B digital device, pursuant to Part 15 of the FCC Rules. These limits are designed to provide reasonable protection against harmful interference in a residential installation. This equipment generates uses and can radiate radio frequency energy and, if not installed and used in accordance with the instructions, may cause harmful interference to radio communications. However, there is no guarantee that interference will not occur in a particular installation. If this equipment does cause harmful interference to radio or television reception, which can be determined by turning the equipment off and on, the user is encouraged to try to correct the interference by one of the following measures:

- Reorient or relocate the receiving antenna.
- Increase the separation between the equipment and receiver.
- Connect the equipment into an outlet on a circuit different from that to which the receiver is connected.
- Consult the dealer or an experienced radio/TV technician for help.

WARNING: Any changes or modifications not expressly approved by the party responsible for compliance could void the user's authority to operate this equipment.

The device must not be co-located or operating in conjunction with any other antenna or transmitter.

To maintain compliance with the FCC's RF exposure guidelines, place the product at least 20cm from nearby persons.

The Bluetooth® word mark and logos are registered trademarks owned by Bluetooth SIG, Inc. and any use of such marks by Retrospekt LLC is under license. Other trademarks and trade names are those of their respective owners.

## SERVICE AND WARRANTY

This product has a limited 1-year warranty covering defects in materials and workmanship of the unit. This limited warranty excludes any damage caused by the owner modifying, attempting to fix, neglecting or otherwise altering the product. This limited warranty excludes parts and attachments that may be used with this product.

For all questions regarding use, warranty, servicing and troubleshooting of this device, contact:  
**service@retrospekt.com**

Visit us at:  
**RETROSPEKT.COM**

This product is distributed and sold by Retrospekt LLC.  
© 2024 All Rights Reserved.

811 E Vienna Ave  
Suite 100  
Milwaukee, WI 53212

service@retrospekt.com

MADE IN CHINA  
HECHO EN CHINA  
HERGESTELLT IN CHINA  
FATTO IN CINA

FABRIQUÉ EN CHINE  
WYPRODUKOWANO W  
CHINACH  
ن ق ي ص

