

## Appendix 5

**Prüfbericht - Nr.:**  
Test Report No.:

**14027270 001**

**Seite 6 von 7**  
Page 6 of 7

### User manual

**Illustrated instructions for assembling the car:**

**1** **Car body**

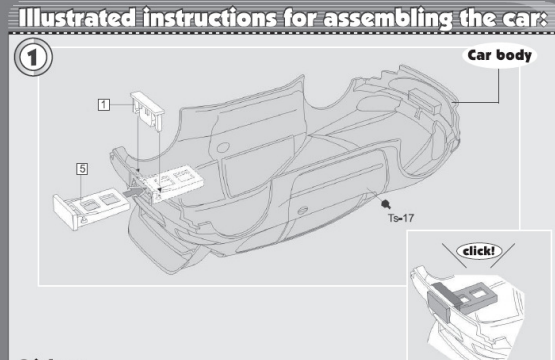

**Stickers**  
Paste the stickers according to the numbers on the sticker sheet.

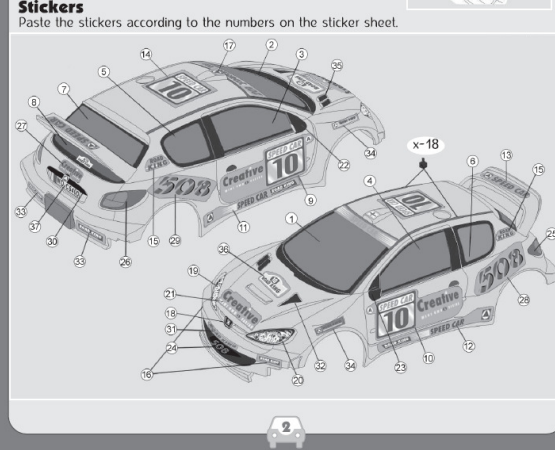

**2** **Note:** there are different types of gears.

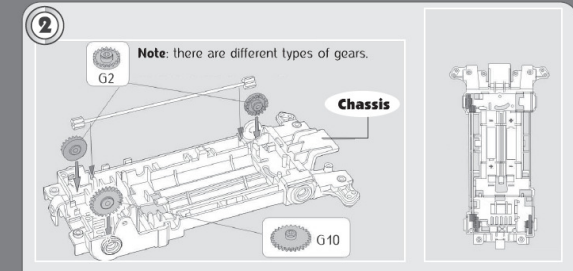

**3**

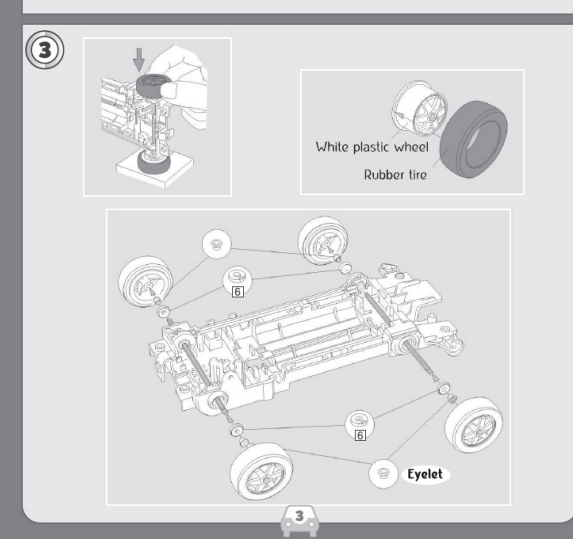

**4** **Attach the metal parts.**

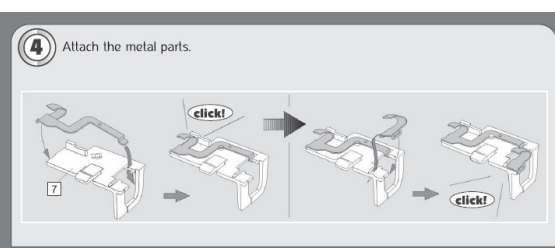

**5**

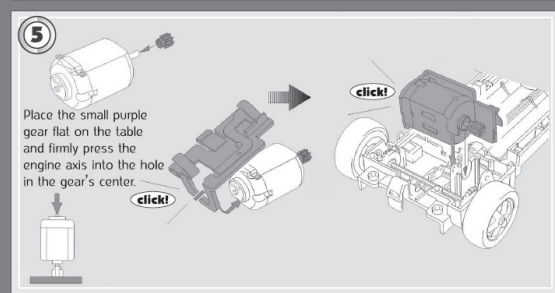

Place the small purple gear flat on the table and firmly press the engine axis into the hole in the gear's center.

**6** **Ratio between gears - 5:1**

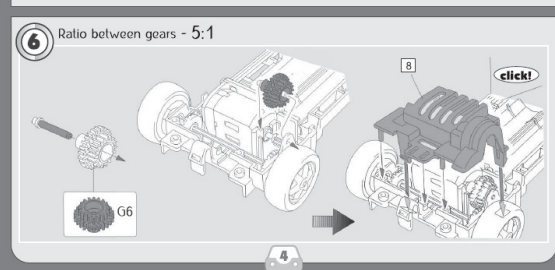

**7**

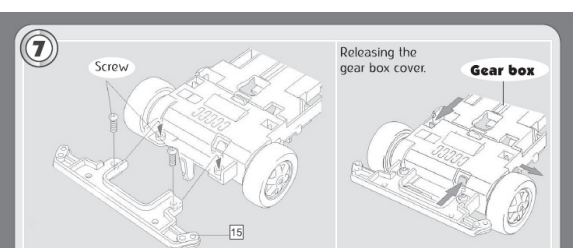

**8**

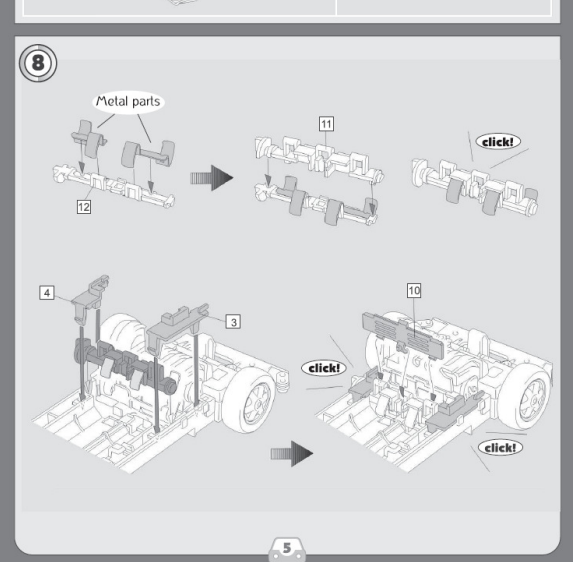

## Appendix 5

Prüfbericht - Nr.:  
Test Report No.:

14027270 001

Seite 7 von 7  
Page 7 of 7

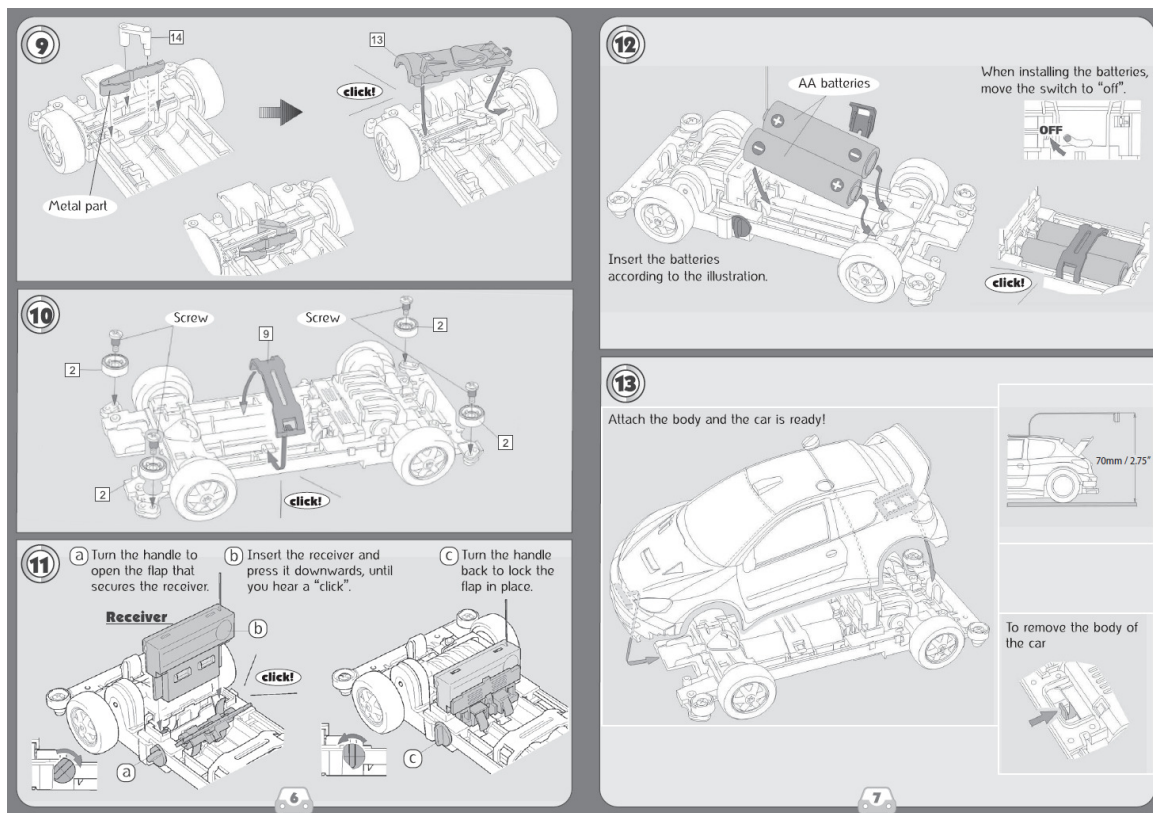

### Instructions for assembling the remote control

**Note:** Move the switch to "off" while installing the battery.

**1** Turn the remote control over and open the lid of the battery compartment.

**2** Insert the battery. Pay attention to the pole markings.

**3** Replace the lid.

**Caution:** Changes or modifications not expressly approved by the party responsible for compliance could void the user's authority to operate the equipment.

**Small World Creative**

Over 8 years

**Build a R/C SPORTS CAR**

**Requires one 9V and 2-AA batteries (Not included)**

- Do not mix old and new batteries.
- Do not mix alkaline, standard (carbon-zinc), or rechargeable (nickel-cadmium) batteries.

#9725400

**Contents**

- 1 wireless radio control unit
- 1 set of parts to assemble the sports car
- 34 colorful stickers to decorate the car
- 1 screwdriver

**General instructions** Read the instruction manual thoroughly prior to assembling the sports car.

In order to assemble the sports car, you will need a screwdriver (included), as well as a wire cutter or scissors, which are not included. When using a sharp tool, ask an adult for help. Be very careful not to cut yourself! You must have adult supervision when using these tools!

### Instructions for operating the car

**1** Pull the antenna up.

**2** First, switch on the remote control and then turn on the car, using the switch located bottom of the car.

**3** Hold the remote control with the antenna pointing towards the car.

**4** Now the car is ready to go... Press the upper button to move the car forward. Release the button to stop the car.

**5** Press the lower button to move the car backwards. Release this button to stop the car.

**6** When finished, first turn off the car switch, and only then turn off the remote control switch.

**7** Remove the batteries from the car and the remote control, until you want to play again. Make sure to keep all the parts together, so that they won't get lost.

**Note:** Changes in frequency may cause a sudden uncontrolled movement of the car, so make sure to turn off all the switches and remove the batteries when you are finished playing.

See you at [www.smallworldtoys.com](http://www.smallworldtoys.com)

### Important guidelines for operating the car:

- The car travels at a high speed and should be used with adult supervision at all times.
- Do not operate the car in the street, in crowded areas or close to other people.
- The car may heat up after prolonged use, so be careful when picking it up.
- Remove all obstacles that can damage the car or impede its progress.
- If a foreign object becomes lodged between the car wheels, the car may overheat.
- Turn off the car and remove the batteries from the car and the remote control unit when not in use.

### Instructions for assembling the car:

**1** Place all the parts in front of you.

**2** The plastic frame, holding all the black plastic components, is divided into small numbered parts. The number of each part is indicated next to it, on the frame. See figure 1. In the manual, all black plastic components are represented by a number in a square. Remove each piece from the plastic framework when required, according to the instructions.

**3** To remove a component, twist it back and forth until it separates from the frame. Ask an adult to help you by removing any remnants of the plastic tabs that connected the piece to the frame, with a knife or scissors.

**4** Whenever the word "click" appears in the instruction manual, the specified piece must be pressed firmly into place until a "click" is heard.