



Switching Your Phone On/Off

1. Press and hold the Power key for a few seconds to switch your phone on.
2. If the phone asks for a phone lock code, enter the phone lock code, and press OK. The default code is **1122**.
3. If the phone asks for a PIN code, enter the PIN code, and press OK. The PIN code is usually supplied with the SIM card. Please consult your network operator for more information.
4. Press and hold Power key for a few seconds to switch your phone off.

Making/Answering Calls

Enter the phone number (with the area code). According to your need, enter the country code or the extension number. Press the Pick up key to make a call.
To answer an incoming call, press the Pick up key or the left soft key. To end or reject an incoming/ongoing call, press the Hang up key.

Select Functions and Options

This mobile phone provides a series of functions for you to use and custom. These functions or options are arranged in the menu or submenu. You can use the left or right key to execute those functions indicated at the left or right of the prompt bar on the screen.

Using The Personal Handsfree Handset

Connect the handsfree handset to your mobile phone, you can still answer calls and use the microphone without holding the phone.

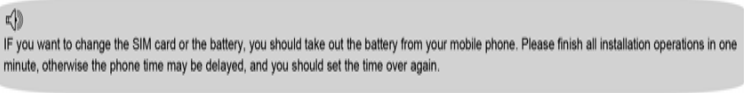

Phonebook

You can fast locate the number of the person you want to contact. Please enter the initial letter of the person's name, and related records about it will display in the middle of the screen. You can locate your records by up or down key and press OK key, and then you can view, send text message, send multimedia message, call and so on.

Call Center

Call history

Missed Calls: displays the list of recent missed phone numbers.

Dialled Calls: displays the list of recent dialed phone numbers.

Received Calls: displays the list of recent received phone numbers.

Delete Call Logs: You can delete all records of missed calls, dialed calls or received calls with this function or Delete all folders drastically.

Call timers:

Last Call: The last call time can be checked.

Dialled Calls: The total time for all dialed calls can be checked.

Received Calls: The total time for all received calls can be checked.

Reset All: Reset the counters.

Call Cost:

Last Call Cost: You can check the last call's fee.

Total Cost: You can check the whole call's fee.

Reset Cost: You can modify the call's fee, and reset the cost to 0. PIN2 code is required while modifying.

Max Cost: You can check and modify the upper limit. PIN2 code is required while modifying.

Price Per Unit: You can check and modify the call's rate. PIN2 code is required while modifying.

Note: This function is related with the SIM card. Some SIM cards don't support the function. PIN2 is provided from the network operator. Please consult your network operator to obtain the number.

Text message Counter:

Sent: You can check and clear the number of sent messages.

Received: You can check and clear the number of received messages.

Note: This function has nothing to do with the SIM card. The amount of sent or received messages will not change even if you change the SIM card.

GPRS Counter: you can check or reset the Last Sent, Last Received, All Sent, All Received and Reset Counter.

KNOW YOUR MOBILE PHONE

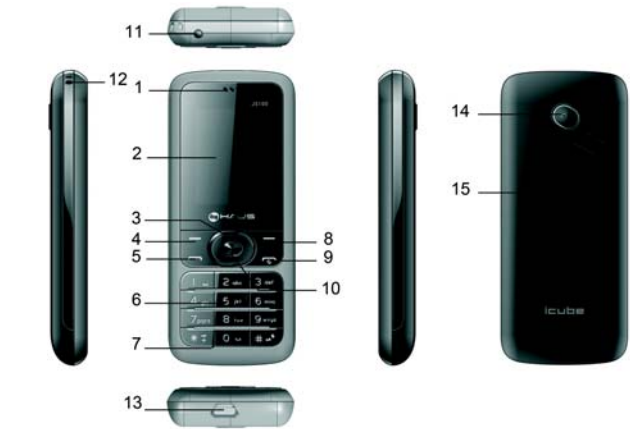

1. Earpiece	2. Screen	3. Direction key
4. Left Soft key	5. Pick up Key	6. Number keys
7. Microphone	8. Right Soft Key	9. Hang up / Power key
10. OK Key	11. Torch	12. Cord hole
13. Charger and Accessories connector	14. Camera	15. Battery Cover

Guidance On Entry Methods

This phone provides input methods of Multitap ABC (ABC), Multitap abc (abc), Numeric (123), etc., which can be used in editing the phone book, short messages, alarms and other text applications.

The icons of input methods:

- "123": The entry method of Numeric appears as: "123"
- "Gb ENG": The entry method of Multitap Smart ABC appears as: "Gb ENG"
- "Gb eng": The entry method of Multitap Smart abc appears as: "Gb eng"
- "Abc": The entry method of Multitap Abc appears as: "Abc"
- "ABC": The entry method of Multitap ABC appears as: "ABC"
- "abc": The entry method of Multitap abc appears as: "abc"

Switch Input Methods

Press # key to switch the input methods. e.g.: If the current input is Multitap ABC, the screen will show "ABC". Press # key, to go to Multitap abc, and the screen will show "abc".

Numeric Input Method

When the icon of the input method is "123", press the number keys to enter the numbers directly.

Multitap ABC and Multitap abc

When the icon is "ABC" or "abc", press the number keys (2 to 9) repeatedly until the desired letter appear in the text area. Press the number key once for the first letter. Press twice for the second letter. So, press number keys to reach the desired letter in the same way.

Input Special Symbols

If you want to input special symbols, such as ". ! ? = < >". Etc., please follow the steps as below:

Press the * key to display the symbols. Press the Up/Down, or Left/Right Key to move the cursor in the symbol table, and select one symbol. Press the right soft key to cancel the symbols selection.

Log(sequel)

Call settings

Caller ID: (Net work Service) You can select Set By Network, Hide ID or Send ID. The default status is the Set By Network.

Call Waiting > Activate, the network will notify you of a new incoming call while you have a call in progress (Net work Service).

Call Divert: This network service allows you to divert your incoming calls to another number. For details, contact your service provider.

Call Barring > Activate, this network service allows you to restrict incoming calls from your phone. For details, contact your service provider.

Close User Group > On, this network service specifies the group of people whom you can call and who can call you. For further information contact your network operator or service provider.

Advance settings:

Black List > On, you won't receive the calls from the numbers entered in the blacklist.

White list: you can set 20 numbers. When this white list is enabled, you can but receive the calls from the numbers entered in the White list.

Auto Redial > On, the phone will automatically redial the last called number after a while if you fail to connect to the number. The times for auto redial are up to 10 times. Press Cancel to end Auto Redial.

Call Time Display > On, the call time will display.

Call Time Reminder: This function prompts you to end the call in time to save the call cost. You can select Off, Single, or Periodic.

Auto quick end: Can set on or off and time of auto quick end.

Display Screen

Your mobile phone has a single screen display, which consist of three main areas:

- The first line displays status icons, which indicate the signal strength, the remaining power of the battery, etc.
- The middle lines display text and images, including numbers, text, animated icons and the information you enter.
- The last line displays the currently available operations assigned to the left or right soft key.

Status Icons

	Network Signal		Divert all Voice Calls
	Alarm clock is activated		Battery status
	Missed calls		New message or messages are full
	Ring Only		Vib. and Ring
	Vib. Only		Vib. then Ring
	Bluetooth		Locked

Note: The picture is for reference only, the product is subject to the real one.

Back Light

You can set the Back Light for the keypad through options in the menu. The backlight will be off automatically without any key operation after a while.

General Information

Antenna

Use of other antenna devices could damage your mobile phone and reduce performance. Your phone has a built-in antenna area unnecessarily when the phone is switched on. Contact with the antenna affects call quality and may cause the phone to operate at a higher power level than otherwise needed.

Network Service

A lot of features described in this manual are called network service. They are special services provided by wireless service providers. You should subscribe to these services from your home service provider and learn instructions on uses before you select the network you want to use.

Accessories

Li-Ion battery is the manufacturer-approved rechargeable battery available for your phone. Maybe some batteries perform best after several full charge/discharge cycles.
Use only batteries, chargers and accessories approved by the phone manufacturer for use with this particular model. The use of any other types will invalidate any approval or warranty applying to the phone, and may be dangerous. Please consult with your dealer for availability of approved accessories.

Phone Lock Code

The factory setting for the phone lock code is 1122. To avoid unauthorized use of your phone, you can change the code in the Settings > Security Settings. Remember your new code and write down in a safe place.

Settings



Settings

User Profiles

You can select General, Meeting, Outdoor, Indoor, Headset, Bluetooth and Power Saving.

Note: Insert the earphone to access the Headset mode automatically. This mode has no Activate option. Press # key to enable or cancel the silent mode. In the Silent mode, you can not hear any sounds except the vibration indicates a call or a message is coming.

Phone settings

1. Time and Date: You can set Time Zone, set Time/Date, set Format, and Update with time zone.

2. Schedule Power On/Off: You can set the time for auto power on/off.

3. Language: Select the desired language for the display text.

4. Preferred Input Methods: Select the desired input method for the default input method.

5. Display: You can configure the wallpaper, screen saver, Main menu style, Show date and time, and so on.

6. Dazzle Ringtone: You can set up to 10 songs in one time as your ring tone.

7. Dedicated Key: You can configure short cut functions for the Up, Down, Left and Right key respectively.

8. Auto Update of Date and Time: It can be set to ON or OFF. (Network Service)

9. Misc. settings:

LCD Backlight > According to various lighting conditions, you can select different Brightness and backlight time.

Network

You can configure the following options as desired: Network Settings (Automatic suggested), Data account.

Security settings

SIM Lock

You can make the security settings to prevent your phone or SIM card from unauthorized use.

The PIN code can prevent your SIM card from unauthorized use. If the PIN code is closed, you can open it to activate its protection. The phone will ask for the PIN code next time the phone is turned on. If the PIN code is opened, you can close it to deactivate its protection.

Mounting The SIM Card/ T-Flash Card

Keep all miniature SIM cards out of children's reach.

Please consult with your SIM card dealer on SIM card services and its usages. The SIM card dealer could be the service provider, network operator or other related dealers.

Note: Always make sure the phone is switched off before you insert or remove the SIM card, otherwise it may damage the SIM card.

1. Remove the battery cover by sliding it, insert the SIM card, with the gold contacts face down, into the card slot. Align the card to the arrow sign as the following picture shows:

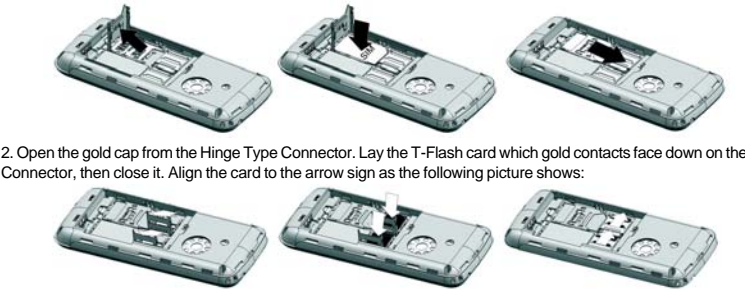

3. Replace the battery and close the cover tightly.

Charging The Battery

1. Connect the connector of the travel adapter to the phone.
2. Plug the travel adapter into a proper AC wall outlet.
3. When your phone indicates that the battery is fully charged, please pull the travel adapter out from the I/O socket of the phone.

Messaging

Only when your network operator supports this service, you can use the function.

SMS

1. Write Message: You can edit the SMS.

2. Inbox: The phone will prompt you when you receive a new message.

3. Outbox: This function is used to check messages in outbox.

4. Drafts: In the Drafts, please select Options, and then you can send, edit or select other operations.

5. Templates: Your phone saves messages both for SMS in common use. You can edit, remove or write message.

6. SMS Settings: You can configure the default information about SMS properties.

7. Schedule SMS: Press the left soft key to access the Add or Options > Add, and then you can set the date, time, message, Phone number. Press Done and Save the message will sent out the message to the number as your desire.

MMS

1. Write Message: You can edit the MMS message.

2. Inbox: The phone will prompt you when you receive a new MMS.

3. Outbox: This function is used to check MMS in outbox.

4. Drafts: This function is used to check messages in drafts.

5. MMS Settings: You can configure the default information about MMS properties.

Voice Mail Server

■ **Call Voicemail:** You can hear messages in the voice mailbox.

■ **Edit:** Input or modify the Name and the number of voice mailbox.

Note: This service is supplied by the network. It enables the caller to leave messages when you can't or unwilling to answer the incoming call. Please consult your network operator for more details.

Broadcast Message

This network service enables you to receive all kinds of text messages, such as weather reports or transportation information. Until now, there are several networks afford the service in this world. Please consult your network operator for more reference.

Settings(sequel)

Note: The SIM card will be locked if the inputs of PIN codes are wrong for three times. Then you need the PUK code to unlock the SIM card. The PIN code and PUK code are supplied together. If not, please contact your network supplier.

Phone lock

The phone lock can prevent your phone from unauthorized use.

The default password of the phone lock is **1122**; please change it into your personalized password. If you forgot the password of your phone, you would have to contact the distributor or the local service center to unlock your phone.

Auto Keypad Lock

The keypad will lock itself after the phone is unused for a specified time you set.

Fixed Dial

If activated, only the numbers set in the list or numbers started with the digits in the list can be made. (Require the support of SIM card.)

Note: Open or close the function of Fixed Calls requires the input of PIN2 code. Please contact your network supplier for the PIN2 code. Enter Fix Calls; numbers of fixed calls will appear in the directory.

Barred Dial

If this function is activated, the phone numbers in the barred dial list cannot be dialed. PIN2 is required for the function. Network support is also required.

Change Password

Change the passwords of PIN, PIN2 and phone password.

Note: Certain functions are provided by service provider.

Restore Factory Settings

All settings can be restored to factory settings with this function. The factory setting for the password is **1122**.

File manager

You can use the function to manage all types of files saved in the memory card and the phone.

Multimedia

Camera

During the view-findings mode, press the left soft key, to carry out the following operations:

Photos: To display the file list.

Camera Settings: To set some relative spec of the camera.

Image Settings: This includes photo size and photo quality adjustment.

White balance: To set the balance of light.

Scene Mode: To set the scene mode auto or night.

Effect Settings: To set special shot effect.

Storage: To set the default storage path.

Restore Default: Press the left soft key and select Yes to return to default settings.

Image viewer

Enter the "image viewer" to view the image files in the default folder "photos".

Video recorder

Press the "options" you can perform the following operations:

Camcorder Settings: To set some spec. of the video recorder.

Video Settings: To set some relative spec of the video recorder.

White balance: To set the balance of light.

Effect Settings: To set special shot effect.

Storage: To set the default storage path.

Restore Default: Press the left soft key and select Yes to return to default settings.

Fun & Games

You phone also provide you several funny games and applications. Most of them need the network support. Please contact with your dealer and your network operator for more information.

Services

STK Service

This service is offered as the SIM card service provided by the network operator.

Internet service

WAP enable you tour around the Internet world easily and pleasantly. Please follow the steps described as below:

1.Homepage: The default Internet Web Address.

2.Bookmarks: Save the Web address you often use.

3.Recent Pages: Records after you browse the Website.

4.Input Address: Press the left soft key to access Enter Address, and then input the web address to go to the Internet.

5.Service Inbox: Messages sent to users from the Web site.

6.Settings: You can configure Profiles, Browser Options, Service Message Settings, Clear Cache, Clear Cookies and Trusted certificates.

Data Account

- 1. GSM Data: Edit the GSM account.
- 2. GPRS: Edit the GPRS account.

Important Information (sequel)

Tips for Battery

- Placing the battery in hot or cold places, such as in a closed car in summer or winter, will reduce the capacity and lifetime of the battery.
- Do not let the metal contacts on the battery touch another metal contacts. It could short-circuit and damage the battery. Use the battery only for its intended purpose.
- Do not disassemble or modify the battery by yourself.
- Do not clean the battery with water or any organic solvent.
- Always keep the battery dry.
- The battery can be charged and discharged many times but it will wear out at last. When the talk and standby time is obviously shorter than normal, please change the original battery approved by manufacturer.
- Do not short-circuit the battery.
- Turn off the mobile phone before removing the battery.
- Do not dispose of batteries in fire.
- If you smell anything strange from the battery or find that the battery is overheated, you should stop using it immediately and contact the authorized Service Center in your region.
- If you don't use the battery for a long time, please fully charge the battery before you store it.
- Batteries should never be placed in municipal waste. Batteries must be recycled or disposed of properly. Please follow local regulations for disposal of batteries.

Usage & Maintenance

To keep your product working well, take a moment to review the following usage & maintenance tips, which will help you to fulfill any warranty obligations and help you to fulfil any warranty obligations and to enjoy this product for many years.

- Keep your phone and all its parts and accessories out of children's reach.
- Your products are not water-resistant. Keep it dry. Precipitation, humidity and liquids contain minerals that will corrode the connectors.
- Always treat your products with care and keep it in a clean and dust-free place.

Multimedia(sequel)

Video Player

You can perform the following operations:

Play: You can play the specified video.

Send: You can forward the video to MMS and to Bluetooth.

Rename: You can rename the specified video.

Delete: You can delete the specified video.

Delete All Files: You can delete all videos.

Sort by: You can sort all video files and display them in a new order; you can choose to Sort By Name, By Type, By Time, By Size and None.

Storage: To set the default storage path.

Audio Player

The Play, Stop, Back, Forward functions correspond to the Up, Down, Left and Right key respectively. Select **List** to access the **Play List**, and then select **Options** to perform the following functions:

Note: The current system does not support some MP3 with a non-standard format.

- 1. Play:**to play the specified music.
- 2. Details:** Filename, Size, Time, and so on.
- 3. Add to Ringtones:** You can use MP3 music as the ring tone for incoming calls.
- 4. Refresh List:** You can refresh the music file list of the memory card.
- 5. Settings:**

Pre. Play list: You can choose the Mp3 files in the Phone or in the memory card.

List Auto Gen. > On/Off, play the music saved in system/select music files from the File Manager to play.

Repeat: You can select Off, One or All.

Shuffle: You can select On/Off.

Background Play > On, the music will continue to play even if you exit the Playing Screen (music will stop when a call is coming).

BT Stereo output: You can select On/Off.

BT Stereo headset: You can activate Bluetooth Stereo headset function.

Note: Press the * / # to adjust the volume. Make sure that the volume is appropriate for your hearing while using the audio player. The Audio Player of the phone will automatically play music files from the "**My Music**" folder. You may need to refresh it manually from the settings in case you have earlier selected manual refresh settings.

Safety Precautions

Before using your phone, please read the following important information to eliminate or reduce any possibility of causing damage and personal injury.

	Do not use wireless phones while driving.
	Switch off wireless devices in aircraft. The signal may cause interference. Using them on aircraft is illegal.
	Do not use mobile phones where blasting is in progress. Follow regulations and rules strictly.
	Do not use mobile phones at refueling point. Don't use near fuel or chemicals.
	Follow regulations or rules in hospital and health care facilities. Switch phone off near medical equipment. All wireless devices may get interference that could affect performance.
	All wireless devices may get interference that could affect performance.
	Only qualified service personnel can install or repair this device.
	Use only approved accessories and batteries.
	Use only in normal position. Do not expose your phone to extreme high temperatures above +60 ° C (+140 ° F). Do not use anything static to clean your phone.
	Ensure the phone is turned on and in service. Enter the emergency number, then press Pick Up key. Give your location. Do not end the call until told to do so.

Important Information (sequel)

- Do not expose your product to extreme high or low temperatures. Your phone operates best in temperature between 15 ° C and 25 ° C. Minimum and maximum temperatures recommended by the manufacturer are -10 ° C and 55 ° C.
- Do not expose your product to open flames or lit tobacco products.
- Do not attempt to disassemble or modify your product. Only authorized personnel should perform service.
- Do not drop, throw or try to bend your product.
- Do not paint your product.
- Do not use harsh chemicals, cleaning solvents, or strong detergents to clean it.
- Keep anything magnetic, such as credit cards, far away from your product.
- If you find that the battery has any crack, deformation or anything else, you should stop using the battery immediately.
- If the electrolyte leak out and contact your skin or clothes, you should immediately use soap and clean water to clean it. In case the electrolyte spatters into your eyes, you must use the clean water to wash your eyes thoroughly and go to the hospital immediately.
- If your phone or any accessory doesn't function normally, please send them to the nearest authorized service facility. The qualified personnel there will assist you, and if necessary, arrange for service.

Emergency Calls

This phone, like any wireless phones, operates using radio signals, wireless and landline networks which cannot guarantee connection in all conditions. Therefore, you should never rely solely upon any wireless phone for essential communications (e.g. medical emergencies)

To make an emergency call:

1> Switch your phone on. Some networks may require that a valid SIM card is properly inserted in the phone.

2> Dial the official emergency number. Emergency numbers vary by location.

While making an emergency call, please remember to give all information as particularly as possible. Never hand off the call please until you are given permission to do so.

Multimedia(sequel)

Sound Recorder

The mobile phone supports 3 recording formats: AWB, WAV and AMR. You can record conversations, which may be saved to the Audio folder under File Manager. If there is a record, press the left soft key you can select: Play, Append (only for AMR), Rename, Delete, List, Settings, Use as and Send.

FM Radio

You can use your phone to listen to FM radio stations once the original Handset is plugged into the connector or antenna is opened.

Schedule FM Record

With this function, your phone can record the FM program as the schedules once the original Handset is plugged into the connector or antenna is opened. You can set On or Off, the date and time, repeat style, channel settings and record settings.

Melody Composer

The mobile phone enables you to compose your favorite music as the tune of the incoming call, alarm.

When the Tune Editing List is blank, you can edit your favorite tunes by pressing "Add". After you have finished the editing, press Option to select a music instrument or playing speed to play the editing tunes. You also can save the editing tunes.

Important Information

Use of Passwords

Your mobile phone and SIM card have various passwords. Those passwords avoid unauthorized use of your phone and SIM card. You can change PIN, PIN2 and phone password in the "Settings > Security Settings".

Phone Code

The Phone code can be used to avoid unauthorized use of your phone. The factory setting for the phone code is 1122. If phone lock is enabled, you will be asked to input the phone password when you switch on your phone.

PIN (4 to 8 digits)

The PIN (Personal Identification Number) code protects your SIM card unauthorized use. The PIN code is usually supplied with the SIM card. When the PIN code request is enabled, the password is asked every time the phone is turned on. Three times wrong PIN input, the SIM card will be locked and you will need to use the PUK to unlock it. PUK is usually set by the network operator.

1. Enter the correct PUK to unlock the SIM card, and then enter the new PIN and press OK.
2. If you are prompted to enter the new PIN again, enter it and press OK.
3. If the PUK is correct, the SIM card will be unlocked and the PIN will be reset.

PUK (8 digits)

The PUK (Personal Unblocking Key) code is required to change a blocked PIN code. Please contact your network operator for the code.



Note: Ten times wrong input in succession, the SIM card will be invalid and you need to consult with your network operator for a new SIM card.

PIN2 (4 to 8 digits)

The PIN2 code, supplied with some SIM card, is used for some functions, such as Call Cost, Fixed Dial and so on. Please consult your network operator to confirm whether your SIM card supports those services or not. Three times wrong PIN2 input, the SIM card will be locked and you will need to use the PUK2 to unlock it.

1. Enter the correct PUK2 to unlock PIN2, and then enter the new PIN2 and press OK.
2. If you are prompted to enter the new PIN2 again, enter it and press OK.

Troubleshooting

The section lists some problems that you might meet while using your phone. If you feel that your phone do not operate normally, please reset settings first, and then follow Troubleshooting Guide. If you are still unable to solve problems, please contact the authorized service center or the store from where you purchased the phone.

Problems	Solutions
Can not answer or make a call	<ul style="list-style-type: none">■ Make sure that the phone has been switched on.■ Make sure that the battery is charged.■ Make sure that the signal intensity is high enough.■ Make sure the own number function in the call setting is system preset or number sending.■ Make sure that the line switch in call setting is the system preset line.■ Check whether you have set up call barring or fixed dialing or any other safety function.■ Check whether you have set up call diverts. Check whether you nave inserted the proper SIM card correctly.
Low voice	<ul style="list-style-type: none">■ Check if the volume has been set too low.
No ring	<ul style="list-style-type: none">■ Check whether you have set up the "Silent" option.■ Check whether the ring volume is not too low.■ Move away from a noisy place to check if you can hear the phone ringing.■ Check whether you have set up call diverts.

Organizer

Bluetooth

You can transfer data, such as music to other device using Bluetooth. Search the device and accept/transfer data. The received data is automatically stored in the directory.

Calendar

You can view and edit the memo of a specified date with this function.

Tasks

You can View, Add, Edit, Delete, Delete overdue, Delete All, Jump to date, Send vCalendar and Save as file as desired. Start up the Memo and press OK. Press Option to access the next step to add a new memo.

Alarm

The mobile phone provides several alarms and you can set them as your need.

World Clock

Scroll to browse every city's time zones in the world map. The related date and time will display at the bottom of the screen.

Calculator

The calculator can add, subtract, multiply and divide. Press # key to enter the decimal point. Press the up, down, left, right and OK key to select +, -, ×, ÷, = respectively. Press Clear to delete the figure.

E-Book Reader

You can read E-book with ""*.TXT" format which is saved in the phone or Memory card.

Torch

You can turn On/ Off the flashlight function.

In the standby mode, long press the * Key to activate/ deactivate Flash Light.

Important Information (sequel)

PUK2 (8 digits)

The PUK2 code supplied with some SIM card is required to change a blocked PIN2 code. It may be supplied with the SIM card. If not, contact your network operator.



Note: Ten times wrong input in succession, the SIM card will be invalid and you need to consult with your network operator for a new SIM card.

Barring Code

To activate call barring, you need a Barring Code. You obtain the password from your service provider.

Battery Information

Information Charging and Discharging

- The charger is designed to be used in temperatures between 0 to 40 ° C.
- Do not charge the phone in wet and damp conditions.
- Use only batteries approved by the phone manufacturer and recharge your battery only with the charges approved by the manufacturer.
- We strive to produce products in compliance with global environmental standards.
- The charger meets the standard for safety of information technology equipment and office equipment use. It must be used for this purpose only.
- Your phone is powered by a rechargeable battery. Full performance of the battery is achieved only after two or three complete charge and discharge cycles.
- When the battery level is low, "Low Battery" will be display on the screen. If you have selected Alert Tone (Warning Tone of any profile in Profiles), the phone will sound the alert tone.
- When a charger is not in use, disconnect it from the power source. Do not leave the battery connected to a charger for longer than 12 hours, since overcharging may shorten its life.
- Temperature extremes will affect the ability of your battery to charge.

Available Accessories

Dual Stereo Personal Hands Free Handset

The Dual Stereo Personal Hands Free Handset allows you listen to music or to make conversations with hands free comfort.

Travel Charge

You can charge the phone with the Travel Charger when you are on the move.



Note: Please use approved accessories to get the most out of your phone.

Manual Statements

© 2011. All rights are reserved. No part of this document may be reproduced without permission. All trademark and brand names mentioned in this publication are property of their respective owners.

While all efforts have been made to ensure the accuracy of all contents in this manual, we assume no liability for errors or omissions or by statements of any kind in this manual, whether such errors are omissions or statements resulting from negligence, accidents, or any other cause. The contents of this manual are subject to change without notice.



Protect your environment! We strive to produce products in compliance with global environmental standards. Please consult your local authorities for proper disposal.

FCC STATEMENT

1. This device complies with Part 15 of the FCC Rules. Operation is subject to the following two conditions: (1) This device may not cause harmful interference. (2) This device must accept any interference received, including interference that may cause undesired operation.
2. Changes or modifications not expressly approved by the party responsible for compliance could void the user's authority to operate the equipment.

NOTE: This equipment has been tested and found to comply with the limits for a Class B digital device, pursuant to Part 15 of the FCC Rules. These limits are designed to provide reasonable protection against harmful interference in a residential installation. This equipment generates uses and can radiate radio frequency energy and, if not installed and used in accordance with the instructions, may cause harmful interference to radio communications. However, there is no guarantee that interference will not occur in a particular installation. If this equipment does cause harmful interference to radio or television reception, which can be determined by turning the equipment off and on, the user is encouraged to try to correct the interference by one or more of the following measures:

Reorient or relocate the receiving antenna.

Increase the separation between the equipment and receiver.

Connect the equipment into an outlet on a circuit different from that to which the receiver is connected.

Consult the dealer or an experienced radio/TV technician for help.

Body-worn Operation

This device was tested for typical body-worn operations. To comply With RF exposure requirements, a minimum separation distance of 1.5cm must be maintained between the user's body and the handset, including the antenna. Third-party belt-clips, holsters, and Similar accessories used by this device should not contain any metallic components. Body-worn accessories that do not meet these requirements may not comply with RF exposure requirements and should be avoided.

Certification information (SAR)

Your model wireless phone meets the governmental requirements for exposure to radio waves. Your mobile device is a radio transmitter and receiver. It is designed and manufactured to not exceed limits for exposure to radio frequency (RF) energy set by the Federal Communications Commission (FCC) of the U.S. overnment and by the Canadian regulatory authorities. These limits are part of comprehensive guidelines and establish permitted levels of RF energy for the general population. The guidelines are based on standards that were developed by independent scientific organizations through periodic and thorough evaluation of scientific studies. The standards include a substantial safety margin designed for the safety of all persons, regardless of age or health, and to account for any variations in measurements. The exposure standard for mobile devices employs a unit of measurement known as the Specific Absorption Rate (SAR). The IEEE SAR limit set by the FCC and by the Canadian regulatory authorities is 1.6 watts per kilogram (W/kg), averaged over one gram of tissue. Tests for SAR are conducted using procedures

accepted by the FCC and by Industry Canada with the mobile device transmitting at its highest certified power level in all tested frequencies. Although the SAR is determined at the highest certified power level, the actual SAR level of the mobile device while operating can be below the maximum value. This is because the mobile device is designed to operate at multiple power levels so as to use only the power required to reach the network. In general, the closer you are to a wireless base station, the lower the power output. Before a mobile device is available for sale to the public in the U.S. and Canada, it must be tested and certified to the FCC and Industry Canada that it does not exceed the limit established by each government for safe exposure. The tests are performed in positions and locations (e.g., at the ear and worn on the body) submitted to the FCC and available for review by Industry Canada. The highest SAR value for this mobile device when tested for use at the head is 850/1900: 0.355 W/kg, and when worn on the body, as described in this guide, is 850/1900: 0.756 W/kg. Body-worn measurements can differ, depending upon available accessories and regulatory requirements. The SAR information includes the Motorola testing protocol, assessment procedure, and measurement uncertainty range for this product. While there may be differences between the SAR levels of various mobile devices and at various positions, they meet the governmental requirements for safe exposure. Please note that improvements to this product model could cause differences in the SAR value for later products; in all cases, products are designed to be within the guidelines.