

Brookstone®

Wireless TV Earphones

ENJOY THE SHOW-WITHOUT
DISTURBING OTHERS



Fold

LITHIUM-ION BATTERY WARNINGS

This device contains a non-removable lithium-ion battery. The battery must be recycled or disposed of properly. Contact your local waste management office for information on battery recycling or disposal.

FCC INFORMATION

This equipment has been tested and found to comply with the limits for a Class B Digital Device, pursuant to Part 15 of the FCC Rules. These limits are designed to provide reasonable protection against harmful interference in a residential installation. This equipment generates, uses, and can radiate radio frequency energy and, if not installed and used in accordance with the instructions, may cause harmful interference to radio communications. However, there is no guarantee that interference will not occur in a particular installation. If this equipment does cause harmful interference to radio or television reception, which can be determined by turning the equipment off and on, the user is encouraged to try to correct the interference by one or more of the following measures:

Fold

- Reorient or relocate the receiving antenna.
- Increase the distance between the equipment and receiver.
- Connect the equipment to an outlet on a circuit different from that to which the receiver is connected.
- Consult the dealer or an experienced radio/TV technician for help.

This device complies with Part 15 of the FCC Rules. Operation is subject to the following two conditions:

1. This equipment may not cause harmful interference.
2. This equipment must accept any interference received, including interference that may cause undesired operation.

Modifications not authorized by the manufacturer may void the user's authority to operate this device. This equipment complies with FCC RF radiation exposure limits set forth for an uncontrolled environment. This transmitter must not be co-located or operating in conjunction with any other antenna or transmitter.

FCCID: ZRH-20151215

Fold

LOCATION OF PARTS AND CONTROLS

1. Earphones
2. Transmitter
3. Volume Dial
4. Power Switch
5. Tone Dial
6. Balance Knob
7. LINE-IN Port
8. Battery Door Cover
9. MIC-IN Port
10. CHANNEL Button
11. Power LED
12. RF Reception LED
13. Power Switch
14. DC-IN Port
15. AUDIO- IN Port
16. MIC-IN Port
17. SCAN Button
18. Charging Pins/Contacts
19. Power LED
20. Audio LED
21. Microphone
22. Li-ion Rechargeable Battery
23. AC/DC Adapter
24. Audio Cable
25. 3.5mm(female)-to-RCA(male) Y-Cable

Fold

LOCATION OF PARTS AND CONTROLS (EARPHONES)

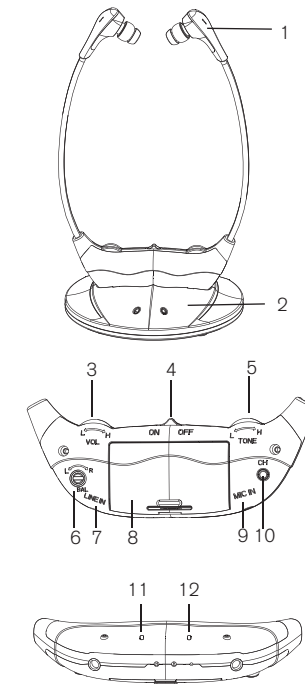

Fold

LOCATION OF PARTS AND CONTROLS (TRANSMITTER)

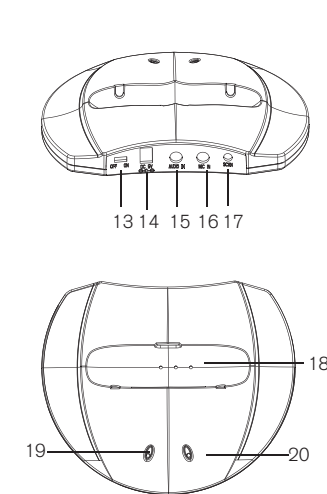

LOCATION OF PARTS AND CONTROLS (ACCESSORIES)

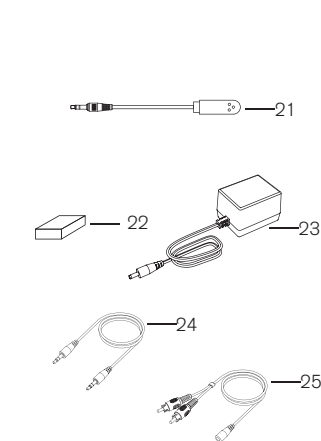

Brookstone®
A WORLD OF INNOVATION

Since 1965, people have come to Brookstone to see what's new, discover smart solutions to everyday problems—and have some fun. At Brookstone, we believe there's always a better way to do things. And we created a world of innovation to prove it.

311673
Merrimack, New Hampshire, USA 03054
800-846-3000 • Brookstone.com

CHARGING THE EARPHONES

1. Carefully open the Battery Door Cover and insert the Li-ion Battery (included) according to the polarity markings. Replace the Battery Door Cover.

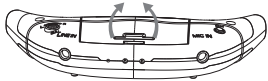

2. For first time use, charge the Earphones for at least 12 hours. To charge earphones, ensure the earphones are OFF by sliding the Power Switch to OFF on earphones until the two LEDs are off. Place the earphones on the top of transmitter ensuring the charging contacts are aligned. When the earphones are fully charged the Power LED is solid GREEN.

TRANSMITTER SET UP

1. Plug the AC/DC power adapter into the DC Port located on the rear of the transmitter. Plug the other end of the AC/DC power adapter into an electrical wall outlet.

2. Slide the Power Switch to ON . The transmitter's Power LED is solid GREEN.

NOTE: If the earphones are docked on the transmitter and in low battery, the transmitter's Power LED is solid ORANGE. The earphones are being charged.

3. Connect the transmitter to an audio source using the included RCA and audio cables.

4. When the transmitter receives an audio signal, the AUDIO LED is solid GREEN.

If no audio signal is detected, the AUDIO LED is solid ORANGE.

NOTE:

Plug in the included external microphone in the MIC-IN Port at the rear of the transmitter to perform monitoring function.

USING THE EARPHONES WITH TRANSMITTER

1. To turn the earphones on, slide the Power Switch to ON. The Power LED is solid RED.

2. The earphones will automatically sync to the transmitter when the transmitter is with audio signal in. When the earphones are attempting to set up a connection with the transmitter, the Power LED will blink RED. When the earphones and transmitter are synced, the earphones' RF LED is solid BLUE and the transmitter's AUDIO LED is GREEN.

3. Use the Volume Dial on the earphones and the audio source to change the volume.

4. Adjust the Tone Dial to your desired bass performance.

5. Use the Balance Knob to adjust sound clarity of the right and left channels.

6. After 5 minutes of no audio signal detected, the AUDIO LED on transmitter turns solid ORANGE should be earphones power LED blinking RED.

7. To turn the earphones off, slide the Power Switch to OFF. The LEDs will turn off.

Note:

Insert the external microphone to the MIC-IN Port at the bottom of the earphones, audio signal will be paused and now the earphones perform as a hearing aid device. Audio signal resume when the microphone is unplugged.

USING THE EARPHONES WITH THE DIRECT PLUG

1. Connect the earphones directly to an audio source by plugging one end of a 3.5mm-to-3.5mm cable (included) into the AUX-IN Port at the bottom of the earphones and other end into the audio source.

2. Use the volume controls on the audio source to change the volume.

Note:

When using a 3.5mm-to 3.5mm cable, the two LEDs are off.

TROUBLE SHOOTING NO SOUND

- Ensure the AC/DC adapter is securely plugged into the transmitter.
- Ensure the earphones are powered on.
- Ensure the earphones and the transmitter are synced.
- The earphones may need to be charged.
- The earphones may need to move closer to the transmitter.
- Ensure the audio device is switched ON.
- The volume of the audio device may need to be increased.
- If there is interference or poor signal reception, audio from the earphones will mute and the Power LED will flash RED. Press the SCAN Buttons on transmitter and CHANNEL Button on earphones at the same time for 10 seconds until the earphones' RF LED turn SOLID BLUE again.

CARE AND STORAGE

1. Dust the earphones and transmitter with a soft, dry cloth.
2. Store the earphones and transmitter in a cool, dry place.

SPECIFICATIONS

Power Supply (Transmitter):

DC 5V, 500mA

Power Supply (Earphones):

3.7V 420mAh

Frequency: 2.402-2.480 GHz Digital

Transmission mode: GFSK

Range: Up to 100ft/30m & 75ft/25m

with some obstructions

S/N Ratio: 75dB

Frequency Response: 30Hz~20KHz

Charging Time: Approx. 3 hours

(subsequent uses after first initial charge of 12 hours)

Battery Life: Approx. 8 hours

ONE (1) YEAR LIMITED WARRANTY

Brookstone® warrants this product against defects in materials and/or workmanship under normal use for a period of ONE (1) YEAR from the date of purchase by the original purchaser ("Warranty Period"). If a defect arises and a valid claim is received within the Warranty Period, at its option, Brookstone will either 1) repair the defect at no charge, using new or refurbished replacement parts, or 2) replace the product with a new product that is at least functionally equivalent to the original product, or 3) provide a store credit in the amount of the purchase price of the original product. A replacement product or part, including a user-installable part installed in accordance with instructions provided by Brookstone, assumes the remaining warranty of the original product. When a product or part is exchanged, any replacement item becomes your property and the replaced item becomes Brookstone's property. When a store credit is given, the original product must be returned to Brookstone and becomes Brookstone's property.

Obtaining Service: To obtain warranty service, call Brookstone Limited Warranty Service at 1-800-292-9819. Please be prepared to describe the product that needs service and the nature of the problem. A purchase receipt is required. All repairs and replacements must be authorized in advance. Service options, parts availability and response times will vary. You are responsible for delivery and the cost of delivery of the product or any parts to the authorized service center for replacement, per our instructions.

Limits and Exclusions: Coverage under this Limited Warranty is limited to the United States of America, including the District of Columbia and the U.S. Territories of Guam, Puerto Rico, and the U.S. Virgin Islands. This Limited Warranty applies only to products manufactured for Brookstone that can be identified by the "Brookstone" trademark, trade name, or logo affixed to them or their packaging. The Limited Warranty does not apply to any non-Brookstone products. Manufacturers or suppliers other than Brookstone may provide their own

warranties to the purchaser, but Brookstone, in so far as permitted by law, provides these products "as is." This warranty does not apply to: a) damage caused by failure to follow instructions relating to product's use or the installation of components; b) damage caused by accident, abuse, misuse, fire, floods, earthquake or other external causes; c) damage caused by service performed by anyone who is not a representative of Brookstone; d) accessories used in conjunction with a covered product; e) a product or part that has been modified to alter functionality or capability; f) items intended to be periodically replaced by the purchaser during the normal life of the product including, without limitation, batteries or light bulbs; g) any product sold "as is" including, without limitation, floor demonstration models and refurbished items; or h) a product that is used commercially or for a commercial purpose.

BROOKSTONE SHALL NOT BE LIABLE FOR INCIDENTAL OR CONSEQUENTIAL DAMAGES RESULTING FROM THE USE OF THIS PRODUCT, OR ARISING OUT OF ANY BREACH OF THIS WARRANTY. TO THE EXTENT PERMITTED BY APPLICABLE LAW, BROOKSTONE DISCLAIMS ANY AND ALL STATUTORY OR IMPLIED WARRANTIES, INCLUDING, WITHOUT LIMITATION, WARRANTIES OF MERCHANTABILITY, FITNESS FOR A PARTICULAR PURPOSE AND WARRANTIES AGAINST HIDDEN OR LATENT DEFECTS. IF BROOKSTONE CANNOT LAWFULLY DISCLAIM STATUTORY OR IMPLIED WARRANTIES, THEN TO THE EXTENT PERMITTED BY LAW, ALL SUCH WARRANTIES SHALL BE LIMITED IN DURATION TO THE DURATION OF THIS EXPRESS WARRANTY.

Some states disallow the exclusion or limitation of incidental or consequential damages or how long an implied warranty lasts, so the above exclusions or limitations may not apply to you. This warranty gives you specific legal rights and you may also have other rights, which vary from state to state.