

FOOT WARMING SYSTEM



INSTRUCTIONS



www.conform-able.com

PRO Remote

BATTERY PACK

FOR CONFORM'ABLE
HEATING INSOLES

BATTERY RECHARGING PROCESS

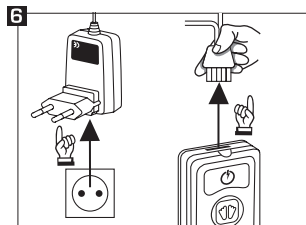
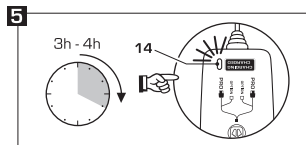
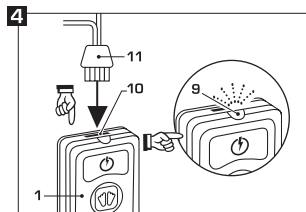
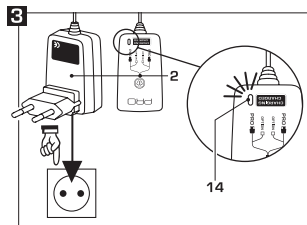
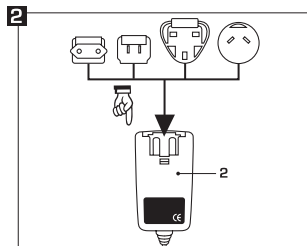
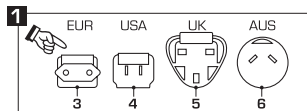

DRYING OPTION PROCESS

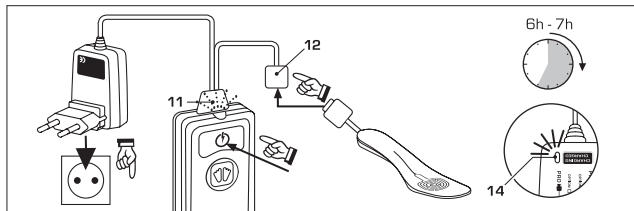

ACCESSORY OPTION



MANUAL USE

DIRECTIONS FOR USE

1

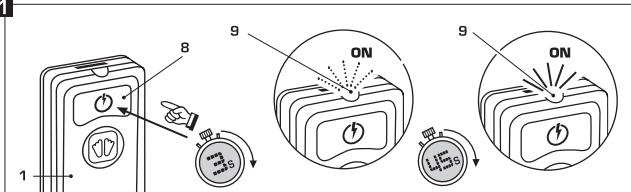

2

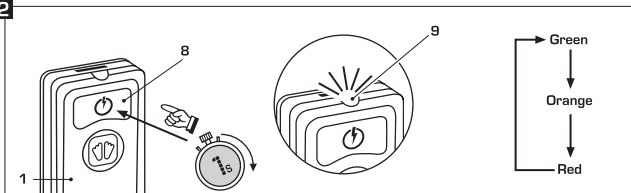

3

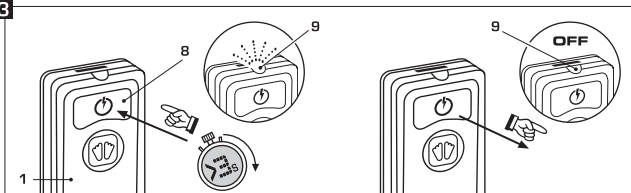

REMOTE USE

DIRECTIONS FOR USE

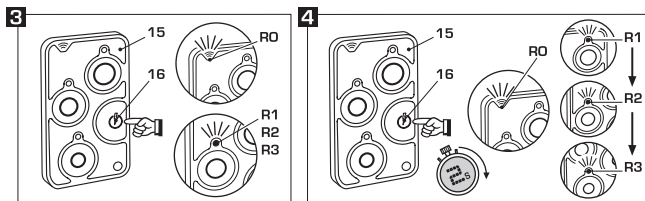
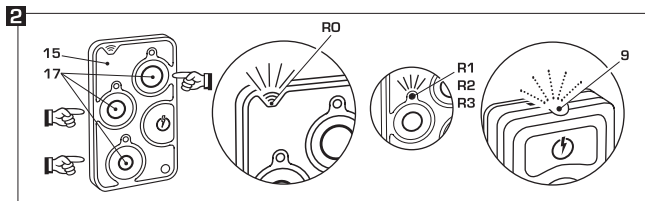
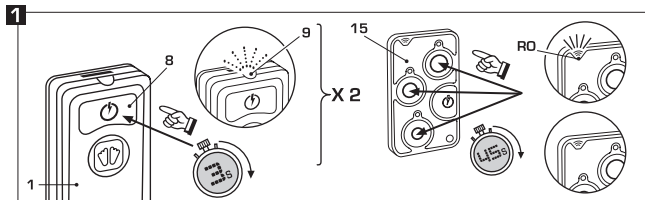



Congratulations on your purchase of the PRO Remote Conform'able battery pack.
Please read these instructions carefully before using the equipment.
For a detailed manual log on to www.conform-able.com.

NB: PRO Remote Conform'able batteries operate only with Conform'able heating insoles, and the accessories of the Conform'able product range.

Description of the PRO Remote pack

- 1- PRO Remote battery x 2 units.
- 2- Charger x 1 unit.
Input: 400 mA / 100-240 V / 50-60 Hz.
Output: 1 A max. / 8.4 V.
- 3- EUR connector x 1 unit.
- 4- USA connector x 1 unit.
- 5- UK connector x 1 unit.
- 6- AUS connector (optional).
- 7- Fastening clip x 2 units.
- 8- ON/OFF button and mode selection.
- 9- Mode indicator lamp.
- 10- Connector for heating insoles or charger.
- 11- Connector for recharging PRO Remote batteries.
- 12- Connector for the other options.
- 13- Rating plate with serial number.
- 14- Charger status indicator.
- 15- Remote control for the Pro Remote packs
- 16- ON/OFF button for the remote
- 17- Mode selection button
- 18- Strap to attach the remote
- R0/R1/R2/R3-** mode indicator lamp of the remote

Safety instructions

- Person(s) who cannot feel the effects of heated insoles may cause injury to themselves by using this product.
- Excessive use at high settings can cause severe burns.
- This equipment should only be used by children under the guidance of an adult.

- To prevent moisture from entering the battery case, ensure the insoles are connected at all times.
- Do not attempt to use the battery pack if any part (case / charger / connector / etc.) becomes damaged. Contact your nearest dealer for assistance.
- All repairs must be performed by the company SIDAS or their authorized agents.
- Battery packs may explode if exposed to excessive heat.
- Never try to open a battery unit. You risk an explosion in the event of incorrect handling of the lithium-ion batteries! You also risk damaging the battery electronics.
- The batteries should not be left within reach of children, thrown into the fire or dismantled.
- In the event of ingestion, contact a doctor immediately.
- In the event of battery acid contact with eyes, skin or clothing, rinse thoroughly with water and contact a doctor immediately.
- Always remove used batteries from the device and dispose of them, because the battery acid could damage the batteries if released.

Start-up

Before any use, make sure that the PRO Remote batteries are fully charged. To charge the PRO Remote batteries, follow the instructions in the "Battery recharging" section below.

Attaching PRO Remote batteries

If your boot has a strap of maximum width 55 mm:

- Attach the PRO Remote batteries using the metallic clip onto the boot strap.

If your boot is not fitted with a strap:

- Attach your batteries safely with the Conform'able Velcro strap (accessory not supplied).
- Use your batteries for any outdoor activity, placed in a pocket (of the trousers or jacket, for example) using the Conform'able extension cable (accessory not supplied).
- Attach your battery to your belt or any other holder with the metallic battery clip, the Conform'able clipfix (accessory not supplied).

Attaching the remote

Attach your remote with the strap (accessory supplied) or place your remote in one of your pockets (pants, jacket).

You can see the accessories on the www.conform-able.com site or at your specialist dealer.

Important note: Do not attach the PRO Remote batteries to smooth or slippery areas to avoid losing them!

Battery recharging

- 1- Select the charger connector appropriate for the mains supply of your installation:
Connector 3, 4, 5 or 6.
- 2- Connect this connector to the charger.
- 3- Connect the charger to the mains supply: indicator light 14 lights green.
- 4- Connect the charger connectors 11 to the connectors 10 of the PRO Remote batteries.
Indicator light 9 flashes, 14 becomes red.
- 5- At the end of charging, indicator light 14 on the charger lights green.
- 6- Disconnect the charger from the mains, then disconnect the batteries from the charger.
Charging time: 3-4h without drying option.

Drying options

During the charging cycle, you can connect a drying option (Conform'able insole, or accessory) to the charger (connectors 12).

The power supply for this option is provided during battery charging, in AC.

Indicator light 14 on the charger remains red.

Charging time: 6-7h with drying option. The light 14 will stay red in this configuration, and the pack will be loaded at 95% of its capacity.

NB

- PRO Remote batteries should be recharged exclusively with the charger supplied in this pack.
- Recharging should be performed indoors in a dry place.
- PRO Remote batteries should be recharged after each use and before each storage.
- You can switch off the PRO Remote batteries during charging without affecting this function.
However, the optional functions (drying) will be suspended.

Operating manual mode

- 1- *To switch on your PRO Remote battery:* Press for 3 s on button 8: indicator light 9 flashes and then lights green. Mode 1 is active.
- 2- *To change mode, from any mode:* Press for 1 s on button 8: indicator light 9 changes colour depending on the mode.
- 3- *To switch off your PRO Remote battery from any mode:* Press for more than 3 s on button 8: indicator light 9 flashes and then goes out when you release it.

After changing modes, indicator light 9 will light up continuously in the colour selected for 10 seconds and will then flash to save battery power.

Using PRO batteries

Each PRO battery has 3 heating modes:

<u>Mode</u>	<u>Status of light 9</u>	<u>Battery life</u>
1	Green	up to 8h
2	Orange	up to 6h
3	Red	up to 4h

Operating mode with your remote

1- To connect your remote to the PRO Remote batteries:

- Press for 3 s on button 8 of the 1st battery: indicator light 9 flashes and then lights alternatively green / blue. Do the same operation with the 2nd battery.
- In the next 45 s, press on any button of the remote: indicator light R0 lights and then switches off.

2- To change mode of your PRO Remote batteries:

- Press on button corresponding to the requested mode: indicator light R0 lights then the indicator light of the selected mode lights for 5 s.
- At the same time, indicator light 9 of both batteries changes colour depending on the elected mode for 5s, then flashes alternating colour of the selected mode / blue.

3- To know which mode is selected:

- Press briefly on "flash" button of your remote; indicator light R0 lights, then the corresponding light indicator of the operational mode (R1 or R2 or R3) lights 5s.

4- To switch off your batteries:

- Press for 2s on "flash" button of your remote; indicator light R0 lights, then R1 or R2 or R3 light alternatively, to finally switch off.

5- To turn off battery operation from any mode:

- Press button 8 for more than 3 seconds: indicator light 9 will flash and will go out when you let go.

Using PRO Remote batteries

Each PRO Remote battery has 3 heating modes:

<u>Mode</u>	<u>Status of light 9</u>	<u>Battery life</u>
1	Green	up to 8h
2	Orange	up to 6h
3	Red	up to 4h

The heating period per charge is between 4h and 8h depending on the heating mode selected, the ambient temperature, the charge level and the age of the storage batteries.
If you find that the heating period decreases, it may be necessary to replace the PRO Remote batteries. Contact your specialist dealer or our after sales service department.

Storage

To extend the service life of PRO Remote batteries as long as possible, we recommend that you store them in a dry, cool place (from 5°C/41°F to 20°C/68°F), after having charged them half full.

The PRO Remote batteries should be stored after being switched off (indicator lamp 9 extinguished) and disconnected from the Conformable heating insoles and the charger. In the event of prolonged storage, the batteries should be discharged at least every six months, then recharged half full (about 1h).

In this way, the storage batteries keep their maximum properties for several years.

If necessary, clean the parts with a slightly moist soft cloth and a mild cleaning agent.

NB: Before each cleaning operation, disconnect the charger from the connector.

Scrapping

When the device has reached the end of its life cycle, scrap it with its packaging in compliance with environmental protection rules.

Do not throw the charger and the PRO Remote batteries into the household refuse or into the fire, but deposit them at an electronic waste collection point.

The packaging materials are recyclable raw materials. Send them to a recycling centre. For more details, consult the local authorities for refuse removal or look for a website on battery recycling, on which you will find a list of the sites provided for the purpose near where you are.

Guarantee

This product is guaranteed against any manufacturing or operating defect, for one year from the date of purchase.

The guarantee is valid only upon presentation of the sales slip and the original packaging, with all the original parts.

This does not affect your statutory rights.

The guarantee does not cover any defects due to incorrect handling or use of the equipment.

The company SIDAS declines any responsibility for any consequential damage.

A 1-year extension of the guarantee is offered by Conform'able upon registration on the website www.conform-able.com. The battery serial numbers are shown on the rating plate 13.

For more information, consult the www.conform-able.com website and your specialist dealer. Subject to change. This product is in conformance with applicable laws and directives.

This device complies with Part 15 of the FCC Rules. Operation is subject to the following two conditions: (1) this device may not cause harmful interference, and (2) this device must accept any interference received, including interference that may cause undesired operation.

Caution: The user is cautioned that changes or modifications not expressly approved by the party responsible for compliance could void the user's authority to operate the equipment.

Note: This equipment has been tested and found to comply with the limits for a Class B digital device, pursuant to part 15 of the FCC Rules. These limits are designed to provide reasonable protection against harmful interference in a residential installation. This equipment generates, uses and can radiate radio frequency energy and, if not installed and used in accordance with the instructions, may cause harmful interference to radio communications. However, there is no guarantee that interference will not occur in a particular installation. If this equipment does cause harmful interference to radio or television reception, which can be determined by turning the equipment off and on, the user is encouraged to try to correct the interference by one or more of the following measures:

- Reorient or relocate the receiving antenna.
- Increase the separation between the equipment and receiver.
- Connect the equipment into an outlet on a circuit different from that to which the receiver is connected.
- Consult the dealer or an experienced radio/TV technician for help.