



AB-S10



"Made for iPod" and "Made for iPhone" mean that an electronic accessory has been designed to connect specifically to iPod or iPhone, respectively, and has been certified by the developer to meet Apple performance standards. Apple is not responsible for the operation of this device or its compliance with safety and regulatory standards. Please note that the use of this accessory with iPod, iPhone may affect wireless performance.
Made for iPod Nano (3rd, 4th, 5th, and 6th generation), iPod Touch (1st, 2nd, 3rd, and 4th generation), iPod with Video, iPod Classic, iPhone, iPhone 3G, iPhone 3GS, iPhone 4.



Owner's Manual

AND INSTALLATION INSTRUCTIONS



TABLE OF CONTENTS

SAFETY FIRST: IMPORTANT INSTRUCTIONS.....	2
MEET AUDIOBULB.....	4
WHAT'S IN THE BOX.....	5
EASY SETUP:	
1. AudioBulb Installation.....	6
2. AudioBulb Base Layout.....	7
3.Using the Remote.....	9
4. Pairing.....	12
TECH SPECIFICATIONS.....	16
HELP.....	17
GIINII PROTECTION: WARRANTY INFORMATION.....	18
REGULATION AND COMPLIANCE.....	20

SAFETY FIRST: IMPORTANT INSTRUCTIONS

1. Please read and follow these instructions carefully. Keep this instruction booklet in a safe place for future references.
2. Do not use AudioBulb near water. Moisture may cause a short-circuit in the electronic components, leading to malfunctions.
3. Clean with a dry cloth only.
4. Do not block any ventilation openings. Install in accordance with these instructions.
5. Do not install near any heat sources.
6. Only use attachments/accessories specific to AudioBulb.
7. Do not attempt to disassemble or modify this product. There are no user serviceable parts inside this product, and any unauthorized modifications will void the warranty.
8. This device is not intended for use with emergency exit fixtures.
9. Only use in a protected outdoor environment.
10. Do not use in enclosed recessed light fixtures.
11. Do not use an unknown power adapter other than the one supplied. Connecting this product to an unknown power adapter is very dangerous and may lead to fire or explosion.
12. It is not recommended to use AudioBulb on a dimmer switch, unless full power is used. the speaker requires a constant flow of electricity to function properly.
13. Please use caution, proper safety methods, and a partner when installing on a ladder or high locations

SAFETY FIRST: IMPORTANT INSTRUCTIONS

While using the AudioBulb:



CAUTION: To reduce the risk of electric shock, do not disassemble product.



Refer to the user manual: During the installation process, please refer to the instructional guide for useful tips

MEET AUDIOBULB

AudioBulb combines light, sound, and wireless technology to create a multi-room music system. Installation is simply and easy, no additional wiring needed.

Brilliant LED Light

AudioBulb LEDs will last up to 30,000 operating hours. Each 5 watt LED bulb is suitable to replace up to 65 watt incandescent light bulb.

Full-Range Sound Performance

Engineered for maximum performance, each speaker is equipped with 10 Watts of power providing rich, full sound. With 2.4Ghz low-distortion wireless transmission, having stereo sound in a room has never been easier.

Multi-Room, Wireless Music

Each AudioBulb docking station can support two music zones and up to eight AudioBulb speakers, providing flexibility to customize your own music zones and enjoy your favorite music wirelessly with just a touch of a button. The proprietary 2.4Ghz wireless technology offers transmission distance of up to 100 feet (approx. 30 meters) in any direction, allowing you to personalize listening zones by room or other environments.

Installation is EASY

AudioBulb speakers can be easily installed just like a standard light bulb and can be installed in standard light bulb sockets.

WHAT'S IN THE BOX

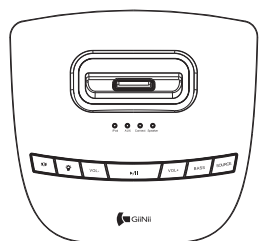

1. AudioBulb docking station



2. Two AudioBulbs



3. Instruction manual



4. Remote control and iPhone/iPod adapters(3x)

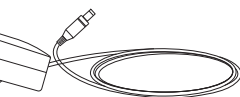

5. AC/DC adapter



6. 3.5mm AUX IN cable(0.5M)

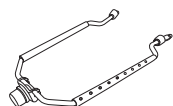

8. Harp

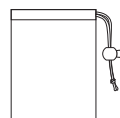

9. Pouch



10. Docking dust cap

EASY SETUP

1. AudioBulb Installation

1. Make sure your wall light power switch is in the "off" position before starting the installation process.

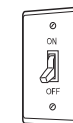

2. Check your connector type: The AudioBulb speaker is designed to fit into a standard light socket connector. It will not fit any other types of connectors .



3. Screw the AudioBulb into the socket and make sure that it is snugly in place.

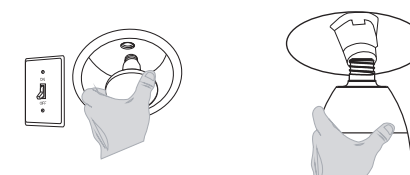

4. Once the bulbs are installed securely, turn on the power switch and wait for few seconds for the AudioBulbs to light up.

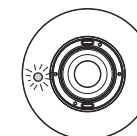

EASY SETUP

2. AudioBulb Base Layout

- ①. Speaker power on / off
- ②. Light power on /dim/ off
- ③. Volume down
- ④. Play/Pause
- ⑤. Volume Up
- ⑥. Bass Boost
- ⑦. Source
- ⑧. Power
- ⑨. Pair

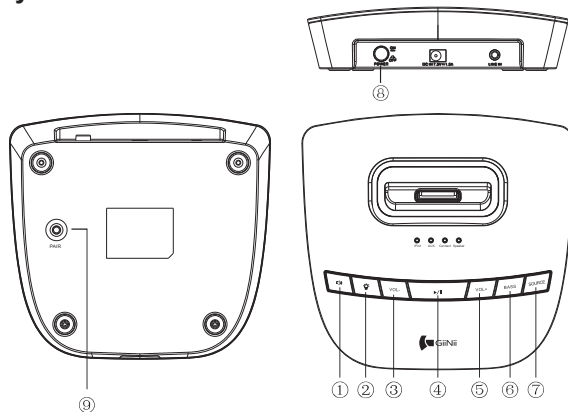

1. Connect the AC adaptor to "DC IN" and the other end to a wall outlet, then press the power button to turn on the base..The "Connect" LED indicator will blink while connecting and stay lit once the connection between the bulbs and the base is established. By default, your AudioBulbs are set to zone1.

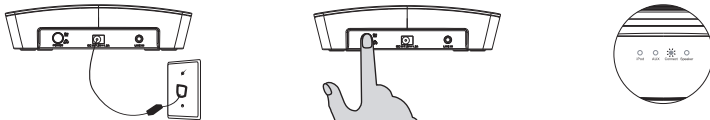

2. Dock your iPhone/iPod to the docking station and press button1 to turn on the speakers on AudioBulbs. When iPhone/iPod is docked, the docking station will establish connection to your iPhone/iPod in 1~2 seconds and begin music playback.

EASY SETUP

automatically. Your device will be charged simultaneously.

To connect other types of audio devices or laptops, use the 3.5mm Aux-in port located on back of the docking station. Once connected, press the SOURCE button to highlight AUX.

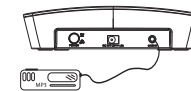

3. Change brightness of AudioBulb LED lights. This will control all bulbs in the same zone.

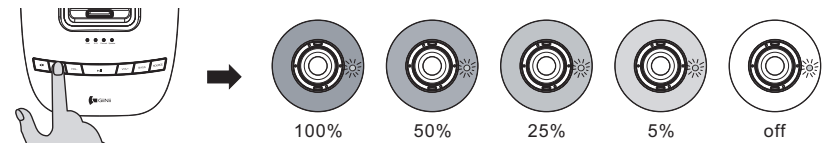

4. Press the VOLUME button to control audio output from the bulbs. When volume is being adjusted, the "Speaker" LED indicator on docking station will blink until minimum or maximum volume setting is reached.

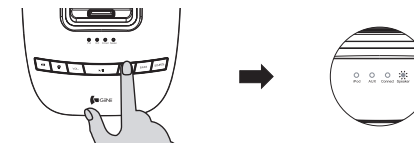

5. Use BASS BOOST for enhanced audio experience.

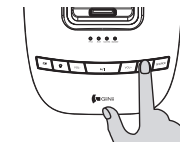

EASY SETUP

3.Using the Remote

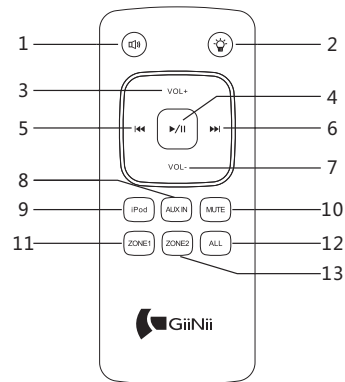

No.	Icon	Description
1		Press “” icon to turn on/off speaker on AudioBulb.
2		Press “” to control AudioBulb lighting level: 100%→50%→25%→5%→off.
3		Press “” button to amplify the music volume.
4		Press “” button to play and pause when playing music from docked iPhone/iPod.
5		Press “” or “” button to select previous or next track from docked iPhone/iPod. Also, press and hold “” or “” button to rewind or fast-forward current playing track on iPhone or iPod.
6		
7		Press “” button to minish the music volume.
8		Press “” or “” button to audio source.
9		

EASY SETUP

10		Press “” button to mute the speakers, the Speaker LED indicator on docking will blink during mute.
11		“” button: allows you to control all AudioBulbs designated to Zone 1. (Factory default setting at Zone 1).
12		“” button: When both zone1 and zone2 are set up and present, press “” button to control all AudioBulbs in range.
13		“” button: You can buy additional AudioBulbs and create Zone 2 to your docking station.

Useful tip: For maximum performance, we recommend placing the AudioBulb docking station in the center of all bulbs, allowing maximum transmitting distance to 100 ft (30 meters) in all directions.

• Replacing the remote control battery

1. On the back of the remote control, press the locking tab to the right.

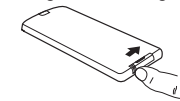

2. Pull out the battery holder.

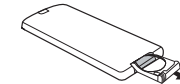

3. Insert the new battery into the holder. The battery must be placed with the positive charge facing upwards, as shown in the illustration below.

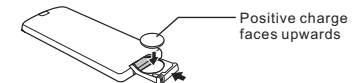

EASY SETUP

4. Slide the battery holder into the remote control.



- Failure to replace the battery in the correct manner may damage the battery.
- Use only the specified battery type.
- Recycle or dispose used batteries properly according to local guidelines and regulations.
- The batteries are highly flammable, keep away from excessive heat or moisture.
- If the battery is completely drained or not in use for extended period of time, remove the battery to prevent leakage.

EASY SETUP

4. Pairing

The AudioBulbs are preconfigured to Zone1 for convenience. In some rare occasions, you may need to re-establish the wireless connection. Please make sure all devices are connected to power and follow below simple steps.

To set up/add AudioBulbs to Zone 1:

a) Press down in the PAIR button, located at the bottom of the docking station.

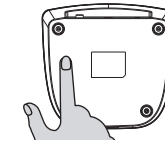

b) Point remote control at the docking station and press down on ZONE1 button, and the connect indicator light on docking station will flash rapidly.

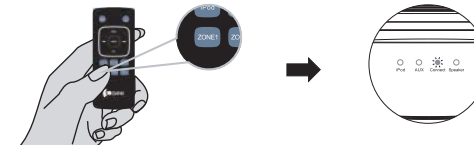

c) Make sure the AudioBulb is securely installed securely in an Edison socket and powered on.

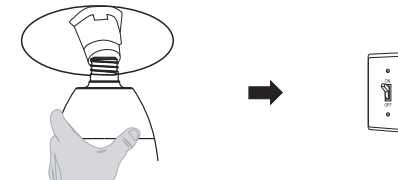

EASY SETUP

d) Use a small paperclip and press the pairing button inside the speaker.

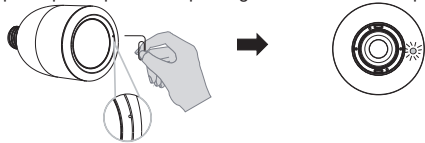

e) Press the PAIR button on the docking station again to complete setup.

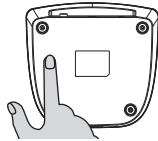

To set up/add AudioBulbs to Zone 2:

a) Press down in the PAIR hole, located at the bottom of the docking station.

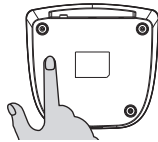

b) Point remote control at the docking station and press down on ZONE2 button, and the AUX indicator light on docking station will flash rapidly.

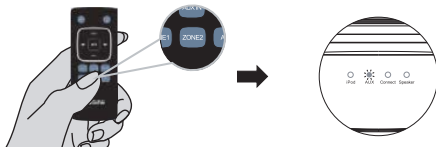

EASY SETUP

c) Make sure the AudioBulb is securely installed on an Edison socket and powered on.

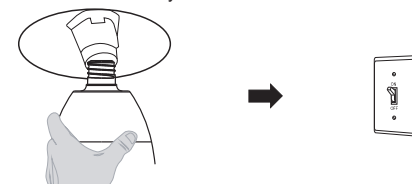

d) Use a small paperclip and press the pairing button inside the speaker.

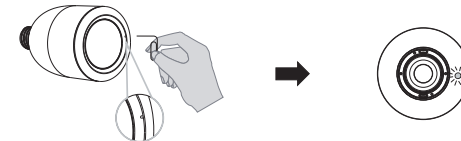

e) Once the steps are complete, press the PAIR button on the docking station again to complete setup.

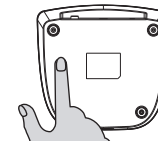

To reset paired channels and re-designate AudioBulbs:

a) Press and hold (4~6 sec) pairing button on bottom of docking station to erase all prior set pairs.

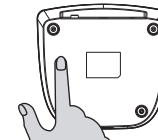

EASY SETUP

b) All 4 LED indicators on docking station will blink in sequence.

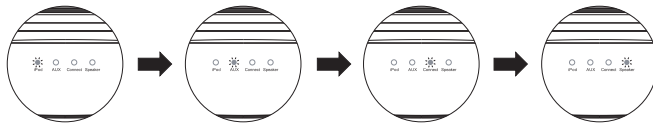

c) All 4 LED indicators on docking station will fast-blink at the same time (all pairing erased at this point).



d) Repeat above Zone1/Zone2 steps to re-establish pairing.

Note:

- If you wish to add more AudioBulbs to predefined Zone1, repeat steps above and choose Zone1 on the remote.
- 1st and 2nd paired AudioBulbs are automatically set to L and R channels respectively.
- In case pairing is not successful, press and hold pair buttons on docking station for 4~6 seconds to reset the system then repeat above instructions.
- If you have a wireless router in your home, it is recommended that the docking station and the wireless router are at least 10 feet apart to avoid any potential signal interference.

TECH SPECIFICATIONS

SPEAKER FREQUENCY RESPONSE	90Hz-20KHz +/- 3dB
AUDIO AMPLIFIER	10 watt/per channel digital amplifier with digital signal processing
MAXIMUM ACOUSTIC OUTPUT	90dB
SPEAKER DRIVER	2.25" full range high performance drivers
LED LIGHT	5 watt long life LED, replaces up to a 65 watt incandescent, fully dimmable and controlled by remote and docking stand
AUDIOBULB CONNECTION	E27 socket
TRANSMITTER	2.4GHz wireless transmission of two sources with iPod and AUX in
REMOTE CONTROLS	Speaker on/off, Light on/off, Previous/Next, Play/pause, Vol+/-, iPod, AUX, MUTE, Zone1, Zone2, ALL
TRANSMITTER INPUTS	Docking transmitter with push power on/off switch, DC input, AUX input and 30pin iPod connector
SYSTEM COMPONENTS	Two AudioBulbs, wireless docking transmitter, IR remote control, 1 transmitter power supply, 0.5M 3.5mm stereo cable, user manual, QSG, iPhone adapters (3x)
AUDIOBULB DIAMETER	3.35 inches
AUDIOBULB HEIGHT	5.5 inches with socket and lens
AUDIOBULB WEIGHT	0.87 LBS
DOCKING STATION DIMENSIONS	W6.2xD5.8xH1.53 inches
REMOTE DIMENSIONS	W3.54xD1.46xH0.4 inches

HELP

Frequently Asked Questions

1. There is no music coming out of the Bulb, what should I do?

- Verify that there is electricity to the Bulbs.
- Double check to see that the correct SOURCE is selected.
- Trying re-pair the bulbs with docking station, please refer to the Pairing Guide.
- Do not install these bulbs on a socket with dimmer switch.

2. There is buzzing coming from the speakers, how can I eliminate it?

The maximum distance between the base and the bulb should not exceed 100ft. If there is interference, clear the air space that may be blocking the signal. It is also recommended to have clear space between other wireless products, such as wireless phones or internet routers.

3. My question is not answered, where can I get more support on this?

Please call us, toll free, at 1-866-909-3550 for troubleshooting and warranty services. Please have the receipt information handy.

GIINII PROTECTION: WARRANTY INFORMATION

WARRANTY COVERAGE:

This warranty obligation is limited to the terms set forth below.

WHO IS COVERED:

This product is warranted to the original purchaser or the person receiving the product as a gift against defects in materials and workmanship as based on the date of original purchase ("Warranty Period") from an Authorized Dealer. The original sales receipt showing the product name and the purchase date from an authorized retailer is considered such proof.

WHAT IS COVERED:

This warranty covers new products if a defect in material or workmanship occurs and a valid claim is received within the Warranty Period. GiINii warrants this product to be free from defects in materials and workmanship (subject to the terms set forth below) for a period of three(3) years from the date of purchase for the LED light and one (1) year from the date of purchase for the rest of the components. At its option, the company will either (1) repair the product at no charge, using new or refurbished replacement parts, or (2) exchange the product with a product that is new or which has been manufactured from new, or serviceable used parts and is at least functionally equivalent or most comparable to the original product in current inventory, or (3) refund the original purchase price of the product. The Company warrants replacement products or parts provided under this warranty against defects in materials and workmanship from the date of the replacement or repair for the remaining portion of the original product's warranty. When a product or part is exchanged, any replacement item becomes your property and the replaced item becomes the company's property. When a refund is given, your product becomes the company's property. Replacement product can only be sent if all warranty requirements are met. Failure to follow all requirements can result in delay.

WHAT IS NOT COVERED

EXCLUSIONS AND LIMITATIONS:

This Limited Warranty applies only to the new products that can be identified by the trademark, trade name, or logo affixed to it. This Limited Warranty does not apply to any non-GiINii hardware product or any software, even if packaged or sold with the product. Non-GiINii hardware manufacturers, suppliers, or publishers may provide a separate warranty for their own products packaged with the bundled product. The Company is not liable for any damage to or loss of any programs, data, or other information stored on any media contained within the product, or any non-GiINii product or part not covered by this warranty. Recovery or reinstallation of programs, data or other information is not covered under this Limited Warranty. This warranty does not apply (a) to damage caused by accident, abuse, misuse, neglect, misapplication, or non-GiINii product, (b) to damage caused by service performed by anyone other than an Authorized Service Location, (c) to a product or a part

GIINII PROTECTION: WARRANTY INFORMATION

that has been modified without written permission, or (d) if any serial number has been removed or defaced, or (e) to a product, accessories or consumables sold "AS IS" without warranty of any kind by including refurbished GiiNii products sold "As IS" by some retailers.

THIS LIMITED WARRANTY DOES NOT COVER:

- Shipping charges to return defective product.
- Labor charges for installation or setup of the product, adjustment of customer controls on the product, and installation or repair of any part outside of the product
- Product repair and/or part replacement because of improper installation or maintenance, connections to improper voltage supply, power line surge, lighting damage, retained images or screen markings resulting from viewing fixed stationary content for extended periods, product cosmetic appearance items due to normal wear and tear, unauthorized repair or other cause not within the control of the company.
- Damage or claims for products not being available for use, or for lost data or lost software.
- Damage from mishandled shipments or transit accidents when returning product.
- A product that requires modification or adaptation to enable it to operate in any country other than the country for which it was designed, manufactured, approved and/or authorized, or repair of products damaged by these modifications.
- A product used for commercial or institutional purposes (including but not limited to rental purposes).
- Product lost in shipment and no signature verification receipt can be provided.
- Failure to operate per User Manual.

TO OBTAIN ASSISTANCE

For technical support go to www.giinii.com and select your product or call toll free 1-866-909-3550. REPAIR OR REPLACEMENT AS PROVIDED UNDER THIS WARRANTY IS THE EXCLUSIVE REMEDY FOR THE CONSUMER. GiiNii SHALL NOT BE LIABLE FOR ANY INCIDENTAL OR CONSEQUENTIAL DAMAGES FOR BREACH OF ANY EXPRESS OR IMPLIED WARRANTY ON THIS PRODUCT. EXCEPT TO THE EXTENT PROHIBITED BY APPLICABLE LAW, ANY IMPLIED WARRANTY OR MERCHANTABILITY OR FITNESS FOR A PARTICULAR PURPOSE ON THIS PRODUCT IS LIMITED IN DURATION TO THE DURATION OF THIS WARRANTY. Some states do not allow the exclusions or limitations of incidental or consequential damages, or allow limitations on how long an implied warranty lasts, so the above limitations or exclusions may not apply to you. This warranty gives you specific legal rights. You may have other rights which may vary from state/province to state/province.

©2011 GiiNii

REGULATION AND COMPLIANCE

THIS DEVICE COMPLIES WITH FCC RULES PART 15.

Operation is subject to the following two conditions:

- (1) this device may not cause harmful interference and
- (2) This device must accept any interference received including that may cause undesired operation.

This equipment has been tested and found to comply with the limits for a Class B digital device, pursuant to Part 15 of the FCC Rules. These limits are designed to provide reasonable protection against harmful interference in a residential installation. This equipment generates, uses and can radiate radio frequency energy and, if not installed and used in accordance with the instructions, may cause harmful interference to radio communications. However, there is no guarantee that interference will not occur in a particular installation. If this equipment does cause harmful interference to radio or television reception, which can be determined by turning the equipment off and on, the user is encouraged to try to correct the interference by one or more of the following measures:

- Reorient or relocate the receiving antenna.
- Increase the separation between the equipment and receiver.
- Connect the equipment into an outlet on a circuit different from that to which the receiver is connected.
- Consult the dealer or an experienced radio/TV technician for help.

NOTE: changes or modifications not expressly approved by the party responsible for compliance could void the user's authority to operate the equipment.

RF Exposure Statement

To maintain compliance with FCC's RF Exposure guidelines, This equipment should be installed and operated with minimum distance between 20cm the radiator your body: Use only the supplied antenna.