

# PENBOOK User Manual

Cregle © 2011 Cregle All Rights Reserved

Free ideas • 創意無界 • 自由在飛想 • свободные идеи • idées libres • ideas libres • freien Ideen

Cregle © 2011 Cregle All Rights Reserved

The Penbook™ platform is built for content creation not just consumption. Jot down notes, edit documents, draw in the margins and share it all with your peers and colleagues on the first truly social handwriting platform.



Liberate yourself with **Penbook™**. Get the freedom of Windows and its built-in application library, multi-touch and digitizer pen, replaceable battery, and side touch bars for custom input.

## ● ***Palm rejection*** *multi touch + digitizer pen*

Palm Rejection technology automatically disables multi-touch so you can doodle, take notes, and compose on your Penbook while resting the palm of your hand on the screen - just like you would write in a traditional notebook. It is a big plus for everyone, and a game-changer for left-handers.

## ● ***Touch Bars*** *unique gesture customization*

Quickly access common commands with gesture-controlled touch bars. With a swipe of your fingers, You can adjust the screen brightness or use the bars to enter keyboard combinations such as Page Up/Down and Ctrl+Alt+Del. You can even use Touch Bar gestures to trigger a whole range of customized commands.

## ● ***Replaceable Battery*** *your ultimate backup*

Get up to 6 hours of continuous battery life in Windows 7 and swap your 5000mAh replaceable battery anytime for added power. But no matter how long you need to use it, your PenBook offers the ultimate comfort zone--the option of a replaceable battery--so you'll never run out of power when you need it.



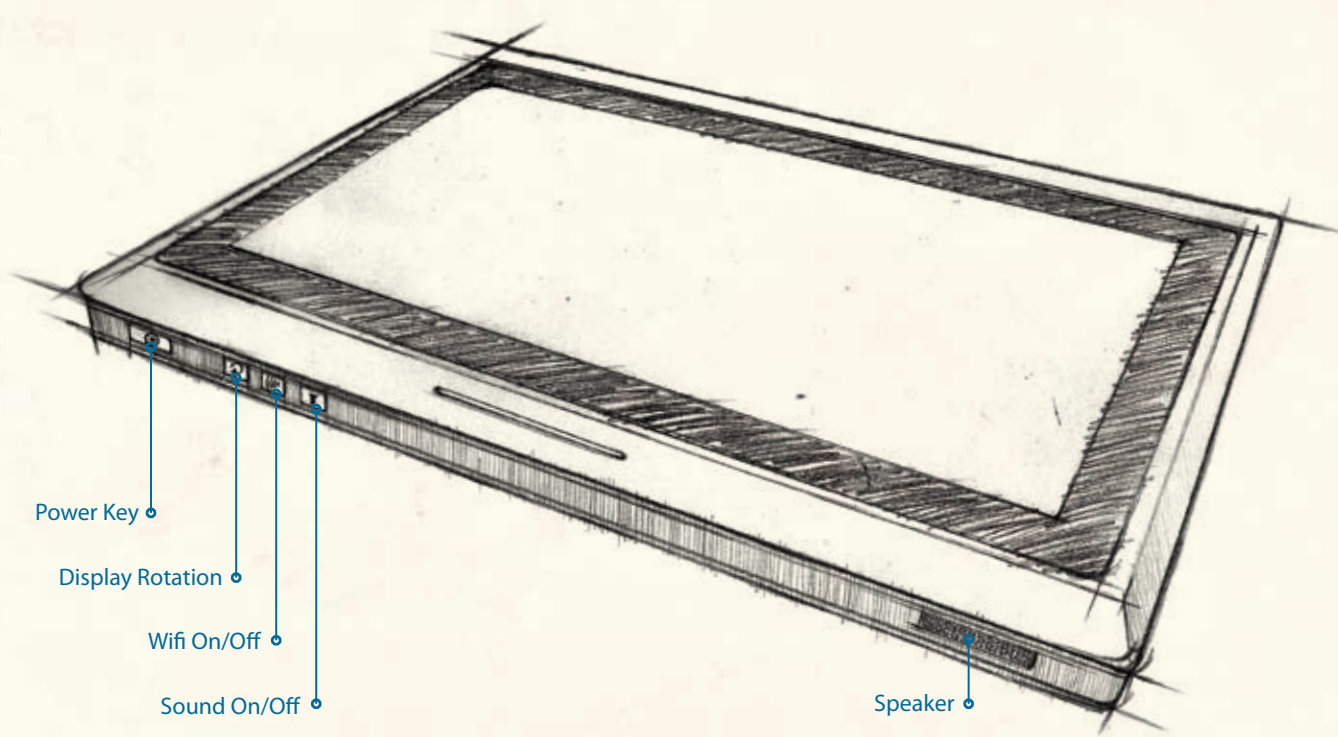

## Dimension and Weight

Length 264mm  
Width 184mm  
Thickness 17mm  
Net Weight 2.3lb

## LCD & Touch

LCD Size 10.1" TFT LCD  
Brightness 200 nits  
Resolution 1024 x 600 / 1024 x 768  
Pen Input Device Wacom 10.1" Digitizer

## Motherboard

CPU Intel Atom Z530@1.6GHz  
Chipset Intel US15WP  
SDRAM Standard 1GB, Max. 2GB

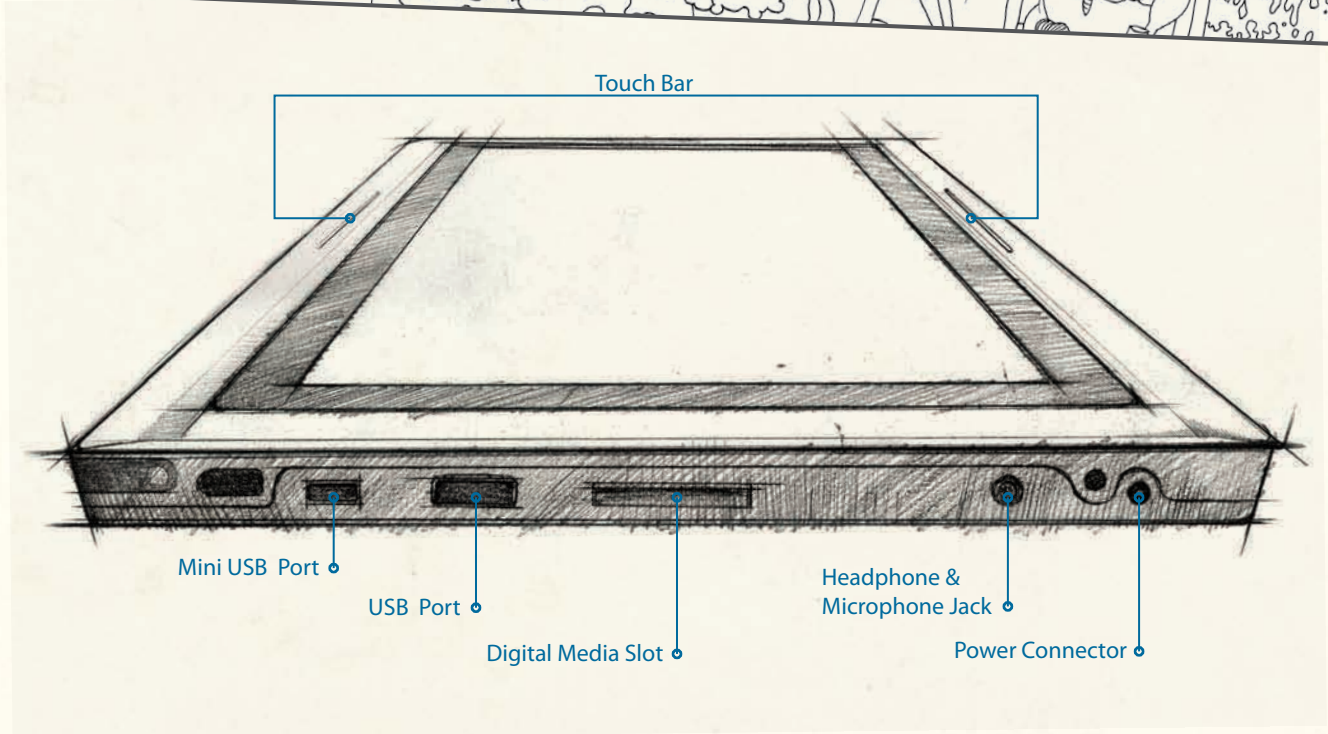

## **Buttons , Touch Bar & Gestures**

1D touch bar x 2 To specify functions

Ctrl+Alt+Del

Slide both **touch bars** opposite

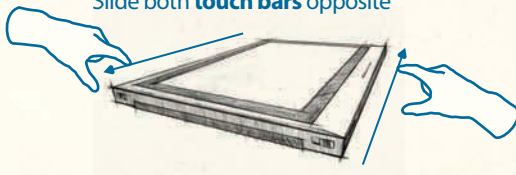

Show Desktop

Slide both **touch bars** down

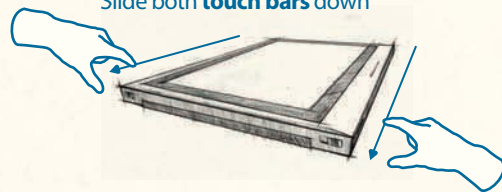

Adjust Screen Brightness

Slide left hand **touch bar**

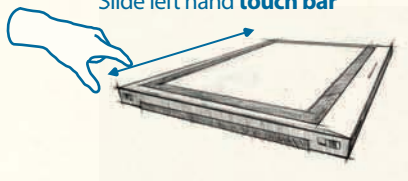

Page Up/Down

Slide right hand **touch bar** Up/Down

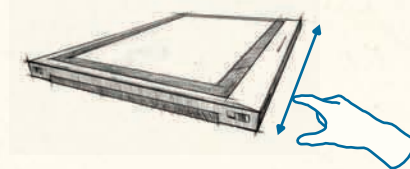

Enter

Double click any **touch bars**

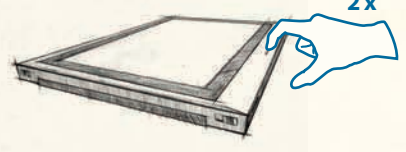

## **Storage & Expansion**

Hard Disk Device (HDD) 16G/32GB SSD

Memory Card Reader SD/MMC slot x 1

## **Input/Output Ports**

USB 2.0 Two ports

Audio Jack 1 x Headphone & Microphone Jack

Microphone 1 x Built-in

Speaker 2 x 1 W (Built-in)



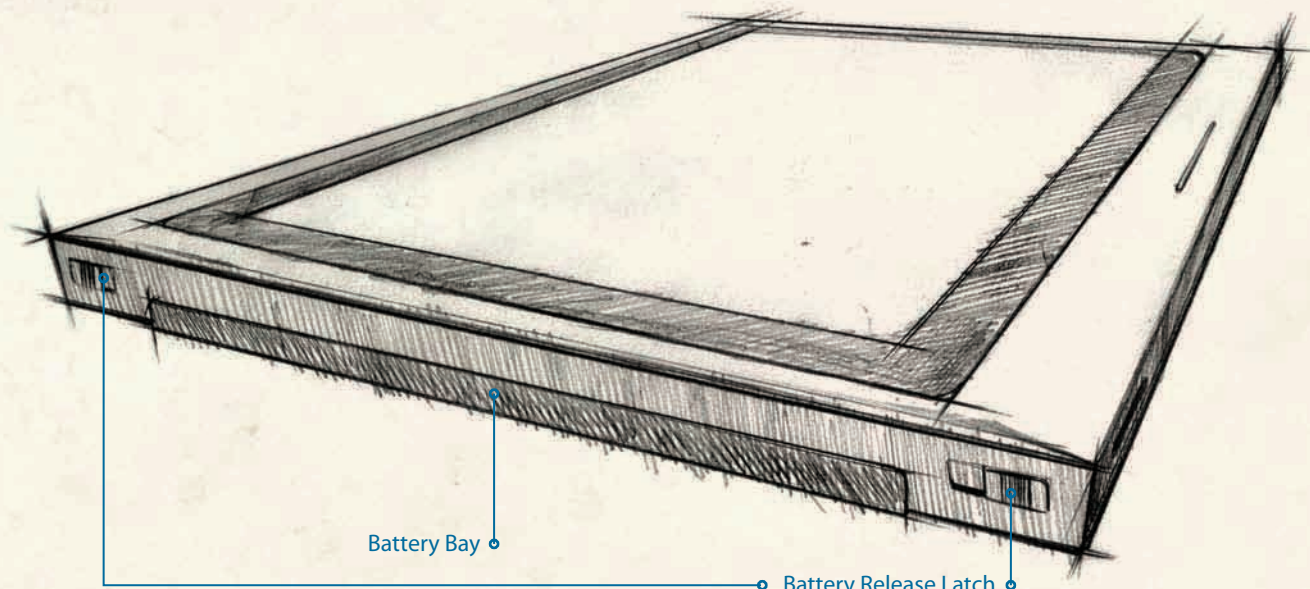

## Wireless

Wi-Fi Built-in 802.11 b/g/n module  
Bluetooth Built-in V2.1 +EDR module

### Antenna List

No.	Manufacturer	Part No.	Antenna Type	Peak Gain	Note
1	MSI	N/A	Printed on PCB	4.4 dBi for 2.5GHz	WLAN
2	MSI	N/A	Printed on PCB	-3.38dBi for 2.5GHz	Bluetooth

Note : The antenna of EUT is conform to FCC 15.203.

## Power & Battery

Power Adapter/Supply 12V@3A/(100~240V)  
Battery Running Time up to 6 hours

## Others

OS Microsoft Windows 7™ Home Premium or Professional  
Wacom Stylus Pen

This device complies with Part 15 of the FCC Rules. Operation is subject to the following two conditions: (1) This device may not cause harmful interference, and(2) This device must accept any interference received, including interference that may cause undesired operation.

### SAR Exposure Statement

This EUT is compliance with SAR for general population/uncontrolled exposure limits in and had been tested in accordance with the measurement methods and procedures specified in OET 65. This equipment should be installed and operated with minimum distance 0cm between the radiator & your body.

This device and its antenna(s) must not be co-located or operating in conjunction with any other antenna or transmitter. The Country Code Selection feature is disabled for products marketed in the US.

For product available in the USA markets, only channel 1~11 can be operated. Selection of other channels is not possible.

Per FCC 15.21, you are cautioned that changes or modifications not expressly approved by the part responsible for compliance could void the user's authority to operate the equipment.