

# Description of E-Label on the ZNFG820UM for Carrier A

❖ FCC ID is applied by E-Label on the device

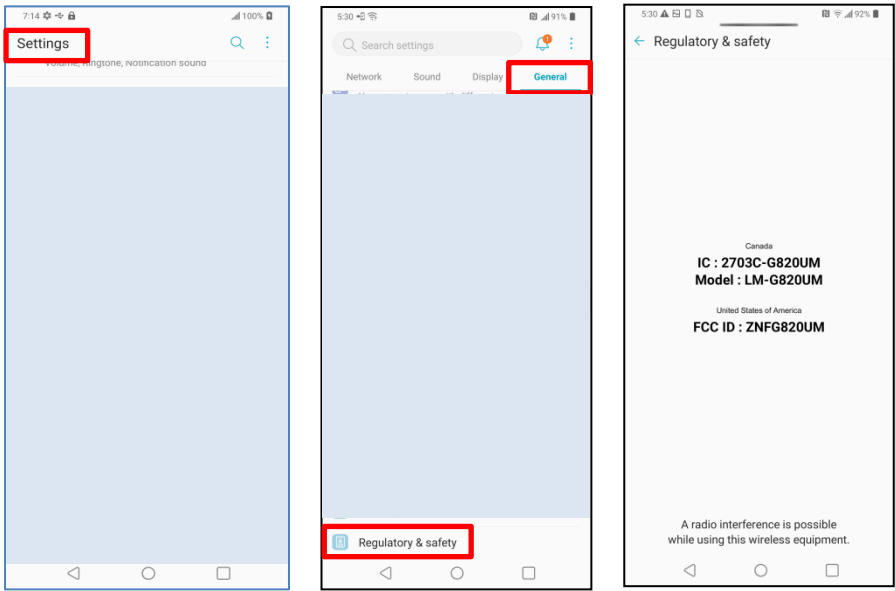

Settings Menu	
Step 1	Select "Setting"
Step 2	Select "General"
Step 3	Select "Regulatory & safety"

❖ FCC ID is applied on packaging Label

**FCC ID: ZNFG820UM**

❖ Instruction of E-Label on the user manual

**Regulatory information (FCC ID number, etc.)**

For regulatory details, go to **Settings > General > Regulatory & Safety.**

# Description of E-Label on the ZNFG820UM for Carrier B

## ❖ FCC ID is applied by E-Label on the device

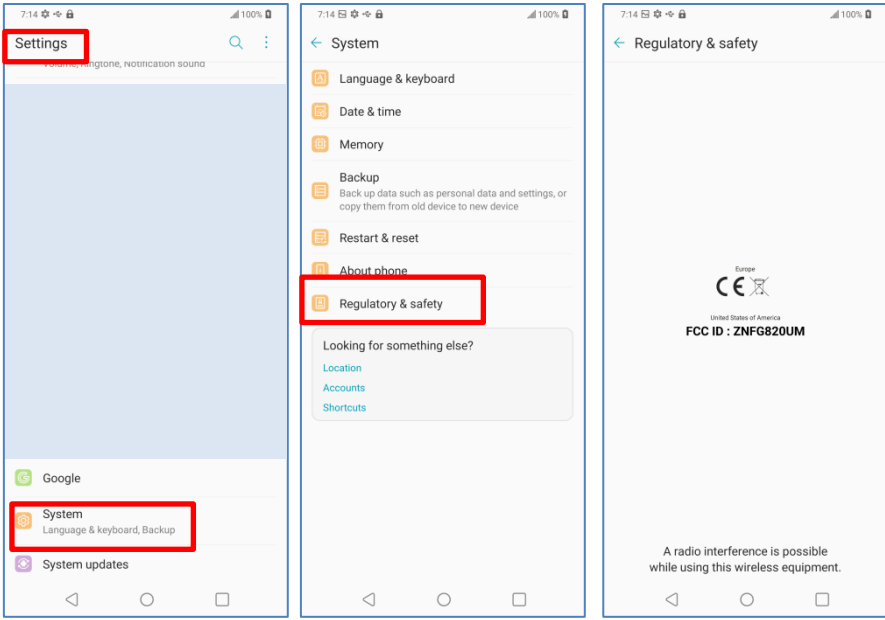

### Settings Menu

Step 1	Select "Setting"
Step 2	Select "System"
Step 3	Select "Regulatory & safety"

## ❖ FCC ID is applied on packaging Label

**FCC ID: ZNFG820UM**

## ❖ Instruction of E-Label on the user manual

**Regulatory Information (FCC ID number, etc.)**  
For regulatory details, go to **Settings > System > Regulatory & Safety.**