

---

# Bluetooth Headset

---

Brand Name: Perfect Choice

Model Name: PC-116110

FCC ID: ZF8-PC-116110

# CALLS & MUSIC

## Calls

1. Answer a call: Quickly press the multifunction button to answer the phone call.
2. End a call: Quickly press the multifunction button to hang up the phone call during a call.
3. Reject a call: Press and hold the multifunction button to reject a call.
4. Last number redial: Press the multifunction button twice to redial last number when the headset is connected to mobile phone and in standby status.

5. To switch a call from the headset to the connected phone: Press and hold the previous song button for about two seconds to switch the call from the headset to the connected phone. To switch the call from the phone to the headset, press and hold the previous song button for about two seconds again.

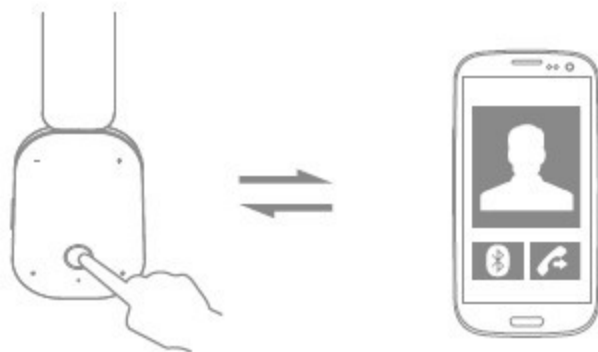

---

**Listen to music** (this feature need to be compatible by mobile phone music player)

1. **Music Play/Pause:** Quickly press the multifunction button to pause playing a song during playback, to resume playing a song, press the multifunction button again.
2. **Previous song:** Press the track back button quickly to play previous song during playback.
3. **Next song:** Press the track forward button quickly to play next song during playback.
4. **Fast forward:** Press and hold the track forward button to fast forward through the current song. Release the button to resume music playing.
5. **Rewind:** Press and hold the track back button to rewind through the current song. Release the button to resume music playing.
6. **Switch music and calls:** If you receive or make a call while listening to music, the music is paused until the call ends.

---

## KNOW MORE

### Battery indicator

The current battery status of headset will be displayed in top right corner after the headset connected to iOS devices.

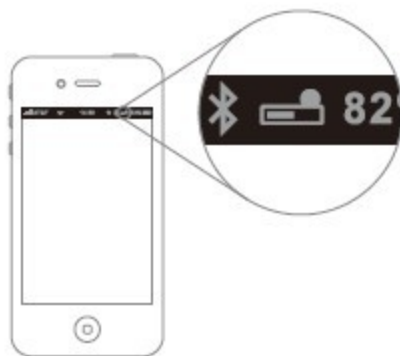

# GET STARTED

## To know more about the headset

Talktime: 15 hours

Music time: 15 hours

Standby time: 300 hours

Bluetooth version: 4.0

Bluetooth profiles: A2DP/HFP/HSP/AVRCP

Solution: CSR

Noise reduction: 2-MIC CVC noise reduction

Wireless range: 10m

Weight: 95g

Size: 155×160×52mm

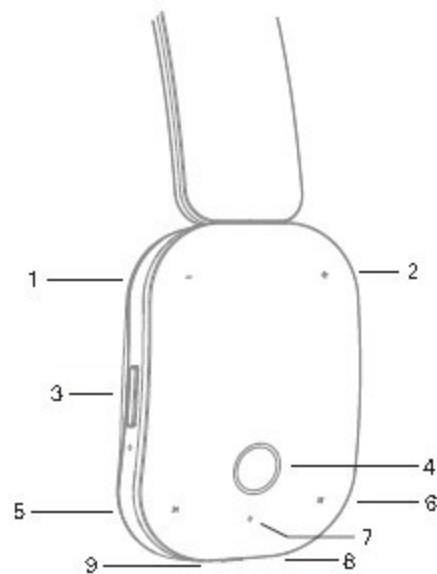

1. Volume down

2. Volume up

3. EQ button

4. Multifunction button

5. Track back

6. Track forward

7. Indicator lights

8. Microphone

9. Charger connect

# EASY TO USE

## Basic operation

1. Adjust the volume: Press volume up or down button during a call or while listening to music.
2. EQ equalizer adjuster: Press EQ button to change the EQ mode (original, bass, treble, rock, pop)
3. Multifunction button: For operations included turn on/off, pairing, answer/end calls, music play/pause etc.
4. Track back/Forward: To enable music track back/forward, and scrolling through the current song.
5. Indicator lights: When the headset start pairing, the red and blue lights flash alternately; red light flashes once when the headset is turned off; blue light flashes in every 8 seconds when in standby status; the blue light flashes continuously when there is incoming calls; the red indicator light keeps lighting when the headset is charging; the red light is off and blue light is on after fully charged.

## Pairing

1. Press and hold the multifunction button about 5 seconds to switch on the headset, it automatically enters the pairing mode, the red and blue indicator lights flashes alternately.
2. Activate the Bluetooth feature on your phone or other devices, and set it to search for new Bluetooth devices.



3. Select 'Headblue1' from the list of found devices on your phone or other devices and connect, if necessary, enter passcode 0000 to pair and connect the headset to your device. Now you can use Headblue1 for phone calls or listening to music.



## Multipoint

1. Press and hold the multifunction button for 6 seconds to switch on the headset, it automatically enters pairing mode, the red and blue indicator lights start flashes alternately.

2. Activate the bluetooth feature on the first and the second mobile phone, and set them to search for the new bluetooth devices

3. Select 'Headblue1' from the list of found devices on both mobile phones simultaneously and connect.



## Important Regulatory Information

This device complies with part 15 of the FCC rules. Operation is subject to the following two conditions:

- (1) this device may not cause harmful interference, and
- (2) this device must accept any interference received, including interference that may cause undesired operation.

Changes or modifications to this unit not expressly approved by the party responsible for compliance could void the user's authority to operate the equipment.