

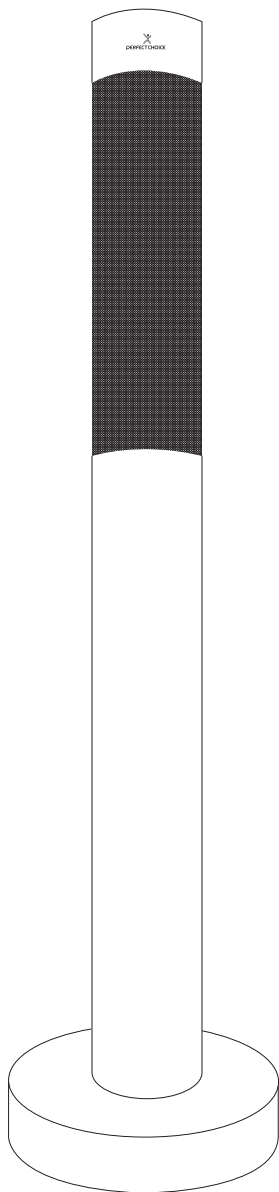

PC-112563
Tower speaker system



   **FM**
Instruction Manual

Contents

- Important Safety Instructions 2**
 - Safety.....2
 - Warning.....3
- Identifying the Parts 4**
 - Main Unit4
 - Remote Control4
- Preparations..... 5**
 - Prepare the Remote Control5
 - Precautions Concerning Batteries5
- Connections 5**
 - Connect Power5
 - Connect to External Audio Device.....5
- Basic Operations..... 6**
 - Power6
 - Selecting Modes.....6
 - Set the Clock.....6
 - Adjust Volume Level6
 - Mute Sound6
- AUX Operation 6**
- Play With Bluetooth Device 6**
 - Pair Bluetooth-enabled Devices Manually6
 - Pair with Bluetooth-enabled Device Using One Touch (NFC).....7
 - Listen to Music from Bluetooth Device.....7
- Listening to the FM Radio 8**
 - Presetting Stations8
 - Tuning in a Station8
- Troubleshooting 8**
- Specifications..... 9**
- Standard Accessories 9**

Important Safety Instructions

	CAUTION RISK OF ELECTRIC SHOCK DO NOT OPEN	
ATTENTION: RISQUE DE CHOC ELECTRIQUE-NE PAS OUVRIIR		



The lightning flash with arrowhead symbol, within an equilateral triangle, is intended to alert the user to the presence of uninsulated "dangerous voltage" within the product's enclosure that may be of sufficient magnitude to constitute a risk of electric shock to persons.



The exclamation point within an equilateral triangle is intended to alert the user to the presence of important operating and maintenance (servicing) instructions in the literature accompanying the appliance.

Safety

- 1 **Read these instructions** – All the safety and operating instructions should be read before this product is operated.
- 2 **Keep these instructions** – The safety and operating instructions should be retained for future reference.
- 3 **Heed all warnings** – All warnings on the appliance and in the operating instructions should be adhered to.
- 4 **Follow all instructions** – All operating and use instructions should be followed.
- 5 **Do not use this apparatus near water** – The appliance should not be used near water or moisture – for example, in a wet basement or near a swimming pool, and the like.
- 6 Clean only with dry cloth.
- 7 Do not block any ventilation openings. Install in accordance with the manufacture's instructions.
- 8 Do not install near any heat sources such as radiators, heat registers, stoves, or other apparatus (including amplifiers) that produce heat.
- 9 Do not defeat the safety purpose of the polarized or grounding plug. A polarized plug has two blades with one wider than the other. A grounding plug has two blades and a third grounding prong. The wide blade or the third prong is provided for your safety. If the provided plug does not fit into your outlet, consult an electrician for replacement of the obsolete outlet.

10 Protect the power cord from being walked on or pinched particularly at the plugs, convenience receptacles, and at the point where they exit from the apparatus.

11 Only use attachments/accessories specified by the manufacturer.

12 Use only with the cart, stand, tripod, bracket, or table specified by the manufacturer, or sold with the apparatus. When a cart or rack is used, use caution when moving the cart/apparatus combination to avoid injury from tip-over.

13 Unplug the apparatus during lightning storms or when unused for long periods of time.

14 Refer all servicing to qualified personnel. Servicing is required when the apparatus has been damaged in any way, such as power supply cord or plug is damaged, liquid has been spilled or objects have fallen into the apparatus has been exposed to rain or moisture, does not operate normally, or has been dropped.

15  This equipment is a Class II or double insulated electrical appliance. It has been designed in such a way that it does not require a safety connection to electrical earth.

Caution:

- Use of controls or adjustments or performance of procedures other than herein may result in hazardous radiation exposure or other unsafe operation.
- Danger of explosion if battery is incorrectly replaced. Replace only with the same or equivalent type.

Warning

- The appliance coupler is used as disconnect device, the disconnect device shall remain readily operable
- The battery (battery or batteries or battery pack) shall not be exposed to excessive heat such as sunshine, fire or the like.
- Before operating this system, check the volt age of this system to see if it is identical with the voltage of your local power supply.
- The ventilation should not be impeded by covering the ventilation openings with items such as newspaper, table-cloths, curtains etc. Make sure there is at least 20 cm of space above and at least 5cm of space on each side of the unit.
- Do not place this unit close to strong magnetic field.

- Do not place the unit on the amplifier or receiver.
- Don't place this unit close to the damper, or the moisture will affect the life of the laser head.
- Should any solid object or liquid fall into the system, unplug the system and have it checked by qualified personnel before operating it any further.
- Do not attempt to clean the unit with chemical solvents as this might damage the finish. Use a clean, dry or slightly damp cloth.
- When removing the power plug from the wall outlet, always pull directly on the plug, never yank on the cord.
- Depending on the electromagnetic waves used by a television broadcast, if a TV is turned on near this unit while it is also on, lines might appear on the TV screen. Neither this unit nor the TV are malfunctioning. If you see such lines, keep this unit well away from the TV set.
- No naked flame sources, such as lighted candles, should be placed on the apparatus.
- Changes or modifications to this unit not expressly approved by the party responsible for compliance could void the user's authority to operate the equipment.
- To reduce the risk of fire or electric shock, do not expose this apparatus to rain or moisture. The apparatus shall not be exposed to dripping or splashing and that objects filled with liquids, such as vases, shall not be placed on apparatus.

FCC STATEMENT

This device complies with Part 15 of the FCC Rules. Operation is subject to the following two conditions:

- (1) this device may not cause harmful interference, and
- (2) this device must accept any interference received, including interference that may cause undesired operation.

Warning: Changes or modifications to this unit not expressly approved by the party responsible for compliance could void the user's authority to operate the equipment.

NOTE: This equipment has been tested and found to comply with the limits for a Class B digital device, pursuant to Part 15 of the FCC Rules. These limits are designed to provide reasonable protection against harmful interference in a residential installation.

This equipment generates uses and can radiate radio frequency energy and, if not installed

and used in accordance with the instructions, may cause harmful interference to radio communications. However, there is no guarantee that interference will not occur in a particular installation. If this equipment does cause harmful interference to radio or television reception, which can be determined by turning the equipment off and on, the user is encouraged to try to correct the interference by one or more of the following measures:

- Reorient or relocate the receiving antenna.
- Increase the separation between the equipment and receiver.
- Connect the equipment into an outlet on a circuit different from that to which the receiver is connected.
- Consult the dealer or an experienced radio/TV technician for help.

FCC Radiation Exposure Statement

This equipment complies with FCC radiation exposure limits set forth for an uncontrolled environment. This equipment should be installed and operated with minimum distance 20cm between the radiator & your body.



Correct Disposal of this product. This marking indicates that this product should not be disposed with other household wastes throughout the EU.

To prevent possible harm to the environment or human health from uncontrolled waste disposal, recycle it responsibly to promote the sustainable reuse of material resources. To return your used device, please use the return and collection systems or contact the retailer where the product was purchased. They can take this product for environmental safe recycling.



Warning: DO NOT INGEST BATTERY,CHEMICAL BURN HAZARD

The remote control supplied with this product contains a coin/button cell battery. If the coin/button cell battery is swallowed, it can cause severe internal burns in just 2 hours and lead to death. Keep new and used batteries away from children. If the battery compartment does not close securely, stop using the product and keep it away from children. If you think batteries might have been swallowed or placed inside any part of the body, seek immediate medical attention.

- The marking label is pasted on the bottom of the equipment.

Identifying the Parts

Main Unit

Top View

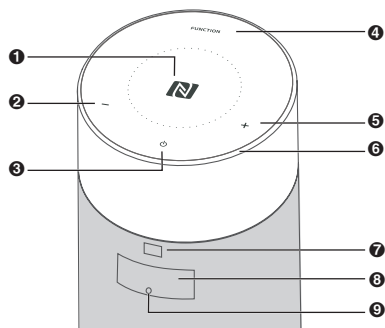

- 1 NFC sensing area.**
- 2 -**
Decrease the volume level.
- 3**
Press this button to turn on or switch to the Eco Power standby mode.
- 4 FUNCTION**
Press this button repeatedly to select a source.
- 5 +**
Increase the volume level.
- 6 Light**
Light up blue when the unit is in ON mode.
- 7 Remote Control Sensor**
- 8 Display Panel**
Shows current status.
- 9 Power Light**
Indicates mode of power.

Bottom View

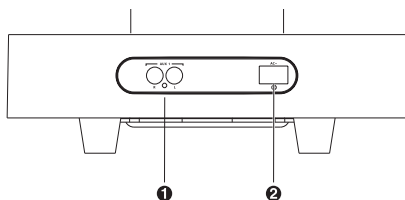

- 1 AUX IN socket**
Connect to TV or an external audio device.
- 2 AC~** Power supply socket.

Remote Control

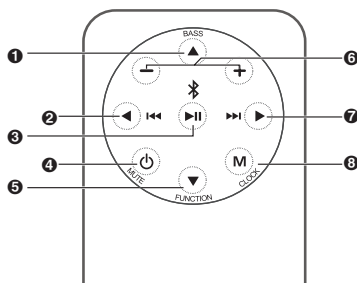

- 1 /BASS**
 - Select a preset sound effect: Bass 1, Bass 2, Bass 3.
 - Adjust the time.
- 2**
 - In bluetooth mode, skip to previous track.
 - Tune to a radio station by searching backward.
 - Select previous radio station.
 - In Standby mode: Adjust brightness level.
- 3**
 - In bluetooth mode, start or pause playback.
 - Hold and press to enable Bluetooth pairing mode in Bluetooth mode.
- 4 /MUTE**
 - Turn on this product from the Eco Power standby mode.
 - Press and hold to turn off the product and switch to Eco Power standby mode.
 - Mute or resume sound of unit.
- 5 /FUNCTION**
 - Select a source.
 - Adjust the time.
- 6 +/-**
Increase or decrease volume level.
- 7**
 - In bluetooth mode, skip to next track.
 - Tune to a radio station by searching forward.
 - Select next preset radio station.
 - In Standby mode: Adjust brightness level.
- 8 M/CLOCK**
 - Press and hold this button to set the clock in Standby mode.
 - Press and hold this button to search radio stations automatically in tuner mode.

Preparations

Prepare the Remote Control

The provided Remote Control allows the unit to be operated from a distance.

- Even if the Remote Control is operated within the effective range (6m), remote control operation may be impossible if there are any obstacles between the unit and the remote control.
- If the Remote Control is operated near other products which generate infrared rays, or if other remote control devices using infrared rays are used near the unit, it may operate incorrectly. Conversely, the other products may operate incorrectly.

Replace the Remote Control Battery

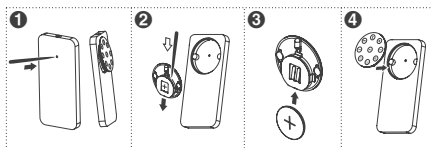

- 1 Use a needle to push the battery forward through the hole on rear of remote control.
- 2 Remove the old battery.
- 3 Place a new CR2025 battery with correct polarity (+/-) as indicated.
- 4 Then install the battery into remote control.

Precautions Concerning Batteries

- When the Remote Control is not to be used for a long time (more than a month), remove the battery from the Remote Control to prevent it from leaking.
- If the batteries leak, wipe away the leakage inside the battery compartment and replace the batteries with new ones.
- Do not use any batteries other than those specified.
- Do not heat or disassemble batteries. Never throw them in fire or water.
- Do not carry or store batteries with other metallic objects. Doing so could cause batteries to short circuit, leak or explode.
- Never recharge a battery unless you are certain that it is a rechargeable battery.

Connections

Connect Power

Caution:

- Risk of product damage! Ensure that the power supply voltage corresponds to the voltage printed on the back or the underside of the unit.
- Before connecting the AC power cord, ensure you have completed all other connections.

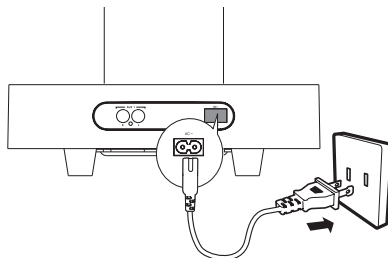

Connect the AC power cord to:

- the AC~ socket on this unit.
- the wall socket.

Connect to External Audio Device

Using AUX IN socket

- Use a RCA to RCA stereo audio cable(not included) to connect the TV's audio output sockets to the **AUX(R L)** socket on the unit.

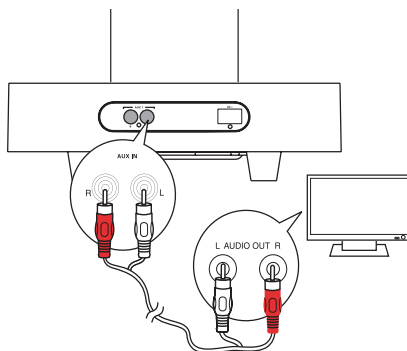

- Use a RCA to 3.5mm stereo audio cable to connect the MP3's headphone sockets to the AUX(R/L) socket on the unit.

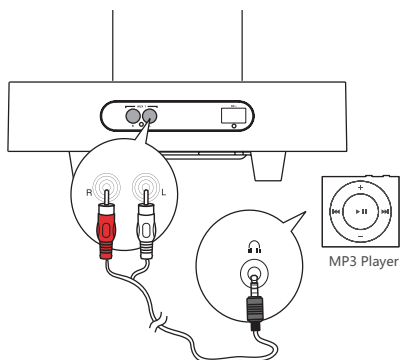

Basic Operations

Power

You can use all the functions on the main unit or the remote control after connecting to a power supply (called Standby Mode).

Turning the System On

Press the **⏻** button to turn the system on from standby mode.

Note:

The set will switch to last selected source.

Turning the System Off

Press **⏻** button on the main unit or press and hold **⏻** button on the remote control to turn the system off and go to Eco mode.

Note:

Be sure to unplug the power cord from the outlet when the system is not in use for an extended period of time.

Selecting Modes

Press **FUNCTION** button switch between **AUX**, **TUNER** and **Bluetooth** modes. The selected mode will show on the display.

Note:

If there is no signal under the Bluetooth and AUX modes, the unit will automatically switch off with in 15 minutes.

Set the Clock

The built-in clock shows the correct time in the display panel.

1. In standby mode, press and hold the **CLOCK** button to activate the clock setting mode, hour indicator will blink.
2. Set the hour with the **▲** or **▼** button.
3. Press **CLOCK** button to confirm, minute indicator will blink.
4. Set the minutes with the **▲** or **▼** button.
5. Press the **CLOCK** button to confirm, the built-in clock starts operating and the seconds start counting from 0.

Adjust Volume Level

During play, press the **+/-** buttons to increase/decrease the volume level.

Mute Sound

During play, press the **MUTE** button to mute or restore sound. Press this button again or **+** buttons to cancel the effect.

AUX Operation

You can also listen to an external audio device through this unit.

1. Press **FUNCTION** button on main unit or remote control to select AUX for your connection.
2. Operate your audio device directly for playback features.
3. Press **+/-** to adjust the volume to your desired level.

Play With Bluetooth Device

You can listen to music from a bluetooth-enabled device via this player.

Pair Bluetooth-enabled Devices Manually

The first time you connect your bluetooth device to this player, you need to pair your device to this player.

Note:

- The operational range between this player and a Bluetooth device is approximately 8 meters.
 - Before you connect a Bluetooth device to this unit, familiarize yourself with the Bluetooth capabilities of the device.
 - Compatibility with all Bluetooth devices is not guaranteed.
 - Any obstacle between this unit and a Bluetooth device can reduce the operational range.
 - Keep this player away from any other electronic device that may cause interference.
1. Turn on the Bluetooth function on your device.
 2. Switch player's source to bluetooth, Display panel shows "**BLU T**", then shows "**NO BT**" (if no bluetooth device is connected).
 3. Press and hold "**▶ II/ ⌘**" button on remote control for a few seconds to activate bluetooth pairing mode, display panel shows "**PAIR**".
 4. Search for bluetooth device with your device.
 5. Select "**PC-112563**" in the pairing list.
 6. Enter "0000" for the password if necessary, display panel shows "**BLU T**" again.
 7. To disconnect connection, turn off the bluetooth function on your device or switch the player to another source.

Tips:

- If a connection exist, hold and press "**▶ II/ ⌘**" button on remote control for a few seconds to re-activate the pairing mode, the connection will be interrupted.
- If no other bluetooth device pairs with this player within two minutes, the player will recover its previous connection.
- The player will also be disconnected when your device is moved beyond the operational range.
- If you want to reconnect your device to this player, place it within the operational range.
- If the device is moved beyond the operational range, when it is brought back, please check if the device is still connected to the player.
- If they are connected, display panel shows "**BLU T**".
- If the connection is lost, display panel shows "**NO BT**". Follow the instruction above to pair your device to the player again.

Pair with Bluetooth-enabled Device Using One Touch (NFC)

Using an NFC compatible bluetooth device, you can establish a bluetooth connection by just touching the unit with it.

- Make sure bluetooth and NFC function is enabled on your device .
- 1 Turn on the NFC function on your device.
 - Make sure your device in the wake-up mode.

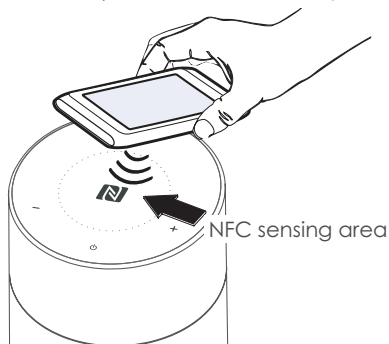

- 2 Turn on the unit and switch to bluetooth source.
- 3 Touch the NFC sensing area with your device, the unit will pair and connect with your device.
- 4 Touch this area again, the unit will disconnect the bluetooth connection.

Tips:

Some NFC-enabled mobile devices cannot pair directly with the unit via NFC, please try either one of the solutions below:

- Please download the Apps "Tap-and-Pair" from Google Play Store ([https:// play. google. com](https://play.google.com)) and install.
- Pair with the unit manually first, then touch again on the NFC sensing area.

Listen to Music from Bluetooth Device

- If the connected Bluetooth device supports Advanced Audio Distribution Profile (A2DP), you can listen to the music stored on the device through the player.
- If the device also supports Audio Video Remote Control Profile (AVRCP), you can use the player's remote control to play music stored on the device.

1. Pair your device with the player.
2. Start to play music via your device (if it supports A2DP)
3. Use supplied remote control to control play (if it supports AVRCP)
 - To pause/resume play, press the ►||/⏏.
 - To skip to a track, press the ◀,|◀◀/▶▶,▶.

Listening to the FM Radio

Presetting Stations

- **Program radio stations automatically**

- 1 Press the **FUNCTION** button to select the TUNER source.
- 2 Press and hold the **M/Clock** button for a few seconds to activate automatic programming. All available stations are programmed in the order of waveband reception strength.
 - You can preset up to 20 FM stations.
 - The first programed radio station is played automatically.

Note:

- If the system is unplugged or if a power failure occurs, the preset stations will not be erased.
- **Tune to a preset radio station**
 - Press the ◀/▶ buttons to skip to previous/ next preset radio station.

Tuning in a Station

- 1 Press and hold the ◀/▶ buttons (till the digital display moves), then release the button, the frequency changes down or up automatically until a station is found.

Troubleshooting

To keep the warranty valid, never try to repair the system yourself. If you encounter problems when using this unit, check the following points before requesting service.

No power

- Ensure that the AC cord of the apparatus is connected properly.
- Ensure that there is power at the AC outlet.
- Press standby button to turn the unit on.

Remote control does not work

- Before you press any function button, first select the correct source.
- Reduce the distance between the remote control and the unit.
- Insert the battery with its polarities (+/-) aligned as indicated.
- Replace the battery.
- Aim the remote control directly at the sensor on the front of the unit.

Poor radio reception

- Increase the distance between the unit and your NFC compatible bluetooth device or the TV and VCR.

Clock setting erased

- Power has been interrupted or the power cord has been disconnected.
- Reset the clock.

No Response From the Unit

- Disconnect and reconnect the AC power plug, then turn on the unit again.

Specifications

General

Power Requirements	AC120V~ 60Hz
Power Consumption	30W
Output Power	25W x 2 + 50W
Total Harmonic Distortion.....	1%(1KHz, 1W)
Audio Input Sensitivity.....	500mV
Frequency Response.....	40Hz - 20KHz
Unit Dimensions (W x D x H)	Φ288 x 1192mm
Product operating temperature.....	0℃-40℃

Speaker

Front Impedance	3Ω
Woofer Impedance	6Ω

Remote

Distance	6m
Angle.....	30°

Standard Accessories

AC Power cord	x 1
Remote Control	x 1
Owner's manual.....	x 1
Warranty Card.....	X 1
RCA to 3.5mm audio cable.....	x 1

- Design and specifications are subject to change without notice.