

CONTENT LIST

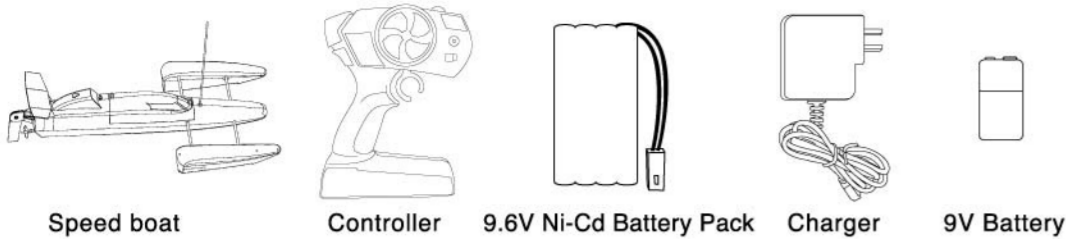

GETTING TO KNOW YOUR SPEED BOAT

Diagram #1

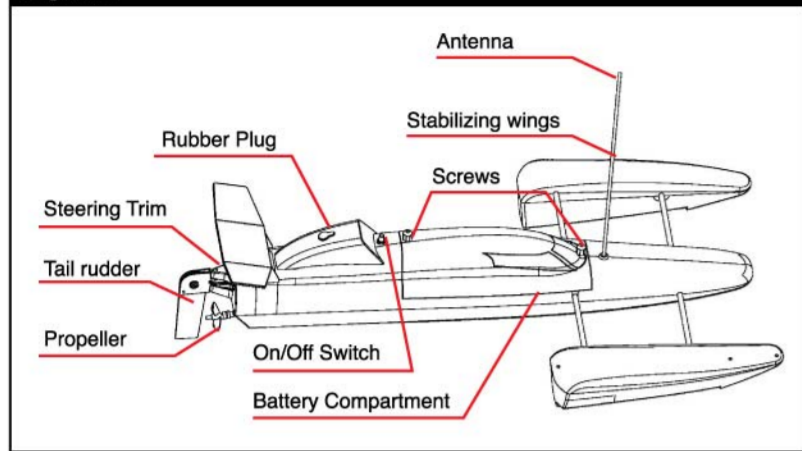

IMPORTANT:
THE INCLUDED 9.6V NI-CD BATTERY PACK IS NOT CHARGED PRIOR TO SHIPMENT AND MUST BE CHARGED BEFORE USE.

To prevent damage, the contents of the package that are listed have been packed in the tray and may be out of plain sight. Please remove all contents from the tray.

CAUTION:

Do not touch the running propeller! Do not play around anyone in water! Adult supervision is required!

INFRARED CONTROL TRANSMITTER

Diagram #2

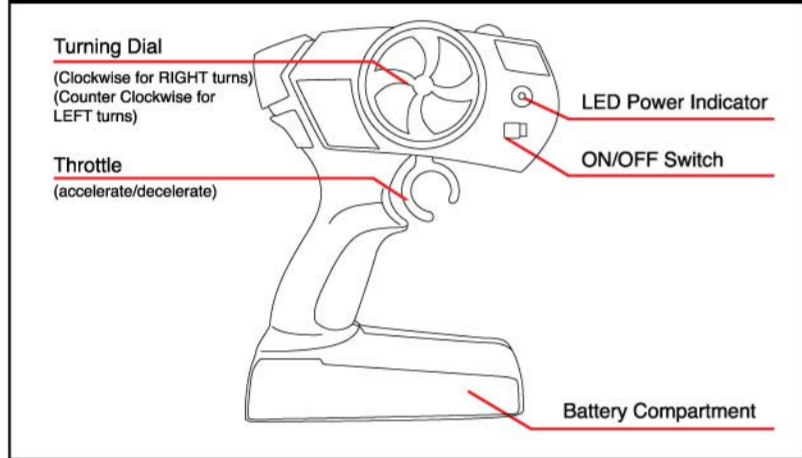

2

TROUBLE SHOOTING

| Problems | Reasons | Solutions |
|------------------|---|---|
| Sailing Problems | The battery inside the radio controller is too weak. | Replace with new alkaline batteries. |
| | There is a weak or low reception to the radio controls. | |
| | The batteries inside the boat are too weak. | Recharge or replace with new batteries inside the boat. |
| Other | The boat does not respond to the radio control. | Try playing at another location. |
| | The radio control's frequency is disrupted by something around the environment. | Some other equipment using the same radio wave could disrupt the radio control. Either play in another location or turn off the other equipment. If you are planning to race your vehicles with another friend, purchase vehicles with two different frequencies (49 MHz and 27 MHz) to avoid disruption. |

PLEASE NOTE:

This equipment has been tested and found to comply with the limits for a Class B digital device, pursuant to part 15 of the FCC Rules. These limits are designed to provide reasonable protection against harmful interference in a residential installation. This equipment generates, uses and can radiate radio frequency energy and, if not installed and used in accordance with the instructions, may cause harmful interference to radio communications. However, there is no guarantee that interference will not occur in a particular installation. If this equipment does cause harmful interference to radio or television reception, which can be determined by turning the equipment off and on, the user is encouraged to try to correct the interference by one or more of the following measures:

- Reorient or relocate the receiving antenna.
- Increase the separation between the equipment and receiver.
- Connect the equipment into an outlet on a circuit different from that to which the receiver is needed.
- Consult the dealer or an experienced radio/TV technician for help.



Ni-Cd

MADE IN CHINA

WARNING:
CHOKING HAZARD-
Small parts not for children
under 3 years



6

ignite
RADIO CONTROL

ITEM NO. 1613

CAUTION-ELECTRIC TOY
NOT RECOMMENDED FOR CHILDREN UNDER 8 YEARS OF AGE. AS WITH ALL ELECTRIC PRODUCTS, PRECAUTIONS SHOULD BE OBSERVED DURING HANDLING AND USE TO PREVENT ELECTRIC SHOCK.
INPUT: AC 100-240V 50/60Hz 0.3A
OUTPUT: DC 11.8V 280mA



BRI

IGNITE-RC.COM

Manufactured & Distributed by © 2012
Bear River International, LLC Logan, UT 84321
In affiliation with Cache Sales, LLC.
All Rights Reserved
MADE IN CHINA

RACING 99
RADIO CONTROL SPEED BOAT

INSTRUCTION MANUAL

FULL-FUNCTION 9.6V NI-CD RADIO CONTROL WATER CRAFT

*IMPORTANT:

IF BOAT DOES NOT RESPOND PROPERLY, PLEASE RECHARGE OR REPLACE THE 9.6V NI-CD BATTERY PACK IN THE WATER CRAFT OR REPLACE THE 9V BATTERY IN THE CONTROLLER

**** NOTE: THE MANUFACTURER IS NOT RESPONSIBLE FOR ANY RADIO OR TV INTERFERENCE CAUSED BY UNAUTHORIZED MODIFICATIONS TO THIS EQUIPMENT. SUCH MODIFICATIONS COULD VOID THE USER'S AUTHORITY TO OPERATE THE EQUIPMENT.**

WARNING:

Changes or modifications to this unit not expressly approved by the party responsible for compliance could void the user's authority to operate the equipment.

This device complies with Part 15 of the FCC Rules. Operation is subject to the following two conditions:

1. This device may not cause harmful interference, and
2. This device must accept any interference received, including interference that may cause undesired operation.

PLEASE DO NOT RETURN TO STORE

For more information please email Consumer Services:
help@bearriver.net

DO NOT MIX ALKALINE, STANDARD (CARBON ZINC) OR RECHARGEABLE (NICKEL CADMIUM) BATTERIES.

DO NOT MIX OLD AND NEW BATTERIES.

DO NOT DISPOSE OF BATTERIES IN FIRE, BATTERIES MAY EXPLODE OR LEAK.

9.6 V 700 mAh RE-CHARGEABLE NI-Cd BATTERY, 1-9V HEAVY DUTY BATTERY AND 100-240V DIGITAL CLASS 2 CHARGER INCLUDED

COLORS AND DECORATIONS MAY VARY. KEEP CONTENT DETAILS FOR FUTURE REFERENCE.

WARNING:

CHOKING HAZARD-Small parts.
Not for children under 3 years.

CONTROLLER BATTERY INSTALLATION

Diagram #3

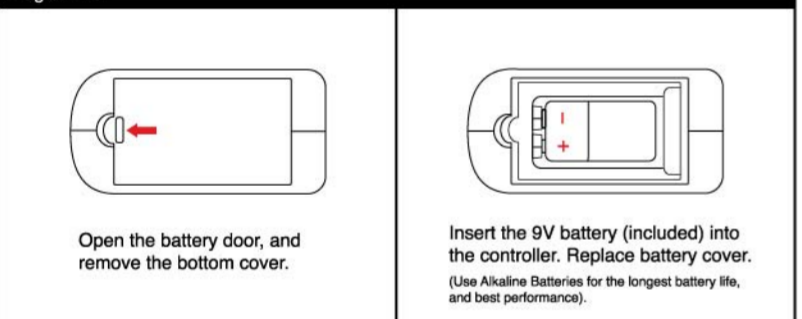

PLEASE NOTE:

- A) Make sure the batteries have been inserted correctly (+ or -) into the controller.
- B) If the speed boat does not respond properly, please replace the alkaline batteries in the controller or recharge speed boat battery.

Remember to take out all the batteries from the controller and speed boat if the water craft will not be used for a long time.

DO NOT MIX ALKALINE, STANDARD (CARBON ZINC) OR RECHARGEABLE (NICKEL CADMIUM) BATTERIES.

DO NOT MIX OLD AND NEW BATTERIES.

DO NOT DISPOSE OF BATTERIES IN FIRE, BATTERIES MAY EXPLODE OR LEAK.

REMEMBER:

Before you recharge the battery, wait 10-15 minutes to let the battery cool down.

Never leave unattended while charging.

DANGER!

NEVER INSERT ANY SHARP OBJECTS, PINS OR SCREWS INTO THE SPEED BOAT AS THIS MAY PUNCTURE THE VESSEL OR THE BATTERY!

CHARGING THE BATTERY PACK

Diagram #4

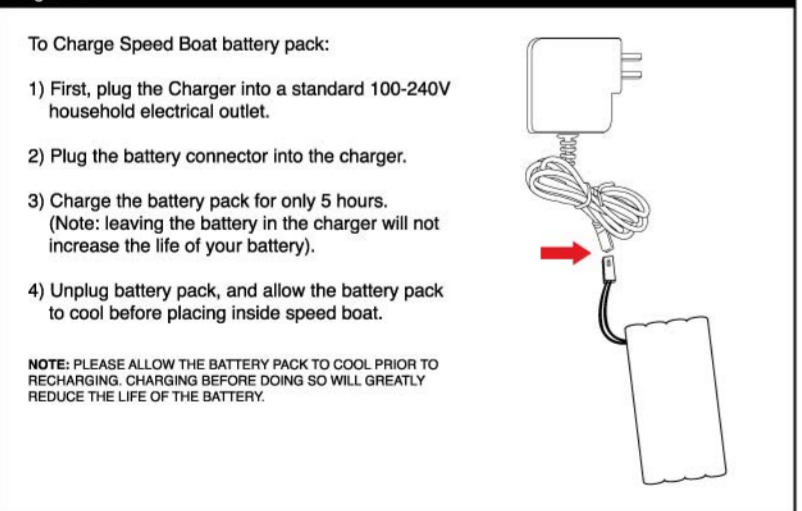

Cautions

1. Make sure you always use new or fully charged batteries in the controller.
2. Do not operate the speed boat if it becomes damaged in any way.
3. Check that the infrared signal from the controller is making a connection with the speed boat before operating.
4. Try not to crash the speed boat as this may cause damage.
5. Check that the area is clear of all obstacles before you operate.
6. Adult supervision is always recommended.
7. Never operate near animals or people in the water. Keep rudder away from your fingers, hair, eyes and other body parts. Stay away from obstacles and electrical hazards.

Warning

1. Non-rechargeable batteries are not to be recharged.
2. Rechargeable batteries are only to be charged under adult supervision.
3. Rechargeable batteries are to be removed from the toy before being charged.
4. Different types of batteries or new and used batteries are not to be mixed.
5. Batteries are to be inserted with the correct polarity.
6. Exhausted batteries are to be removed from the toy.
7. The supply terminals are not to be short-circuited.

OPERATING IN WATER

Location - Use in a wide-open area of water away from breakable items. Avoid driving near currents, vents and or pumps, as these may overpower the speed boat and make it difficult to control. NOTE: Always get permission to use your speed boat in each water location.

ATTENTION PARENTS: The battery charger and battery pack need to be periodically examined for potential hazards and any potentially hazardous parts to be repaired or replaced.

3

SPEED BOAT PREPARATIONS

Diagram #5

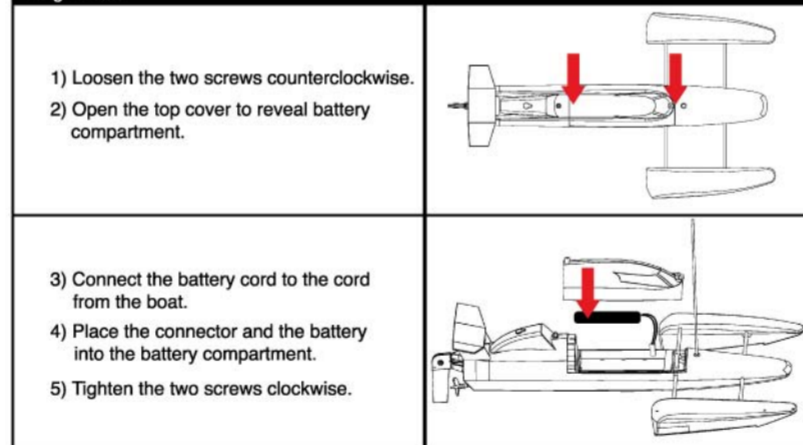

USING YOUR SPEED BOAT

Diagram #6

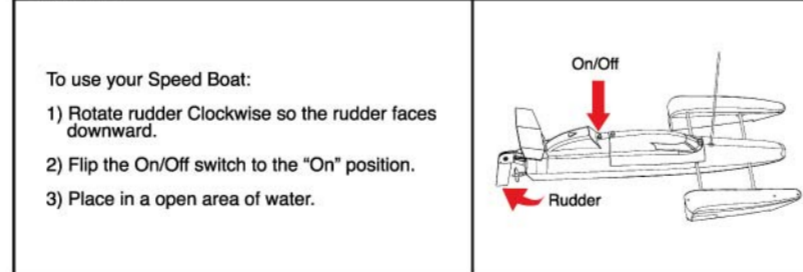

DANGER!

NEVER TOUCH THE PROPELLER WHILE IT IS TURNING

SPEED BOAT CONTROLS

Diagram #8

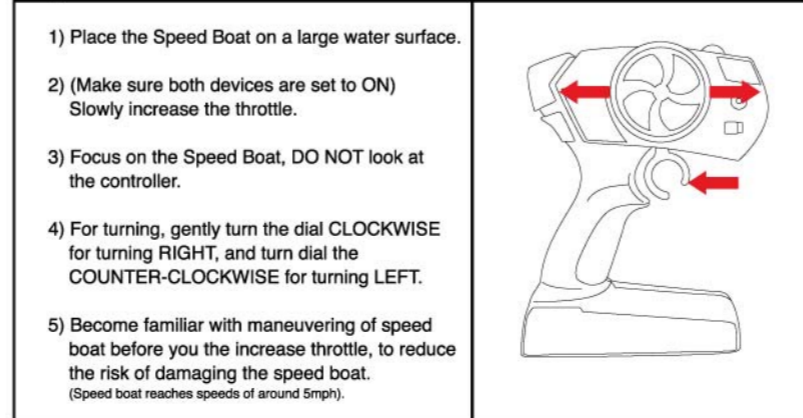

4

TRIMMING METHODS

Diagram #7

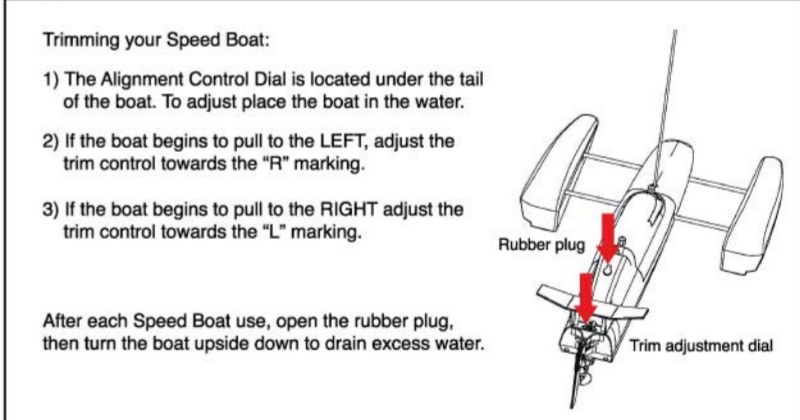

NOTE:

Operating multiple speed boats with the same frequency in close proximity will cause interference and poor performance. Two frequency bands are available to play two at the same time.

Works best away from electrical hazards and large obstacles.

CAUTIONS AND WARNINGS:

- Don't cover the lens of the transmitter. No signal will be released while the lens is covered.
- Do not recharge the battery pack if it is warm to the touch. Allow the battery pack to cool before recharging.
- Recharging a warm battery pack will shorten the life of the battery pack.
- Recharging batteries should be done by an adult.
- Motor of Speed Boat will get hot, use caution in handling.
- Do not charge a damaged, leaking, hot or wet Battery Pack.
- When not in use, charger should be unplugged from the electrical outlet.
- Under no circumstance should the battery pack be disposed of in a fire. This may cause injury, leakage or explosion.
- Please dispose of Ni-Cd battery cells properly.
- Do not break, open or disassemble the battery pack.
- Do not use the battery pack or charger for any other reason than charging and running the remote control speed boat.
- Do not stall the motor during use.

CAUTIONS OPERATING IN WATER

Do not operate the boat where there is debris or plants in the water, as the could cause damage to the propeller or hull. Do not use in sea water (ocean), as parts will become damaged.

Never play outdoors during extreme weather, such as thunderstorms.

Avoid hard crashes.

Do not operate the boat when there is a strong current or wind.

Never touch the propeller while it is turning.

Always get the boat out of the water before the battery power fails.

Never give the boat or controller to any child under the age of 3, as it contains small parts.

Do not allow the antenna to get wet, as this will affect the distance of the controller.

Never use chemicals including benzene, alcohol, or thinning agents to clean the boat, as this may damage the boat.

When not in use, remove batteries from compartments (boat and controller).

Normal working distance is about 80 feet.

5