

F360 Introduction

V1.0

Content

Chapter 1. F360 Product Introduction..... i

1.1 Product Introduction..... i

1.2 Product Appearance i

1.3 Specifications..... ii

 1.3.1 Dimensions ii

 1.3.2 Screen ii

 1.3.3 Communication Interface ii

 1.3.4 Battery and Power Source..... iii

 1.3.5 Audio..... iii

 1.3.6 Camera iii

 1.3.7 SIM card iii

 1.3.8 PSAM card..... iii

 1.3.9 Contact IC card Reader iii

 1.3.10 Contactless IC Card Reader iv

 1.3.11 Features v

1.4 Certifications..... v

1.5 Installation v

Warning: ix

Chapter 1. F360 Product Introduction

1.1 Product Introduction

Feitian F360 is a smart mobile POS product with PCI certification. It has a stylish and smart design. Connect with smart phone or tablet via Bluetooth interface, you can easily and quickly complete the payment process. It can achieve payment progress anytime anywhere which provides end users with a new experience of payment.

This product is developed based on Android 13 operating system, software including android system and secure system, the function is simple and easy to use.

Both android system and secure system can be upgraded remotely or upgraded by TF card/OTG+U disk, lower the following cost of development and maintenance.

The features of this product:

■ Portable

The appearance is portable, suitable for mobile use.

■ Powerful

Support contact card and contactless card. Support WiFi and Bluetooth.

Support 1* type C Port, support USB2.0 and OTG.

■ Certified

CE, PCI, EMV L1&L2, EMV CL L1, Amex, payWave, Paypass, Discover, JCB, Pure, qUICS, TQM(TBD) certified.

■ Remote upgrading

Firmware can be upgraded remotely, reducing the cost of late development and maintenance.

1.2 Product Appearance

The F360 product appearance is shown as follows:



Figure 1 F360 appearance figure

1.3 Specifications

1.3.1 Dimensions

Size: $\Phi 98.5 \times H22.9$ (mm)

1.3.2 Screen

Use a 3.2-inch screen with a resolution of 320*480 and capacitive Capacitive Touch Panel.

1.3.3 Communication Interface

■ RF Band

4G: FDD-LTE:B2/4/5/7

TDD-LTE:B38

3G: WCDMA:B2/4/5

2G: GPRS/EGPRS 850/1900

■ Type-C USB port

When the device is connected to the host(for example,PC)through this interface,this interface provides functions such as charging.

■WiFi

This device can be connected to 2.4G/5G network,support 802.11 a/b/g/n/ac.

■Bluetooth4.2

This device can be connected to smart phone or bluetooth headset throughthis interface.

■GPS

This device supports GPS

■NFC

NFC is a POS function, which supports 13.56MHz, ISO/IEC 14443, ISO18092, Type A&B、Felica, Mifare card.

1.3.4 Battery and Power Source

Non-Removable polymer lithium battery,3.7V/2000mAh,with charge protection and RTC battery.

1.3.5 Audio

■Speaker

This device can play audio through this interface.

■Buzzer

Notify the user by beeping when needed.

1.3.6 Camera

■Front Camera

A front camera: 0.3/2M, FF

1.3.7 SIM card

This device can insert into one sim card, and optional one ESIM integrated inside.

1.3.8 PSAM card

This device can insert into PSAM card.

1.3.9 Contact IC card Reader

Support contact IC card(ISO/IEC7816-1/2/3/4ChipCard),TypeA/B/C.

When inserting the IC card, please let the chip side toward the side of the screen.

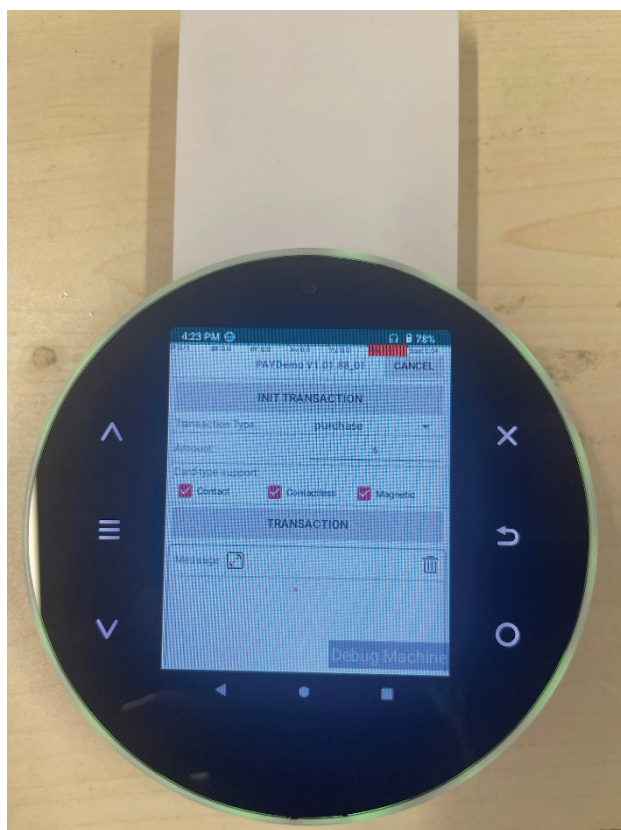

1.3.10 Contactless IC Card Reader

Support contactless IC card(ISO/IEC14443TypeA,ISO/IEC14443TypeB, working frequency 13.56MHz)

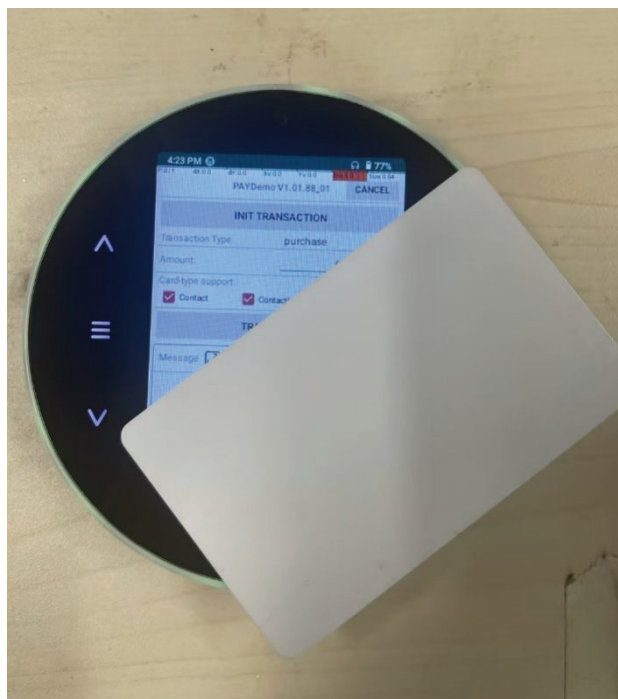

1.3.11 Features

- Tamper-proof and anti-power-down protection
- Support DUKPT key systems
- RSA、AES、3DES、SHA-1、SHA-256; Support RSA, AES, 3DES,SHA-1, SHA-256
- Support SM2, SM3, SM4
- Physical tamper-proof has self-destruction function
- Support redevelopment

1.4 Certifications

- PCI PTS 6.2 certified
- EMV L1/L2
- EMV Contactless L1
- PBOC3.0 L1/L2
- Master Card PayPass
- Visa PayWave
- CE
- DSM
- UN38.3
- ULRoHS
- Telec&JATE
- Amex
- Discover
- PURE

1.5 Installation

Step 1. Charging the device

- Insert the USB charging cable into the Type-C port on the down side of the device.

- Connect the other end of the USB charging cable into a powered USB socket.
- A charging symbol will appear over the battery symbol in the top right corner of the device during charging.
- Charging of the battery will typically take between 1 and 3 hours, whilst not in use.
- Battery condition is indicated in the display when the device is switched on.
- The terminal is fitted with an internal rechargeable battery which can be removed or replaced. This battery should be charged for at least 1 hours when using the terminal for the first time. It is recommended that the battery is charged to at least 40% of its capacity every 4 months.

Step 2. Turning on the device

- Hold down the power button 2 seconds, the system will start.
- If required, remove the protective film from the display.

Step 3. Mobile payment application

Please follow the instructions provided by your bank or service provider to download the mobile application onto this device.

Step 4. Performing a chip card sale transaction with PIN

- When prompted, insert the customer's chip card into the slot at the right hand side of the device with the chip facing upwards.
- Follow the instructions provided by your bank or service provider to complete the transaction.

Step 5. Performing a contactless transaction

- Transactions may be completed using a contactless card or enabled product. The contactless symbol is printed on the back of the device.
- To read a contactless card it must be positioned in close proximity to the device over the contactless symbol.
- Follow the instructions provided by your bank or service provider to complete the transaction.

Troubleshooting

In the unlikely event you experience issues with this product, please follow the guidelines below. If this does not resolve the issue, please contact your solution provider for further assistance.

No display

- Charge the device with the supplied USB cable.
- Ensure the USB socket being used is powered.

Poor battery life

- Ensure the power is being supplied during charging.
- Check battery charge indicator is at maximum
- Charge for 3 hours to ensure a full charge whilst not in use.

Cannot read Cards

- Ensure the chip card has been inserted in the correct orientation.
- Ensure the contactless card has been placed at a distance of 0 to 4 cm from the device.
- Test with another card of the same type.

Caution and Safety Instructions

- Do not attempt to disassemble, modify, service or repair any part.
- Do not use if damaged or with signs of tampering.
- Only use the device with supplied or manufacturer-certified accessories.
- To avoid the potential hazard of electrical shock do not use in wet environments or during an electrical storm.
- Do not use in proximity of potentially flammable gases or substances.
- Ensure cables used do not cause a trip hazard or risk the device being dropped on to a hard surface.
- Do not expose to excessive heat or cold. Only operate between -10 °C and 50 °C.

- Before cleaning, disconnect from the electrical outlet. Use only a dry or dampened soft cloth.
- Do not immerse, use liquids, sprays or aerosol cleaners. Clean all spillages quickly.
- This device is intended for handheld use only or in an approved cradle/stand
- Dispose any part in an environmentally sound manner and in accordance with local laws.
- F360 product will not be held liable for any damage resulting from user operation that does not comply with the above-stated guidance.
- If the device will be stored/unused for extended periods of time, then it is imperative that the battery be recharged every six months or sooner to at least 30–40% of maximum charge while the terminal is in 'OFF' position.

Frequency bands and power

- Maximum radio frequency power transmitted in the frequency bands in which this equipment operates is below the limit values specified in the corresponding Harmonized Standards.
- The frequency bands and power limits applicable to this equipment are: Bluetooth:
NFC: 13.56 MHz, Type-A/B, Felica.

Warning:

FCC Statement

Any Changes or modifications not expressly approved by the party responsible for compliance could void the user's authority to operate the equipment.

This device complies with part 15 of the FCC Rules. Operation is subject to the following two conditions: (1) This device may not cause harmful interference, and

(2) This device must accept any interference received, including interference that may cause undesired operation.

Note: This equipment has been tested and found to comply with the limits for a Class B digital device, pursuant to part 15 of the FCC Rules. These limits are designed to provide reasonable protection against harmful interference in a residential installation. This equipment generates,uses and can radiate radio frequency energy and, if not installed and used in accordance with the instructions, may cause harmful interference to radio communications. However, there is no guarantee that interference will not occur in a particular installation. If this equipment does cause harmful interfer-ence to radio or television reception, which can be determined by turning the equipment off and on, the user is encouraged to try to correct the interference by one or more of the following measures:

—Reorient or relocate the receiving antenna.

—Increase the separation between the equipment and receiver.

—Connect the equipment into an outlet on a circuit different from that to which the receiver is connected.

—Consult the dealer or an experienced radio/TV technician for help.

CAUTION

Risk of explosion if the battery is replaced by an incorrect type;

disposal of a battery into fire or a hot oven, or mechanically crushing or cutting of a battery, that can result in an explosion; leaving a battery in an extremely high temperature surrounding environment that can result in an explosion or the leakage of flammable liquid or gas; a battery subjected to extremely low air pressure that may result in an explosion or the leakage of flammable liquid or gas.

Non-compliance with the above restrictions may result in violation of RF exposure guidelines.

ISED compliance statement

This device is restricted to indoor use when operating in the 5150 to 5250 MHz frequency range. Restriction

d'utilisation: ce dispositif est réservé à l'usage intérieur lorsqu'il fonctionne dans la gamme de fréquences 5150 à 5250 MHz.

This device contains licence-exempt transmitter(s)/receiv-er(s) that comply with Innovation, Science and Economic Development Canada's licence-exempt RSS(s). Operation is subject to the following two conditions:

(1) This device may not cause interference.

(2) This device must accept any interference, including interference that may cause undesired operation of the device. L'émetteur/récepteur exempt de licence contenu dans le présent appareil est conforme aux CNR d'Innovation, Sciences et Développement économique Canada applica-bles aux appareils radio exempts de licence. L'exploitation est autorisée aux deux conditions suivantes :

(1) L'appareil ne doit pas produire de brouillage;

(2) L'appareil doit accepter tout brouillage radioélectrique subi, même si le brouillage est susceptible d'en comprom-ettre le fonctionnement

SAR statement

This equipment complies with FCC/ISED radiation exposure limits set forth for an uncontrolled environment. End user must follow the specific operating instructions for satisfying RF exposure compliance. This transmitter must not be co-located or operating in conjunction with any other antenna or transmitter. The portable device is designed to meet the requirements for exposure to radio waves established by the ISED. These requirements set a SAR limit of 1.6 W/kg averaged over one gram of tissue. The highest SAR value reported under this standard during product certification for use when properly worn on the body.

Déclaration DAS

Cet équipement est conforme aux limites d'exposition aux rayonnements FCC/ISED définies pour un environnement non contrôlé. L'utilisateur final doit suivre les instructions d'utilisation spécifiques pour satisfaire à la conformité en matière d'exposition aux RF. Cet émetteur ne doit pas être placé à proximité ou fonctionner en conjonction avec une autre antenne ou un autre émetteur.

L'appareil portable est conçu pour répondre aux exigences d'exposition aux ondes radio établies par l'ISED. Ces exigences fixent une limite DAS de 1,6 W/kg en moyenne sur un gramme de tissu. La valeur DAS la plus élevée signalée dans le cadre de cette norme lors de la certification du produit pour une utilisation lorsqu'il est correctement porté sur le corps.