



## USER'S GUIDE

V:1705-0420-11



# ISP801B

## Wireless Speaker System for iPod + iPhone

For the most up-to-date version of this User's Guide, go to **[www.ilive.net](http://www.ilive.net)**





# Warnings and Precautions

- **CAUTION:** TO PREVENT ELECTRIC SHOCK, MATCH WIDE BLADE OF PLUG TO WIDE SLOT, FULLY INSERT.
- **WARNING:** To reduce the risk of fire or electric shock, do not expose this apparatus to rain or moisture.
- **AVERTISSEMENT:** Pour réduire le risque d'incendie ou de choc électrique, ne pas exposer cet appareil sous la pluie et l'humidité.
- **CAUTION:** Use of any controls or adjustments or performance of procedures other than those herein specified may result in hazardous radiation exposure.
- **WARNING:** Changes or modifications to this unit not expressly approved by the party responsible for compliance could void the user's authority to operate the equipment.
- **WARNING:** Do not place the unit on top of any soft, porous, or sensitive surfaces to avoid damaging the surface. Use a protective barrier between the unit and surface to protect the surface.
- **WARNING:** Use of this unit near fluorescent lighting may cause interference regarding use of the remote. If the unit is displaying erratic behavior move away from any fluorescent lighting, as it may be the cause.
- **CAUTION:** Danger of explosion if battery is incorrectly replaced. Replace only with the same or equivalent type.
- **PRÉCAUTION:** Danger d'explosion si les piles sont remplacées de façon incorrect. Remplacer les piles seulement par le même type de pile ou l'équivalent.
- **WARNING:** There is a danger of explosion if you attempt to charge standard Alkaline batteries in the unit. Only use rechargeable NiMH batteries.
- **WARNING:** The battery, batteries, and battery pack shall not be exposed to excessive heat such as sunshine, fire, or the like.

- **WARNING:** Lithium batteries, like all rechargeable batteries are recyclable and should be recycled or disposed of in normal household waste. Contact your local government for disposal or recycling practices in your area. They should never be incinerated since they might explode.
- **WARNING:** Shock hazard - Do Not Open.
- **AVIS: RISQUE DE CHOC ÉLECTRIQUE - NE PAS OUVRIR**

Mains Plug or Direct plug-in adapter is used as disconnect device and it should remain readily operable during intended use. In order to disconnect the apparatus from the mains completely, the Mains Plug or Direct plug-in adapter should be disconnected from the mains socket outlet completely.

*La fiche d'alimentation ou adaptateur de courant est utilisé comme dispositif de déconnexion et doit rester accessible pendant l'utilisation. Pour mettre l'appareil hors tension, la fiche ou adaptateur de courant doit être débranché de la prise de courant.*

Do not mix old and new batteries.

Do not mix alkaline, standard (carbon-zinc), or rechargeable (ni-cad, ni-mh, etc) batteries.

*No mezcle baterías viejas y nuevas.*

*No mezcle baterías alcalinas, estándar (carbón-zinc) o recargables (ni-cad, ni-mh, etc.).*

**CAUTION**  
RISK OF ELECTRIC SHOCK  
DO NOT OPEN

**ATTENTION**  
RISQUE D'ÉLECTROCUTION  
NE PAS OUVRIR

**WARNING:** TO REDUCE THE RISK OF ELECTRIC SHOCK, DO NOT REMOVE COVER (OR BACK). NO USER-SERVICEABLE PARTS INSIDE. REFER SERVICING TO QUALIFIED SERVICE PERSONNEL.



The lightning flash with arrowhead symbol, within an equilateral triangle, is intended to alert the user to the presence of uninsulated "dangerous voltage" within the product's enclosure that may be of sufficient magnitude to constitute a risk of electric shock to persons.



The exclamation point within an equilateral triangle is intended to alert the user to the presence of important operating and maintenance (servicing) instructions in the literature accompanying the appliance.





# Important Safety Instructions

1. Read these Instructions.
2. Keep these Instructions.
3. Heed all Warnings.
4. Follow all instructions.
5. Do not use this apparatus near water.
6. Clean only with a dry cloth.
7. Do not block any ventilation openings. Install in accordance with the manufacturer's instructions.
8. Do not install near any heat sources such as radiators, heat registers, stoves, or other apparatus (including amplifiers) that produce heat.
9. Do not defeat the safety purpose of the polarized or grounding - type plug. A polarized plug has two blades with one wider than the other. A grounding type plug has two blades and a third grounding prong. The wide blade or the third prong are provided for your safety. When the provided plug does not fit into your outlet, consult an electrician for replacement of the obsolete outlet.
10. Protect the power cord from being walked on or pinched particularly at plugs, convenience receptacles, and the point where they exit from the apparatus.
11. Only use attachments/accessories specified by the manufacturer.
12.  Use only with a cart, stand, tripod, bracket, or table specified by the manufacturer, or sold with the apparatus. When a cart is used, use caution when moving the cart/apparatus combination to avoid injury from tip-over.
13. Unplug this apparatus during lightning storms or when unused for long periods of time.
14. Refer all servicing to qualified service personnel. Servicing is required when the apparatus has been damaged in any way, such as power-supply cord or plug is damaged, liquid has been spilled or objects have fallen into the apparatus, the apparatus has been exposed to rain or moisture, does not operate normally, or has been dropped.

**Special note:** When placing your unit on a lacquered or natural finish, protect your furniture with a cloth or other protective material.

## FCC Warnings

**WARNING:** Changes or modifications to this unit not expressly approved by the party responsible for compliance could void the user's authority to operate the equipment.

**NOTE:** This equipment has been tested and found to comply with the limits for a Class B digital device, pursuant to Part 15 of the FCC Rules. These limits are designed to provide reasonable protection against harmful interference in a residential installation. This equipment generates, uses, and can radiate radio frequency energy and, if not installed and used in accordance with the instructions, may cause harmful interference to radio communications. However, there is no guarantee that interference will not occur in a particular installation. If this equipment does cause harmful interference to radio or television reception, which can be determined by turning the equipment off and on, the user is encouraged to try to correct the interference by one or more of the following measures:

- Reorient or relocate the receiving antenna.
- Increase the separation between the equipment and receiver.
- Connect the equipment into an outlet on a circuit different from that to which the receiver is connected.
- Consult the dealer or an experienced radio/TV technician for help.

## Additional Warnings

- The apparatus shall not be exposed to dripping or splashing and that no objects filled with liquids, such as vases, shall be placed on apparatus.  
*L'appareil ne doit pas être exposé aux écoulements ou aux éclaboussures et aucun objet ne contenant de liquide, tel qu'un vase, ne doit être placé sur l'objet.*
- Battery shall not be exposed to excessive heat such as sunshine, fire or the like.  
*Les piles ne doivent pas être exposées à de forte chaleur, tel qu'à la lumière du soleil, au feu ou autres choses de semblable.*
- Caution marking is located at the rear or bottom of the apparatus.  
*Attention marquage est situé sur le panneau arrière ou inférieur de l'unité.*
- The marking information is located at the rear or bottom of apparatus.  
*Le marquage est situé sur le panneau arrière ou inférieur de l'unité.*



This symbol indicates that this product incorporates double insulation between hazardous mains voltage and user accessible parts.

This equipment complies with FCC radiation exposure limits set forth for an uncontrolled environment. This equipment should be installed and operated with minimum distance 20cm between the radiator & your body.





## Wireless Speaker System for iPod + iPhone

### Dock - Features

- Made for iPod and iPhone
- Plays and charges docked iPod and iPhone
- iPod and iPhone authentication IC
- 2.4GHz wireless
- 3.5mm audio input
- DC power input: requires an AC/DC power adapter (included)

### Included

- Remote control: requires 1 CR2025 battery (included)
- 2 rubber spacers
- 3 AC/DC power adapters
- Warranty card
- User's guide

### Wireless Speakers - Features

- 2.4GHz wireless
- DC power input: requires an AC/DC power adapter (included)
- DC battery power: requires 4 D batteries (not included)





## Table of Contents

<b>Wireless Speaker System for iPod + iPhone .....</b>	<b>4</b>
Dock - Features	
Included	
Wireless Speakers - Features	
<b>Table of Contents.....</b>	<b>5</b>
<b>Introduction .....</b>	<b>6</b>
<b>Setup.....</b>	<b>8</b>
Power - Base Station	
Power - Wireless Speakers	
Remote	
<b>Wireless Speakers Setup .....</b>	<b>9</b>
Important Note	
What does it mean to pair?	
Additional Information	
Pairing the Wireless Speakers	
<b>iPod and iPhone.....</b>	<b>10</b>
Docking an iPod or iPhone	
Playing a Docked iPod or iPhone	
<b>Audio Input .....</b>	<b>11</b>
Using the 3.5mm Audio Input	
<b>Company Information .....</b>	<b>12</b>
International Support	
Contact Information	
Green Initiative	





## Introduction

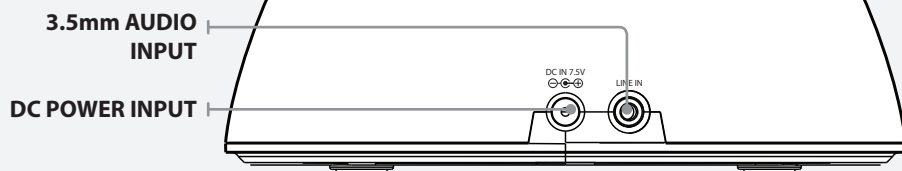
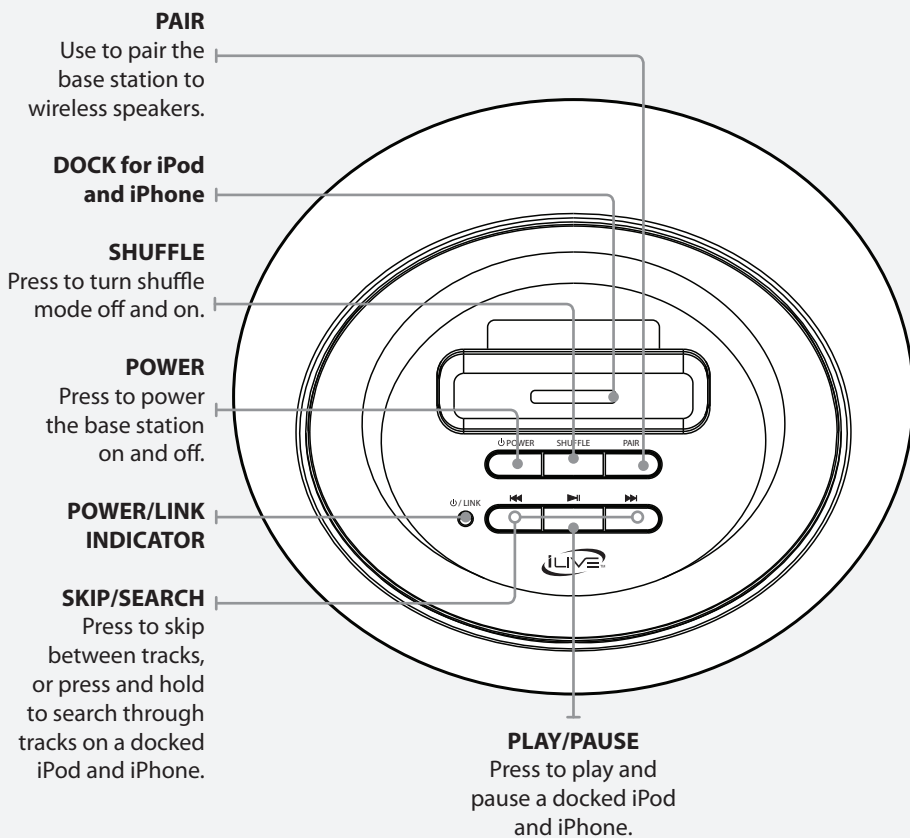

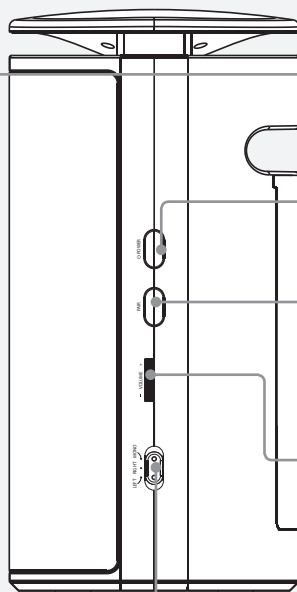
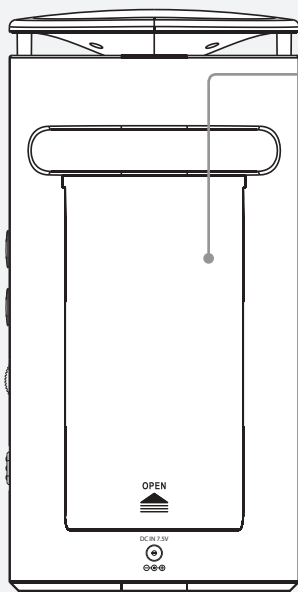

### **BATTERY COMPARTMENT**

Requires 4 D batteries (not included)

### **POWER**

Press and hold to power on the wireless speaker.

### **PAIR**

Use to pair the wireless speaker with the base station.

### **VOLUME**

Toggle to adjust the volume.

### **LEFT/RIGHT/MONO**

Adjust to switch the wireless speaker into left, right, and mono audio modes.

### **VOLUME**

Press to adjust the volume on the wireless speaker.

### **PLAY/PAUSE**

Press to play and pause a docked iPod and iPhone.

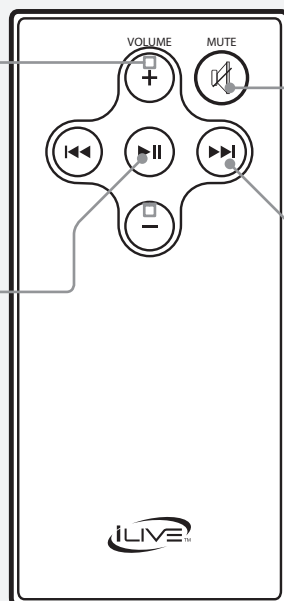

### **MUTE**

Press to mute the volume from the wireless speakers.

### **SKIP/SEARCH**

Press to skip between tracks, or press and hold to search through tracks on a docked iPod and iPhone.



## Setup

### Power - Base Station

DC power input: requires an AC/DC power adapter (included)

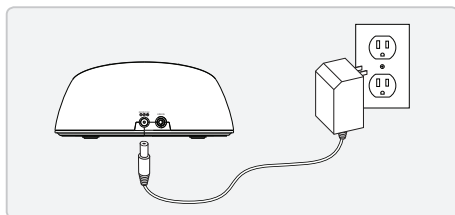

### Power - Wireless Speakers

DC power input: requires an AC/DC power adapter (included)

DC battery power: requires 4 D batteries (not included)

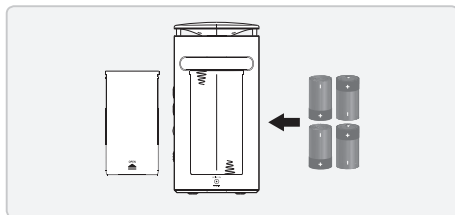
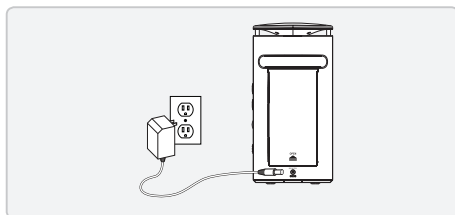

### Remote

Remote control: requires 1 CR2025 battery (pre-installed)

When using the remote control, point it in the direction of the wireless speakers.

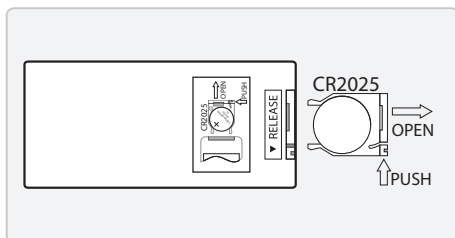

**WARNING:** The remote control's button cell battery contains mercury. Do not put in the trash, instead recycle or dispose of as hazardous waste.





## Wireless Speakers Setup

### Important Note

While the wireless speakers were paired at the factory to allow for immediate operation, they will occasionally become un-paired in transit. Un-pairing can also occur in day-to-day operation due to different environmental influences. This is normal. Should this occur, please follow the pairing instructions below.

### What does it mean to pair?

Pairing allows the base station to recognize a wireless speaker. Once a wireless speaker is paired, the base unit will transmit audio to it.

### Additional Information

- Once paired, the wireless speaker can be moved up to 200ft (line-of-site) or up to 90ft (indoors) depending on environmental conditions. Should the sound drop or become garbled it will be necessary to move the speaker to another location in order to receive the signal clearly.
- Up to 8 wireless speakers can be paired with one base station. Additional speakers sold separately.

Link Indicator	System Status
OFF	Powered off
SLOW FLASHES	Standby mode
QUICK FLASHES	Attempting to pair
SOLID LIGHT	Paired and playing

### Pairing the Wireless Speakers

*Keep the base station and all wireless speakers within 4 feet of each other when you pair them.*

1. Plug the base station into a power source and press the **POWER** button to power the base station on.

*The base station Link Indicator will flash when the base station is powered on.*

2. Plug the wireless speaker into a power source or insert 4 D batteries (not included) and press and hold the **POWER** button to power the wireless speaker on.

*The wireless speaker Link Indicator will flash when the wireless speaker is powered on.*

3. Press the **PAIR** button on the base station and the **PAIR** button on the wireless speaker.

*After pairing, the speaker may take up to 30 seconds to begin playing audio from the base station.*

4. Repeat steps 1-3 for each additional wireless speaker.





## iPod and iPhone

### Docking an iPod or iPhone

1. Use the included rubber spacer as needed to fit your iPod or iPhone into the dock.
2. Connect the iPod or iPhone to the connector inside the Dock for iPod and iPhone.
3. When the speaker is plugged in, using AC power, the docked iPod or iPhone will charge.

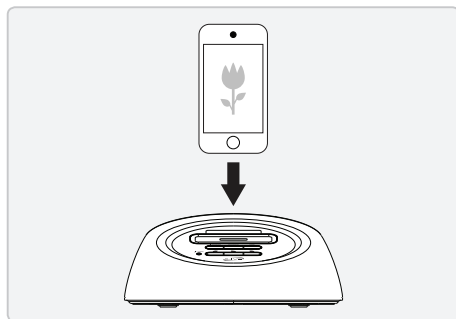

### Playing a Docked iPod or iPhone

1. Follow the instructions for Docking an iPod or iPhone.
2. Press the **PLAY/PAUSE** button to begin playing the docked iPod or iPhone.

#### **Important Note:**

*When the 3.5mm audio cable is connected, the base station will automatically switch to Line In mode.*

*Disconnect the 3.5mm audio cable to switch from Line In mode to iPod mode.*





## Audio Input

### Using the 3.5mm Audio Input

Requires a 3.5mm audio cable  
(not included)

1. Connect a 3.5mm audio cable to the **3.5MM AUDIO INPUT** on the speaker and an audio output on an MP3 player or other audio source.
2. When the 3.5mm audio cable is connected, the base station will automatically switch to Line In mode.

*Disconnect the 3.5mm audio cable to switch from Line In mode to iPod mode.*

3. Use the native controls on the connected MP3 player or other audio source to play and control audio played through the speaker.





## Company Information

### International Support

To download this User's Guide in English, Spanish, or French, visit the support section at [www.ilive.net](http://www.ilive.net).

Para transferir esta guía de usuario en inglés, español, o francés, visite la sección de la ayuda en [www.ilive.net](http://www.ilive.net).

Pour télécharger ce guide de l'utilisateur en anglais, espagnol, ou français, visitez la section de soutien chez [www.ilive.net](http://www.ilive.net).

### Contact Information

**Phone:** 1-888-999-4215

**Email:** [customerservice@ilive.net](mailto:customerservice@ilive.net)

**Parts Email:** [partsinfo@dpi-global.com](mailto:partsinfo@dpi-global.com)

**Website:** [www.ilive.net](http://www.ilive.net)

### Green Initiative



Environmental Commitment to 'Protect for Today and Sustain for Tomorrow'

2009 marked the official launch of DPI, Inc.'s corporate campaign for a greener and cleaner world. DPI is building upon environmental initiatives introduced at all of their facilities to help formulate and sustain significant and important conservation efforts within its manufacturing and marketing communities. In addition to targeting and selecting energy efficient product features, and structuring 'green office' procedures, other initial program efforts include:

- Reduction of all packaging sizes
- Recyclable plastics for clamshell packages, with a plan to eventually replace plastic with recyclable paper
- Recycled fiber board in place of the polyfoam in packing boxes
- Recycled plastics in place of the virgin material in product construction