

Welcome,

To begin using your system, please register either logging into www.iTextAlert.com or calling 855-810-2992. Please note that the activation reminder will be present on your Hub until it has been registered. You will not receive SMS alerts to your cell phone until you have completed activation.

For customer service or technical support, please call 855-810-2992 between the hours of 7:00 AM to 7:00 PM Central time zone, Monday through Friday or visit us at www.iTextAlert.com.

Thank you for purchasing the iTA-1 monitoring and alerting system. With this product, you have the ability to monitor up to 8 remote sensing devices using wireless technology and the convenience of your cell phone. The iTA-1 allows you to receive alerts from and to send commands to your Hub via SMS (text) messaging.

Activation

iTextAlert

Quick Start Guide

Model iTA-1 Rev. A

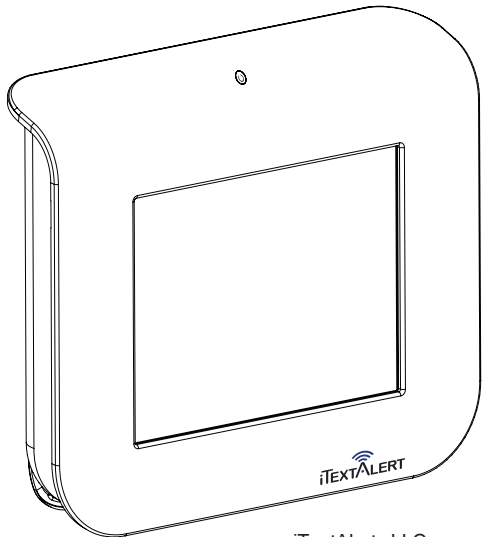

iTextAlert, LLC
111 East First Street
Geneseo, Illinois 61254
Customer Service: 855-810-2992
www.iTextAlert.com

Hub & Sensor Item List

1 - iTextAlert Hub with built-in power Sensor (control panel)	2 - mounting screws	1 - Rechargeable Li-ion battery (3.7V, 1150 mAh, 4.3 Wh)	1 - AC power supply (Input: 110-120V, 50-60 Hz, 0.15A Output: 5V, 1A)	1 - USB cable	1 - USB plug (to protect the port)	1 - wall mount or desk stand bracket	2 - pieces of double-sided tape
---	---------------------	--	---	---------------	------------------------------------	--------------------------------------	---------------------------------

Quick Start Guide

Items included with the optional Sensor packages:

- 1 - wall mount bracket
- 1 - USB plug (to protect the port)
- 1 - USB plug (to protect the port)
- 2 - mounting screws
- 1 - AA or AAA battery
- 2 - piece of double-sided tape

Sensors included:

- Temperature Sensor
- Stationary/Move Sensor
- Open/Close Sensor
- Wet/Dry Sensor

Hub & Sensor Item List

Note: please push on the power button to access the hard key.

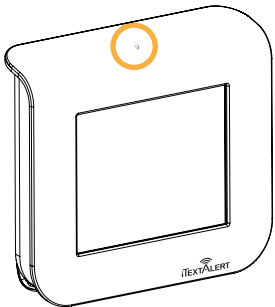

The hard key is used to put the Hub in sleep mode, wake the Hub up from sleep mode, and reboot the system. The Hub will only power down when the battery pack is depleted.

Hard Key Functions

- Press and hold hard for 5 seconds to place Hub in sleep mode.
- Press and release the hard key to wake the Hub from sleep mode. (Note: Do not hold the hard key down.)

If the system shuts down, use a paperclip to hit the Reset button on the back side of the Sensor. Push in carefully until the button clicks.



Plug in supplied AC power adapter to Hub.

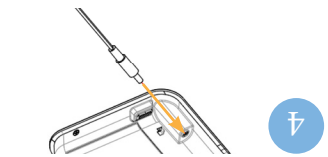

Replace battery and cover on Hub.

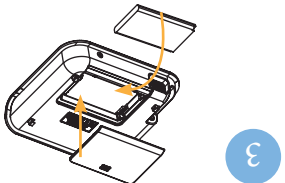

Pull battery tab from battery.

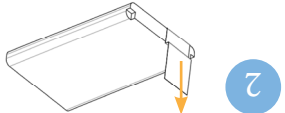

Slide Hub cover to access battery area.

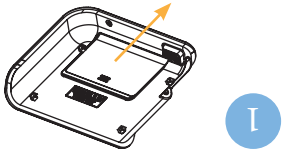

Note: the Hub will not operate without the battery installed. Please install battery prior to operating the device.

Installing The Hub's Battery

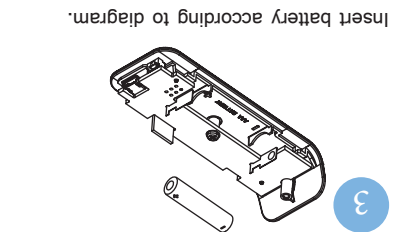

Slide battery cover to access battery area.

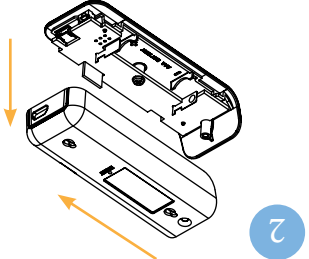

Remove screw from back battery cover.

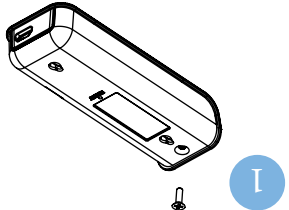

Installing The Sensor's Battery

Setup Wizard

Note: Hub must have battery installed and AC adapter plugged in to operate.

- Power On**
Install included Li-ion battery into Hub. Connect the included AC power adapter to Hub.

becomes disabled, the Hub will transmit alerts using the cellular telephone network. The Hub can only connect to one Wi-Fi network.

- Activation**
Log into www.iTextAlert.com or call 855-810-2992 to activate the system. Once activation has been completed, follow the on-screen instructions.

- Hub Name**
Enter a name or identifier for the Hub. This is the identifying name that you (and your designated contacts) will receive SMS (text) messages from on your cell phone.

- Password**
You have the option to create a four-digit password that would allow only you to make changes to the system settings.

- Sensors**
Connect sensors to the Hub via the provided USB cable and follow on-screen instructions to synchronize the sensors with the Hub.

- Wi-Fi**
Connecting to a Wi-Fi network provides a second method for the Hub to transmit alerts to your cell phone. If there is no Wi-Fi network or the network

- Contacts**
Enter the name(s) and cell phone number(s) of those persons that are to be notified of any alerts via SMS (text) messaging.

Wall Mount Installation (Hub and Sensors)

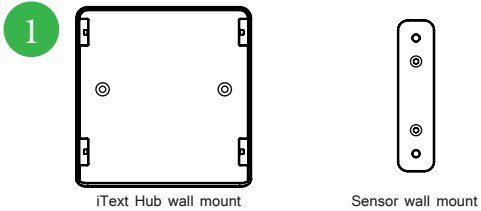

Use the mounting bracket as a template to mark pilot holes for the mounting screws. Pilot holes may not be necessary in some materials.

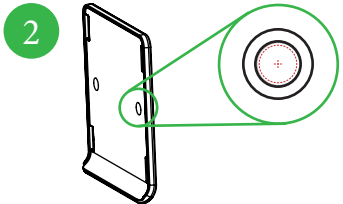

Drill 1/16" pilot holes. Install the mounting bracket using the included screws.

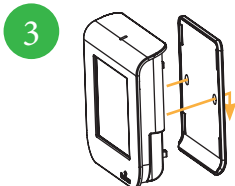

Fasten the Hub or Sensor to the bracket. The double-sided tape may be used to fasten the mounting bracket instead of securing with the screws.

Menu Navigation

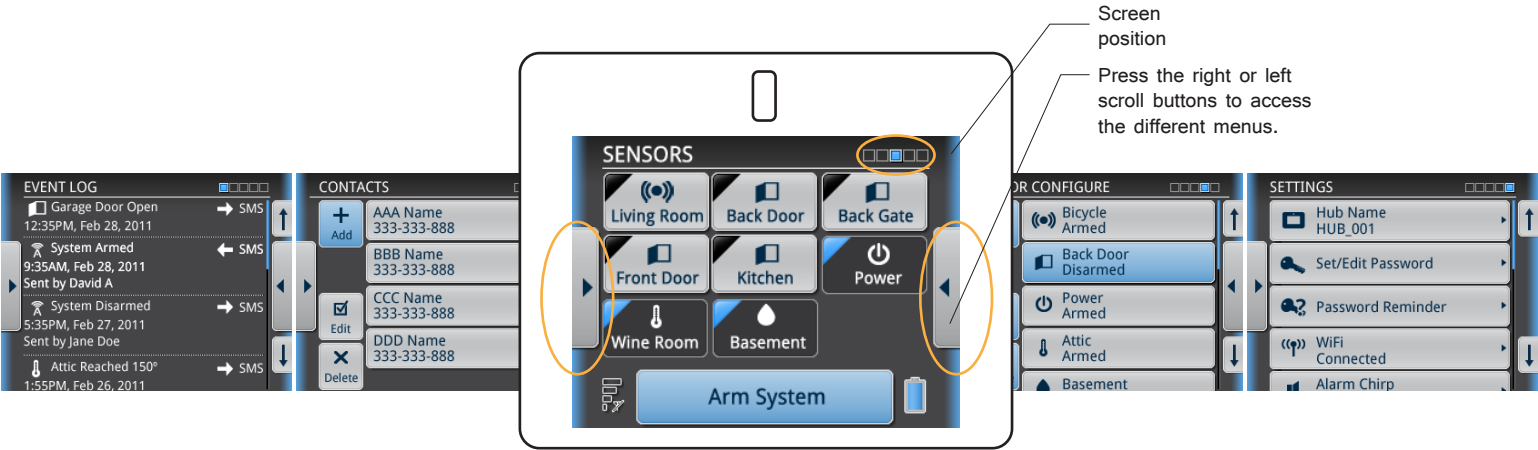

- Event Log**
Chronologically lists the last 50 system events.
- Contacts**
Lists the designated contacts (maximum of 5).
- Sensors**
Lists the maximum of 9 sensors (Power is a default Sensor).
- Sensor Configure**
Lists all the sensors, their types, and their locations. From this screen, individual sensors can be edited or deleted.

Note: After the initial setup, Sensor Settings can be edited without connecting the Sensor to Hub via the provided USB cable.
- Settings:**
Lists the settings for the Hub and Sensors.

Additional Sensors

- Go to Sensor Configuration screen and press [+ symbol] to add a Sensor (maximum of 8).
- Connect the Sensor to the Hub via the provided USB cable.
- The connecting screen will appear; once the Hub recognizes the Sensor, the screen will advance to the specific Sensor Settings screen.
- Adjust the settings; then press the [✓ symbol] to confirm the settings.

Note: When resetting the sensor, it is not required to connect the Sensor to the Hub via USB cable.

Sensor Types

- Stationary/Move - alerts once the Sensor is physically moved.
- Open/Close - alerts once the Sensor disconnects/connects.
- Temperature - alerts once the Sensor has reached its threshold.
- Wet/Dry - alerts the Sensor has reached the wet/dry level based on its configuration.
- Power - alerts once the Hub has lost or regained power.

Remote Configuration Commands:
You can send a SMS command to the Hub.

XY

Command Sensor

1Y - Disarm
2Y - Arm
3Y - Dismiss

ex. Send "25" will Arm Sensor 5 (Kitchen)

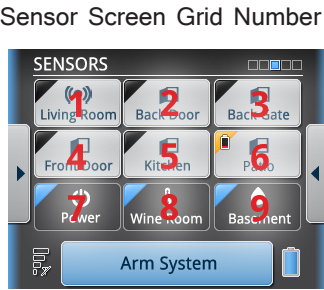

Sensor Status



Status Indicator

- Sensor Armed
- Sensor Disarmed
- Sensor Alert
- Sensor Armed Battery Low
- Sensor Disarmed Battery Low
- Sensor Alert Battery Low
- Armed With System
The Sensor will arm when selected on the Sensor Menu or when the system is armed.
- Always On
The Sensor will remain armed even when the system is disarmed.

SMS Notifications

- The commands allow you to communicate with your Hub via SMS on your mobile device.
- 3 or MENU - Option Menu
 - 4 or DISARM - Disarm System
 - 5 or ARM - Arm System
 - 6 - Reply to see Disarmed Sensor List
 - 7 - Reply to see Armed Sensor List
 - 8 or STATUS - Reply Sensor Disarmed/Armed Status
 - 9 or TEST - Send Test SMS to all contacts
 - 11 to 19 - Disarm individual Sensor
 - 21 to 29 - Arm individual Sensor
 - 31 to 39 - Dismiss individual Sensor

Other Graphics

- SMS signal strength
- Wi-Fi strength
- Hub battery level
- Settings confirmation
- Incoming SMS
- Outgoing SMS
- Entire system

Reply Commands

Sensor List

- | | |
|----|-----------------------------|
| 1. | 11-Disarm 21-Arm 31-Dismiss |
| 2. | 12-Disarm 22-Arm 32-Dismiss |
| 3. | 13-Disarm 23-Arm 33-Dismiss |
| 4. | 14-Disarm 24-Arm 34-Dismiss |
| 5. | 15-Disarm 25-Arm 35-Dismiss |
| 6. | 16-Disarm 26-Arm 36-Dismiss |
| 7. | 17-Disarm 27-Arm 37-Dismiss |
| 8. | 18-Disarm 28-Arm 38-Dismiss |
| 9. | 19-Disarm 29-Arm 39-Dismiss |

- 3 or OPTION - Option Menu
- 4 or DISARM - Disarm System
- 5 or ARM - Arm System
- 6 - Reply to see Disarmed Sensor List
- 7 - Reply to see Armed Sensor List
- 8 or STATUS - Reply to see all Sensor Disarmed/Armed Status
- 9 or TEST - Send Test SMS to all contacts

Sticker added to Quick Start Guide

The user is cautioned to maintain a 20 cm
(8 inches) spacing from the product to ensure
compliance with FCC requirements



Quick Start Guide

Model iTA-1 Rev. A

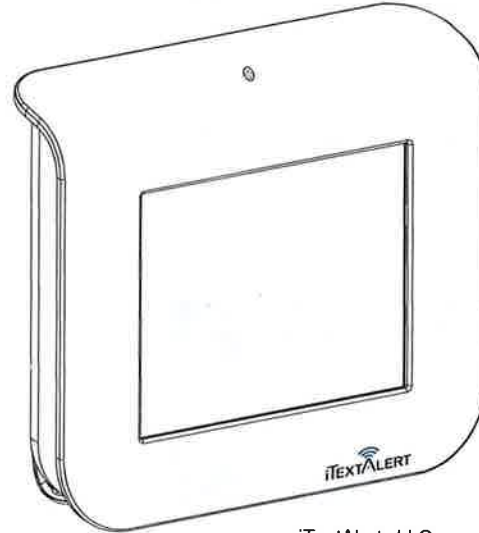

iTextAlert, LLC
111 East First Street
Geneseo, Illinois 61254
Customer Service: 855-810-2992
www.iTextAlert.com