

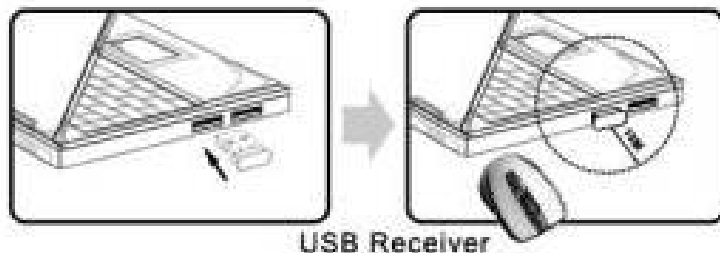

Supported Operating Systems

OS System: Windows Vista/XP/2000/ME/7/8
MAC OSX 10.2 or above



USB Receiver

FCC Warning

This device complies with Part 15 of the FCC Rules. Operation is subject to the following two conditions

- (1) this device may not cause harmful interference, and
- (2) this device must accept any interference received, including interference that may cause undesired operation. Changes or modifications not expressly approved by the party responsible for compliance could void the user's authority to operate the equipment.

Specifications



On/Off Button

When the mouse is not in use for extended periods, or in travel mode, you may switch to the Off position to save power.

First install:

1. Open the cover to the battery box.
2. Put the two AAA batteries into the battery box. Make sure the polarity(positive and negative poles) is correct.
3. Close the cover of battery box.
4. Plug the USB Receiver into an open USB port on your computer.
5. The Plug & Play System allows quick installation without the need of additional software or driver installation.
6. The installation takes only a few moments and your new mouse is paired.

Note: This equipment has been tested and found to comply with the limits for a Class B digital device, pursuant to part 15 of the FCC Rules. These limits are designed to provide reasonable protection against harmful interference in a residential installation. This equipment generates, uses and can radiate radio frequency energy and, if not installed and used in accordance with the instructions, may cause harmful interference to radio communications. However, there is no guarantee that interference will not occur in a particular installation. If this equipment does cause harmful interference to radio or television reception, which can be determined by turning the equipment off and on, the user is encouraged to try to correct the interference by one or more of the following measures:

- Reorient or relocate the receiving antenna.
- Increase the separation between the equipment and receiver.
- Connect the equipment into an outlet on a circuit different from that to which the receiver is connected.
- Consult the dealer or an experienced radio/TV technician for help.

Caution: Any changes or modifications not expressly approved by the party responsible for compliance could void the user's authority to operate this equipment.