

KDRC

Operation Manual

FCC Compliance Statement

This device complies with part 15 of the FCC Rules. Operation is subject to the following two conditions:

1. This device may not cause harmful interference, and
2. This device must accept any interference received, including interference that may cause undesired operation.

Caution: changes or modifications not expressly approved by the party responsible for compliance could void the user's authority to operate the equipment.

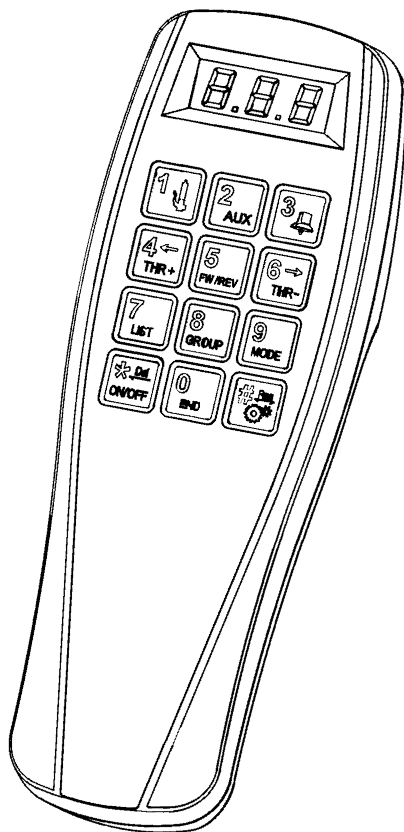

Kadee Quality Products
673 Ave, C White City, OR 97503

©2010 Kadee Quality Products Co.

Quick Start

You will need:

Small Phillips Screwdriver and 4 AA batteries.

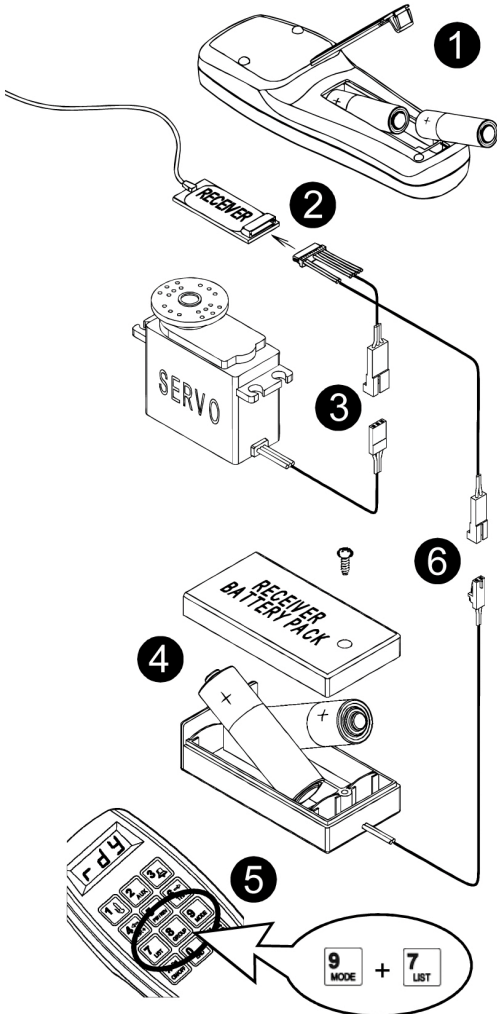

1. Install two AA Batteries in Transmitter.
(display will show that System is Ready)
2. Connect Wire Harness to Receiver.
(do not force any connectors)
3. Connect Servo to Wire Harness.
(match up wire colors)
4. Install two AA batteries into Receiver Battery Pack.
(Small phillips screwdriver needed)
5. Hold [9] key for one second *(curser starts to blink)*. Release [9] key and press [7] key.
6. **(note)** The next sequence must be completed within 10 seconds.
Plug Receiver Battery Pack into Wire Harness and Press the [*] key on Transmitter.

Write down the address shown in the Transmitter Display. (This address will be needed for future communication with this Receiver). Transmitter and Receiver are now linked & ready to use.

7. Press [#] to operate the servo.

