

User Manual  
**GEO Wireless 5000mAh Power Bank**  
Model : XP61066

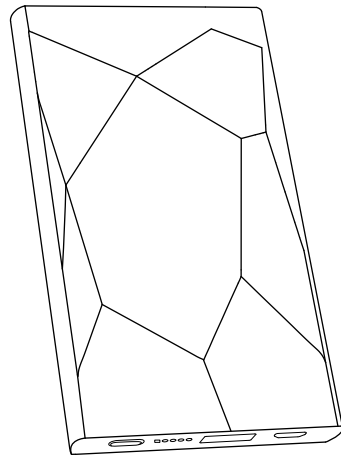

Fit For :

Qi Phones

Specification and appearance subject to change without notice.  
All trademarks and registered trademarks are the property of their  
respective owners © 2018 Xoopar Ltd.



- ENG Wireless charging powerbank with utility patented Geo light.  
Wirelessly charge more than 100% of your smart phone. Beautiful lighting logo.
- DE Schnurlose Powerbank mit patentiertem Geo-Licht. Laden Sie Ihr  
Smartphone bis zu 100 % schnurlos auf. Schönes Blitz-Logo.
- NL Draadloze powerbank voor het laden met nuttig gepatenteerde geo-lamp.  
Draadloos laden tot 100% van uw smartphone. Mooi verlicht logo.
- FR Chargeur externe sans fil avec lampe utilitaire Geo brevetée. Chargez sans  
fil votre smartphone jusqu'à 100%. Beau logo éclairé.
- ES Batería externa inalámbrica con función patentada de luz Geo. Cargue  
inalámbricamente hasta 100% de su teléfono móvil, incluye ventosas para  
facilitar el proceso de carga. Precioso logo luminoso.
- PT Powerbank de carregamento sem fios com luz Geo patenteada. Carregue  
sem fios até 100% do seu Smartphone. Belo logótipo iluminado.
- IT Powerbank a ricarica wireless con luce Geo brevettata. Ricarica wireless del  
tuo smartphone fino al 100%. Magnifico logo luminoso.
- JP 一般特許取得済みGeoライト搭載ワイヤレス充電パワーバンク。スマートフォンを最  
大100%充電するワイヤレス充電、美しい、光るロゴ。
- KR 유틸리티 특허를 받은 Geo 라이트를 갖춘 무선 보조배터리. 스마트폰을 100%까지  
무선 충전, 멋진게 빛나는 로고.
- AR باور بانك للشحن اللاسلكي مع ضوء فلوري مسجل كبراءة اختراع. شحن لاسلكي حتى 100% من سعة  
شحن هاتفك الذكي، مع عناصر تثبيت بالشفط مدمجة للشحن السهل. شعار مضني جميل.
- SW Strömbank med trådlös laddning och verktygspatenterad Geo-belysning.  
Trådlös laddning upp till 100 % på din smartphone. Vackert upplyst logotyp.
- CH 无线充电移动电源，带获得实用专利的Geo灯。支持无线充电，最高储电量相当于您  
的智能手机的满电量。漂亮的发光标志。
- TC 無線外置充電器，配備已獲新型專利(Utility Patent)的Geo燈。採無線充電方式，其  
電池容量能為智能手機提供1次100%的充電。漂亮的發光商標。

Specifications:

Battery Capacity: 5000mAh Rechargeable Battery  
Battery Type: Li-Polymer Grade A  
Case: Plastic + Silicone  
Input Voltage: 5V / 2A  
Output Voltage: 5V / 2.1A  
Wireless Output: 5W (Max)  
Charge Time: App 2.5 Hours (AC / Computer)  
Induction Distance: ≤ 8mm  
Watt Hour: 18.5Wh  
Patented Product

① Configuration

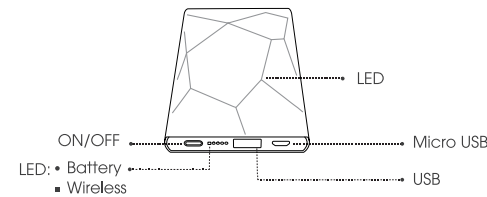

③ Wireless Charging

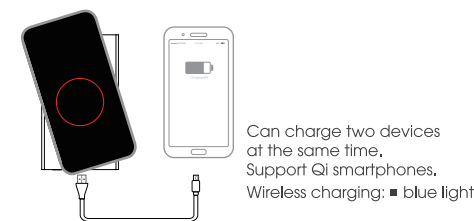

⑤ Coil Area

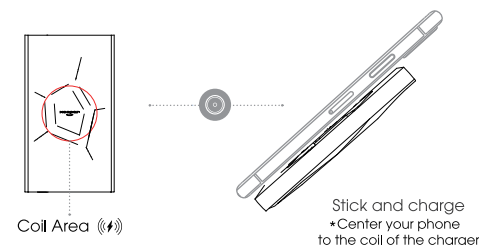

② Power ON

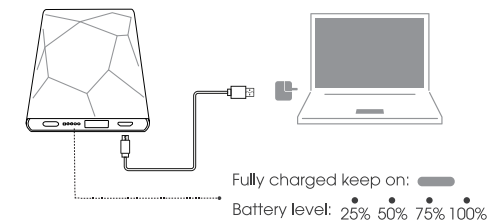

④ Induction Distance

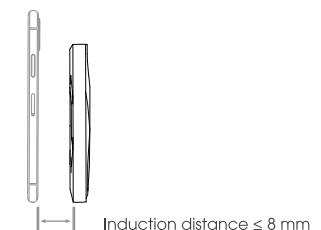

⑥ FOD Safe Charge

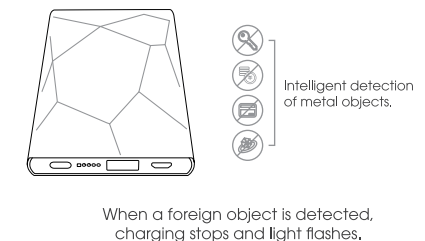

FCC warning

Any Changes or modifications not expressly approved by the party responsible for compliance could void the user's authority to operate the equipment.

This device complies with part 15 of the FCC Rules. Operation is subject to the following two conditions: (1) This device may not cause harmful interference, and (2) this device must accept any interference received, including interference that may cause undesired operation.

Note: This equipment has been tested and found to comply with the limits for a Class B digital device, pursuant to part 15 of the FCC Rules. These limits are designed to provide reasonable protection against harmful interference in a residential installation. This equipment generates, uses and can radiate radio frequency energy and, if not installed and used in accordance with the instructions, may cause harmful interference to radio communications. However, there is no guarantee that interference will not occur in a particular installation. If this equipment does cause harmful interference to radio or television reception, which can be determined by turning the equipment off and on, the user is encouraged to try to correct the interference by one or more of the followin measures:

- Reorient or relocate the receiving antenna.
- Increase the separation between the equipment and receiver.
- Connect the equipment into an outlet on a circuit different from that to which the receiver is connected.
- Consult the dealer or an experienced radio/TV technician for help

FCC Radiation Exposure Statement:

This equipment complies with FCC radiation exposure limits set forth for an uncontrolled environment .

This transmitter must not be co-located or operating in conjunction with any other antenna or transmitter

This equipment should be installed and operated with minimum distance 20cm between the radiator &you body