

D74TS

VIEW

D74TS



7" Widescreen Color LCD Monitor With DVD Player

- Please read the manual in detail before using this product.
- This product is made of precision components, keep it away from moisture.

TABLE OF CONTENTS

Safety Precautions.....	1
Main Features.....	2
Unit Installation.....	3
UNIT REMOVAL.....	4
User introduction	5
Wire connection	5
Unit Rear Side Connection.....	6
Appearance And Function Introduction	7
Remote Control Operation.....	8
Basic operation.....	9
Connect To Storage Accessories.....	10
Touch Screen Menu And Operation	11
Radio Function Interface.....	12
Bluetooth Function System.....	12
DVD Mode Menu Interface.....	13
CD Mode Basic Operation.....	14
Touch screen calibration.....	14
USB/SD Operation.....	14
System Menu Setup.....	15
Common Menu Setup.....	15
AUDIO/VIDEO Menu Setup.....	16
DVD System Setup.....	16
Function Index Sign.....	19
Warning.....	20
Disc Notes.....	20
Simple Trouble-Shooting Guide.....	21

Safety Precautions



This product without waterproof function. To avoid the risk of fire breakout or electric shock, please do not expose this unit in the rain or moist environment. Do not open the cabinet. Such operation will absolve relative maintenance guarantee. Only the legally authorized professionals are allowed to conduct such operation.



LASER: This unit installs a laser system. To ensure proper use of this product, please read this owner's manual carefully before operating this unit and keep it for future reference. If the unit requires maintenance, please contact an authorized professional. Please operate according to correct process in order not to hurt by laser beam.



Please use this unit at normal temperature. Do not put the unit under -10 degree or higher than +60 degree environment. Otherwise it will distort the plastic shell, debase the display quality and products quality.



Installation should be very tight and secured to prevent the fallen unit hurt people and damage the unit when moving on or a sudden brake.



Please install carefully to avoid damaging working platform. Please clean the internal working platform, and ensure sufficient space for installation. Inner shell will be installed on the working platform. Then install the mainframe, connecting the power and video signals jack, then put mainframe into the shell. Then assemble the shell with the mainframe device.



Please do not try to repair display device by yourself. It is made up of many precision electronic elements, and any dismantlement or refit will make it damaged or broken. If any problem on the unit, please switch off the power immediately, and consult your nearest seller or distributor.



Please keep the monitor away from the pollution of moisture, dust, water soot etc. Please switch off the power immediately if any moisture or other objects pollute, please contact the seller or distributor.



If you drive with the sound at a level preventing you from hearing sounds outside the car please keep the unit at an appropriate sound level, otherwise this may affect your driving and cause an accident.



For your safety, please do not watch or operate the monitor when you are driving.

Preface

Thank you for your support of the company's products and options. This unit is crystallization of the modern high-tech. It is a cross-functional player mode and adjustable true color LCD Automatic retractable screen LCD touch screen. Allows you to be arbitrary choice To appreciate the program. Here, we wish you to personally experience this high-tech products can be Perfect fun and enjoyment. To ensure proper use of this product, please read this owner's manual carefully before operating this unit and keep it for future reference.

Note: The graphics of this manual are for your reference only, please in-kind products prevail,

Main Features

1. 7" Wide screen TFT LCD monitor.
2. This unit is with touch icon interface.
3. DVD/RADIO/AUX/USB/SD/IPOD/BLEETOOTH/CAR REVERSING function build in.
4. DVD/VCD/MP3/CD/MPEG compatible.
5. FM/AM digital synthesizer tuner with 30 memory presets.
6. Intelligentize bluetooth function, for you to make and answer the phone comfortably.
7. Hi power 45Wx4, 4 RCA stereo audio output, can connect to power amplifier.
8. Signal : 2 video output, 2 video input.
9. Under car reverse mode, can auto switch to the reversing mode, if connect to the camera, can observe the back side of car to ensure the safety.
10. Menu language: Portuguese/English display.
11. Menu function: all function is operated by OSD menu.
12. Display system: auto PAL/NTSC.
13. Video mode: Brightness/ Standard/Soft/Shar four preset video mode.
14. Display panel adjust: Panel angle can be adjustable.
15. Support SD card to play MP3/MP4/WMA/AVI/JPEG media format.
16. USB connector can support removable disc, and with MP3/WMA audio display and picture browse function.
17. Clock display: 12/24 hours clock display
18. Remote control: full function remote control operation
19. Picture pixel: 480*3(R.G.B)*234
20. Power: DC+12V/±10%

UNIT INSTALLATION

Installation Method 1: Din Front-Mount

Install the Mounting sleeve into the dashboard.

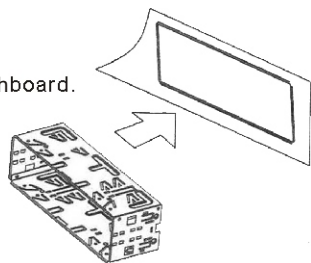

Bend as many claws outward for tight fit, to lock the sleeve into place.

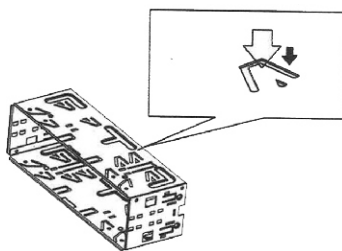

Install the trim bezel to the unit.
(Arched surface toward the bottom).

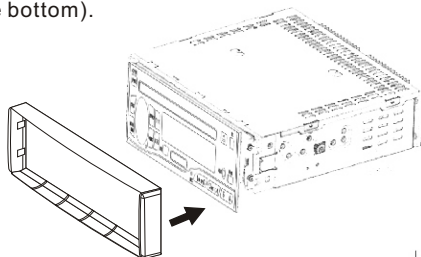

Use the Rear Mounting Bolt to support the unit.

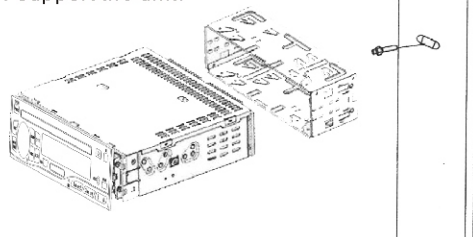

Installation Method 2:

Using the screw holes at the sides of the unit(ISO Mount).

1. Remove the hooks on both sides.
2. Select a position where the screw holes of the mounting bracket supplied with the car and the screw holes of the main unit become aligned, tighten the screws on each side, and re-mount the brackets with the factory hardware in the original location.

NOTE:

1 and 10 are not used for installation method2.

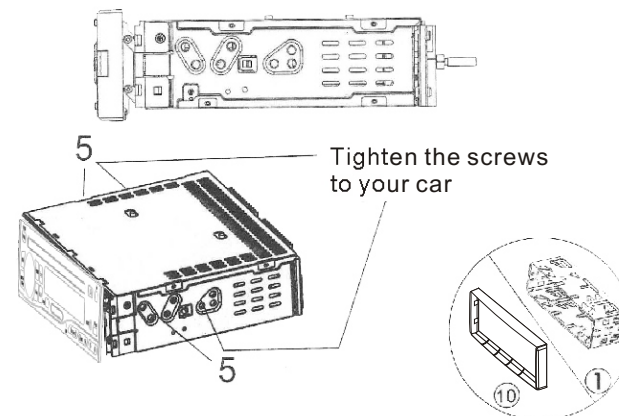

UNIT REMOVAL (when installed using the sleeve)

1. Detach the trim bezel.
2. Insert the keys supplied with the unit on both sides (as illustrated) as this will release the internal locks so you can slide the unit out.

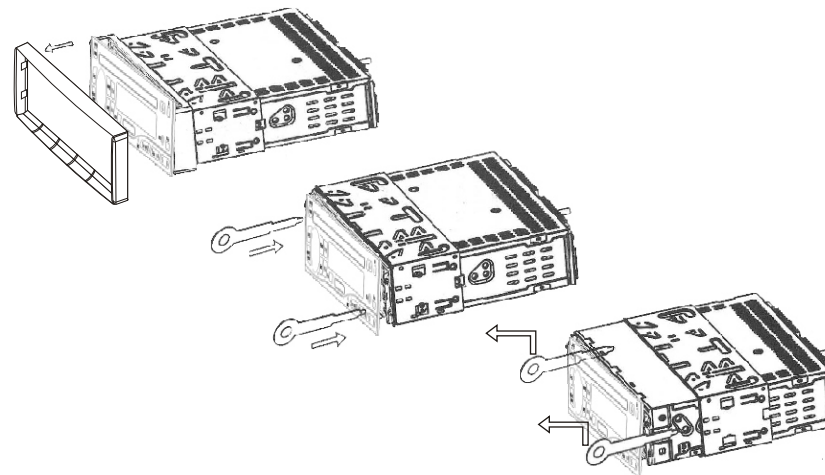

User introduction

1. Please connect the signal cable with power cable according to "Unit rear side connection" to connect to power and signal.
2. After connect to power, press the power button, then the picture will show the RADIO mode.
3. When display DVD or VCD disc, the unit is automatically identify the video system PAL and NTSC.
4. Can through the button on panel to adjust the function. And can use the remote control or touch screen to adjust the function.
5. FM mode will be factory default when without any signal input. If put the disc or USB/SD, the picture will auto read the file and enter to play picture.

Wire connection

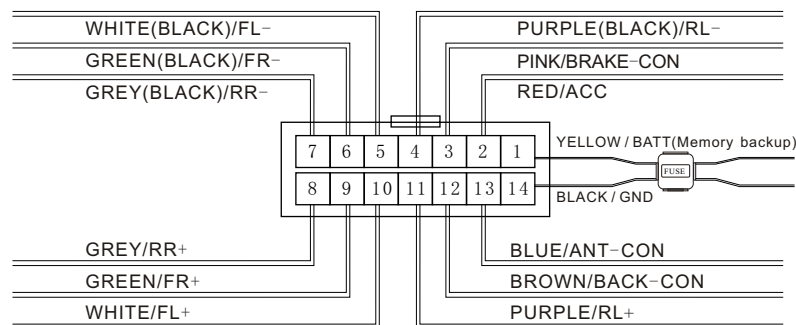

1. (YELLOW) BATT(Memory backup): Power cable
2. (RED) ACC: Connect to battery positive pole
3. (PINK) BRAKE-CON: Hand brake connection cable
4. (PURPLE/BLACK) RL-: Rear left audio output (cathode)
5. (WHITE/BLACK) FL-: Front left audio output (cathode)
6. (GREEN/BLACK) FR-: Front right audio output (cathode)
7. (GREY/BLACK) RR-: Rear right audio output (cathode)
8. (GREY) RR+: Rear right audio output (positive pole)
9. (GREEN) FR+: Front right audio output (positive pole)
10. (WHITE) FL+: Front left audio output (positive pole)
11. (PURPLE) RL+: Rear left audio output (positive pole)
12. (BROWN) BACK-CON: Car reversing cable
13. (BLUE) ANT-CON: Antenna amplifier output control
14. (BLACK) GND: connect to ground.

Unit Rear Side Connection

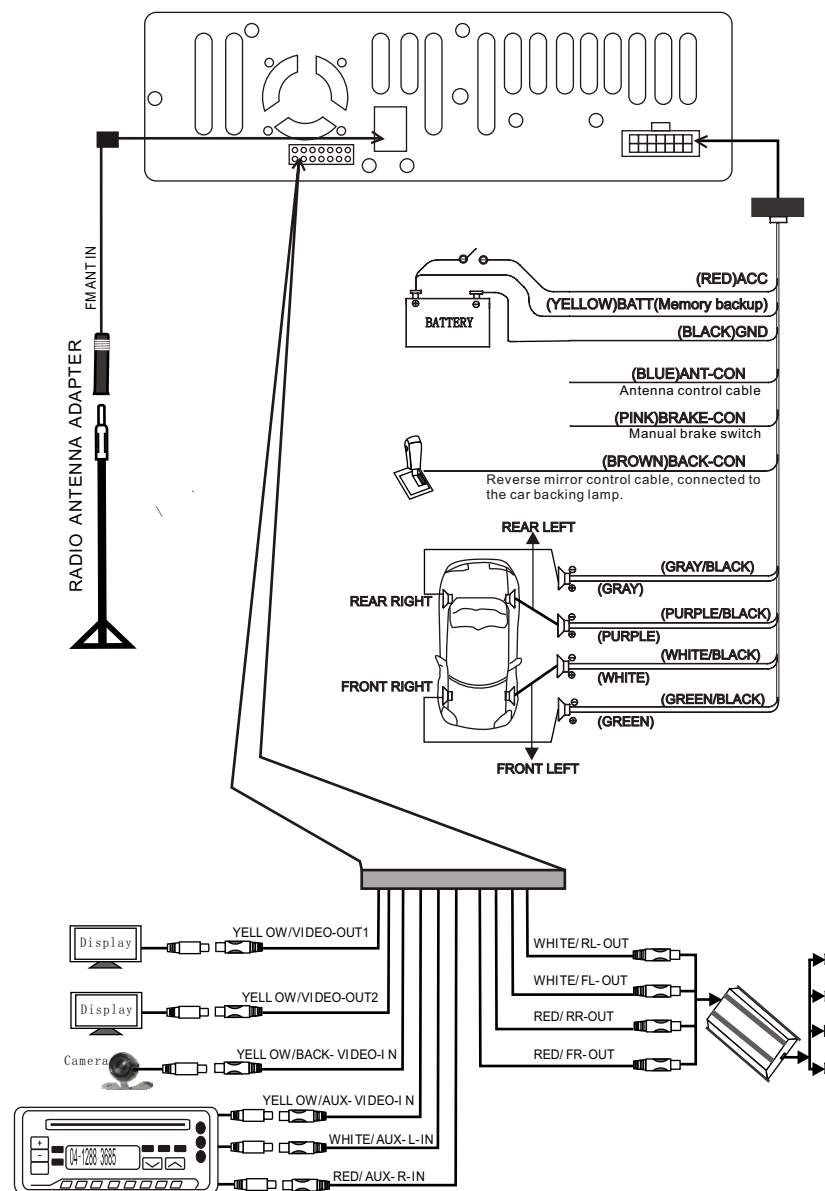

Appearance And Function Introduction

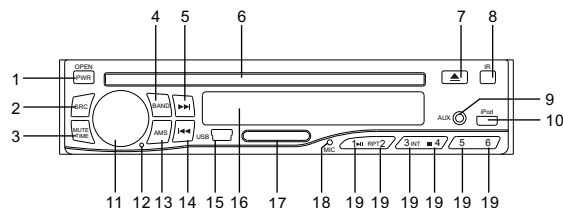

1. PWR: Power on/off, press for long time to turn off, short-press it for panel slip in and out.
2. SRC: Signal mode select.
3. MUTE/TIME: Short-press it for mute, Long-press it for display time on, display the time on the left top of panel.
4. BAND: PAL/NTSC/AUTO system switch, Radio band selection.
On FM mode to select brand of radio: FM1/FM2/FM3. AM1/AM2;
On DVD-USB/SD mode to select the system: NTSC/PAL/AUTO.
- 14/5. In DVD mode, short-press for previous/next item, long-press for fast forward/fast back; In FM mode, short-press for adjust radio frequency, long-press for manual search forward up/down.
6. Disc slot.
7. Eject/Enter the disc.
8. Remote control window.
9. AUX: audio input jack .
10. iPod:iPod jack.
11. Clockwise rotation is Control for the volume increase, and can use for MENU adjustment.
Counterclockwise-rotation is Control for the volume reduce, and can use for MENU adjustment.
Press it for choose "VOL" "BAS" "TRE" "BAL" "FAD" to adjust that you need.
12. Reset button: When the unit appears confusion or have abnormity and cannot play continually. press the reset button the product will get back to the factory default.
13. AMS: In FM mode, Long-press it for auto search, short-press it for channel browse.
15. Mini USB connector
16. Fluorescent digital screen
17. SD card reader
18. Microphone
19. In FM mode these are number buttons, press it to display select the channel, long-press can reserve the current frequency to corresponding number channel;
In DVD mode these are play/pause, repeat, sequence play and stop.

Remote Control Operation

1. Power
Press this button to turn on/off the unit.
2. PLAY/PAUSE
3. MUTE
4. Cursor direction key
Press this button to move cursor to left/right/up/down.
5. SYSTEM SELECT: AUTO/NTSC/PAL
6. ENTER
7. VOLUME: VOL+/VOL-
8. PREV: SEEK- /SEEK+
9. ST/PROG
Program play track order
10. OSD
Press it to display the disc information.
11. SEL
Sound selection function
12. AMS/RPT
FM mode, long-press for auto search, short-press for channel browse;
DVD mode, press for single song play or single song repeat.
13. LOC/AF/RDM
Under DVD mode, press it for play song by production system.
14. NUMBER
Song choose
15. AUDIO choose mode.
16. MENU display
17. Language select
18. GOTO title, chapter
19. MODE: Switch mode.
20. :STOP/PLAY
21. ANGLE
22. SLOW:slow forward/ slow playing

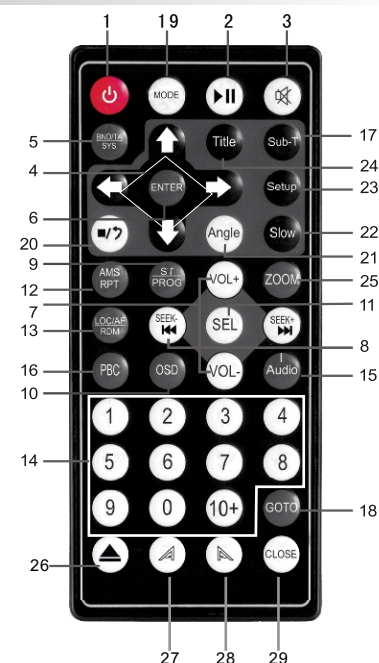

23. SETUP
DVD system setup.
24. TITLE
Back Disc Title.
25. ZOOM
Press it can zoom or shrink picture displayed
26. :Eject button
Press this button to eject or enter the disc.
27. Display panel slip out
28. Display panel retract
29. CLOSE:press it, the monitor will auto-extend or return

Precautions before using remote control unit

1. Please pull out the PVC when the remote control unit is first using.
2. Don't drop or step on remote control unit or subject it to shocks.
3. Note that it maybe impossible to operate the main unit if there are obstacles between it and the remote sensor.
4. Using the remote control unit within the specified operating range.

Remote control unit operating range

Horizontal: ± 30 degree
Vertical: ± 30 degree
Distance: 6M

Replacing the battery

1. Insert your finger nails into A and B on the diagram below, press A according to the direction, then pull out the battery holder.

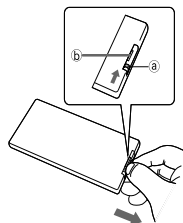

3. Fit the battery holder back to its place.

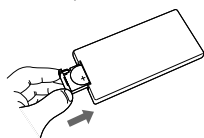

2. Remove the old battery, then insert the new battery into the battery holder with the + side facing upwards.

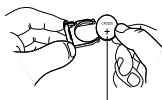

Lithium battery (Cr2025)

Note:

To prevent leakage of fluid from the lithium battery, remove the battery when not using the remote control unit for long periods of time (one month or more). If the battery leaks fluid, carefully wipe it out of the battery case, then change to a new lithium battery.

BASIC OPERATION

1. Power on /off
Press the "⏻" button on remote control, enter into power on condition, press this button again to turn off the unit.
2. PLAY/PAUSE
On normal play disc mode, press this "⏮" button to pause. Press this button again to continue playing.
3. ■ STOP
In play mode, press it to stop playing, press "PLAY" button to resume playing.
4. DISC IN /OUT ▲
Press to eject the disc. The disc into the disc slot, will inhale automatically.
5. Adjust panel angle
Press "↶" "↷" button on remote control, can adjust the panel angle.
6. MUTE control
Press "⊗" button on remote control to turn off the sound. Press it again will resume the previous volume level.
Note: there are some functions no work when mute
7. Function mode switch
Press "MODE" button on remote control, can switch the DVD, AUX, RADIO, BLUE, SD/USB mode. But if the unit without disc/SD/USB inside, can't enter to DVD/SD/USB mode.
8. "⏮" "⏭"
In DVD mode, short-press for previous/next item, long-press for fast forward/fast back; In FM mode, short-press for adjust radio frequency, long-press for manual search forward up/down.
9. SEL audio function
Audio adjust button. Press it to choose "VOL" "BASS" "TRE" "BAL" "FAD", then press "VOL-" "VOL+" to adjust that you need.
10. press the CLOSE key on the remote, the monitor could auto-extend or return, and the music display could not be influenced by the telescopic.

11. Press OSD when playing DVD, the screen will display current playing and disc information.
12. "GOTO" chooses play button, Press it, show play information upside screen, use cursor button on the remote control to move choose disc title or chapter or time then confirmation button to play.
13. Press AUDIO to select the audio language when the main unit is in play mode for DVD disc. Press AUDIO to select the audio channel when the main unit is in play mode for VCD, CD disc.
14. Press "Sub-T" to select different subtitles inherent in DVD disc.
15. Press ANGLE to select the play angle when the main unit is in play mode for DVD disc, there is no function for other disc. It will be no working if the disc not have this function.
16. Press ZOOM key for times, the picture will change in order of 2X, 3X, 4X, 1/2X, 1/3X and 1/4X of normal size. (Note: When playing MP3/USB/SD, this button is invalid.)
17. Press SLOW on the remote control to slow playing. Change the playing speed to 1/2, 1/3, 1/4, 1/5, 1/6 and 1/7 through pressing SLOW button. Press SLOW button to skip frame when the unit is in pause mode. (The sound is mute when the main unit is in fast or slow playing except CD and MP3 disc. Press PLAY to resume normal playing)
18. The main unit may auto play the list according to the order of title, chapter or setlist; Press ST/PROG, the menu will shown on the screen.

Hint: T is for Title, C is for Chapter of DVD disc. DVD disc is divided into several parts called Title. Then title is divided into chapter; Normally one movie only corresponding to one title. CD disc is divided into several items. For KARAOKE disc one music corresponding to one title.

编程		
T C	T C	T C
1 -- : --	5 -- : --	9 -- : --
2 -- : --	6 -- : --	10 -- : --
3 -- : --	7 -- : --	11 -- : --
4 -- : --	8 -- : --	12 -- : --
播放	清除	退出

Use the ◀/▶/⏮/⏭ and number button, to input the corresponding title, chapter, same as the picture showing:

编程		
T C	T C	T C
1 01 : 001	5 -- : --	9 -- : --
2 02 : 002	6 -- : --	10 -- : --
3 -- : --	7 -- : --	11 -- : --
4 -- : --	8 -- : --	12 -- : --
播放	清除	退出

Use ◀/▶/⏮/⏭ move cursors to "play", press "enter" button, the unit starts playing on the program list. Press "Play/Pause" button or choose "Exit" button, press "enter" to exit.

NOTE:

- (1). The program list will be cancel when the main unit is power off or eject the disc.
- (2). There is no program function for some disc.
- (3). The unit can not play the list if you select the item that does not exist in the disc.

Connect To Storage Accessories.

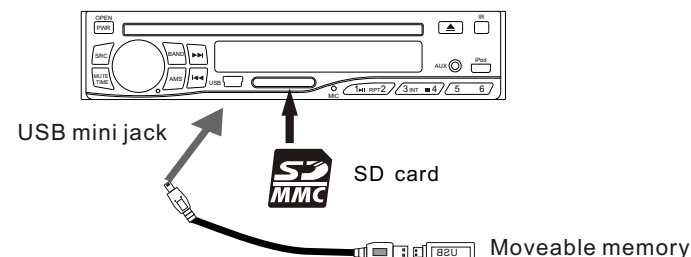

CONNECTING WITH USB

1. Under power on mode, connector the USB, it will be play the USB.
2. It will display "USB READ", then play the file.
3. Pull out the USB when you want to stop playing.

If there are some file in the memory card that can't to play, please delete, then connect to the unit to read the file.

CONNECTING WITH SD CARD

1. Under power on mode, connector the SD card, it will be play the SD card.
2. Will show can play the file.
3. Pull out the SD card when you want to stop playing.

Note: Please take attention for the SD card using direction, label side upward, then insert the card.

Touch Screen Menu And Operation

Main Interface

Press "SRC" button on panel or "MODE" on remote control to choose function display pictures, and touch main interface icon in screen to enter the main interface: see below picture



- | | |
|---|--|
| 1. RADIO: FM/AM radio mode | 8/9. USB/SD: Memory signal input mode, |
| 2. DVD mode (have disk can be entering) | inserted the USB/SD, the system will |
| 3. GPS: navigation mode (optional function) | automatically read play. (Connect the |
| 4. TV function mode (optional function) | USB/SD can be to enter) |
| 5. BT: Bluetooth function | 10. INPUT: AUX-AV signal input mode |
| 6. Close Screen button: Click it the | 11. SETUP: setup menu |
| screen became black, then click on the | 12. ↑ : Panel angle upward |
| screen back to normal. | 13. ⏻ : POWER |
| 7. IPOD: IPOD mode (Connect the IPOD | 14. ↓ : Panel angle down |
| can be to enter) | |

Touch screen "1,2,4,5,7,8,9,10" the center of the corresponding function, the screen immediately enter to interface of your chosen functions mode. If have connected signal source, there are clear picture for you to enjoy. Touch the screen "13" point turn off the power; touch "11" point can enter the setup menu to set product function and display; specific instructions, please refer to the corresponding menu interface. Touch screen "12,14" points to adjust the panel angle up or down to meet your visual requirements.

Note: This product "GPS" function is optional, and this unit does not come with these functions. In this manual do not explain.

RADIO Function Interface

After turn on the unit, will enter to RADIO mode automatically; Or press RADIO icon on main menu or "SRC" on panel or "MODE" button on remote control to switch RADIO function:



1. MUTE: Touch MUTE to turn off the sound, press again to resume to previous volume level.
2. BAND: Select FM/AM wave band
3. SEL: Enter to menu setup, Please refer to "system menu setup instruction".
4. AMS: signal scan, Touch AMS, will auto search FM signal.
5. LOUD: Touch it to turn on/off the loud.
6. ST: Press it to turn on/off the stereo.
7. EQ sound effect
There are "POPULAR, CLASSICALITY, ROCK" three kinds of sound mode for circulate select, if going on will turn off EQ.
8. Mode display
Display the reserve RADIO frequency, press it to play this frequency radio, long-press can reserve the current frequency to relative position.
9. Close screen icon, click it the screen became black.
10. Main interface icon, press it back to the main interface.
11. Adjust panel angle upward/down.
- 12: Channel increase/ reduce: short-press for adjust radio frequency, each plus/minus the frequency increase or decrease. long-press for manual search forward up/down.
13. Volume adjustment buttons

Note: When RDS is open, "5,6,7" points are PTY, TA, AF, depends on the local whether exist teletext. (RDS can be set only in the english mode)

Bluetooth Function System



1. Main interface icon, press it back to the main interface.
2. Volume adjustment buttons
- 3/4/6. Inquiry Phone Records (received calls, missed calls, dialed calls)
5. number button
- 7/17. Dialing button: answer and make the phone.

8. pressing this button is the conversion of mobile patterns and bluetooth mode under calling state
- 9/10/11. When play songs by bluetooth, they are previous song, next song and pause/ play (need mobile phone support)
- 12/13. Adjust panel angle upward/down.
14. Close screen icon, click it the screen became black.
15. Status Information shows column.
16. Delete button: touch the button can delete the already input number.
18. Hang up button: end the call or refuse the call.

Operating instructions

1. Starting up and enter into the bluetooth system picture.
2. Open up the bluetooth equipment of the mobile phone can search this unit's bluetooth equipment "CAR KIT". Then match the bluetooth by presentation.
3. Input 4 figures pass code "0000", this unit's bluetooth will be set up to the authorized equipment of the mobile phone. If the match is successful the status of the bluetooth picture will show "LINK OK"

Tips: If it unable to match please starting up again. After setting up the unit to authorized equipment, the bluetooth will connect or enter into mobile phone bluetooth system automatically. Select "CAT KIT" to connect it.

4. After you match successfully you can make and answer the phone comfortably. Under any system the calls will switch to bluetooth system automatically. It's convenient for you to operate. Within the effective limits, this unit can also transmit the music which is playing in the mobile phone. And can adjust the voice through mobile phone. (Within the effective limits of 10 meters).

Cautions:

This unit can only match with one mobile phone equipment which has bluetooth function. The bluetooth function of this unit can only receive audio frequency information.

DVD Mode Menu Interface

Press "SRC" on panel or "MODE" on remote control to switch to DVD mode; Or on main menu to touch MEDIA icon enter to DVD mode(touch screen the menu toolbar appears when the menu toolbar Hide):

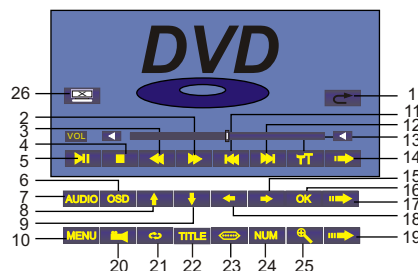

- | | |
|--|---|
| 1 : Back to main menu | 11/12 : previous/Next |
| 2/3 : Fast forward/Fast back | 13 : Tools, Touch it enter to AUDIO/VIDEO menu |
| 4 : Stop | 14/17/19 : Next |
| 5 : Play/Pause | 16 OK : sure |
| 6 OSD: Press it will display the disc information. | 20 : Angle |
| 7 AUDIO: Press it to select the audio language when the main unit is in play mode for DVD disc | 21 : Repeat |
| 8/9/18/15: up/down/left/right | 22 TITLE |
| 10 MENU | 23 : Subtitles |
| | 24 NUM: Selections songs |
| | 25 : Zoom |
| | 26. turn off screen |

CD Mode Basic Operation

When you play the CD disc, will display CD disc and track display mode on top of the DVD interface.

Note: When display the CD, the operation interface is the same as DVD operation. You can through the "AUDIO" button on remote control to choose the audio effect; And press "GOTO" button on remote control to choose the title and chapter display.

Note: On DVD display menu, some of simple function can use the touch panel to operate, but some functions have to through remote control to operate. If there are without disc inside, can't enter to DVD mode.

Above and "OK" functions only available on Some disc or Mp3/SD playing. Under CD/DVD display condition, touching screen left the default is the former song or previous chapter, right is the next, top is adjust panel upward, Below is adjust panel downward

Touch screen calibration

In DVD mode, press " " button on the remote control to stop playing disc, then press " " to enter the calibration interface, according to prompt click the center point of "+" sign, until the calibration success to auto-exit.

USB/SD Operation

When the unit is connect USB/SD, touch the "USB" or "SD" icon in main interface, will auto read and display the file. If under the playing mode, and insert the card, no need to choose the any function, will auto get into the display mode.

1. File bag
2. File
3. Mp3 Icon
4. JPEG Icon
5. Video Icon
6. Menu Icon

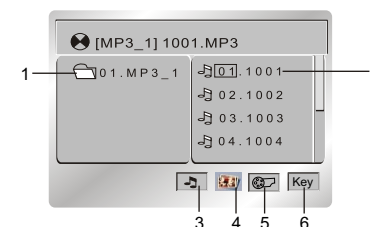

When display USB or SD card, touch panel menu is the same as DVD menu, also the same operation, Touch the DVD menu button move to the file bag, file, MP3 icon or JPEG icon.

After more cursor to the display bag, then press "OK" to ensure the icon; The chosen file will be display by order.

After you choose the JPEG display, touch again the OK button to confirm this picture, then touch again the number button can change the picture direction to up/down/left/right.

Note: While the USB/SD is playing, and if you eject the disc or slot-in the disc, the display will pause for few second, this is normal situation. After finish the disc operation will resume the display. Pull out the USB/SD when you want to stop playing

System Menu Setup

Press "SEL" button on TV menu or RADIO interface, on AUX mode, click the screen will enter to system menu setup, as shown below:

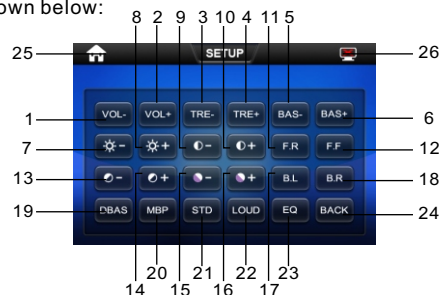

- | | |
|---|--|
| 1/2. VOL-/VOL+:
Volume adjust. | 17/18. B.L/B.R:
left / right audio adjust. |
| 3/4. TRE-/TRE+:
High volume balance adjust. | 19. DBAS:
Sub-woofer on /off. |
| 5/6. BAS-/BAS+:
Low volume balance adjust. | 20. MBP:
Listen respectfully left/right on / off. |
| 7/8. ☆ -/+:
Display picture brightness adjust. | 21. STD:
Standard video select. |
| 9/10. ● -/+:
Display picture contrast adjust. | 22. LOUD:
LOUD on/off. |
| 11/12. F.R/F.F:
Rear/ Front audio adjust. | 23. EQ: sound select
There are "popular, classically, rock"
three kinds of sound mode, can
through EQ to select or turn off EQ. |
| 13/14. ● -/+:
Display picture colorful adjust. | 24. BACK: back to last step. |
| 15/16. ● -/+:
Display picture acutance adjust. | 25. Main interface icon. |
| | 26. Turn off screen. |

You can operate above function follow the instruction.

Common Menu Setup

On main interface, touch "SETUP" can enter to setup menu, as shown below:



1. Main interface icon.
- 2/3. colck set: touch "-" "+" to adjust the time.
4. Time show, Note: AM and PM to show only in america.
5. OSD LANG: Language Setting: Portuguese and English Display is included for your choice.
6. FM area setup
It's convenient for your to use this product, we already setup five RADIO area for your select, only through the touch screen text to choose the position which you listen to.
7. RDS MODE: Wireless Data Broadcasting System to open or closed.
(only in the English mode, it can be set)

Audio/Video Menu Setup

Under DVD mode, touch "TT" button enter to "AUDIO/VIDEO" menu setting interface: Same as below picture 1.2:

(Picture 1) Audio setting interface

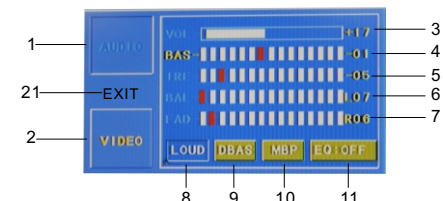

(Picture 2) Video setting interface

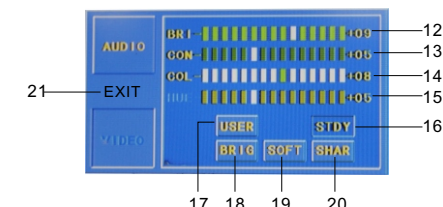

- | | |
|---|--|
| 1. AUDIO: Audio mode. Touch this function, the icon is concave, then will enter to audio setting mode. | 9. DBAS: Bourdon mode. Touch here to enter to bourdon display mode. |
| 2. VIDEO MODE: Touch this function, the picture is concave, then will enter to video setting mode. | 10. MBP: Listen position
Touch here to choose left or right listen position. |
| 3. VOLUME ADJUST
Touch the "-" "+" function on the screen, the volume will change. | 11. EQ: Sound effect mode
Touch here to choose the preset sound mode: popular, rock, classically. |
| 4. BAS: Bourdon volume adjust
Touch the "-" "+" function on the screen, the bourdon volume will change. | 12. BRI: Brightness
Touch the "-" "+" function on the screen, to adjust the picture brightness. |
| 5. TRE: Alt volume adjustment Touch the "-" "+" function on the screen, the alt volume will change. | 13. CON: Contrast. Touch the "-" "+" function on the screen, to adjust the picture contrast. |
| 6. BAL: Left and right track adjustment
Touch the "-" "+" function on the screen, the left right track volume will change. | 14. COL: Color. Touch the "-" "+" function on the screen, to adjust the picture color. |
| 7. FAD: Front and Rear volume adjustment Touch the "-" "+" function on the screen, the front and Rear volume will change. | 15. HUE: Hue. Touch the "-" "+" function on the screen, to adjust the picture hue. |
| 8. LOUD
Touch here can turn on or turn off the loud. | 16. STDY: STANDARD MODE |
| | 17. USER: USER-DEFINED MODE |
| | 18. BRIG: BRIGHTNESS |
| | 19. SOFT: SOFT |
| | 20. SHAR: SHARP |
| | 21.EXIT: exit to setting interface |

DVD System Setup

Under the DVD display mode, press the "SETUP" button on remote control, can enter to DVD system menu setup. Press the "▲/▼/◀/▶" button on remote control to move the cursor to setup the SYSTEM setup, LANGUAGE SETUP, AUDIO SETUP, VIDEO SETUP, SPEAKER SETUP and DITIGAL SETUP. Below is for the details menu for your reference:

1. SYSTEM SETUP

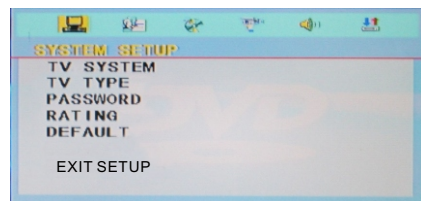

SYSTEM SETUP	
TV SYSTEM	NTSC
TV TYPE	PAL
PASSWORD	AUTO
RATING	
DEFAULT	
EXIT SETUP	

SYSTEM SETUP	
TV SYSTEM	
TV TYPE	4:3PS
PASSWORD	4:3LB
RATING	16:9
DEFAULT	
EXIT SETUP	

SYSTEM SETUP	
TV SYSTEM	
TV TYPE	
PASSWORD	----
RATING	
DEFAULT	
EXIT SETUP	

SYSTEM SETUP	
TV SYSTEM	1KID SAFE
TV TYPE	2G
PASSWORD	3PG
RATING	4PG13
DEFAULT	5PG-R
	6R
	7NC-17
	8ADULT
EXIT SETUP	

SYSTEM SETUP	
TV SYSTEM	
TV TYPE	
PASSWORD	
RATING	
DEFAULT	RESTORE
EXIT SETUP	

RENEW MANUAL

PASSWORD: this unit factory default have set password "0000", if you need, choose the password item to type it to breake lock. After open lock, can choose children lock to amend the grade, after amend then back to password to type 4 number password, press ensure button to lock again.

RATING: this function only fit to the DVD disc come with children lock grade. Through it to control which kind of disc can read. Children lock limited grade have seven level, choose "no limited" to cancel the lock function. Factory default is no limited.

Note: If password have been locked, children lock setting will can't change.

2. LANGUAGE SETUP

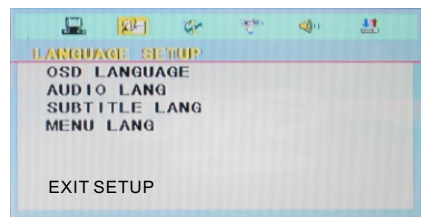

LANGUAGE SETUP	
OSD LANGUAGE	ENGLISH
AUDIO LANG	CHINESE
SUBTITLE LANG	GERMAN
MENU LANG	SPANISH
	FRENCH
	PORTUGUESE
EXIT SETUP	

LANGUAGE SETUP	
OSD LANGUAGE	ENGLISH
AUDIO LANG	CHINESE
SUBTITLE LANG	GERMAN
MENU LANG	SPANISH
	FRENCH
	PORTUGUESE
EXIT SETUP	

LANGUAGE SETUP	
OSD LANGUAGE	ENGLISH
AUDIO LANG	CHINESE
SUBTITLE LANG	GERMAN
MENU LANG	SPANISH
	FRENCH
	PORTUGUESE
EXIT SETUP	

LANGUAGE SETUP	
OSD LANGUAGE	ENGLISH
AUDIO LANG	CHINESE
SUBTITLE LANG	GERMAN
MENU LANG	SPANISH
	FRENCH
	PORTUGUESE
EXIT SETUP	

3. AUDIO SETUP

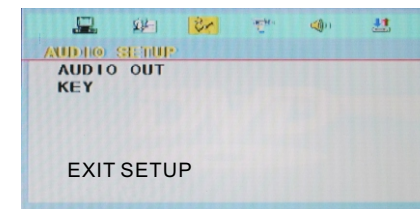

AUDIO SETUP	
AUDIO OUT	SPDIF/OFF
KEY	SPDIF/RAW
	SPDIF/PCM
EXIT SETUP	

AUDIO SETUP	
AUDIO OUT	
KEY	
	#
	+4
	+2
	0
	-2
	-4
	-6
EXIT SETUP	

4. VIDEO SETUP

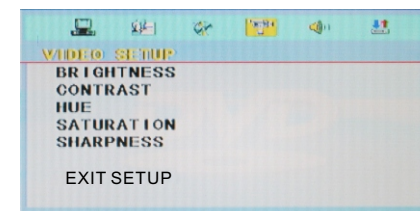

VIDEO SETUP	
BRIGHTNESS	12
CONTRAST	10
HUE	8
SATURATION	6
SHARPNESS	4
	2
	0
EXIT SETUP	

VIDEO SETUP	
BRIGHTNESS	12
CONTRAST	10
HUE	8
SATURATION	6
SHARPNESS	4
	2
	0
EXIT SETUP	

VIDEO SETUP	
BRIGHTNESS	+6
CONTRAST	+4
HUE	+2
SATURATION	0
SHARPNESS	-2
	-4
	-6
EXIT SETUP	

VIDEO SETUP	
BRIGHTNESS	12
CONTRAST	10
HUE	8
SATURATION	6
SHARPNESS	4
	2
	0
EXIT SETUP	

VIDEO SETUP	
BRIGHTNESS	8
CONTRAST	6
HUE	4
SATURATION	2
SHARPNESS	0
EXIT SETUP	

5. SPEAKER SETUP

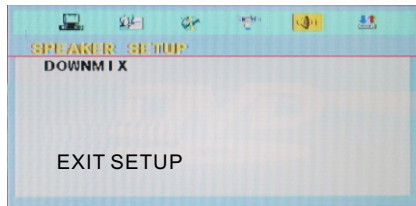

In the speaker set menu "LT/RT" "STEPEO" "VSS" three submenu choices.

6. DIGITAL SETUP

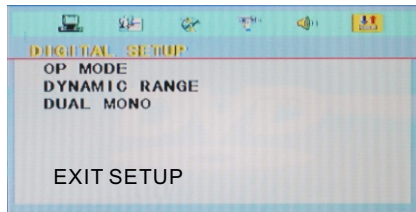

DIGITAL SETUP		DIGITAL SETUP		DIGITAL SETUP	
OP MODE	LINE OUT	OP MODE		OP MODE	
DYNAMIC RANGE	RF REMOD	DYNAMIC RANGE		DYNAMIC RANGE	STEREO
DUAL MONO		DUAL MONO		DUAL MONO	MONO L
					MONO R
					MIX MONO
EXIT SETUP		EXIT SETUP		EXIT SETUP	

Function Index Sign

FM	FM Frequency range	87.5~108.0MHZ
	Noise limit sensitivity	20dBu
	S/N Ratio	50dBu
	Antenna resistance	75Ω
AM	MW Frequency range	530~1730KHZ
	S/N 30db	35dBu
	S/N Ratio	40dBu
	Antenna resistance	75Ω
AUDIO	S/N Ratio	80dBu
	Max output power	4Ω 60W*4CH
VIDEO	Video output scope	1+/-0.2V
	Video Horizontal Resolaton	≥600

Warning

1. To ensure the accurate of touch function, please touch the center point of relative function.
2. There are build in anti-jamming system in touch screen, To prevent the wrong position touch, please keep to touch this function for 0.5 second, then the product will get respond for your instruction.
3. Please do not use the object, which is bigger than the function icon to touch the screen. Otherwise the touch function will failure or give the wrong operation to other function.
4. To ensure the panel safety, please don't press or use the sharp object to touch the panel.
5. Don't play the severity scratch disc, otherwise will damage the DVD play capability.
6. Be sure to distinguish the anode and the cathode when connecting the power. If connect wrong, the fuse in filter box will melt immediately to protect unit. Then please replace the same parameter fuse.
7. DC 12V should be best to connect with the power adapter to prevent from the over-voltage drop the may influence the normal work of the monitor.
8. Keep this machine away from too hot, or under effect of moisture, dust or oil smoke, avoid this machine from dropping or impacting, never extrude or chafe this machine with sharp objects.
9. Dangerous high voltages are present inside the enclosure. Do not open the cabinet, non-professionals can not disassemble unit.
10. Installation should be very tight and secure. Preventing the fallen unit hurt people when moving on or a sudden brake.

Disc Notes.

Specifications

	DVDs	12cm
	Vedio CDs	12cm
	Audio CDS	12cm
	MP3 CDs	12cm
	JPG CDs	12cm

Disc type	DVD Vedio VedioCD	CD-DA MP3 JPEG
Video output	Vedio output Video output: 1.0Vpp/75ohm	
LCD panel	7" color TFT Pixels: 480xR. G. BX234	
Power	DC: 12V/10A	
Working temperature	5°C~45°C	

Simple Trouble-Shooting Guide

If your product fails, please follow the way of exclusion, if it is still unresolved, please contact the professional or supplier.

Symptom	Probable Cause	Solution
Black Screen	1.No12 voltage 2.Brightness or contrast ratio is too small	1. check the power is on or connect rightly 2. check the A/V Cable is loose or not 3. Increase the brightness and contrast ratio
NO picture	1.No sources output 2.The video concentric plug becomes loose	1.Check the output of VCD or DVD 2.Replace with the A/V cable 3.Tighten the Video input cable
color picture	1 Video sources have no output 2.Color ratio should be re-adjust	1.check the video sources 2.Enter into the Menu to re-adjust
With a little regular light spots and color spots on the screen or black horizontal line in the picture	It is normal symptom in the active matrix display technology.	it is normal symptom in view range with a little regular light spots on display screen.
Unclear picture	1.Poor quality of the video sources 2.Bright & Contrast	1.Replace with the high quality videodisc 2.Reset Bright & contrast.
The outer cover of the monitor has been deformed	1.External temperature is too high. 2.The power has not been switched off for a long time.	1.The surround temperature should not exceed to 0-60 degrees. 2.Turn off the power after using the unit.

ALARM

For your safety, driver are advised not to watch the display when driving. It's prohibited in law of some countries when driving and operating to watch displayer.

FCC STATEMENT

1. This device complies with Part 15 of the FCC Rules.

Operation is subject to the following two conditions:

(1) This device may not cause harmful interference.

(2) This device must accept any interference received, including interference that may cause undesired operation.

2. Changes or modifications not expressly approved by the party responsible for compliance could void the user's authority to operate the equipment.

NOTE: This equipment has been tested and found to comply with the limits for a Class B digital device, pursuant to Part 15 of the FCC Rules. These limits are designed to provide reasonable protection against harmful interference in a residential installation. This equipment generates uses and can radiate radio frequency energy and, if not installed and used in accordance with the instructions, may cause harmful interference to radio communications. However, there is no guarantee that interference will not occur in a particular installation. If this equipment does cause harmful interference to radio or television reception, which can be determined by turning the equipment off and on, the user is encouraged to try to correct the interference by one or more of the following measures:

Reorient or relocate the receiving antenna.

Increase the separation between the equipment and receiver.

Connect the equipment into an outlet on a circuit different from that to which the receiver is connected.

Consult the dealer or an experienced radio/TV technician for help.

FCC Radiation Exposure Statement

This equipment complies with FCC radiation exposure limits set forth for an uncontrolled environment. This equipment should be installed and operated with minimum distance 20cm between the radiator & your body