

## Installation Guide

### Pre-Installation Checklist

- ADC-V730 camera (included)
- AC power adapter (included)
- Wi-Fi (2.4 or 5 GHz) connection to broadband Internet (Cable, DSL, or Fiber Optic) Internet. For information about bandwidth requirements, see [What are the internet service and bandwidth requirements for Alarm.com](#) video devices?
- A computer, tablet, or smartphone with Wi-Fi is required if the router does not have the Wi-Fi Protected Setup (WPS) feature

There are two options for connecting the ADC-V730 to the Wi-Fi network: Access Point (AP) mode or Wi-Fi Protected Setup (WPS) mode. Use WPS mode if you have easy access to the customer's router and the router has the WPS feature enabled.

Note: Some Internet Service Providers disable the WPS feature on customer routers. AP mode is the most reliable method for installing this device.

### In The Box

ADC-V730 camera  
12V/1.5A Power Adapter  
Installation card  
Wall anchors & screws (3)

### Overview

1. Ambient Light Sensor
2. Microphone
3. Spotlight
4. Status LED
5. WPS/Reset Button
6. SD Card Slot
7. SD Card Door
8. Speaker

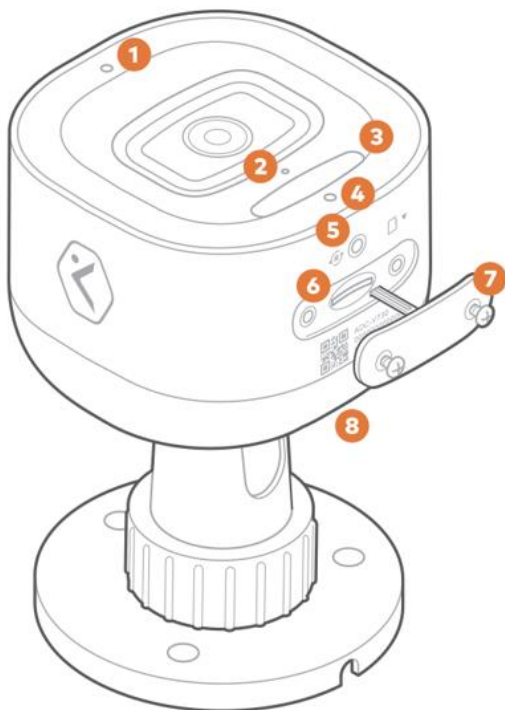

### Rubber plug

A rubber plug has been included with your ADC-V730 at the base of the mount. This rubber plug should only be used if you are mounting it directly over a hole in the wall. The rubber plug will provide a seal to prevent water from entering the hole in the wall behind the camera.

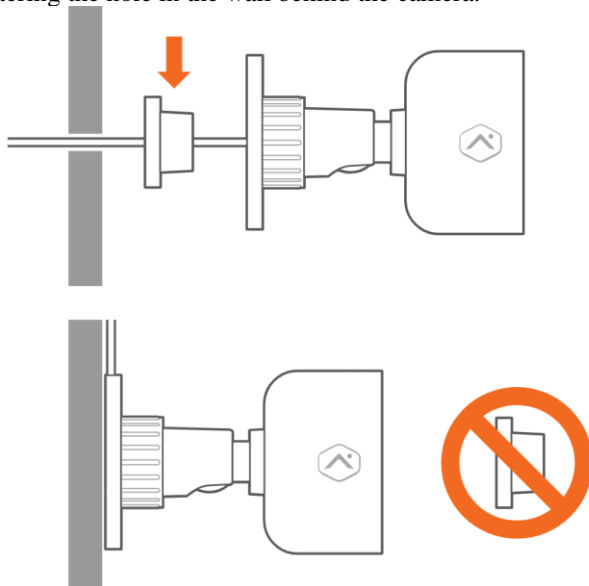

In all other installations, please remove the rubber plug. Removing the rubber plug will allow you to route the power cable through the mouse hole without bending or breaking the cable.

### Installation

For information about general video installation and maintenance guidelines, see [Video Installation Best Practices](#).  
For information about setting up and using Two-Way Audio, see [Two-Way Audio Installation and User Guide](#).



### **AP Mode (recommended)**

To ensure sufficient Wi-Fi signal, complete these steps with the camera near its final location but prior to mounting.

1. Connect the camera's AC power adapter and plug it into a non-switched outlet. If the standard power supply is too short to reach an outlet, see [How do I extend the power supply of a camera?](#).
2. The camera's LED will begin to blink white. If the LED is not white after two minutes, press and hold the WPS/Reset button and release when the LED begins to blink white (about 3 seconds).
3. On an Internet-enabled device, connect to the Wi-Fi network ADC-V730 (XX:XX:XX) where XX:XX:XX is the last six characters of the ADC-V730's MAC address, which is located on the camera or on the packaging.
4. On the same device, open a web browser and enter <http://v730install> or 192.168.1.1 in the URL field. Follow the on-screen instructions to add the ADC-V730 to the Wi-Fi network. The LED will briefly turn red before blinking green. The LED will be solid green when the connection is complete.
5. Add the device to the account by either selecting the account in the MobileTech app or by using a web browser and entering the following web address: [www.alarm.com/addcamera](http://www.alarm.com/addcamera) (you will need the customer user name and password).
6. Select the camera from the video device list or enter its MAC address to begin adding the camera. The MAC address is located on the camera or on the packaging.
7. Follow the on-screen instructions to finish adding the camera.

You can now power down the camera and install it in its final location using the included hardware. You may configure camera settings from the customer website.

### **WPS Mode (alternate)**

To ensure sufficient Wi-Fi signal, complete these steps with the camera near its final location but prior to mounting.

1. Connect the camera's AC power adapter and plug it into a non-switched outlet.
2. After the startup process is complete (the camera's LED will be blinking white), press and hold the WPS/Reset button and release when the LED begins to blink blue (about 6 seconds).
3. Activate WPS mode on the router. The camera will begin to connect to the Wi-Fi network. The LED will be solid green when the connection is complete.
4. Add the device to the account by either selecting the account in the MobileTech app or by using a web browser and entering the following web address: [www.alarm.com/addcamera](http://www.alarm.com/addcamera) (you will need the customer user name and password).
5. Select the camera from the video device list or enter its MAC address to begin adding the camera. The MAC address is located on the camera or on the packaging.
6. Follow the on-screen instructions to finish adding the camera.

You can now power down the camera and install it in its final location using the included hardware. You may configure camera settings from the customer website.

## Camera Mounting Overview

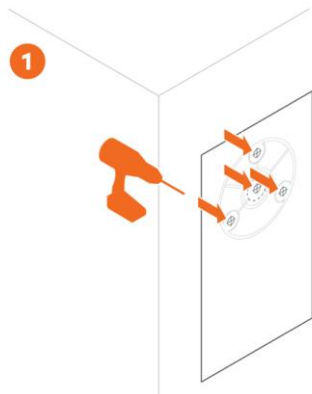

To mount the ADC-V730 when routing the power cable through the wall







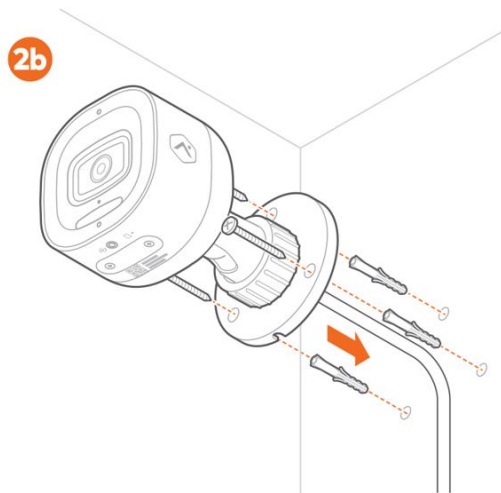





1. The camera should be mounted 8 feet or more above the ground, on a flat surface (e.g., a wall or ceiling). Install the rubber plug.
2. Verify that there are no obstructions near the camera. Obstructions can lead to poor night vision performance.
3. Use the included drill template to mark the desired location of the holes for the power cable and mounting screws. Drill a 1/2" hole in the center of the template for the power cable. If mounting to drywall, drill three 9/32" holes and insert the included M5 wall anchors. If mounting to a solid surface (e.g., wood), drill three 1/8" pilot holes.
4. Connect the 12 VDC connector to an unplugged 12 VDC adapter. Insert the power cable into the center hole.
5. Line up the camera with the three holes created in step 3. Use the included ST4.8 x 32mm self tapping screws to fasten the camera to the mounting surface (#10 drywall screws or 3/16" Tapcon screws are also acceptable).

**To mount the ADC-V730 when routing the power cable along the wall**



1. The camera should be mounted 8 feet or more above the ground, on a flat surface (e.g., a wall or ceiling). Remove the rubber plug.
2. Verify that there are no obstructions near the camera. Obstructions can lead to poor night vision performance.
3. Use the included drill template to mark the desired location of the holes for the mounting screws. If mounting to drywall, drill three 9/32" holes and insert the included M5 wall anchors. If mounting to a solid surface (e.g., wood), drill three 1/8" pilot holes.
4. Connect the 12 VDC connector to an unplugged 12 VDC adapter.
5. Line up the camera with the three holes created in step 3. Use the included ST4.8 x 32mm self tapping screws to fasten the camera to the mounting surface (#10 drywall screws or 3/16" Tapcon screws are also acceptable). Route the cable through the cut-out in the mounting plate.

## LED Reference Guide

LED Pattern	Description
Off 	Power off
Solid Green 	Connected to <a href="https://www.alarm.com">Alarm.com</a>
Blinking Green 	Local network connection
Blinking Red 	Power on, camera booting
Solid Red 	No local or Internet connection
Blinking White 	Wi-Fi Access Point mode (press and hold button for 3-6 seconds)
Blinking Blue 	WPS mode (press and hold button for 6-9 seconds)
Blinking Yellow 	Power cycling (press and hold button for 9-12 seconds)
Blinking Red and Green 	Reverting to factory default settings (press and hold button for 12-15 seconds)
Blinking Green and Blue 	Firmware updating

## Troubleshooting

1. If you have issues connecting the camera to the account, power cycle the camera and try again.
2. If issues persist, reset the camera to factory defaults. Press and hold the WPS/Reset button until the LED is flashing green and red (about 12 seconds), then release the button. The camera will reboot to factory default.

If the camera was previously installed on a different Alarm.com account, it will need to be deleted before it can be installed again.

**Caution:** Prolonged exposure to sunlight in extreme conditions may impact the camera's performance. The optimal installation location is in a shaded area such as under an eave.

## Regulatory Statements

Operating Temperature: -58°F – 122°F (-50°C – 50°C)

Ingress Protection: IP66

## FCC compliance Statements

This device complies with part 15 of the FCC Rules. Operation is subject to the following two conditions: (1) This device may not cause harmful interference, and (2) this device must accept any interference received, including interference that may cause undesired operation.

## FCC Long Part 15 Statement

Note: This equipment has been tested and found to comply with the limits for a Class B digital device, pursuant to part 15 of the FCC Rules. These limits are designed to provide reasonable protection against harmful interference in a



residential installation. This equipment generates, uses and can radiate radio frequency energy and, if not installed and used in accordance with the instructions, may cause harmful interference to radio communications. However, there is no guarantee that interference will not occur in a particular installation. If this equipment does cause harmful interference to radio or television reception, which can be determined by turning the equipment off and on, the user is encouraged to try to correct the interference by one or more of the following measures:

- Reorient or relocate the receiving antenna.
- Increase the separation between the equipment and receiver.
- Connect the equipment into an outlet on a circuit different from that to which the receiver is connected.
- Consult the dealer or an experienced radio/TV technician for help.

Changes or modifications not expressly approved by the party responsible for compliance could void the user's authority to operate the equipment.

### **RF Exposure**

This equipment complies with FCC and ICSED radiation exposure limits set forth for an uncontrolled environment. This equipment should be installed and operated with a minimum distance of 20cm between the equipment and your body. This device and its antenna(s) must not be co-located or operating in conjunction with any other antenna or transmitter.

### **FCC ID**

FCC ID: YL6-143V730

### **ICSED Statements**

#### **Condition**

This device contains license-exempt transmitter(s)/receiver(s) that comply with Innovation, Science and Economic Development Canada's licence-exempt RSS(s). Operation is subject to the following two conditions:

1. This device may not cause interference.
2. This device must accept any interference, including interference that may cause undesired operation of the device.

Cet appareil contient des émetteurs/récepteurs sans licence qui sont conformes aux RSS sans licence d'Innovation, Sciences et Développement économique Canada. L'exploitation est soumise aux deux conditions suivantes :

1. Cet appareil ne doit pas provoquer d'interférences.
2. Cet appareil doit accepter toute interférence, y compris les interférences susceptibles de provoquer un fonctionnement indésirable de l'appareil.

### **RF Exposure**

This equipment complies with FCC and ICSED radiation exposure limits set forth for an uncontrolled environment. This equipment should be installed and operated with a minimum distance of 20cm between the equipment and your body. This device and its antenna(s) must not be co-located or operating in conjunction with any other antenna or transmitter.

Cet appareil est conforme aux limites d'exposition aux radiofréquences établies par la FCC et l'ICSED pour un environnement non contrôlé. Cet appareil doit être installé et utilisé à une distance minimale de 20 centimètres entre l'appareil et votre corps. Cet appareil et son ou ses antennes ne doivent pas être situés ou fonctionner en conjonction avec une autre antenne ou un autre émetteur. Veuillez communiquer avec [intsupport@alarm.com](mailto:intsupport@alarm.com) pour obtenir plus d'information sur la conformité aux exigences canadiennes en matière d'exposition aux radiofréquences.

### **IC ID**

IC: 9111A-143V730

**EU Declaration of Conformity Statement**

Hereby, Alarm.com Incorporated declares that the equipment type ADC-V730 is in compliance with Directive 2014/30/EU. The full text of the EU declaration of conformity is available at the following internet address:

<https://www.alarm.com/about/international/eu-red>