



WIRELESS KEYFINDER

Instruction Manual

FEATURES

The wireless keyfinder offers a convenient way to track down misplaced keys. The two compact keyfobs include a loud location alarm and a handy flashlight. The base station includes docking stations for the two keyfobs - great way to store your keys!

BATTERY INSTALLATION

Each of the keyfob units takes 2 x CR2032 lithium batteries (included). Use a screwdriver to remove the battery door on the rear of each keyfob by sliding it in the direction of the arrow. Install the batteries with their "+" side facing up and replace the battery door. (Fig. 1)

The base station requires 3 x AAA batteries (not included). Remove the battery door at the rear of the base station by sliding it in the direction of the arrow. Install the batteries following the polarities markings inside the battery compartment. (Fig. 2)

When the keyfobs are hanging on the base station, their receivers are disconnected to conserve battery life.

PAIRING THE BASE STATION WITH THE KEYFOB RECEIVERS

- Remove the keyfob from the base station.
- Press and hold the light/alarm key on the keyfob for 4-5 seconds. The light on the keyfob will flash and the keyfob will enter the pairing mode for every 5 seconds until they are paired.
- Press and hold the pairing key located on the back of the base station and the coloured "find" key on the front of the base station (red for the red keyfob, etc.).
- The indicator light on the base station will also begin to flash. Release both keys.
- The keyfob will beep twice to indicate that the pairing is successful. The indicator light on the keyfob will go out. Press the coloured key on the front of the base station to return to normal mode or, it will return to normal mode automatically after 1 minute.
- Repeat this process with the other keyfob.

MOUNTING THE BASE STATION

The base station can be wall-mounted using the keyhole shaped slots on the back of the unit.

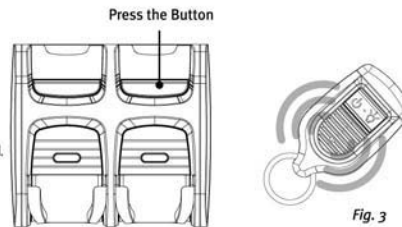
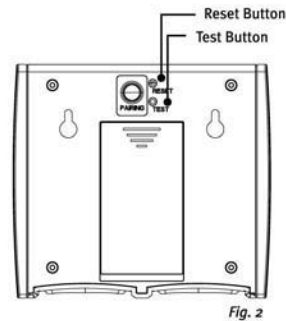
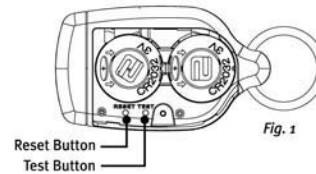
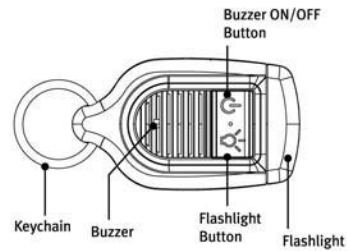

USING THE WIRELESS KEY FINDER

The wireless key finder is comprised of a base station and two coloured key fobs. To locate your keys, press the button on the base station that corresponds with the colour code of your keyfob (red or green).

When the button is pressed, the coloured transmit light on the base station will light, indicating that a signal is being sent to your keys. Within a few seconds you will hear the alarm signal from your keyfob. To cancel the alarm, press either the coloured button on the base station, or the button on your keyfob.

If your keyfob does not respond, it may be outside the range of the base station. Move the base station to another location and try again. The wireless key finder has a range of approximately 20 meters (60 feet), but solid obstructions or electrical interference around your home may reduce this range. (Fig. 3)

USING THE KEYFOB FLASHLIGHT

Built into each keyfob unit is an LED flashlight. Press the button on the keyfob to switch the light on, press it again to switch off. If the locator alarm is sounding while the light is on, the first press of the button will cancel the alarm and a second press will switch the light off.

TROUBLESHOOTING

If your wireless key finder does not work, please check these points:

Main Unit Battery - if the coloured light does not light up when the "find" key is pressed, the batteries in your main unit require replacement with 3 x AAA batteries (ensure that the batteries are correctly inserted into the battery compartment, following the polarity markings shown).

Keyfob Battery - if the flashlight does not operate when the button on the keyfob unit is pressed, the batteries require replacement with 2 x CR2032 batteries (ensure that the batteries are correctly inserted into the battery compartment, following the polarity markings shown).

Range - if your keyfob does not sound it's alarm when the correct coloured "find" key is pressed, your keyfob may be out of range. Move the base station to another location and try again.

Reset - if your wireless key finder is not working correctly and these instructions do not help, press the reset button on the rear of the base station. Please note, this will delete all the pairing setups, so you will need to configure the system again.

CAUTION

Read the instruction manual before using.

Immediately dispose of used batteries safely. Keep all batteries away from children. Batteries are small objects and could be ingested. If swallowed, contact a physician at once. Do not open battery, dispose of in fire, or attempt to recharge. Do not immerse the unit in water or expose to rain.

WARNING: CHOKING HAZARD - Small parts not suitable for children under 3 years of age.

FCC STATEMENT

1. This device complies with Part 15 of the FCC Rules. Operation is subject to the following two conditions:
(1) This device may not cause harmful interference, and
(2) This device must accept any interference received, including interference that may cause undesired operation.
2. Changes or modifications not expressly approved by the party responsible for compliance could void the user's authority to operate the equipment.

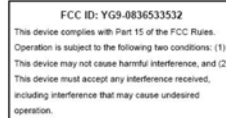

NOTE: This equipment has been tested and found to comply with the limits for a Class B digital device, pursuant to Part 15 of the FCC Rules. These limits are designed to provide reasonable protection against harmful interference in a residential installation. This equipment generates, uses and can radiate radio frequency energy and, if not installed and used in accordance with the instructions, may cause harmful interference to radio communications. However, there is no guarantee that interference will not occur in a particular installation. If this equipment does cause harmful interference to radio or television reception, which can be determined by turning the equipment off and on, the user is encouraged to try to correct the interference by one or more of the following measures:

- Reorient or relocate the receiving antenna.
- Increase the separation between the equipment and receiver.
- Connect the equipment into an outlet on a circuit different from that to which the receiver is connected.
- Consult the dealer or an experienced radio/TV technician for help.