

CEILING / WALL LIGHT WITH REMOTE (JB5571)

Extra Lights (JB5573) sold separately

INSTRUCTIONS

1

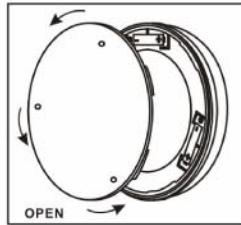

Twist the back cover of the light counter clockwise to open.

2

Battery
Insert 4 x 'AA' Batteries

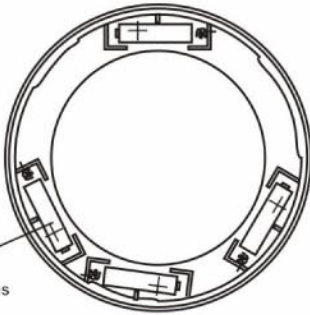

Insert 1 x 23A 12Volt Batteries

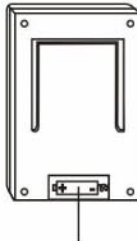

Insert batteries in the back of the light and remote as shown.

CAUTION

Only use batteries of the same type. Do not mix alkaline, standard (carbon-zinc), or rechargeable (nickel-cadmium) batteries. Do not mix old and new batteries.

This device complies with Part 15 of the FCC Rules. Operation is subject to the following two conditions: (1) this device may not cause harmful interference, and (2) this device must accept any interference received, including interference that may cause undesired operation.

Any changes or modifications to this device not explicitly approved by manufacturer could void your authority to operate this equipment.

3

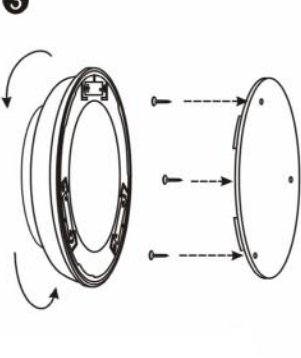

Mount the back plate to a wall or ceiling (screws included).

WALL

Mount the remote to the wall (screws included).

4

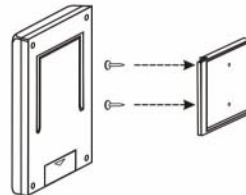

WALL

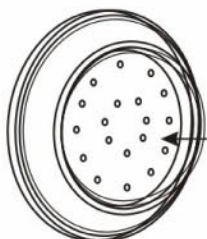
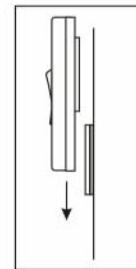

20'



ON
OFF

The remote will work with up to 4 lights at 20 feet away.

*Must purchase JB5571 for JB5573 to work.