



Lenovo A6020I36

Quick Start Guide

 Read this guide carefully before using your smartphone.

Technical specifications



Model and system

Model: Lenovo A6020I36

System: Android



① Dimensions and weight

Height: 141.0 mm (5.55 inches)

Width: 71.0 mm (2.8 inches)

Depth: 8.2 mm (0.32 inch)

Weight: 142.4 g (0.31 lb)



Processor

Processor: MSM8939R3, octa-core, 1.5 GHz

② Capacity: 16 GB



Camera

Type: CMOS

Pixels: 13.0 megapixels (back) + 5.0 megapixels (front)



Battery

Battery: 2750 mAh



Display

Size: 5.0 inches

Screen: multi-touch

Resolution: 1080 × 1920 pixels

LCD type: FHD



Wireless Communication

Bluetooth 4.1; WLAN 802.11 b/g/n; WCDMA, GSM; FDD-LTE



AC/DC adapter

Input: 100-240 Vac 50/60 Hz 0.3 A

Output: 5.2 Vdc 2 A



① Depending on the measuring method, the dimensions and weight might vary slightly.

② Total memory 16 GB, available for user 10 GB.

First glance

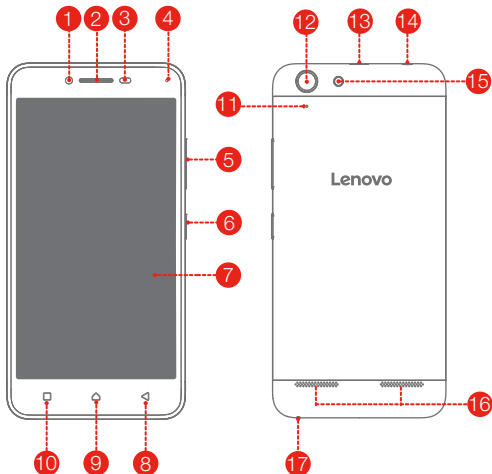

- | | | |
|------------------------|--------------------------|--------------------------|
| 1 Front-facing camera | 2 Receiver | 3 Light/Proximity sensor |
| 4 Indicator light | 5 Volume buttons | 6 On/Off button |
| 7 Touch screen | 8 Back button | 9 Home button |
| 10 Menu button | 11 Anti-noise microphone | 12 Rear-facing camera |
| 13 Micro USB connector | 14 Headset connector | 15 Flashlight |
| 16 Speaker | 17 Microphone | |

Preparing your smartphone

You must insert the Micro-SIM card provided by your carrier to use cellular services. Set up your smartphone as shown.

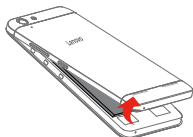

Step 1. Open the back cover.

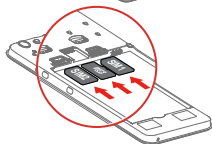

Step 2. Insert the Micro-SIM cards and the memory card.

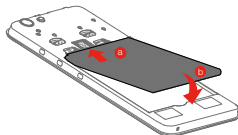

Step 3. Install the battery.

- a. Align the battery connectors on the battery with the pins in the battery compartment.
- b. Push the battery down into place.

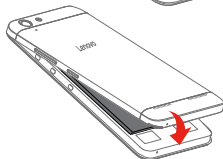

Step 4. Install the back cover.



Always turn off your smartphone first before you insert or remove a Micro-SIM card. Insert or remove a Micro-SIM card with your smartphone on may damage your Micro-SIM card or smartphone permanently.

Charging the battery

Charge the battery as shown.

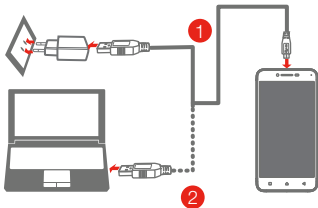

Method 1. Connect your smartphone to a power outlet using the cable and USB power adapter that come with your smartphone.

Method 2. Connect your smartphone to a computer using the cable that comes with your smartphone.

 Low battery power

 Fully charged

 Charging

Turning on or turning off your smartphone

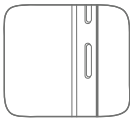

Turn on: Press and hold the On/Off button until the Lenovo logo appears.

Turn off: Press and hold the On/Off button for a few seconds, then tap **Power off**.

Restart: Press and hold the On/Off button for a few seconds, tap **Restart**, and then tap **OK**.

 Your smartphone has a rechargeable battery. For more information about battery safety, see the “Rechargeable battery notice” in the *Important Product Information Guide* shipped with your smartphone.

FCC regulations

This mobile phone complies with part 15 of the FCC Rules. Operation is subject to the following two conditions: (1) This device may not cause harmful interference, and (2) this device must accept any interference received, including interference that may cause undesired operation.

This mobile phone has been tested and found to comply with the limits for a Class B digital device, pursuant to Part 15 of the FCC Rules. These limits are designed to provide reasonable protection against harmful interference in a residential installation. This equipment generates, uses and can radiated radio frequency energy and, if not installed and used in accordance with the instructions, may cause harmful interference to radio communications. However, there is no guarantee that interference will not occur in a particular installation. If this equipment does cause harmful interference to radio or television reception, which can be determined by turning the equipment off and on, the user is encouraged to try to correct the interference by one or more of the following measures:

- Reorient or relocate the receiving antenna.
- Increase the separation between the equipment and receiver.
- Connect the equipment into an outlet on a circuit different from that to which the receiver is connected.
- Consult the dealer or an experienced radio/TV technician for help.

FCC Note:

Caution: Changes or modifications not expressly approved by the party responsible for compliance could void the user's authority to operate the equipment.

RF exposure information (SAR)

This phone is designed and manufactured not to exceed the emission limits for exposure to radio frequency (RF) energy set by the Federal Communications Commission of the United States.

During SAR testing, this device was set to transmit at its highest certified power level in all tested frequency bands, and placed in positions that simulate RF exposure in usage against the head with no

separation, and near the body with the separation of 10 mm. Although the SAR is determined at the highest certified power level, the actual SAR level of the device while operating can be well below the maximum value. This is because the phone is designed to operate at multiple power levels so as to use only the power required to reach the network. In general, the closer you are to a wireless base station antenna, the lower the power output.

The exposure standard for wireless devices employing a unit of measurement is known as the Specific Absorption Rate, or SAR.

The SAR limit set by the FCC is 1.6W/kg.

This device is complied with SAR for general population /uncontrolled exposure limits in ANSI/IEEE C95.1-1992 and had been tested in accordance with the measurement methods and procedures specified in IEEE1528.

The FCC has granted an Equipment Authorization for this model phone with all reported SAR levels evaluated as in compliance with the FCC RF exposure guidelines. SAR information on this model phone is on file with the FCC and can be found under the Display Grant section of www.fcc.gov/oet/ea/fccid after searching on FCC ID: YCNA6020L36.

For this device, the highest reported SAR value for usage against the head is 0.80 W/kg, for usage near the body is 1.14 W/kg.

While there may be differences between the SAR levels of various phones and at various positions, they all meet the government requirements.

SAR compliance for body-worn operation is based on a separation distance of 10 mm between the unit and the human body. Carry this device at least 10 mm away from your body to ensure RF exposure level compliant or lower to the reported level. To support body-worn operation, choose the belt clips or holsters, which do not contain metallic components, to maintain a separation of 10 mm between this device and your body.

RF exposure compliance with any body-worn accessory, which contains metal, was not tested and certified, and use such body-worn accessory should be avoided.

Learning more

To learn more information about your Lenovo smartphone and obtain the latest smartphone manuals, go to:

<http://support.lenovo.com/>.

Getting support

For support on network service and billing, contact your wireless network operator. For instructions on how to use your device, go to:

<http://support.lenovo.com/>.

Legal notices

Lenovo and the Lenovo logo are trademarks of Lenovo in the United States, other countries, or both.

Other company, product, or service names may be trademarks or service marks of others.

© Copyright Lenovo 2016.

V1.0_20160201

Reduce | Reuse | Recycle



XXXXXXXXXX

Printed in China