

User manual

Instruction Manual

FOR
AGES 6

⚠ ATTENTION!

Please read the Instruction Manual carefully and keep it properly.

[illegible]

ATTENTION

- Please do not touch the instruction Manual carefully and keep it properly after reading.
- Please do not hold or twist of any part.
- Please do not switch on the power while the wheels are locked, not to cause the engine in high temperature and out of order.
- Please do not stretch or drop it on the floor.
- Please keep distance from sunshine, the high temperature and moisture.
- Please do not slide the car while charging to cause the damage in charging platform.
- Please pull out the plug from the car cable after charging.
- Please disconnect the packed machine after its unseal.
- These products is not easy maintenance. It will be out of order if affixed the dust or rubbish when lay outdoors.
- Please do not lay at camp or wooden material.

Method of battery installation

- 1 To open the battery compartment cover of the driver
 - 2 To test AKA sensitivity set according to the instructions in the manual and to make positive and negative poles
 - 3 Reduced the battery compartment cover
-

2 Installation of Racing Wing

The dumped car body will recover easily with Racing wing installation, the car will work normally even without Racing wing installation.

Procedures of making the Racing Wing

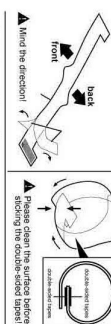

■ Installation of Racing Win

- ▲** Clean the surface before sticking the double-sided tapes!

3 operating principle of Remote Control car

- 1 The red light at the bottom of the car keeps light while switches on the power and works ordinary
- 2 The red light at the bottom of the car flashes quickly while the car is at low voltages
- 3 The red light at the bottom of the car flashes slowly while the car is at medium voltages
- 4 The red light will turn to lighted if charging finished, please refer to the photo below for the charging
- 5 Please keep the power switch on while charging

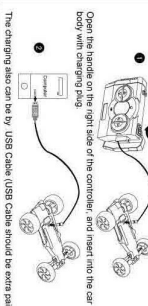

4 Installation of Telecontrol antennae

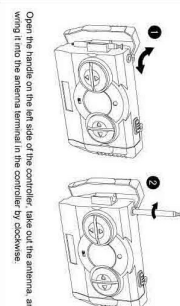

Jumping skills

5 Operation of remote control car

- **Operation of forward, backward & speed up**
Press the upward key on the left side of controller, the car will go forward

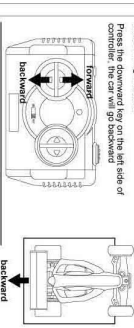

Press the rightward key on the right side of controller, the car will turn right. Press the rightward key on the right side of controller, the car will turn right.

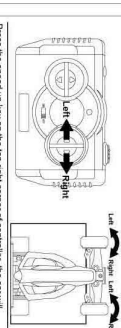

Press the speed up key on the top right corner or corner forward in max speed

6

- 1. Model 1:** Press the forward key on the controller, the car will rush towards the platform. (When approach the platform, press the speed up key, the car will rush faster).

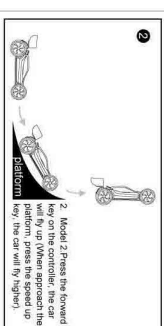

-
3. Model 3 Press the forward key on the controller, meanwhile, press the speed up key, the car will upturn

Solution Guiding	
Reason	solution
problem	<p>extracted distances of car body</p> <p>reducing the ballistics</p>
<p>estimated distances of controller</p> <p>R/C Car doesn't work</p>	<p>reduce the ballistics</p> <p>across the distance between the controller and the car</p>
<p>radio wave can not be transmitted</p> <p>forget to switch on the power</p>	<p>switches for both the controller and car</p>
<p>didn't put antenna on the pins</p> <p>Operation is not smoothly</p>	<p>the wheel will rotate constantly, if antenna by data phase do clean the lines</p> <p>put out the antenna completely</p>
<p>the antenna not pulled out completely</p> <p>the gradient of platform isn't good enough</p>	<p>adjust the angle of platform</p>

Maintenance method

1. Please clean the floor before playing, otherwise, the dust affixed on the tires will affect the operation
2. please clean the dust on the tires or gear

post-use

1. Switch off the power for both the controller and the car, batteries should be taken out.
2. The car should be placed at level place.

This device complies with Part 15 of the FCC Rules. Operation is subject to the following two conditions: (1) this device may not cause harmful interference, and (2) this device must accept any interference received, including interference that may cause undesired operation.

Changes or modifications not expressly approved by the party responsible for compliance could void the user's authority to operate the equipment.