

# COMMUNICATOR MODEL 318US

## OWNER'S MANUAL AND OPERATING INSTRUCTIONS

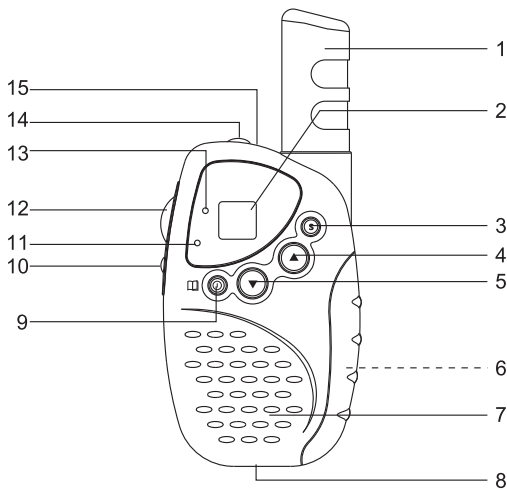

### Communicator Controls

1. Antenna
2. LCD Screen: Displays current channel selection and other radio status symbols.
3. SCAN button: Press and hold 1 sec. for channel scanning.
4. Up button (VOLUME/CHANNEL): Press to adjust volume level and change channels.
5. Down button (VOLUME/CHANNEL): Press to adjust volume level and change channels.
6. Battery Compartment (LOCATED ON THE REAR): Houses 3 x "AAA" alkaline or Ni-MH rechargeable batteries (not included).
7. Speaker
8. Battery Compartment Cover Latch (LOCATED ON THE REAR): Secures Battery Compartment cover.
9. Menu/Power (On/Off) button: Press and hold the button to turn your unit ON/OFF. Allows you to change channels, select high/low power. Press to tune in and hold onto weak signals.
10. Torch button: Press and hold to turn on the torch.
11. Mic: Microphone.
12. PUSH TO TALK/CALL button: Press and hold for PTT. Press twice shortly for call tone transmission.
13. TX (Transmission) LED indicator: Illuminates red when transmitting. Lights up once every 15 seconds to show battery low.
14. LED Torch
15. Belt Clip (LOCATED ON THE REAR) is just convenient of carrying, not using in transmission.

### Getting Started

Carefully remove your communicator from its Packing. If there is any visible damage, do not attempt to operate this communicator. Return it to the place of purchase

Removing the BELT CLIP:

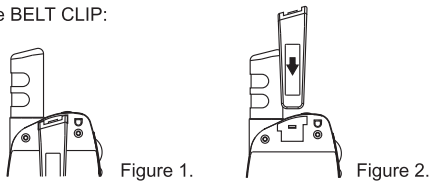

1. Pull the BELT CLIP LATCH away from the unit.
2. While pulling the BELT CLIP LATCH, push up on the BELT CLIP to remove it from the unit. See Figure 1.

Installing the Belt Clip:

1. Slide the BELT CLIP into the BELT CLIP SLOT. See Figure 2.
2. A "click" indicates the BELT CLIP is locked into position.

Battery Installation:

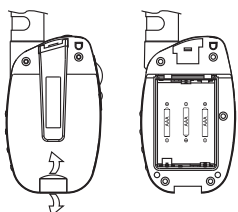

1. Release the BATTERY COMPARTMENT COVER LATCH located on the rear side of the unit (see Figure 3) and remove the BATTERY COMPARTMENT COVER from the BATTERY COMPARTMENT (See Figure 4).
2. Install 3x1.5V AAA alkaline batteries or Ni-MH rechargeable batteries (not included) as shown.
3. Reinstall the BATTERY COMPARTMENT COVER and lock the BATTERY COMPARTMENT COVER LATCH into position.

When the COMMUNICATOR is not being used, conserve battery power by pressing the button to OFF. Remove the batteries if the unit will not be used for a long period of time.

LCD Screen:

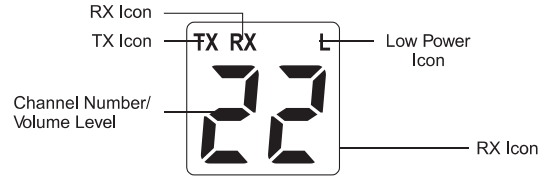

**TX** Light on in Transmission mode

**RX** Light on in Receiving mode

**22** Volume Level/Channel Number changes from 1 to 22 as selected by user

**L** Light on when low power is selected

Turning the Unit ON:

Press and hold the button. The unit will "beep" with dual tone and the LCD SCREEN will briefly display a SELF-TEST Screen.

Turning the Unit OFF:

Press and hold the button. The unit will "beep" with a signal tone and the LCD Screen will turn blank.

Adjusting Speaker Volume:

1. Press the Up button to increase the Speaker Volume.
2. Press the Down button to decrease the Speaker Volume.
3. The Speaker Volume level is indicated by the number 1 to 8 displayed on the LCD Screen.

Receiving a Signal:

The unit is continuously in the RECEIVE mode when the unit is ON and not Transmitting. When you receive a signal on the current channel, the RX icon is displayed. (See "LCD SCREEN" for details) and red LED indicator lights up.

Transmitting a Signal:

1. Check the channel activity by using MONITOR function (See below "MONITOR" section). You'll hear static if the channel is unoccupied. Don't TRANSMIT if someone is talking on the channel. Press and hold the button to TRANSMIT. The TX LED Indicator will light up in red. Hold the unit in a vertical position with the MICROPHONE 2 to 3 inches from the mouth.
2. While holding the button, speak into the unit using a normal tone of voice.
3. Release the button when you have finished transmitting.

NOTE: In order for other people to receive your transmission, they must also be on the same channel you are currently using. Refer to the "Changing Channels" section for more information.

### Operation

Changing Channels:

The COMMUNICATOR has 8 available channels. To change channels:

1. Press the button until the current channel number flashes on the LCD Screen.
  2. While the channel number is flashing:
    - Press the Up button to move to a higher channel.
    - Press the Down button to move to a lower channel.
    - The channel changes from 1 to 8, or from 8 to 1.
  3. Press the button to confirm the selected channel and return to the NORMAL mode.
- NOTE: Refer to the "Channel Table" section of this Owner's Manual for detailed frequency listings.

Monitor:

You can use the MONITOR feature to check for weak signals in the current channel.

1. Press the button 3 times to activate this function.
2. Press again the button to deactivate the function.



Using the Torch:  
Press and hold the Torch button to shine the torch. The torch works even when the unit is switched off.

Automatic Power Save Feature:  
After 6 seconds for the last operation, the PMR enters to the power saving mode automatically. The life of the batteries would be extended. The PMR is still able to receive transmission in this mode.

Low Battery Alert:  
When the batteries in the unit are low, an alert tone will be heard and red LED will light up once every 15 seconds. Replace new batteries immediately.

Channel Scan:  
CHANNEL SCAN performs searches for active signals in an endless loop from 1 to 8.

- Press and hold SCAN **S** button for 1 second to turn on scan function. The channel number on the LCD Screen changes rapidly until an active signal is detected.  
During CHANNEL SCAN mode.
  - Press and hold **PTT/C** button you can talk to others who use same channel.
  - Press the **PTT/C** button to change to CALL function and to send a CALL TONE on that active channel.
  - Press and hold SCAN **S** button again for 1 second to deactivate CHANNEL SCAN mode.
- When an active signal (one of 8 channels) is detected. CHANNEL SCAN pauses, keeping the active signal broadcasted.
- Press the **PTT/C** button to communicate through the active signal channel and CHANNEL SCAN is deactivated.
- When an active signal (one of 8 channels) is detected, but another channel is desired, press the Up **▲** or Down **▼** button to bypass the current channel and continue to search for another active channel.

Sending Call Tones  
You can use CALL TONES to alert the other when you are attempting to contact them. You can also use CALL TONES to signal the beginning or the end of a transmission.

- Press the **PTT/C** button twice shortly, the red TX LED indicator will light up and the CALL TONE continues for 3 seconds.
- Release the **PTT/C** button, your CALL TONES will transmit to nearby receivers set to the same channel.

Troubleshooting

SYMPTOM	SOLUTION
No power.	<ul style="list-style-type: none"><li>● Check batteries. Ensure that the batteries are installed properly.</li><li>● The batteries may be weak.</li><li>● Replace old batteries with three (3) new "AAA" alkaline batteries or Ni-MH rechargeable batteries.</li></ul>
Reception is weak.	<ul style="list-style-type: none"><li>● Press the Up <b>▲</b> button to increase VOLUME.</li><li>● The receiving signal may be weak and/or out of range.</li><li>● If this happens, use the MONITOR function.</li></ul>
Cannot change channels.	<ul style="list-style-type: none"><li>● To change channels, press the <b>1/0</b> button until the channel number flashes on the LCD Screen.</li><li>● Press the Up <b>▲</b> or Down <b>▼</b> buttons to change channels.</li><li>● Batteries may be weak.</li></ul>
Range is limited.	<ul style="list-style-type: none"><li>● BATTERIES may be weak.</li><li>● Replace with new batteries if there is low battery alert tone.</li><li>● The maximum range will vary depending on terrain and environment.</li><li>● Open fields provide the maximum range, while steel/concrete structures, heavy foliage and use in buildings and in vehicles may limit the range significantly.</li><li>● Wearing the radio close to the body, such as in a pocket or on a belt, will decrease range; change the location of the radio.</li></ul>
Sound distortion problems.	<ul style="list-style-type: none"><li>● If you are transmitting, speak in a normal tone of voice, 2 to 3 inches away from the MICROPHONE.</li><li>● If you are receiving, lower the volume to a comfortable level.</li><li>● Radios too close. Radios must be at least 5 feet apart; increase your distance.</li><li>● Radios too far apart. Obstacles interfere with transmission. Talk range is up to 5 Km in clear unobstructed conditions.</li></ul>

Specifications

Channels Available	22 Channels (CH1-14 FRS/ CH15-22 GMRS)
Output Power (TX)	0.5W
Battery Life	30 Hours (typical)
Range	About 5 Km
CHANNEL TABLE	
CHANNEL NUMBER	FREQUENCY (MHz)
1	462.5625
2	462.5875
3	462.6125
4	462.6375
5	462.6625
6	462.6875
7	462.7125
8	467.5625
9	467.5875
10	467.6125
11	467.6375
12	467.6625
13	467.6875
14	467.7125
15	462.5750
16	462.6250
17	462.6750
18	462.5500
19	462.6000
20	462.6500
21	462.7000
22	462.7250

NOTE: The maximum transmission range will vary depending on terrain and environment.

To Charge The COMMUNICATOR

The COMMUNICATOR units must be used with original Charger Pod and AC -DC Adaptor (optional).

\* AC -DC Adaptor: input 120 VAC 60Hz - Output 6V DC 200mA.

- Turn the unit OFF (Do not turn ON the unit during Battery Charge Mode).
- Install 3.6V "AAA" Ni-MH Rechargeable Battery Pack into the battery compartment of unit.
- Connect the lead of the AC-DC adaptor to the socket at the back of the charger pod (make sure the lead has been fully inserted into the jack with some force). Connect the AC-DC adaptor to the mains power supply.
- Place the unit into the Charger Base.
- The LED Indicators on the Charger Base will turn RED once electricity get connected.
- Unplug the Adaptor. Turn the unit ON.

NOTE: 1. LED Indicators on the charger base will NOT turn OFF automatically, except take out the unit from the charger base and disconnect the electricity.  
2. It takes approximately 6 hours to fully charge the battery pack if they are at their lowest level or takes around 14 hours to fully charge the new battery pack.  
3. In case LED Indicators on the Charger Base do not turn RED with units placed inside, please double check if units being put in proper position, or change battery pack and retry the recharge process.

WARNING: DO NOT attempt to charge any type of regular Alkaline batteries in this PMR. Only use the original AC-DC Adaptor with the supplied battery pack (optional).

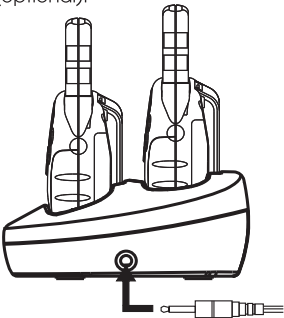

Notice:The FRS/GMRS service is only applied to the device.  
Warning:  
Changes or modifications to this unit not expressly approved by the party responsible for compliance will void the user's authority to operate the equipment. Any change to the equipment will void FCC grant.  
The equipment compliance with FCC radiation exposure limit set forth for uncontrolled environment