

# Canon



## *ivy*

Mini Photo Printer  
User Manual

SAFETY INFORMATION

Read Before Use .....P.2-3

OVERVIEW

Supplied Items.....P.4

Product Features .....P.4

GETTING STARTED

Charging .....P.5

Power ON / OFF .....P.6

Load Paper.....P.6-7

LED INDICATIONS ..... P.8

SPECIFICATIONS ..... P.9

ACCESSORY .....P.10

# SAFETY INFORMATION

## READ BEFORE USE

Please read the following instructions and safety precautions before using the Printer.

For regulatory and additional safety information, refer to the Regulation and Warranty Information sheet included in your printer package contents.

### **RMN: PP1003A**

Regulatory Model Identification Number is assigned for regulatory identification purpose.



### **WARNING**

Used to indicate a potentially hazardous situation which, if not avoided, could result in death or serious injury.

- Keep away from children and infants. Improper use of this product may cause suffocation or accident.
- Stop using the device immediately if it emits smoke or a strange smell, or otherwise behaves abnormally.
- Do not use the printer if the battery or product has swelled.
- Do not handle near Medical Electrical Equipment. Weak magnetism is emitted by this product. Do not stand near implanted electronic devices, such as a cardiac pacemaker. Please see your doctor if the printer does come close to such a device.



## CAUTION

Used to indicate the level of a hazard or damage which, if product is handled erroneously, may result in injury or property damage other than product faults.

- When operating in extreme weather, the device might not print. Let the printer temperature adjust to the recommended operating temperature of 59° to 90°F (15° to 32°C), before attempting to print again.
- When charging, please charge the device at the recommended temperature of 59° to 90°F (15° to 32°C).
- Use a soft dry cloth to clean the device. Do not clean with a damp cloth or volatile liquids such as paint thinner.
- Keep the top cover closed to avoid dust and other particles from entering the inside of the device.
- Keep the ventilation openings clear of any objects that could block them.
- If the device is not functioning properly, please contact the dealer you purchased this product from or Canon Service & Support at [www.usa.canon.com/support](http://www.usa.canon.com/support)
- Electromagnetic interference or electrostatic discharge may cause the device to malfunction or the memory to be lost or altered. Should this occur, use a pin, or similar item to press the [RESET] button at the bottom of the device.
- Do not use or leave the product under direct sunlight. Also avoid areas subject to rapid temperature changes, high humidity, dust and dirt.
- In areas with low humidity, the printer may build up a static electric charge. Take precautions before handling the printer.
- Keep the printer away from liquids or containers of liquids.
- Do not improperly dispose of the product as it may cause personal injury or harm. Please dispose of the product in accordance with local regulations.

## ABOUT BATTERY

- It is recommended that you fully charge the battery after use. For healthy battery maintenance, you must fully charge the battery at least once a year before storing product. If the product is not charged/used for an extended period of time, you may not be able to charge the built-in battery and the product may no longer power on.
- Disassembling the device may cause the battery leakage, explosion, damage or personal injury.
- Never expose the battery to high temperatures, direct heat, or dispose by incineration.
- When disposing of the battery, follow the regulations of the local government. For details, inquire your local authorities.

# OVERVIEW

## SUPPLIED ITEMS



Mini Photo Printer



USB Cable



Regulation and  
Warranty  
Information sheet



CANON ZINK®  
Photo Paper  
(10 sheets)

## PRODUCT FEATURES

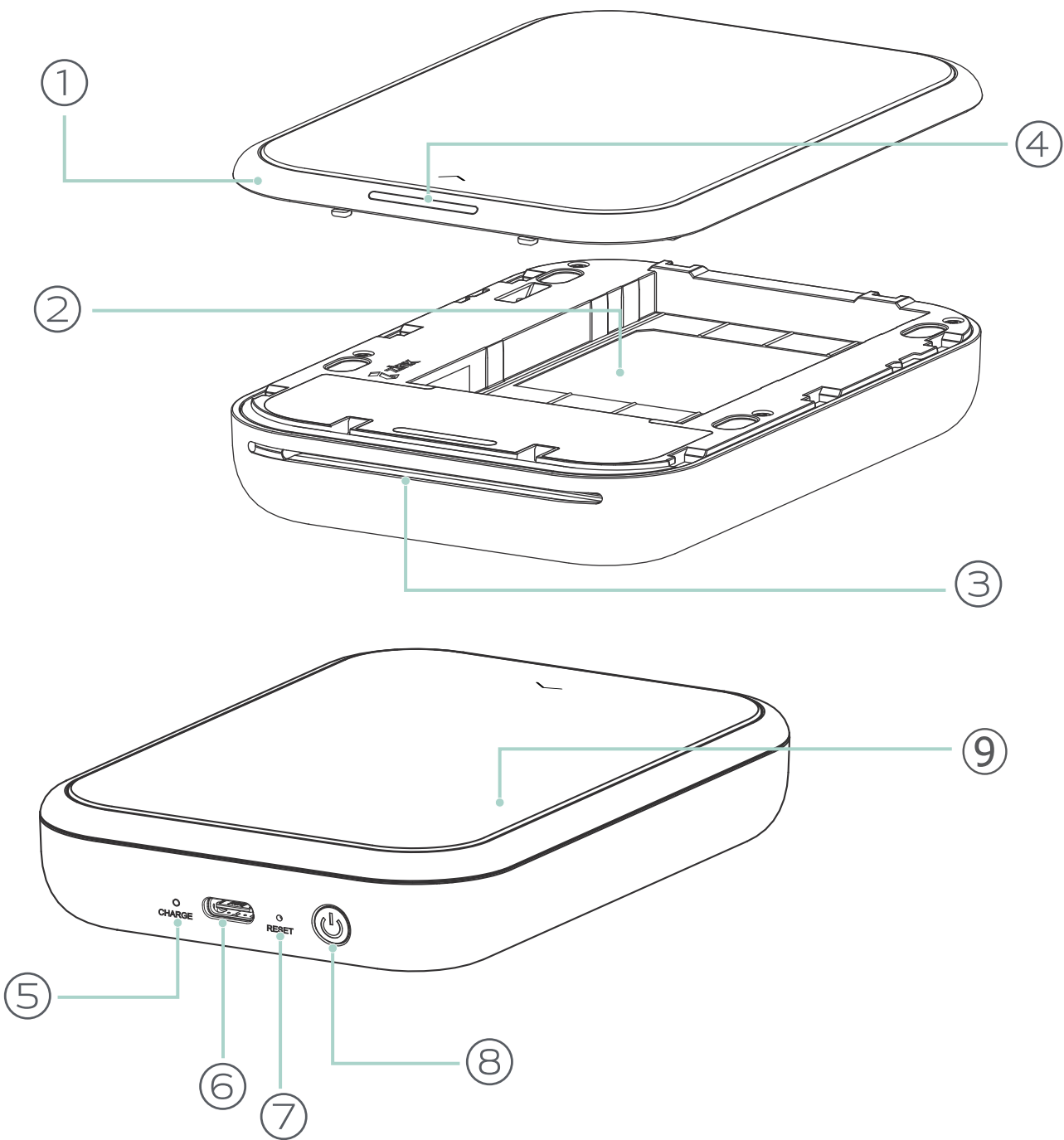

- ① Top cover

② Paper tray  
(Visible with top cover open)

③ Paper output slot

④ Status LED light

⑤ Charging LED light
- ⑥ USB port (For charging)

⑦ Reset button  
(To reset the device, press with a pin)

⑧ Power button

⑨ Detachable faceplate

## A) CHARGE

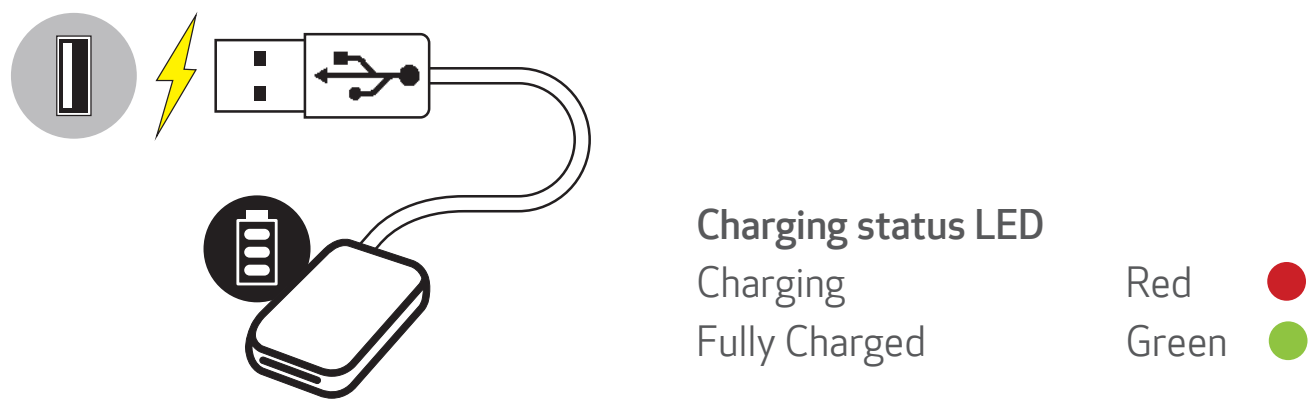

Printer uses a built-in battery. Before using the printer, fully charge the battery using the USB cable provided.

- 1 Insert the smaller end of the supplied USB cable into the Printer and the other end into a chargeable USB adapter.
- 2 The charging LED light will turn red to indicate charging.
- 3 Once fully charged, the charging LED will turn green.
  - Operating time may vary depending on the battery status, operational status and environment conditions.

**NOTE** Instructions or content are important and must be followed accordingly.



### About USB Cable

#### Handle the USB cable with care while charging

- Do not place any heavy objects on top of the cable.
- Do not place the USB cable near heat.
- Do not scratch, damage, twist or pull hard on the cable.
- Do not plug or unplug the cable with wet hands.
- Avoid too high/too low temperature or humid condition.
- Please unplug the USB cable from power source after charging.
- Please use supplied USB cable for charging.

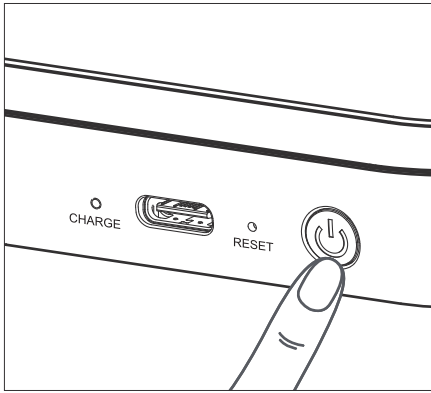
## B) POWER ON / OFF



- ① Press and hold the Power button (  ) Charging LED light will flash 2 times in green to indicate power-on.
- ② When the status LED indicator turns to a white , the device is ready to use.
- ③ Press and hold the Power button (  ) to turn off the device.

### AUTO POWER OFF

- The device will power off automatically when idle for 3 minutes (default).
- The user can change the time (3 minutes/5 minutes/10 minutes) in the app.

## C) LOAD PAPER

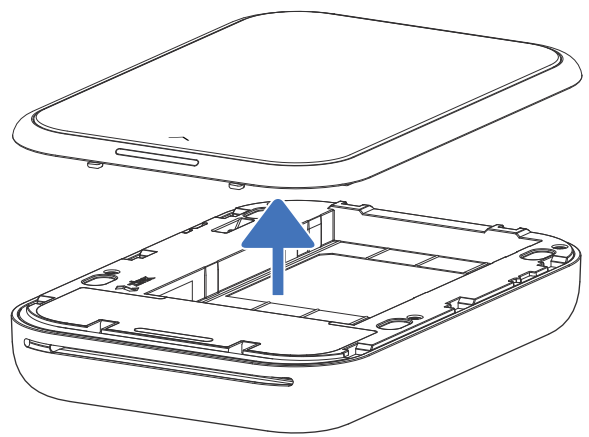
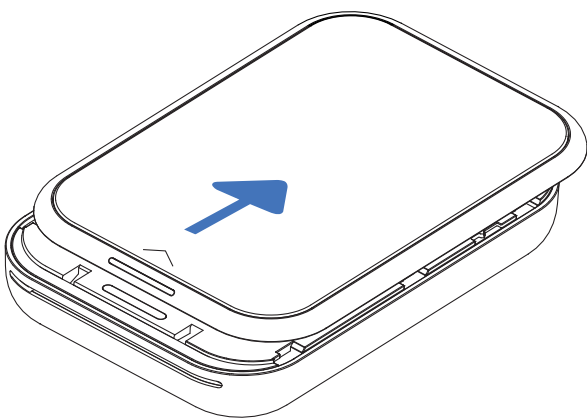

- ① Remove the top cover by sliding it forward in the direction of the arrow.
- ② Open a single pouch of photo paper (10 sheets + blue SMART SHEET®).

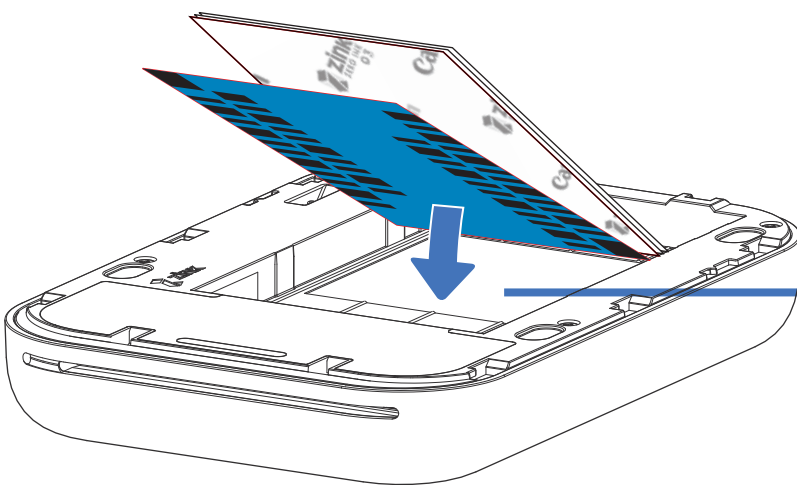

Blue SMART SHEET® on  
bottom with photo  
papers on top.  
All logos facing down.

- ③ Place all 10 photo paper sheets and the one blue SMART SHEET® into the photo paper compartment.
  - Stack the photo paper on top of the blue SMART SHEET®, making sure the bar code and the photo paper logos are facing down.
- ④ Place the top cover back onto the printer. It should click into place when closed properly.
  - The blue SMART SHEET® will be sent through the printer automatically before the first print.





## NOTE

Instructions or content are important and must be followed accordingly.

## WHEN USING PAPER















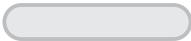

- Only load 10 ZINK® photo paper sheets and 1 blue SMART SHEET®. Do not load more as it can result in paper jams or printing errors.
- For optimal print results, use ZINK® photo paper for Canon IVY printers.
  - You may purchase additional photo papers within the Canon Mini Print App by tapping "Buy Paper" in the main menu.
- If there is a paper jam, simply turn the printer OFF and ON to automatically clear the paper jam. Don't try to pull the paper out.
- While the printer is printing, don't pull or tug on the photo paper.
- Handle photo paper carefully to avoid damage or bending.
- Keep the paper clean when loading. If paper is dirty or damaged it may result in a paper or print error.
- Don't open a new pouch of paper until you are ready to load into your printer.
- Don't expose photo paper to direct sunlight or moisture.
- Don't leave your photo paper in an area where the temperature or humidity is out of the suggested conditions indicated on the pouch. It may reduce the quality of the printed photo.

## ABOUT THE BLUE SMART SHEET®

- Each pouch of photo paper contains 10 sheets of photo paper and 1 blue SMART SHEET®.
- Load the blue SMART SHEET® and photo paper from within the same pouch for optimal print quality. Each blue SMART SHEET® is specifically tuned for the pouch of paper it is contained in.
- The blue SMART SHEET® will be sent through the printer automatically before the first print to clean and the printer and optimize print quality for that specific paper pouch (10 sheets).
- Keep the blue SMART SHEET® and only discard after you have printed all 10 sheets of photo paper in the pouch. If print quality is not as expected, you can reuse the blue SMART SHEET® if the paper is still from the same pouch. Simply slide the blue SMART SHEET® with its barcode-side down underneath the remaining photo paper.
- Using a blue SMART SHEET® from another pouch may result in reduced print quality.



# LED INDICATOR

Status	Mode LED	Status LED
Power On	Press and hold power button	 >  WhiteWhite (Flashing)
Standby	Device is NOT connected with APP	 White (Flashing)
	Device is connected with APP	 White
Power Off	Press and hold power button	 Off
Processing Blue SMART SHEET®	When the device is loading blue SMART SHEET®	 Yellow >White>Magenta>White>Cyan>White (Looping)
Printing Photo	When the device is printing a photo	 Yellow >White>Magenta>White>Cyan>White (Looping)
Blue SMART SHEET® Error	When the device detects no-Canon blue SMART SHEET® is inserted, or other blue SMART SHEET® error	 Blue (Flashing)
Get Ready for Printing	Preparing for printing	 White (Glowing)
Paper Jam / Cover Open	When there is a paper jammed or the printer cover is opened	 Red (Flashing)
No paper	When print request is initiated and no paper in tray	 Red (Flashing)
Firmware Upgrading	When the device is updating firmware	 White (Glowing)
Low Battery	When battery level down to 20% – Device is Not connected with APP	 White>Red (Flashing)
	– Device is connected with APP	 White>Red
Temperature High	When device temperature is too high	 Red (Until temperature returns to normal)
Printer Head Cooling	Checking the printer head temperature and letting it cool down before printing	 Cyan (Glowing)
Temperature Low	When device temperature is too low	 Cyan (Until temperature returns to normal)

# SPECIFICATION

Power Source	Internal rechargeable battery 500 mAh Li-Polymer 7.4 V
Charging Speed	Approximately 45 minutes (Full Charge)
Dimension	4.7"(L) x 3.3" (W) x 0.8" (H) / 120 mm (L) x 84 mm (W) x 21.5 mm (H)
Weight	6 oz (177 g)
Connectivity	Bluetooth® 5.0
Compatible OS	iOS 12.0 or above & Android 6.0 or above
Print Technology	ZINK®
Print Resolution	313 x 512 dpi (dots per inch)
Borderless Printing	Yes
Compatible Paper	Canon ZINK® Photo Paper: ZP-2030-20 (20 sheets) ZP-2030-50 (50 sheets) ZP-2030-2C-20 (20 sheets) 2" x 3" / Peel-and-stick back
Paper Capacity	Up to 10 sheets of ZINK® photo paper + 1 blue SMART SHEET®
Memory	512Mb
Environmental Parameters	<ul style="list-style-type: none"><li>• Recommended Printer Operating, Charging, and Storage Temperature: 59° to 90° F (15° to 32° C)</li><li>• Recommended Printer Operating, Charging, and Storage Humidity: 40-55% RH</li><li>• Operating Temperature: 41° to 104°F (5° to 40°C)</li><li>• Operating Humidity: &lt;70% RH</li></ul>
Automatic Power-off	3 minutes / 5 minutes / 10 minutes (selectable in-app)
Power Adapter	Output power : 5V  2.25A

\* All specifications are subject to change without notice

\* The IVY Mini Photo Printer is designed to be charged with a USB Charging Adaptor. If it is charged using a laptop USB port, there may not be sufficient electrical power to charge the IVY Mini Photo Printer.

## SUPPLIED ITEMS

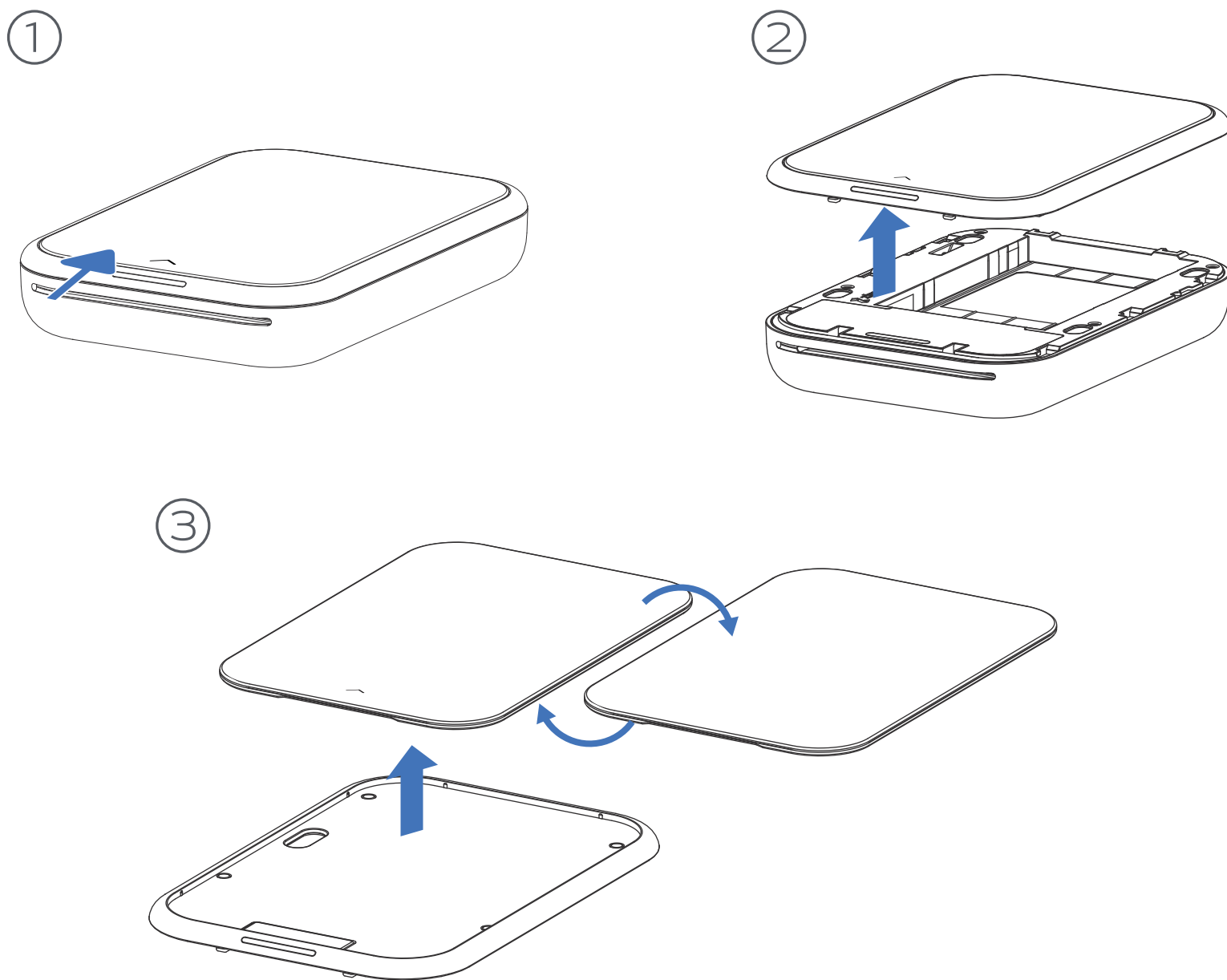

The device has a detachable faceplate. Gently lift up the detachable faceplate to remove it.

Customize the device by changing the faceplate. \*

\* Additional faceplates are sold separately.



FCC REGULATIONS

This device complies with Part 15 of the FCC Rules. Operation is subject to the following two conditions:  
(1) this device may not cause harmful interference, and  
(2) this device must accept any interference received, including interference that may cause undesired operation.

Canon U.S.A., Inc. Canon is a registered trademark of Canon Inc. in the United States and may be a registered trademark, or trademark, in other countries. IVY is a trademark of Canon U.S.A., Inc. in the United States. SMART SHEET, the ZINK Technology and ZINK Trademarks are owned by ZINK Holdings LLC. Used under license. Apple, the Apple logo, iPad, iPad Air, iPad Pro, and iPhone are trademarks of Apple Inc., registered in the United States and other countries. App Store is a service mark of Apple Inc. iOS is a trademark or registered trademark of Cisco in the United States and other countries and is used under license. Android, Google Play and the Google Play logo are trademarks of Google LLC. Bluetooth is a registered trademark of Bluetooth SIG. Wi-Fi is a registered trademark of the Wi-Fi Alliance. All other third-party product names, brand names and logos are trademarks of their respective owners.

BATTERY RECYCLE

The lithium ion/polymer battery is recyclable.  
Please call 1-800-8-BATTERY for information on how to recycle this battery.

