

**PATRIONICS**

CRC#:4384376

For Wii™

# Remote & Wireless Controller Grip Pack

Instruction Manual

Wii™, Wii Remote™ and MotionPlus™ are trademarks of Nintendo, Inc.  
This product is not manufactured, sponsored, licensed,  
endorsed or distributed by Nintendo, Inc.

## Precautions

Before using this product, read this manual carefully and retain it for future reference. Also read the instruction for the Wii™ System.

- Do not allow children to play with this product.
- Do not throw or drop the products, or expose them to strong physical shock.
- Do not expose the product to high temperatures, high humidity or direct sunlight. Only use the product under a normal indoor environment.
- Don't drop device and dispose of it in fire.
- For external cleaning, use a soft, clean, dry cloth only, use of detergent may damage the cabinet finish and leak inside.
- Failure to follow these directions may damage the product.

### NOTE:

THE MANUFACTURER IS NOT RESPONSIBLE FOR ANY RADIO OR TV INTERFERENCE CAUSED BY UNAUTHORIZED MODIFICATIONS TO THIS EQUIPMENT. SUCH MODIFICATIONS COULD VOID THE USER AUTHORITY TO OPERATE THE EQUIPMENT

## Features

### Remote:

- Compatible with Wii™ console.
- Fully functional trigger, buttons and motion sensitivity for complete gaming control.
- Requires two AA batteries (not included).
- Built-in MotionPlus™.

### Wireless Controller Grip:

- Fully compatible with Wii Remote™ and Console.
- Fully functional buttons, joystick and motion sensitivity.
- Requires two AAA batteries (not included).

## REMOTE FRONT VIEW

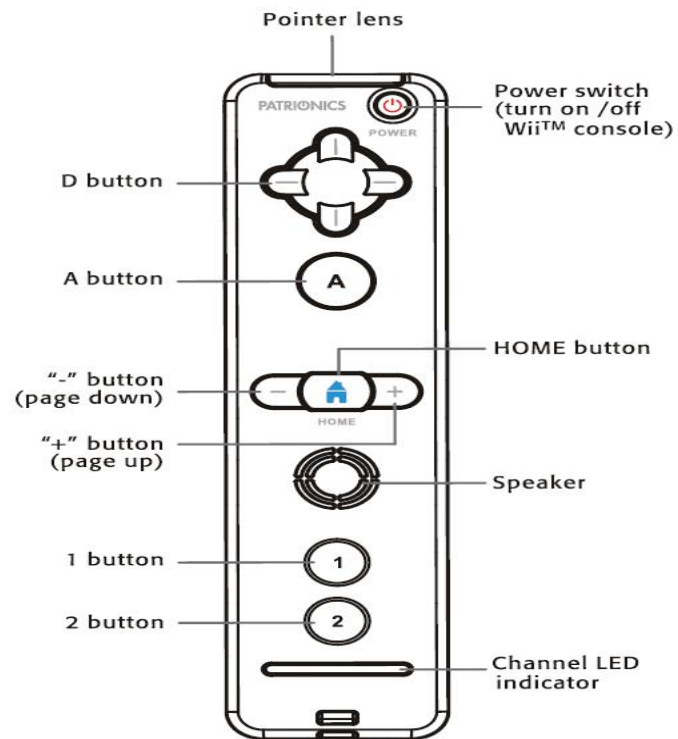

## REMOTE BACK VIEW

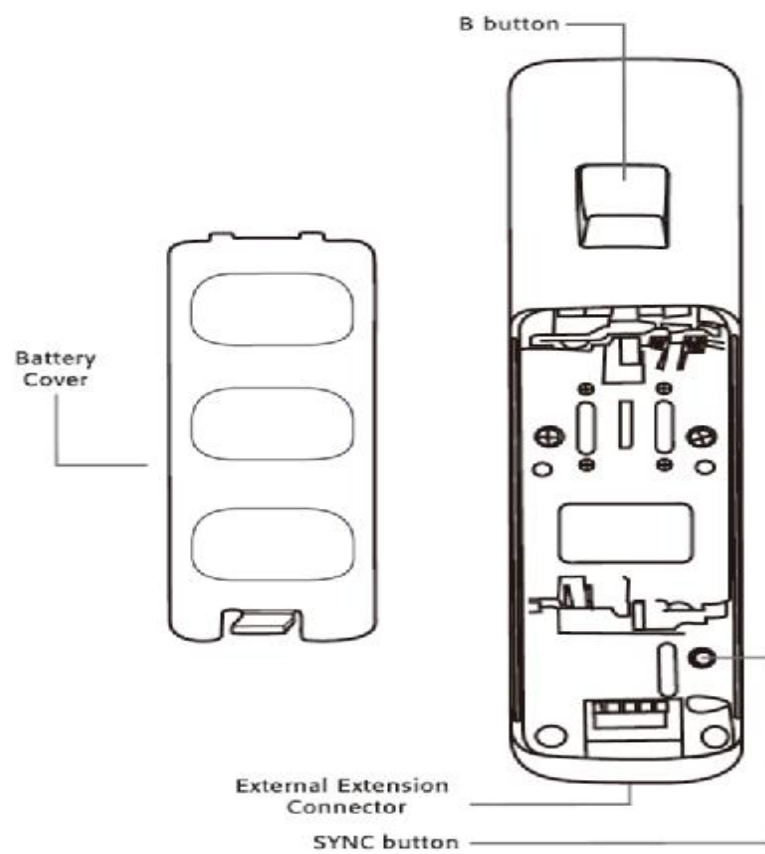

## WIRELESS CONTROLLER GRIP

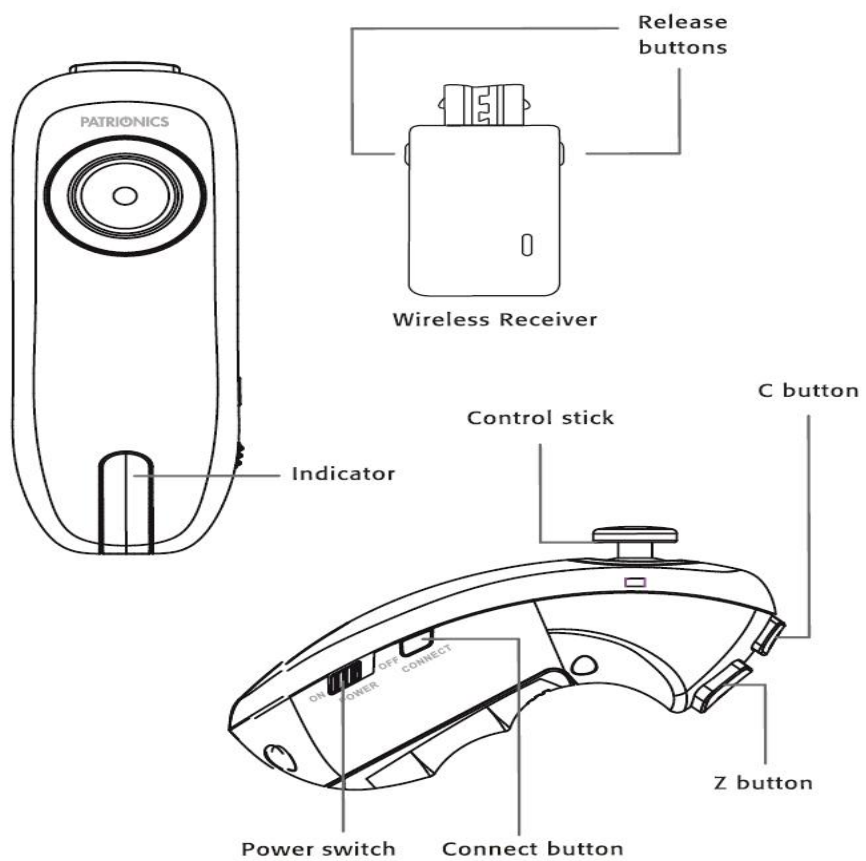

## HOW TO USE WIRELESS CONTROLLER GRIP PACK

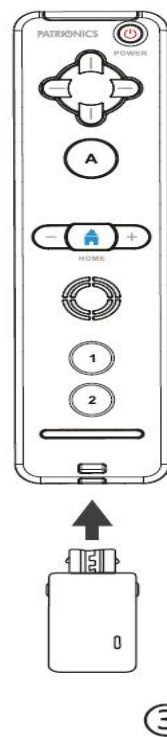
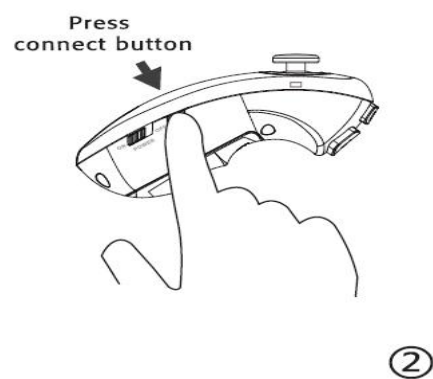
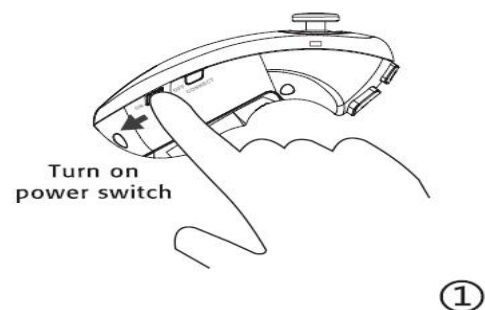

## HOW TO USE

1. Correctly connect Wii™ console with TV set, and switch on.
2. Place two AA batteries into battery compartment on Remote.
3. Code match for Remote and Wii™ console: First press SYNC button on console, then press SYNC button inside the battery compartment of Remote.
4. After console and the Remote are connected successfully, the channel indicator on Remote will be turned on. If more Remote Controllers are used simultaneously, please repeat this process.
5. Place two AAA batteries into battery compartment on Wireless Controller Grip.
6. Turn on Wireless Controller Grip's Power switch, the indicator on Wireless Controller Grip will light on with slow flashing.
7. Press CONNECT button on Wireless Controller Grip. Now insert the Receiver into Remote's External Extension Connector. After the connection is completed, both indicators on Receiver and Wireless Controller Grip will be steadily ON. Please repeat this operation if it fails to connect.
8. Place game disc of Wii™ into console and enter game.
9. When Wireless Controller Grip working voltage is lower, the indicator on Wireless Controller Grip will quickly flash, please change batteries.

This device complies with part 15 of the FCC Rules. Operation is subject to the following two conditions: (1) This device may not cause harmful interference, and (2) this device must accept any interference received, including interference that may cause undesired operation.

Distributed by AAFES  
Dallas, Texas

Printed in China



#### STATEMENT

1. This device complies with Part 15 of the FCC Rules. Operation is subject to the following two conditions:
  - (1) This device may not cause harmful interference.
  - (2) This device must accept any interference received, including interference that may cause undesired operation.
2. Changes or modifications not expressly approved by the party responsible for compliance could void the user's authority to operate the equipment.

**NOTE:** This equipment has been tested and found to comply with the limits for a Class B digital device, pursuant to Part 15 of the FCC Rules. These limits are designed to provide reasonable protection against harmful interference in a residential installation.

This equipment generates uses and can radiate radio frequency energy and, if not installed and used in accordance with the instructions, may cause harmful interference to radio communications. However, there is no guarantee that interference will not occur in a particular installation. If this equipment does cause harmful interference to radio or television reception, which can be determined by turning the equipment off and on, the user is encouraged to try to correct the interference by one or more of the following measures:

Reorient or relocate the receiving antenna.

Increase the separation between the equipment and receiver.

Connect the equipment into an outlet on a circuit different from that to which the receiver is connected.

Consult the dealer or an experienced radio/TV technician for help.

**RF warning statement:**

The device has been evaluated to meet general RF exposure requirement. The device can be used in portable exposure condition without restriction.