

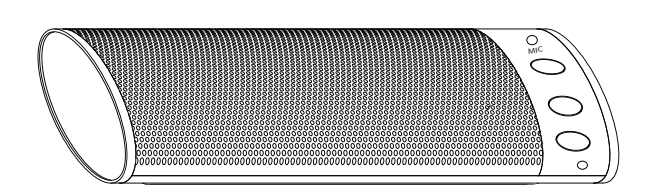

Included

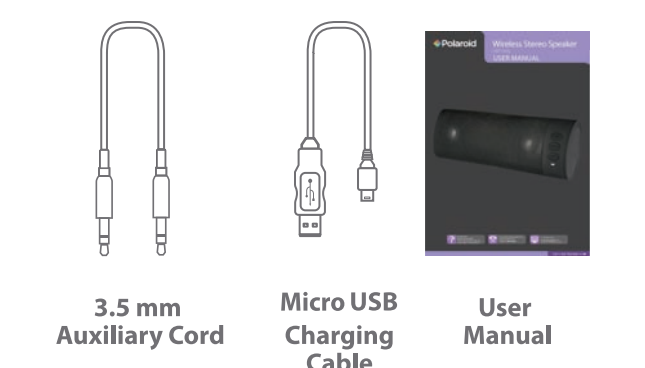

Stereo Bluetooth Speaker

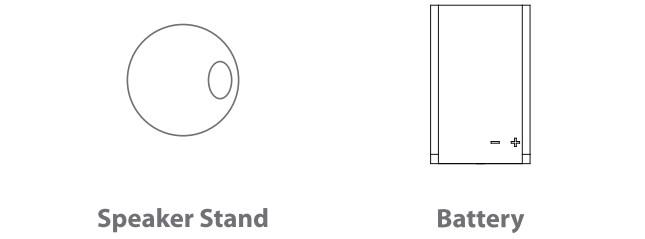

Inserting the Speaker Stand

To stand the speaker, slide the speaker stand attachment into the slot located on the back of the speaker.

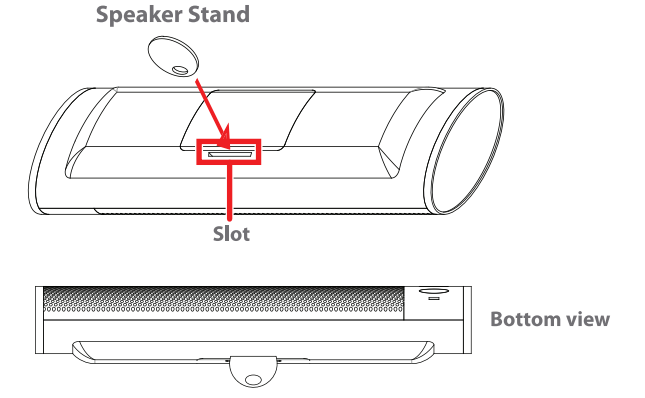

Location of controls

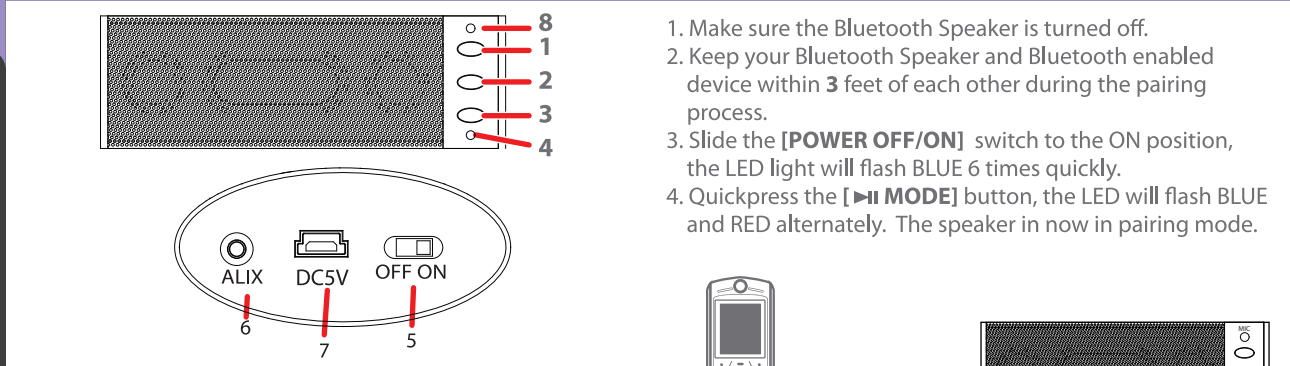

1. [VOL+] button
Quickpress = Next song
Press & Hold = Volume up
2. [MODE] button
Quickpress = Play/Pause/Answer Call/End Call
3. [VOL-] button
Quickpress = Previous song
Press & Hold = Volume down
4. LED indicator light
5. [POWER ON/OFF] switch
6. 3.5 mm Auxiliary Cord input
7. DCSV port / Mini USB charging port
8. Microphone

Inserting the rechargeable battery

1. Open the battery door located on the back of the speaker.
2. Insert the included battery into the compartment. Be sure to align the metal contacts of the battery with the metal contacts inside the battery compartment.
3. Close the battery door.

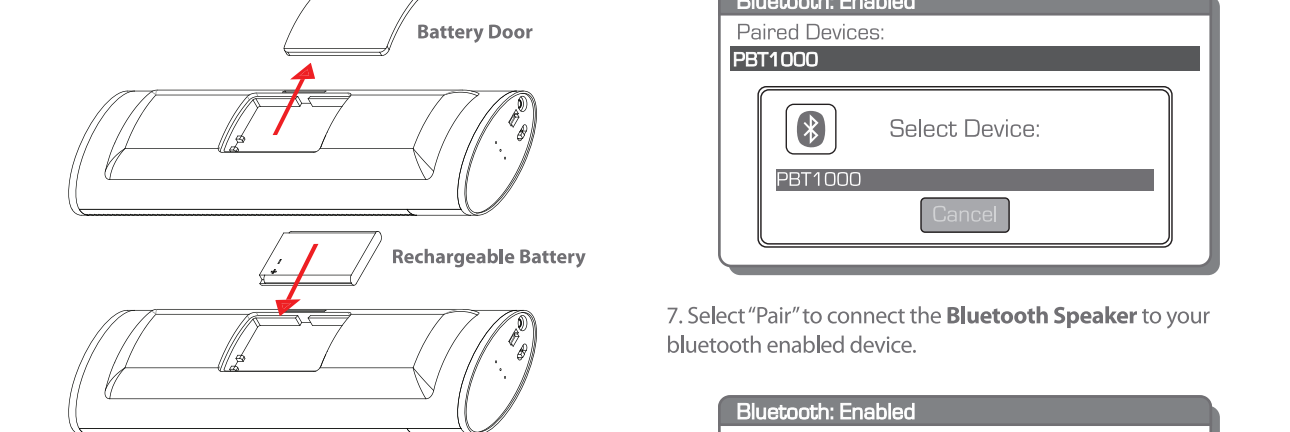

Charging the Bluetooth Speaker

1. Connect the small end of the Micro USB charging cord into the DCSV port on the side of the speaker.
2. Connect the other end of the Micro USB cable to your computer's USB port.
3. The RED LED indicator light turns on.
4. The RED LED indicator light shuts off when the speaker is fully charged (approximately 4 hours).

When the battery is running low, the RED indicator light turns on.

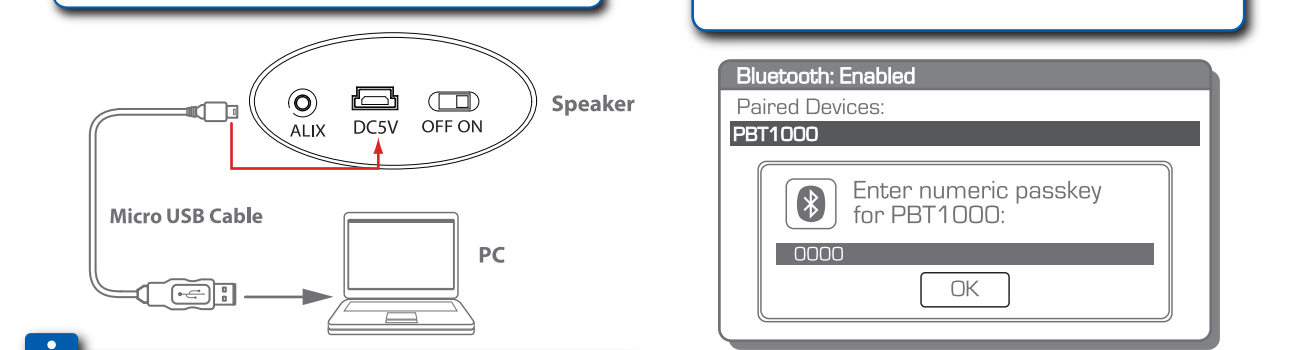

Make sure you charge your speaker for 8 hours before using it for the first time. You may use the Bluetooth speaker while charging.

8. Your Bluetooth enabled device will confirm that the pairing was completed, and prompt you to accept the connection. Please respond **YES** to connect the **Bluetooth Speaker** to your Bluetooth enabled device. If the pairing was successful, the **Bluetooth Speaker's** indicator light will begin flashing blue every five seconds.

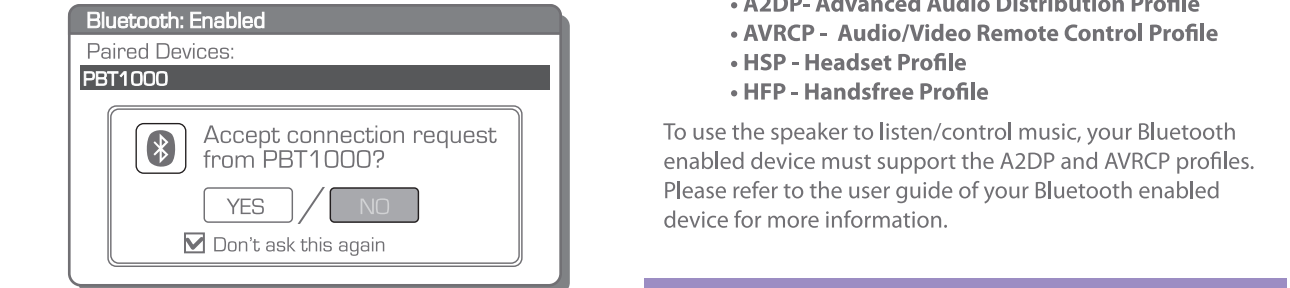

9. When attempting to reconnect the **Bluetooth Speaker** to your Bluetooth enabled device, you may see the message below, and your Bluetooth device will prompt you to accept the connection request to the PBT1000 speaker, and an option not to ask this again. Please accept the connection, and if you select "Don't ask this again", your Bluetooth device will automatically accept future connection requests from your **Bluetooth Speaker**.

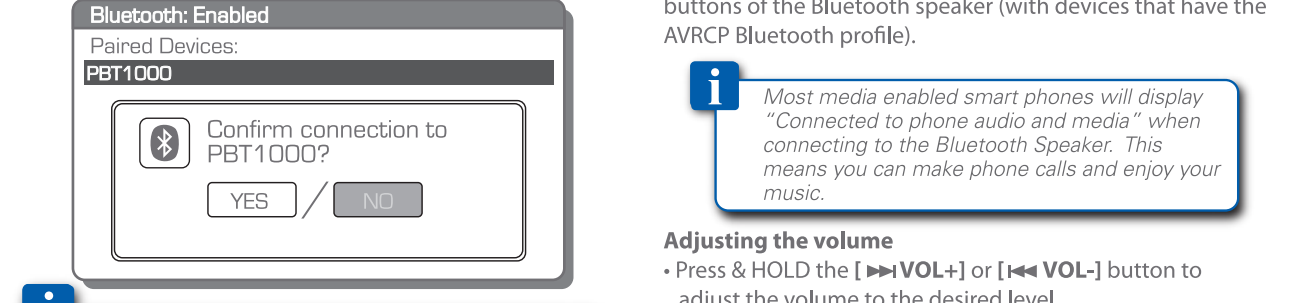

The screenshots above are typical of many Bluetooth enabled devices in the market today, and are used to assist in the explanation of the pairing process. Your Bluetooth enabled device's interface and interaction with the Bluetooth Speaker may slightly differ from the illustrations above.

Using your Bluetooth Speaker

- Powering ON/OFF**
- To turn **ON**, slide the [POWER ON/OFF] switch to the ON position, the LED flashes BLUE 6 times quickly then once every few seconds.
 - To turn **OFF**, slide the [POWER ON/OFF] switch to the OFF position, the RED LED illuminates and the speaker will power OFF.

- Answering/Ending a call**
- To answer a call quickpress the [MODE] button.
 - To end a call quickpress the [MODE] button.

- Adjusting the volume**
- Press & HOLD the [VOL+] or [VOL-] button to adjust the volume to the desired level.
 - A beep will be heard when maximum volume is reached.

NOTE: You may also adjust the volume from your mobile phone's volume control.

- To make a call**
- Dial the number and press the send button on your mobile phone, the call is automatically transferred to the headset.

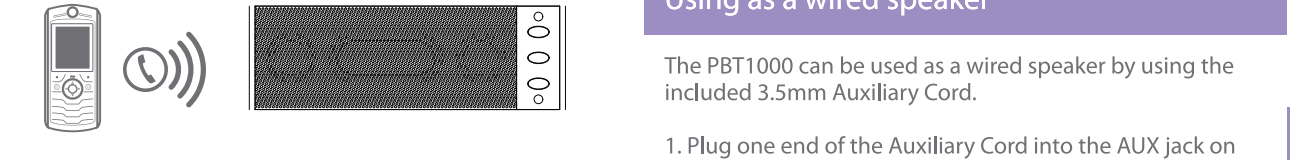

- Redialing the last number called (With devices that have AVRCP Bluetooth profile)**
- Quick press the [MODE] button twice. The last number called will be redialed.

- Rejecting calls**
- To reject an incoming call, longpress the [MODE] button for 2 seconds.

Stereo Bluetooth

This speaker allows you to listen to (in full stereo) and control* the music on your Bluetooth enabled device with the following Bluetooth profiles:

- **A2DP - Advanced Audio Distribution Profile**
- **AVRCP - Audio/Video Remote Control Profile**
- **HSP - Headset Profile**
- **HFP - Handsfree Profile**

To use the speaker to listen/control music, your Bluetooth enabled device must support the A2DP and AVRCP profiles. Please refer to the user guide of your Bluetooth enabled device for more information.

Playing Music

To enjoy wireless music on your Bluetooth Speaker, make sure you are connected to a Bluetooth enabled device. Once connected you can press **PLAY** on your Bluetooth device or you can press the [MODE] button on the PBT1000 Bluetooth Speaker. Once playback has begun, you can control the music or answer phone calls from the control buttons of the Bluetooth speaker (with devices that have the AVRCP Bluetooth profile).

Most media enabled smart phones will display "Connected to phone audio and media" when connecting to the Bluetooth Speaker. This means you can make phone calls and enjoy your music.

- Adjusting the volume**
- Press & HOLD the [VOL+] or [VOL-] button to adjust the volume to the desired level.

You may also adjust the volume from your mobile phone's volume control.

Play/Pause*

Press the [MODE] button to pause the music. To resume music playback, press the [MODE] button again.

- Skipping Songs* (With devices that have AVRCP Bluetooth profile)**
- Quickpress the [VOL+] to go to the next song
Quickpress the [VOL-] to go to the previous song.

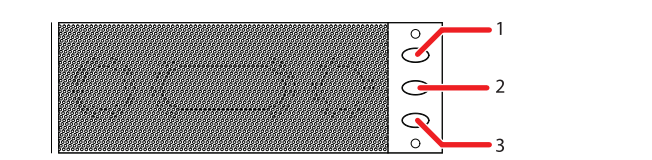

1. [VOL+] button
Quickpress = Next song
Press & Hold = Volume up
2. [MODE] button
Quickpress = Play/Pause/Answer Call/End Call
3. [VOL-] button
Quickpress = previous song
Press & Hold = volume down

Using as a wired speaker

The PBT1000 can be used as a wired speaker by using the included 3.5mm Auxiliary Cord.

1. Plug one end of the Auxiliary Cord into the AUX jack on the side of the speaker.
2. Plug the other end of the Auxiliary Cord into the headphone jack of any media device which has a 3.5mm headphone jack (this is standard headphone-out-jack).
3. Use your media device's music controls to control the music. When using the Auxiliary Cord the speaker buttons will not function.

FCC and telephone company information

*The Emerson Bluetooth Speaker is compatible with any brand of Bluetooth-enabled phone or music device that supports Advanced Audio Distribution Profile (A2DP) and Audio Video Remote Control Profile (AVRCP).

In order for Bluetooth devices to communicate with one another properly, they must utilize the same Bluetooth profile. To determine the profiles supported by your device (mobile phone, gaming console, computer or mp3 player), please refer to the device's user guide.

Certain Bluetooth features including those listed may not be supported by all compatible Bluetooth-enabled devices, and/or the functionality of such features may be limited in certain devices.

Troubleshooting tips

I can pair the Bluetooth Speaker with my Bluetooth device, but I cannot hear any music?

- Make sure your Bluetooth device supports A2DP profile.
- Turn up the volume on your Bluetooth device.

I cannot get the Bluetooth Speaker into Pairing

- Make sure the **Bluetooth Speaker** is turned OFF before beginning the pairing process.
- Slide the [Power ON/OFF] switch to the ON position, wait for the LED to flash BLUE 6 times quickly then quickpress the [MODE] button. The RED and BLUE lights will flash alternately, this will signal that the Bluetooth Speaker is in **Pairing Mode**, and ready to connect to your Bluetooth device.

My Bluetooth Device is not able to pair with the Bluetooth Speaker.

- Make sure the [Power ON/OFF] is switched to the OFF position before beginning the pairing process.
- Slide the [Power ON/OFF] switch to the ON position.
- Keep your **Bluetooth Speaker** and Bluetooth enabled device within 3 feet of each other during the pairing process.
- Check that YOUR device's Bluetooth feature is turned **ON**.
- Try repeating the pairing process, see "Pairing the Speaker with a Bluetooth enabled device".

Safety information

- Observe all signs in the designated areas where some electronic devices or RF radio products are required to be switched off. These could include airplanes, hospitals, blasting areas, and potentially explosive atmospheres.

Drive Safe

Driving while talking on your mobile phone is dangerous, and illegal in many states.

Although this device enables conversations, it is still dangerous to drive and use a mobile phone at the same time. We recommend pulling over before making or answering calls, especially during adverse driving conditions. Please use your mobile phone, and our product responsibly while driving!

Warranty information (Cont.)

The shipping address of the authorized service center is:
AIT, Inc.
ATTN: Customer Service (2nd Floor)
No. 8 Fengyi Road, Dakan Village, Huangjiang, DongGuan, China
IN NO EVENT WILL AIT, ITS MANUFACTURERS, DISTRIBUTORS OR PLR IP HOLDINGS, LLC BE LIABLE FOR ANY INCIDENTAL, DIRECT, INDIRECT, SPECIAL, PUNITIVE OR CONSEQUENTIAL DAMAGES (SUCH AS, BUT NOT LIMITED TO, DAMAGES FOR LOSS OF PROFITS, BUSINESS, SAVINGS, DATA OR RECORDS) RELATED TO THIS PRODUCT, EXCEPT AS STATED HEREIN. NO OTHER WARRANTIES SHALL APPLY.
Should you have any questions or problems concerning this product, please contact our customer service department at:
Customer Support:
☎ 86-769-89029933
✉ acc@qishenglong.com
Monday - Thursday: 9AM - 5PM (EST)
Friday: 9AM - 3PM (EST)

- Re-orient or relocate the receiving antenna.
- Increase the separation between the equipment and receiver.
- Connect the equipment into an outlet on a circuit different from that to which the receiver is connected.
- Consult the dealer or an experienced radio/TV technician for help.

Do not attempt to repair or modify this equipment. Warning: Changes or modifications to this equipment not expressly approved by the party responsible for compliance could void the user's authority to operate the equipment.
*This device complies with Part 15 of the FCC Rules. Operation is subject to the following two conditions:

- (1) this device may not cause harmful interference, and
- (2) this device must accept any interference received, including interference that may cause undesired operation."

Shielded USB cables must be used with this unit to ensure compliance with the Class B FCC limits.

PLR IP Holdings, LLC, its licensees and affiliates, fully support all electronic waste initiatives. As responsible stewards of the environment, and to avoid violating established laws, you should properly dispose of this product in compliance with all applicable regulations, directives or other governance in the area where you reside. Please check with local authorities or the retailer where you purchased this product to determine a location where you can appropriately dispose of the product.

FCC Radiation Exposure Statement
This equipment complies with FCC radiation exposure limits set forth for an uncontrolled environment. This equipment should be installed and operated with minimum distance 20cm between the radiator & your body

If your electronic device has internal memory on which personal or other confidential data may be stored, you may want to perform a data sanitization process before you dispose of your device to assure another party cannot access your personal data. Data sanitization varies by the type of product and its software, and you may want to research the best sanitization process for your device before disposal. You may also check with your local recycling facility to determine their data sanitization procedures during the recycling process.

Warranty information

This Product as supplied and distributed new by AIT, Inc. ("AIT") to the original consumer purchaser is warranted by AIT against defects in material and workmanship for a period of one year from your date of purchase ("Warranty").
In the unlikely event that this product is defective, or does not perform properly, you may within one year from your original date of purchase return it to the authorized service center for repair or exchange.

TO OBTAIN WARRANTY SERVICE:

- Provide proof of the date of purchase within the package (Dated bill of sale)
- Prepay all shipping costs to the authorized service center, and remember to insure your return.
- Include a return shipping address (no P.O. Boxes), a telephone contact number, and the defective unit within the package.
- Describe the defect or reason you are returning the product. Your product will be repaired or replaced, at our option, for the same or similar model of equal value if examination by the service center determines this product is defective. Products received damaged as a result of shipping, will require you to file a claim with the carrier.

FRONT

BACK