

Photographs of EUT>

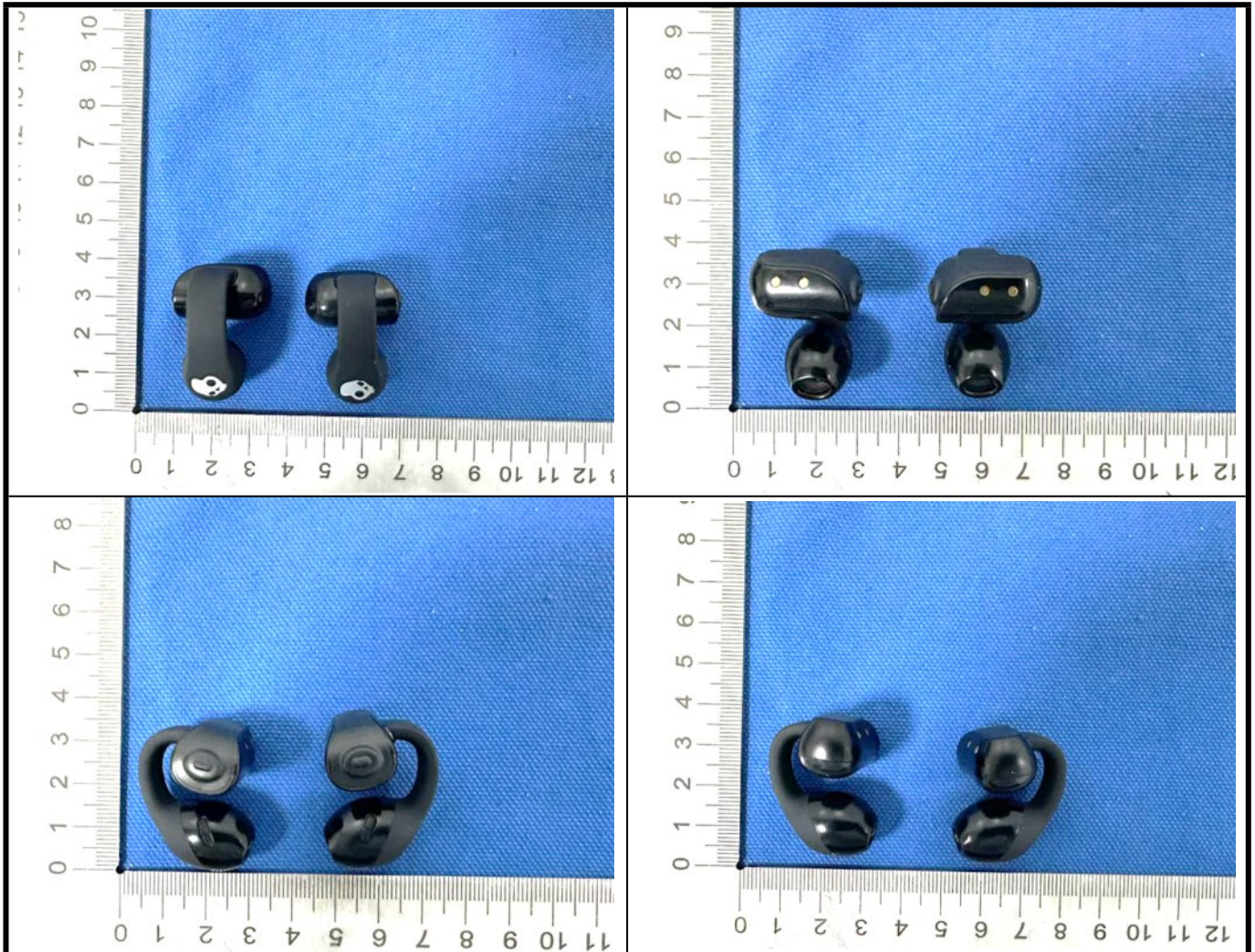

<Antenna Location>

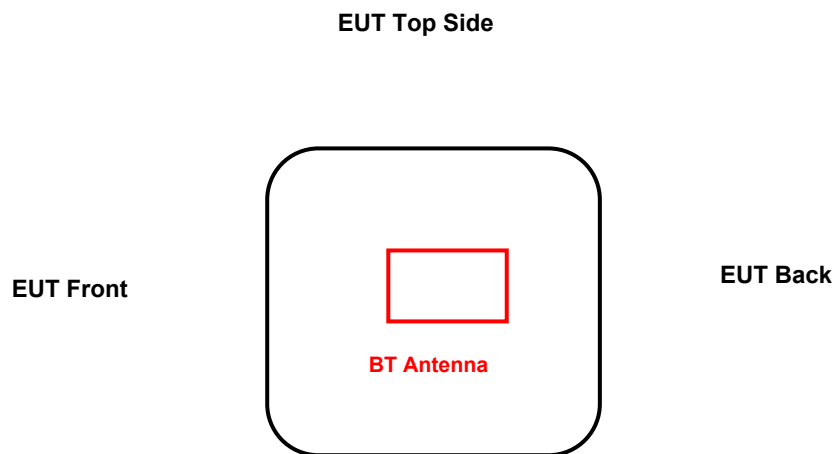

EUT Bottom Side  
<EUT Back View>

The antenna is carved into the ear shell with radium, and the left and right ear shell antennas carved with radium are as follows:

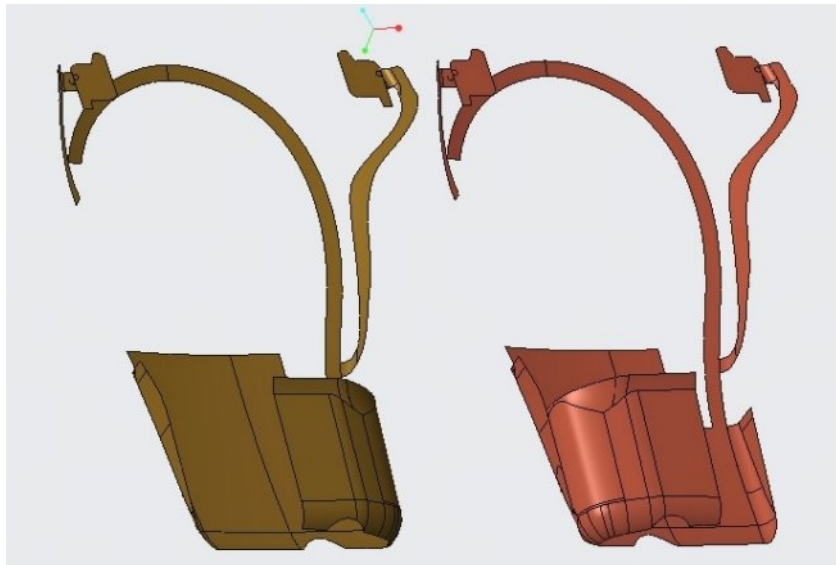

<Photographs of SAR Setup>



Front Face of Left Earphone with 0 cm Gap



Rear Face of Left Earphone with 0 cm Gap



Top Side of Left Earphone with 0 cm Gap



Bottom Side of Left Earphone with 0 cm Gap



Front of Left Earphone with 0 cm Gap



Back of Left Earphone with 0 cm Gap





Front Face of Right Earphone with 0 cm Gap



Rear Face of Right Earphone with 0 cm Gap



Top Side of Right Earphone with 0 cm Gap



Bottom Side of Right Earphone with 0 cm Gap



Front of Right Earphone with 0 cm Gap



Back of Right Earphone with 0 cm Gap