

## CONTENT

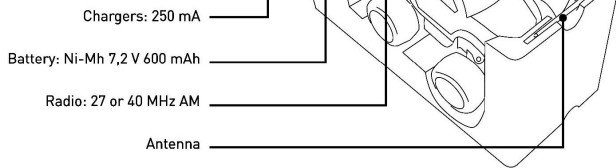

## GETTING STARTED

## 1. CHARGING BATTERIES

- a) Connect 220 V charger to the battery contacts and connect to a 220 V power outlet.  
b) For the best durability battery should be discharged before charging.  
It takes about 2,5 hours to charge the battery to 100%.

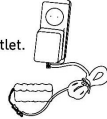

⚠ **Never leave unattended when charging the battery.**

⚠ **We recommend that you use our seftybag when You loading.** Item No. XP-103362

## 1. Mont the Antenna

Screw the antenna in the top of radio.



## 2. Installing the Radio Battery

Put in 2 x AA battery against accession. Mount the cover.



## 3. Installing Battery

Install the supplied battery. Make sure the correct polarity ports.

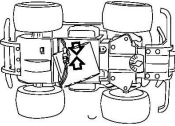

## 4. Installing Battery

Screw the cover. Turn the ON / OFF button to ON.

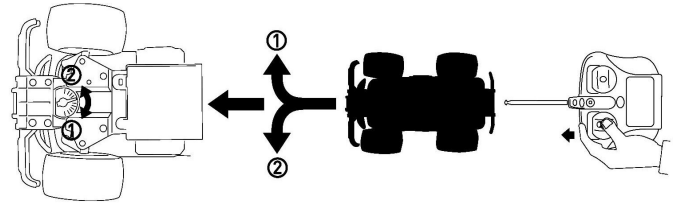
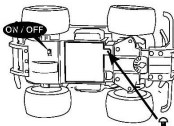

## WARNING

Short circuit can cause fires or destroy electronics. Don't let water / moisture get in the product's electronics. Do not use the battery / charger if there are visible damage.



The accompanying Li-Po battery may not be charged longer than the prescribed time (5 h) and should always be supervised when charging. Do not expose the battery to fire or extremely high temperatures.



Not suitable for children under 3 years contain small parts. Handling of battery / charging is done by an adult. The product contains electronics to be recycled, should not be discarded.

Read this before using the product  
SAFE INSTRUCTIONS

1. Make sure the battery is installed properly. Wrong connected, it can cause battery leakage, and in the worst case the battery catch on fire.
2. Always keep the battery's in supervision when you charge.
3. Do not charge the battery for longer than prescribed.
4. Use only in well-ventilated areas when you charge the battery.
5. Do not store the battery in direct sunlight, high temperatures or humid condition.
6. Never expose the battery to direct fire then it can explode.
7. Do not mix old and new batteries in the transmitter.
8. Never use rechargeable batteries. These are only at 1.2 V.
9. Take out the battery when you are finished.
10. Use only the included battery pack and charger together.
11. Pull out the wall plug from the socket after the completion of charge.
12. Rechargeable batteries should only be charged under the supervision of an adult.

## Warning:

Changes or modifications not expressly approved by the party responsible for compliance could void the user's authority to operate the equipment.

NOTE: This equipment has been tested and found to comply with the limits for a Class B digital device, pursuant to Part 15 of the FCC Rules. These limits are designed to provide reasonable protection against harmful interference in a residential installation. This equipment generates, uses and can radiate radio frequency energy and, if not installed and used in accordance with the instructions, may cause harmful interference to radio communications.



## ENGLISH MANUAL

CROSS  
COUNTRY  
Spider

Item nr: TT-23813B

TECHTOYS