

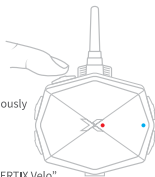

## 8 PAIRING WITH SMARTPHONE

- Power ON by holding **Power** button until red and blue lights flash alternately and 'Pairing' is heard.
- Pairing can be done for up to 2 smartphones.
- To set a smartphone as **Priority**:
  - Press **Power** button again
  - LED lights should flash 'Red Red Blue Blue' continuously
- To proceed with **Normal** pairing:
  - LED lights should flash Red and Blue alternately
- Activate **Bluetooth®** on your smartphone and select "VERTIX Velo"
- Enter default code '0000' if prompted



## 9 PAIRING WITH REMOTE CONTROL

Install battery before using. Remote control is pre-paired with Velo.

If you need to pair again:

- Power ON. Press both **VOL +** and **VOL -** on the Velo and release. The blue LED lights up.
- On the Remote Control, press **VOL +** button once and then press and **HOLD VOL +** until the red light on the Velo flashes, which indicates a successful pairing.
- Pairing only needs to be done once

Note: Should you encounter the unlikely event of interference from another Velo remote control, pair again. A new security code will be applied whenever you pair.

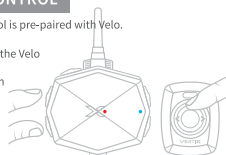

## 10 PAIRING FOR INTERCOM

Pairing is only required once if you ride with the same person or group. Should you ride adhoc with other Velo users, repeat the simple pairing procedure detailed below.

### ➤ PAIRING BETWEEN 2 DEVICES

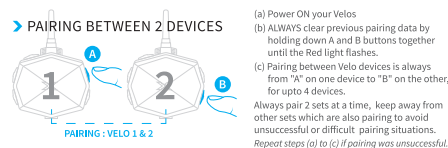

### ➤ PAIRING OF 3RD DEVICE

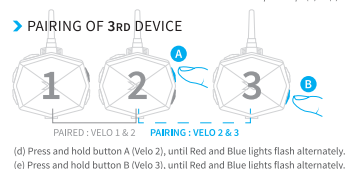

(f) Press button A of Velo 2 once. Only Blue light of Velo 2 flashes.  
 When the Blue light of Velo 3 also flashes, the pairing is successful.  
 Both Velos revert to flashing Red light upon successful pairing.  
 Repeat steps (d) to (f) if pairing was unsuccessful.

### ➤ PAIRING OF 4TH DEVICE

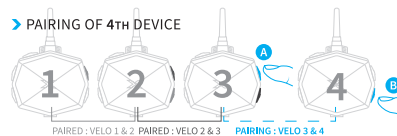

(g) Press and hold button A (Velo 3), until Red and Blue lights flash alternately.  
 (h) Press and hold button B (Velo 4), until Red and Blue lights flash alternately.  
 (i) Press button A of Velo 3 once. Only Blue light of Velo 3 flashes.

When the Blue light of Velo 4 also flashes, the pairing is successful.  
 Both Velos revert to flashing Red light upon successful pairing.  
 Repeat steps (g) to (i) if pairing was unsuccessful.

#### IMPORTANT :

When pairing the sets, keep them away from sets nearby which are also pairing. This may result in unsuccessful or difficult pairing.

## 12 INSTALLATION : CONTROL UNIT



- 1 Select & paste suitable paddings for your helmet type onto rear of mounting base plate.



- 2 Hold mounting base plate with VERTIX logo upwards, and press it firmly on the preferred mounting location behind the helmet.



- 3 Slip the buckle into a suitable air vent which is not too close to the mounting base plate.



- 4 Adjust buckle so that it does not slip through the air vent. Repeat for the other side.



- 5 Tighten the mounting by pulling the straps.



- 6 Align the two catches of Velo to the mounting plate and push forward to lock with the top catch. To release the unit, press your thumb on the unit and pull the catch towards you.

## 13 INSTALLATION : REMOTE CONTROL



- 1 Attach the adhesive padding on the underside of the base plate.



- 2 Mount the base plate to the handlebar with the cable ties provided.



- 3 Slot the remote control onto the base plate.

## 11 USING THE INTERCOM

### INTERCOM INDICATORS

- Single Blue light flash : Connected with 1 other device
- Double Blue light flash : Connected with two other devices

### COMMUNICATING VIA INTERCOM

#### PRIVATE INTERCOM

Private Intercom can only be carried out within the teams (Team A or Team B), and between the 2 forming the Connecting Bridge.

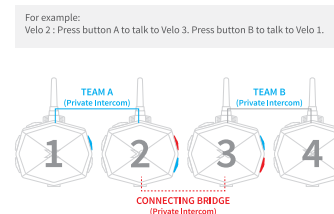

#### Terminating Intercom

For example:  
 Terminating intercom between Velo 2 and Velo 3 : Press button A twice on Velo 2. Intercom with Velo 3 is terminated.

#### GROUP INTERCOM

When intercom links have been established between the devices, riders can talk to each other anytime without the need to press any button, as long as they are within individual range of up to 350m, and total range of up to 1km for 4 riders, between Velo 1 and Velo 4

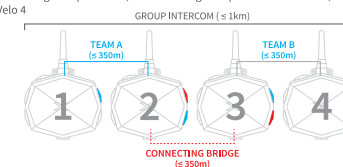

Velo 2 and Velo 3 are connected to two devices each, making them the connecting bridge between Velo 1 and Velo 4 in the group intercom.

This device complies with Industry Canada licence-exempt RSS standard(s). Operation is subject to the following two conditions: (1) this device may not cause interference, and (2) this device must accept any interference, including interference that may cause undesired operation of the device.

Le présent appareil est conforme aux CNR d'Industrie Canada applicables aux appareils radio exempts de licence. L'exploitation est autorisée aux deux conditions suivantes : (1) l'appareil ne doit pas produire de brouillage, et (2) l'utilisateur de l'appareil doit accepter tout brouillage radioélectrique subi, même si le brouillage est susceptible d'en compromettre le fonctionnement.