

Instruction Manual

Digital Broadcast System 10W Receiver

- 402MHZ-410MHZ
- 410MHZ-420MHZ
- 420MHZ-430MHZ
- 430MHZ-440MHZ
- 440MHZ-450MHZ
- 450MHZ-460MHZ
- 450MHZ-470MHZ



Dear Customer,

Thanks for purchasing the Quantun Wireless Digital Broadcast System.

We deeply appreciate your choice of buying our DBS. We believe this product is going to make a positive impact in the functionality and productivity of your company.

Our Digital Broadcast System is one of our RF solutions technologically different from any other existing broadcast systems in the market. The biggest difference is that it is a “Wireless System”, meaning there is no need to install any wires between the “Broadcast Console” & “Remote Terminals”. Additionally, multiple audio sources are fully integrated to the DBS console simplifying operation and saving the cost of the additional equipment that may be required on standard broadcast systems.

Thanks again for your trust in our products. It gives us the motivation to keep developing quality innovative products to successfully satisfy your broadcast needs. We strongly recommend you fully read the operational manual prior to use the equipment. It will greatly help you to understand the features and safe operating parameters of our system.

Cautions for Operation

The Receiver you bought is a high technology product, please operate with care. For a longer useful life, we offer the following advice:.

- A 3 Pins AC Power plug is used in the unit. It has a GND pin for protection. Do not remove it.
- There are High Voltages inside the unit. To avoid any damage or accidents do not try to open the unit.
- Do not install the unit to direct exposure to sunlight, This will limit the service life on the unit.
- Please keep the unit away from magnetic fields.
- To protect this unit from lightning strike, the antenna should be properly installed and protected, with a ground connection and lightning arrestor, if required

Content

I. Unpacking	4
II. Features	4
III. Parts Identification	5
IV. Assembly & Installation	6-7
V. Operation Guide	8
VI. Read/Write Operation	8
VII. Tech Specifications	9
VIII. Trouble Shooting	9
IX. Cautions for Warranty	10
X. Memo	11
XI. Warranty Card	12

I. Unpacking

Please take the receiver out from the packing box carefully and make sure there are no items left in the box prior to discard it. If you detect any loss or damage caused during shipping, please feel free to submit your claim sheet to your reseller without hesitation.

Accessories

No	Item	Qty	Illustration
1	Bracket	1	
2	Instruction Manual	1	

Optional Parts

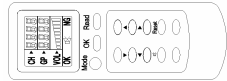
No	Item	Qty	Illustration
1	Antenna	1	
2	Remote Control	1	

II. Features

- (1) Remote Control
- (2). Attractive Design
- (3).Maximum Audio Power output: 10W
- (4).Auto Power-saving when in Standby mode.
- (5). Internally Switched power supply source, for 110v AC and 12V DC.
- (6).Mute the unit by remote control
- (7).Reset the unit by remote control
- (8). Frequency Agile
- (9).Wireless Microphone

III. Parts Identification

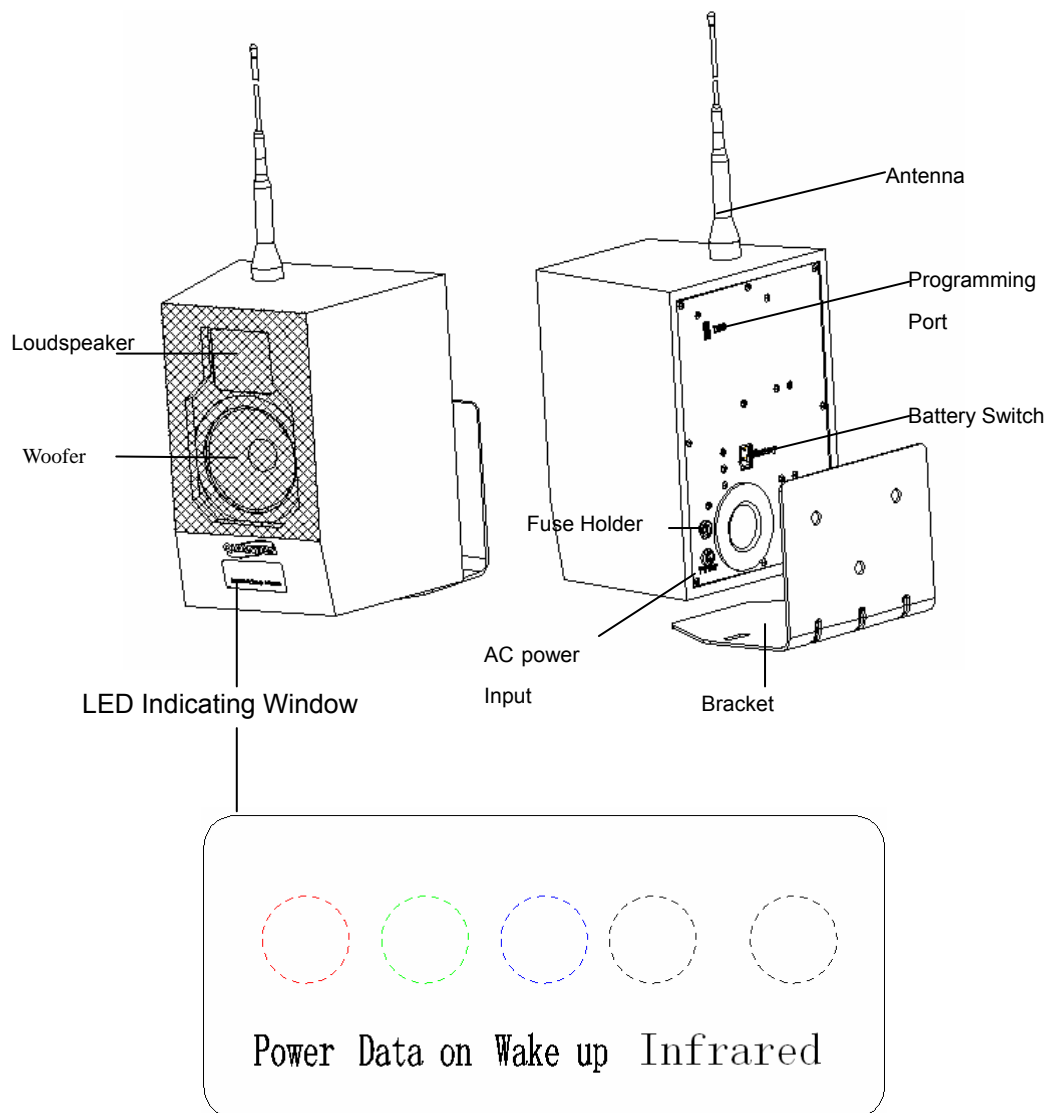

IV. Assembly& Installation

(1). Antenna Removing & Assembly

1. Assemble the antenna as indicated in illustration below.

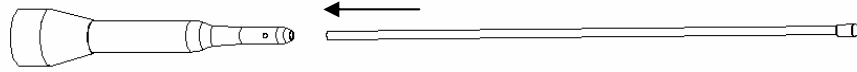

2. Tighten the screws to assemble the antenna



3. Install the antenna in accordance with the arrow direction as illustrated below, to remove the antenna turn in the opposite direction.

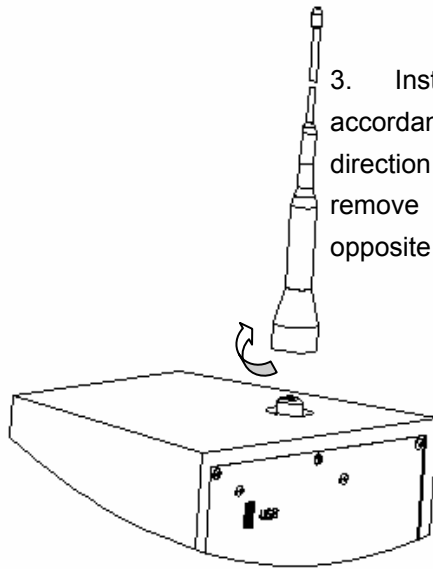

(2). Bracket Assembly and Installation

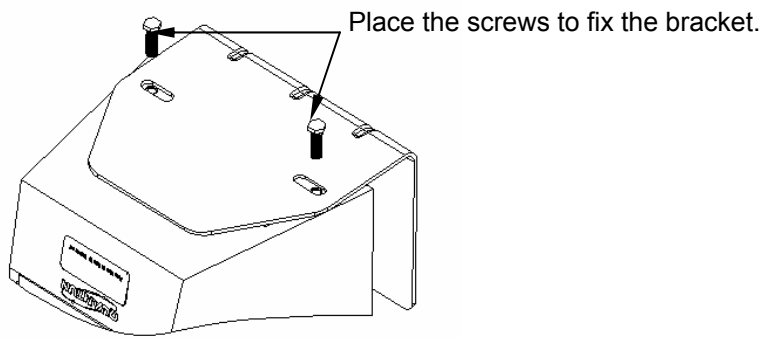

(3). Fuse Removing & Assembly and Battery Switch

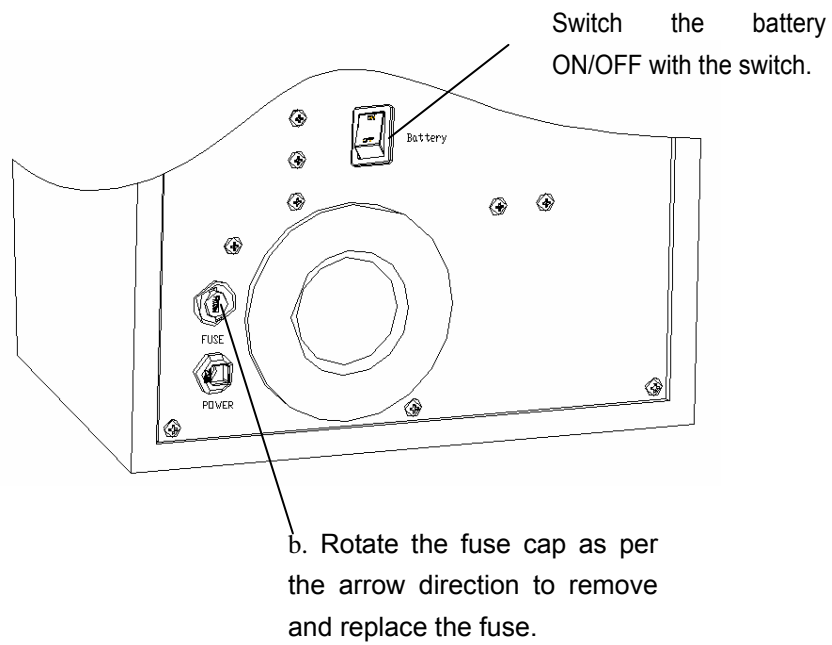

V. Operation Guide

1. Unit Switched On, "POWER" (Red LED) will lit solid bright
2. Signal Received, "DATA ON" (Green LED) will lit solid bright
3. Standby, "WAKE UP" (Blue LED) will lit solid bright (the unit will go to sleep when no signal is received from the DBS for 2 or more minutes)
4. How to Program the new Frequencies in the Receiver.
 - a. Connect Receiver to PC with the programmable cable, and have the Receiver Powered.
 - b. Run the provided programming software.
 - c. In the programming window, click "Read" to read out frequency of each channel
 - d. In programming window, Enter the required frequency, click "Write" to save it.

VI. Read& Write Operation (Keep the remote control 1- 6 meters away and pointing the receiver window you are trying to program).

1. Channel Selecting: Pressing "CH" under "Mode", pressing "▲" "▼" to select the channel (can be set from 0 to 9, valid channels are from 1 to 8) then press "OK". LCD will display "OK" or "NG" to indicate whether the implementation has been successful or not.
2. Group Selecting: Pressing "GP" under "Mode", then press "▲" "▼" "◀" "▶" to set the Group ID (can be set from 0 to 9999, valid Groups range is from 1 to 500) then press "OK". The LCD will display "OK" or "NG" to indicate whether the implementation was successful or not.
3. Volume Control: Pressing "VOL" under "Mode", then "▲" "▼" to increase or reduce the volume level (level 1- 9). The LCD will display "OK" or "NG" to indicate whether the implementation was successful or not, as well as the "current volume level".
4. Mute: Pressing "MUTE", Receiver goes to "Silent" if it's not in "Mute "mode, LCD will display "🔇"; to exit "Silent "by pressing again, "🔇" will disappear.
5. Data Retrieving: Pressing "Read" will get the data from the Receiver, LCD will display "OK" or "NG" to indicate whether the implementation of "Read" was successful or not. If "OK", the LCD will display "CH"、"GP"、"VOL" of the Receiver. It is always required to perform "Read" prior to change or reprogram the receiver.
- 6 .Reset: hold down "Reset" button for 3 Sec to reset the unit.

VII. Tech Specifications

- (1). Power Supply: 110VAC/60HZ and/or 12VDC
- (2). Modulation Method : GFSK
- (3). Operating Frequency: 402~470MHz
- (4). Channel Bandwidth: 100 KHZ
- (5). Channel: 8 CH
- (6). Connection Sensitivity: $\leq -110\text{dBm}$
- (7). Transmission Speed: 38.4kbps
- (8). Modulation Deviation: 15KHz
- (9). Working Temperature: $-10^{\circ}\text{C} \sim 60^{\circ}\text{C}$
- (10). Working Humidity: 10%~90% Relative Humidity No condensation
- (11). Dimension: L215mm*W180mm*H278mm (the size of Antenna & Bracket are not included)

VIII. Troubleshooting

Problems	Solutions
Can't be powered on	<ol style="list-style-type: none"> 1 Please check if the AC Power Cable is properly connected. 2. Please check if the fuse is OK and making good contact
Can't read/write data	Please check if the unit in Normal condition.
No Signals picked up	<ol style="list-style-type: none"> 1. Use the remote control to check the data of the Receiver, check if the Channel is the same of the DBS and the Groups ID is active. 2. Please check if the Antenna is properly connected.
No audio output signal	<ol style="list-style-type: none"> 1. Using the remote control to verify if the unit is in "Mute" mode.) 2. Please check if the Speaker line is properly connected.

IX. Warranty

1. We offer a 1 year warranty period.
2. If during this warranty period the product you have bought proves defective due to improper parts or manufacturing, our authorized Service Station or authorized Service Reseller in your country will repair or replace it at no charge. Our 1 year limited warranty does not cover:
 - A. Damages caused by natural disaster (water, fire, earthquake, lightning), or any improper use that is beyond the control of our company.
 - B. Problems and malfunctions caused by removing disassembly, repairs done by user himself or modifications conducted by any non-authorized personal.
 - C. Any modification or changes to upgrade the product from its normal purpose as described in the Operating Manual without the prior written consent of our company.
 - D. Problems and malfunctions caused by improper settings or Drivers installations done by the user.
 - E. Identification Tag or type or serial number or warranty card of the product has been altered, deleted, removed or made illegible.
 - F. Problems and malfunctions caused by any other improper operation..
3. Please keep in your records the Commercial Invoice & Warranty Card together with the unit at the time it is sent to Service Station Repair and Service. (the purchasing date will be counted from the date of ex-factory if the Commercial Invoice and Warranty Card can't be provided by customer)

Memo

XI. Digital Broadcast System Warranty Card (Customer's Receipt)

Thanks for purchasing our Digital Broadcast System, in the event that any after-sales services are needed, you are required to contact the reseller from whom it was purchased or a member of our authorized Service Network either via Website or Telephone.

1. Please visit our website given below:

www.quantunelectronics.com

2. Please reach our Technical Support Service at the number given below:

Tele: 954-651-6300

Purchasing Date: _____Y_____M_____D

Dealer Tele: _____

Dealer Address: _____

Sales person: _____

*Above blanks are supposed to be completed by the Reseller.

*Please make sure the above said purchasing date is in accord with the date on the invoice.

* "Warranty Card-Customer's Receipt" kept by customer himself.

Digital Broadcast System Warrant Card (Reseller's Return Receipt)

User Information:	
*Name: _____	<input type="checkbox"/> MS Company: _____ <input type="checkbox"/> MR
*Tele: _____	*Cell: _____
*E-mail: _____	
*Province: _____	Address: _____
Postal Code: _____	
<p>*For the customer's rights & interests to be protected, above*marked items are required to be completed after confirmation with customer.</p>	
Reseller Information: Company: _____ Salesperson: _____ Tele: _____ - _____ Ext: _____	
Purchasing Date: _____Y_____M_____D	Reseller:

*Above blanks are supposed to be completed by the Reseller.

*This "Warranty Card (Reseller's Return Receipt) is required to be filled out & cut off by Reseller & has to be shipped to Quantun within 15 days from the time of purchasing.

[HTTP://WWW.QUANTUNELECTRONICS.COM](http://www.quantunelectronics.com)



1379 Shotgun Road Sunrise, Florida USA 33326

TEL: 954-651-6300 FAX: 954-651-6311

This device complies with part 15 of the FCC rules. Operation is subject to the following two conditions: (1) this device may not cause harmful interference, and (2) this device must accept any interference received, including interference that may cause undesired operation.

NOTE: The manufacturer is not responsible for any radio or TV interference caused by unauthorized modifications to this equipment. Such modifications could void the user's authority to operate the equipment.

NOTE: This equipment has been tested and found to comply with the limits for a Class B digital device, pursuant to part 15 of the FCC Rules. These limits are designed to provide reasonable protection against harmful interference in a residential installation. This equipment generates uses and can radiate radio frequency energy and, if not installed and used in accordance with the instructions, may cause harmful interference to radio communications. However, there is no guarantee that interference will not occur in a particular installation.

If this equipment does cause harmful interference to radio or television reception, which can be determined by turning the equipment off and on, the user is encouraged to try to correct the interference by one or more of the following measures:

- Reorient or relocate the receiving antenna.
- Increase the separation between the equipment and receiver.
- Connect the equipment into an outlet on a circuit different from that to which the receiver is connected.
- Consult the dealer or an experienced radio/TV technician for help.