

## BOOX InkSpire (Active Stylus) Quick Start Guide

### BOOX InkSpire 主动笔快速说明书

Eng:

#### Pairing and Charging

The BOOX InkSpire stylus and tablet connect via Bluetooth.

The BOOX InkSpire stylus charges in reverse by magnetically attaching to the tablet.

The BOOX InkSpire stylus is only compatible with the Tab X C.

#### Tips for Usage

During use, the tip of the BOOX InkSpire stylus will gradually wear out. Replace the tip as needed to prevent damage to the tablet screen. The active stylus is not impact-resistant, so avoid dropping it from heights.

#### Replacing the Stylus Tip

To remove the stylus tip, pinch the tip with your fingers and gently rotate it counterclockwise, as shown in Figure ①.

To install a new tip, pinch the tip of the new stylus, insert the tail end vertically into the barrel, and then gently rotate it clockwise, as shown in Figure ②, until it is securely tightened.

Finally, please ensure that the installed tip is firmly in place to prevent it from becoming loose and falling out.

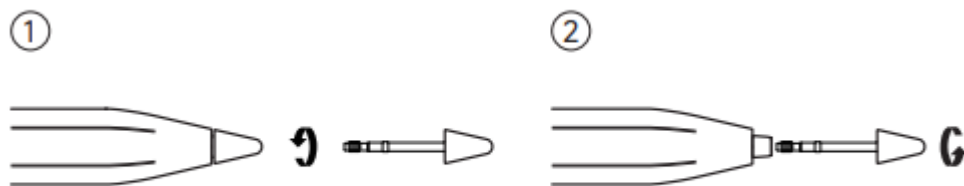

#### FCC WARNING:

This device complies with Part 15 of the FCC Rules. Operation is subject to the following two conditions

1. This device may not cause harmful interference
2. This device must accept any interference received, including interference that may cause undesired operation.

Warning: Changes or modifications not expressly approved by the party responsible for compliance could void the user's authority to operate the equipment

NOTE: This equipment has been tested and found to comply with the limits for a Class B digital device, pursuant to Part 15 of the FCC Rules. These limits are designed to provide reasonable protection against harmful interference in a residential installation.

This equipment generates uses and can radiate radio frequency energy if not installed and used in accordance with the instructions, may cause harmful interference to radio communications. However, there is no guarantee that interference will not occur in a particular installation.

If this equipment does cause harmful interference to radio or television reception which can be determined by turning the equipment off and on, the user is encouraged to try to correct the interference by one or more of the following measures:

- Reorient or relocate the receiving antenna
- Increase the separation between the equipment and receiver.
- Connect the equipment into an outlet on a circuit different from that to which the receiver is connected
- Consult the dealer or an experienced radio/TV technician for help.

RF exposure warning statement: The device can be used without restriction

繁体：

#### 配對與充電

B00X InkSpire 與平板透過藍牙配對

B00X InkSpire 於平板磁吸後，反向充電

B00X InkSpire 只適用 B00X Tab X C

#### 溫馨提示

使用過程中，B00X InkSpire 主動筆的筆尖會逐漸磨損，需要更換筆尖以避免損壞平板螢幕

主動筆不耐摔，請避免高空掉落

#### 更換筆尖

用手指捏住筆尖，然後如圖所示①逆時針方向將筆尖輕旋出筆管

捏住新筆尖的頭部，將筆尖尾部垂直插入筆管中，然後如圖示②順時針方向輕旋筆尖，直到擰緊為止

請檢查已安裝的筆尖是否牢固，以免筆尖鬆脫掉落

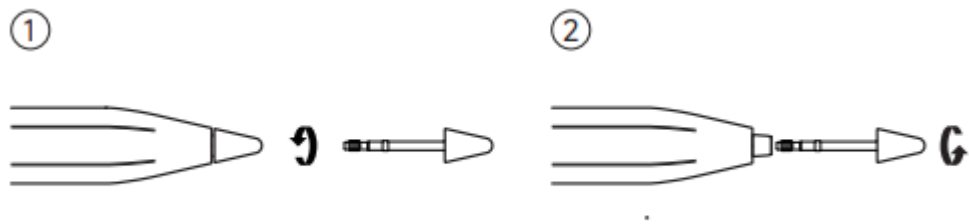

Japanese:

#### ペアリングと充電

BOOX InkSpire は Bluetooth 経由でタブレットとペアリングします

BOOX InkSpire はタブレットに磁氣的に吸着された後、逆充電されます。

BOOX InkSpire は BOOX Tab X C でのみ動作します

#### 親切なヒント

BOOX InkSpire アクティブ ペンの先端は使用中に徐々に摩耗するため、タブレット画面の損傷を避けるために交換する必要があります。

アクティブ ペンは落下に弱いため、高所からの落下は避けてください。

#### ペン先を交換する

図①に示すように、ペン先を指で持ち、ペン先を反時計回りにゆっくりとペン軸から外します。

新しいペン先の頭を持ち、ペン先後端をペン軸に垂直に差し込み、図②のように時計回りにしっかりと締まるまでゆっくりと回してください。

ペン先の緩みや脱落を防ぐため、取り付けたペン先がしっかりと取り付けられているか確認してください。

