



LIGHT[®] Speaker

Patented

State-of-the-art LIGHT & SOUND

One complete system that installs in 30 minutes or less!



OWNER'S MANUAL AND INSTALLATION INSTRUCTIONS



Tech Support: 1-800-KLIPSCH



The lightning flash with arrowhead symbol, within an equilateral triangle, is intended to alert the user to the presence of uninsulated "dangerous voltage" within the product's enclosure that may be of sufficient magnitude to constitute a risk of electric shock to persons.

Le symbole de l'éclair fléché dans un triangle équilatéral, a pour but d'avertir l'utilisateur de la présence non isolées d'une «tension dangereuse» dans le boîtier du produit que mai d'une magnitude suffisante pour constituer un risque d'électrocution pour les personnes.



The exclamation point within an equilateral triangle is intended to alert the user to the presence of important operating and maintenance (servicing) instructions in the literature accompanying the appliance.

Le point d'exclamation dans un triangle équilatéral sert à alerter l'utilisateur de la présence d'importantes exploitation et de maintenance (entretien) dans la documentation accompagnant l'appareil.

Caution marking is located at the side of the apparatus.
Attention marquage est situé sur le côté de l'appareil.

CAUTION: Risk of Electrical Shock - Use in Dry Locations Only

ATTENTION: Risque de Choc Électrique - Utiliser Seulement Dans des Endroits Secs

CAUTION: To reduce the risk of electric shock, do not remove cover (or back). No user servicable parts – refer servicing to qualified service personnel only.

ATTENTION: Pour réduire le risque de choc électrique, ne pas retirer le couvercle (ou l'arrière). Non utilisateur servicable parts - confier l'entretien de service qualifié seul le personnel.

WARNING: To reduce the risk of fire or electric shock, do not expose this apparatus to rain or moisture.

AVERTISSEMENT: Pour réduire le risque d'incendie ou de choc électrique, ne pas exposer cet appareil sous la pluie et l'humidité.



Tech Support: 1-800-KLIPSCH



IMPORTANT SAFETY INSTRUCTIONS

1. Read these instructions. Keep these instructions. Heed all Warnings. Follow all instructions.
2. Do not use this apparatus near water. The apparatus shall not be exposed to dripping or splashing and that no objects filled with liquids, such as vases, shall be placed on apparatus.
3. Clean only with a dry cloth.
4. Do not block any ventilation openings. Install in accordance with the manufacturer's instructions.
5. Do not install near any heat sources such as radiators, heat registers, stoves, or other apparatus (including amplifiers) that produce heat.
6. The lamp holder is used as disconnect device. The lamp holder of apparatus should not be obstructed OR should be easily accessed during intended use. To completely disconnect the power input, the lamp holder of the apparatus shall be disconnected from the mains.
7. Only use attachments/accessories specified by the manufacturer.
8. Refer all servicing to qualified service personnel. Servicing is required when the apparatus has been damaged in any way, such as power-supply cord or plug is damaged, liquid has been spilled or objects have fallen into the apparatus, the apparatus has been exposed to rain or moisture, does not operate normally, or has been dropped.
9. Added weight of the device may cause instability of a free-standing portable lamp. Use only with portable table lamps in which the distance from the bottom of the base to the top of the lampholder does not exceed three (3) times minimum base width. Use only with portable table lamps which are provided with lamp shades" or the equivalent.
10. This device is not intended for use with emergency exit fixtures or emergency exit lights
11. NOT FOR USE WHERE EXPOSED TO THE WEATHER
NE PAS EXPOSER AUX INTEMPÉRIES
12. NOT FOR USE IN TOTALLY ENCLOSED RECESSED LUMINAIRES
NE PAS INSTALLER DANS DES LUMINAIRES ENCASTRÉS COMPLÈTEMENT FERMÉS



Tech Support: 1-800-KLIPSCH

LIGHT
Speaker

Congratulations

Thank you for choosing a LightSpeaker® from Klipsch®. You have chosen one of the most unique, patented, audio systems in the world. With proper installation and operation, you will enjoy years of trouble-free use. Klipsch® sells numerous loudspeakers for use inside or outside your home. To see the complete Klipsch® product assortment, visit us on the Internet at: www.Klipsch.com.

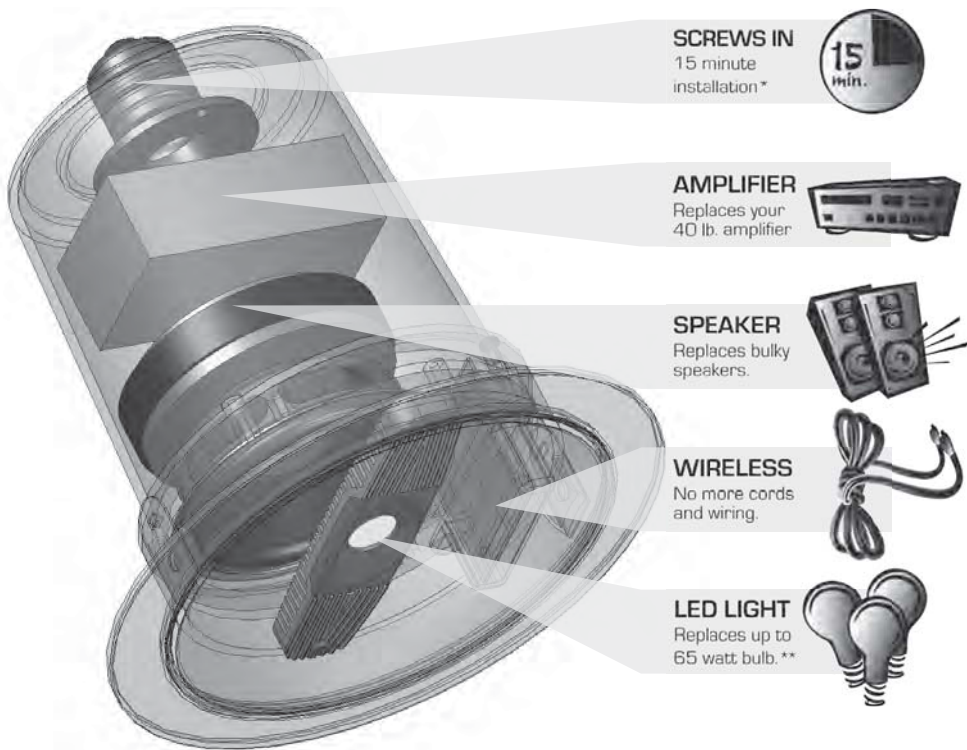



Tech Support: 1-800-KLIPSCH



Table of Contents

System Overview.....	6
What is in this box.....	8
Step 1 - Where will you install.....	9
Step 2 - Check your connector type.....	9
Step 3 - Test fit your LightSpeaker®.....	10
Step 4 - Removing the trim ring.....	11
Step 5 - Installing the trim ring.....	14
Step 6 - Adjusting the Simple Tabs™.....	15
Step 7 - Setting the zone and stereo switches.....	16
Step 8 - Installing your LightSpeakers®.....	20
Step 9 - Pairing.....	21
Step 10 - Plug in your sources.....	23
Step 11 - Enjoy your LightSpeakers®.....	24
Operating the transmitter & remote control.....	25
Helpful hints.....	27
More about removing trim rings.....	30
Where to put the transmitter.....	33
Attaching the remote wall bracket.....	33
Selecting LightSpeaker® locations.....	34
Specifications.....	37
Possible causes of interference.....	40
Troubleshooting the remote.....	41
Warranty.....	42
Registration Information.....	43
FCC Declaration.....	44
Technical Support Information.....	Back Cover



Tech Support: 1-800-KLIPSCH

LIGHT
Speaker

System Overview

This wireless LightSpeaker® System is intended to install into any home easily and without any expensive and complicated wiring. You can install a typical system in your home in a few minutes and not have to worry about repairing walls or ceilings. Plus there is no climbing into attics or wriggling into crawl spaces! LightSpeakers® deliver great sound into any room in your house, using your existing wiring and your recessed lighting fixtures. The LightSpeaker® installs in a standard 5" or 6" recessed ceiling light fixture common in most homes. It will replace a standard light bulb (R-30 or R-40). This unique patented LightSpeaker® has full bandwidth audio and "green" lighting together in one small package. The 10 watt LED can replace up to a 65 watt incandescent bulb while using 80% less power than the light bulb it replaced. Consider also that you may never have to replace this light; an operating life of 25,000 to 40,000 hours means that with average use this light should easily last 15 to 25 years.





Tech Support: 1-800-KLIPSCH



Your system can use up to 8 LightSpeakers® to provide audio and lighting to your entire home. You can even divide your home into two unique areas where different music sources, sound and lighting control allow you to add music with integrated “green” lighting to places you only dreamed of having it before.

There’s no wiring and no big (or small) speaker boxes. The wireless transmitter can be centrally located which will provide audio and, together with the remote, allow you to control your LightSpeakers® from anywhere in your home. The RF remote and the transmitter base station will control which source you listen to in a room as well as the level of the sound and the brightness of the light; this can be done from anywhere in the house, you don’t need to be near the transmitter.

Plug two separate audio sources into your transmitter and deliver the music from your AM/FM Radio, TV or MP3, or any audio source, to any room in your house. To expand your system, additional LightSpeakers® are available from your retailer or at www.klipsch.com.

This incredible patented system provides even greater flexibility to you as the owner; since you can take this system with you if you move; and when you do, it leaves no trace (holes that need to be covered) that the system was ever installed and used.

Please take a few moments to copy down the serial number and part number found on the side of your product box onto page 43 of this manual. You will need them to register your product.



LIGHT
Speaker

Tech Support: 1-800-KLIPSCH

Take just a minute to be sure you have everything you need to install your first wireless distributed audio system from Klipsch®.



Transmitter



Power Cord

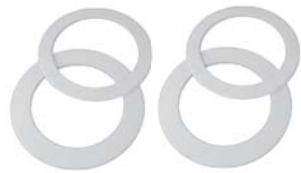

Large & Small
Trim Rings



LightSpeakers®



Remote



Lenses



Remote Wall Bracket



Attachment Cords



Tech Support: 1-800-KLIPSCH



Instruction Manual

Step 1: Decide which lights will be replaced with LightSpeakers®.

Your Klipsch® LightSpeakers® have been specifically designed to cover large areas, however if the location of your fixtures allow you to do so, you should think about how you use your room and where you are likely to spend most of your time. Then choose the fixtures that are most evenly spaced to your preferred listening position.



WARNING!

Turn off circuit breakers to all lighting fixtures you are working on!

A) Turn off the circuit breaker and light switch, to the bulbs you intend to replace with LightSpeakers®.

B) Remove the existing light bulb.

Step 2: Check your connector type. Your Klipsch® LightSpeaker® is designed to fit into a standard Edison connector. It will not fit any other type connector.

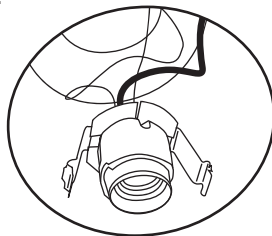

STOP!

Check your connector!



Tech Support: 1-800-KLIPSCH



Step 3: Test fit your LightSpeaker®.

Your LightSpeaker® is designed to fit directly into most 5" (R30) and 6" (R40) down light cans by simply removing the existing light and, in the same manner as a light bulb, re-installing your LightSpeaker® in its place. You may simply test fit your LightSpeaker®, or you may measure according to the diagram below, to be certain your Klipsch® LightSpeaker® will fit directly into your recessed light fixture.

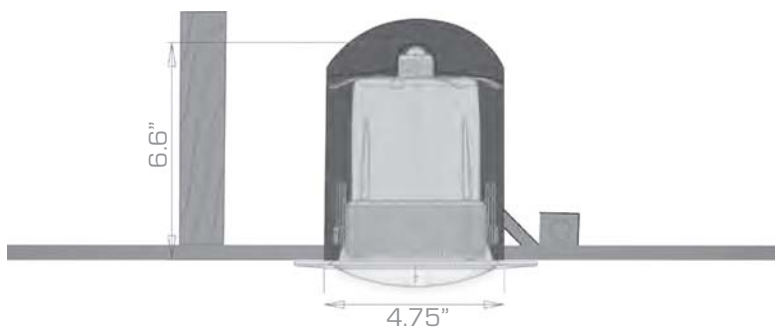

This diagram shows the minimum width and depth necessary to house your LightSpeaker® completely within the recessed lighting enclosure. The depth can be less if you do not mind your LightSpeaker® standing out slightly from the ceiling.

If your LightSpeaker® fits directly into your recessed lighting fixture without any modifications you can skip forward to **Step 7**.



Tech Support: 1-800-KLIPSCH



If your Lightspeaker® does not fit either because the trim ring/reflector opening is too small or the lighting fixture is not set deep enough, please follow the instructions below.



STOP!
Depth is adjustable in
most fixtures! Read on!

Step 4: Removing the trim ring and any included reflector.

There are many types of recessed light fixtures so it may be necessary to perform a few simple operations. The goal is to get your ceiling fixture to look like the picture below.

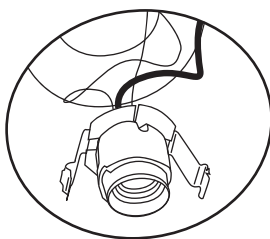

Remove the trim ring and reflector. Sometimes, especially in the 5" fixtures, these are combined units like the figure below.

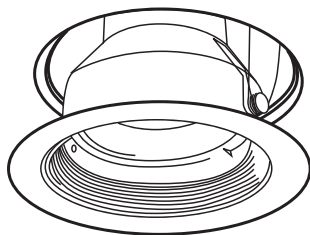



Tech Support: 1-800-KLIPSCH



The attachment here is via a common “V” spring. To remove simply pinch the two sides of the spring together and slip out of the “C” shaped brackets on the inside walls of the lighting fixture.

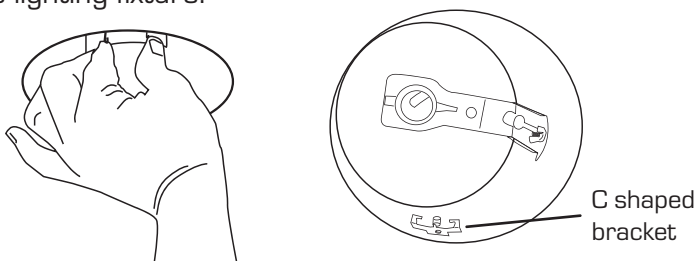

The trim ring and reflector may also be attached to the inside of the recessed lighting fixture with small springs. Reach inside the lighting fixture, grasp the spring at the top hook, and lift it off of its point of attachment. There are usually two springs one on either side of the fixture. For more information on removing this type of trim ring see the section titled “More on Removing Trim Rings and Reflector” on page 28 in this manual.

The Edison Socket may also be attached to a socket arm (L-shaped bracket) or to a socket plate (flat circular piece of metal). Many times this “arm” or “plate” can be adjusted via a wing nut to a depth which is suitable for mounting your LightSpeaker®. In most cases however it is just as easy or easier to just remove the socket plate all together since it provides for the quickest and easiest install.

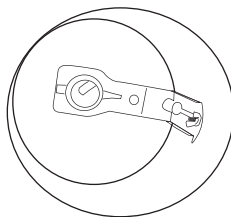



Tech Support: 1-800-KLIPSCH



Repositioning the socket plate (arm): Loosen the wing nut just enough to push the plate (arm) as far into the enclosure as it will go. Retighten the wing nut. Retest your LightSpeaker® for proper fit. If it fits, remove it again and go forward to **Step 7**.

Complete removal of the socket plate: Loosen the wing nut, turning the “wings” so that they are aligned with the slot. Slide the plate until the big opening in the slot aligns with the thick part of the wing nut. Lift the socket plate free of the wing nut. Slide the wing nut up to the top of the slot and retighten.

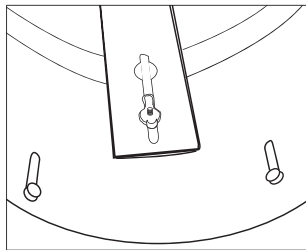

The Edison socket is most often attached to the socket arm with either 2 screws or via a spring bracket. Either remove the screws to free the socket, or pinch the spring bracket to slide it free of the plate (arm). In 5” fixtures this spring bracket may be attached to a metal bracket which is itself attached to the trim ring and reflector.

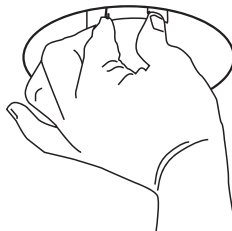



Tech Support: 1-800-KLIPSCH



HELPFUL TIP!

Save all the parts so if you move, you can replace and take your LightSpeakers® with you.

Step 5: Installing the trim ring.

Your LightSpeaker® comes with their own integrated trim ring. There are two different sizes. Choose your trim ring based on either A or B below and place the LightSpeaker® trim ring over the back of the LightSpeaker®. Be sure the finished side is facing out. Upon completion of the install, this trim ring should fit snugly and uniformly to the ceiling and should also seat properly around the entire edge of your LightSpeaker®.

A) The thicker trim ring will be used when your LightSpeaker® is installed into a 6" lighting fixture.

B) The thinner one when it is installed into a 5" fixture. As long as the trim ring covers the edges of the lighting fixture and any rough drywall edges you may use either trim ring; it will not affect the performance of your LightSpeaker®.

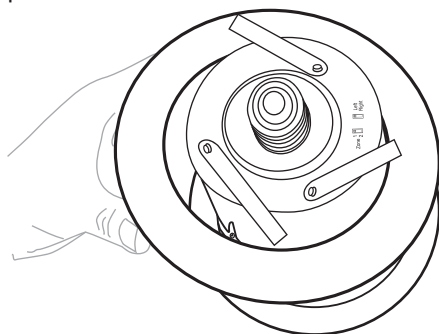



Tech Support: 1-800-KLIPSCH



Step 6: Adjusting the SimpleTabs™.

Your LightSpeaker® is equipped with a unique mounting system. The three SimpleTabs™, on the back of the speaker can be rotated outward and when the LightSpeaker® is pressed into the housing, hold it centered and securely in place.

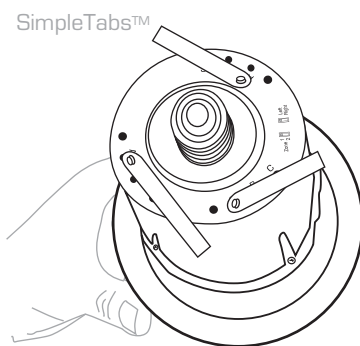

You will now adjust the Simple Tabs™ on the back of the LightSpeaker® to either A (6" recessed light fixture) or B (5" recessed light fixture).

If you are installing into a 5" recessed lighting fixture, rotate each of the SimpleTabs™ out to position "B" on the top of the LightSpeaker® unit.

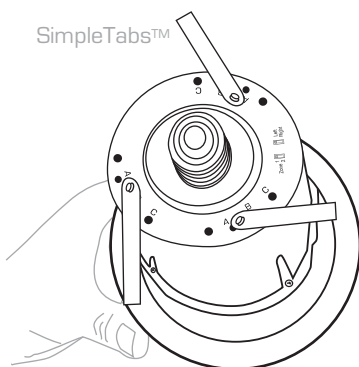



Tech Support: 1-800-KLIPSCH



If you are installing into a 6" recessed lighting fixture, rotate each of the SimpleTabs™ out to position "A" on the top of the LightSpeaker® unit.

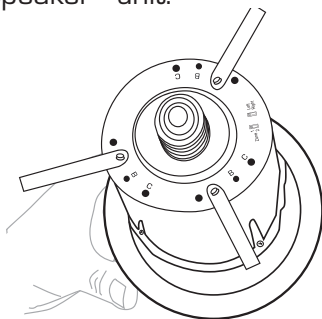

Step 7: Setting the Zone and L/R Stereo Switches.

A) Set the zone switch on the back of the LightSpeakers® to one, unless you are setting up a two zone system. For more on zones see Step 7B: Setting up a Two Zone System below after completing B and C below.

B) Set the left/right stereo switch. "L" if it is the left speaker, "R" if it is the right speaker. For additional information see Selecting LightSpeaker® Locations.

C) Your LightSpeaker® system allows you to install up to 4 pair of (or 8 total) speakers. If you are installing more than one pair of LightSpeakers® you will probably want to divide your home into zones.

If you are not setting up a two zone system, go to Step 8.



Tech Support: 1-800-KLIPSCH



Step 7B: Setting up a Two Zone System

Your system allows you to set up two separate zones. Zones are the different spaces in your home where you want to listen to music, and are important because, later in this setup, your Transmitter will automatically seek out and identify each zone. This in turn will allow you to control the music and lighting in each zone separately. (See Figure 2A)

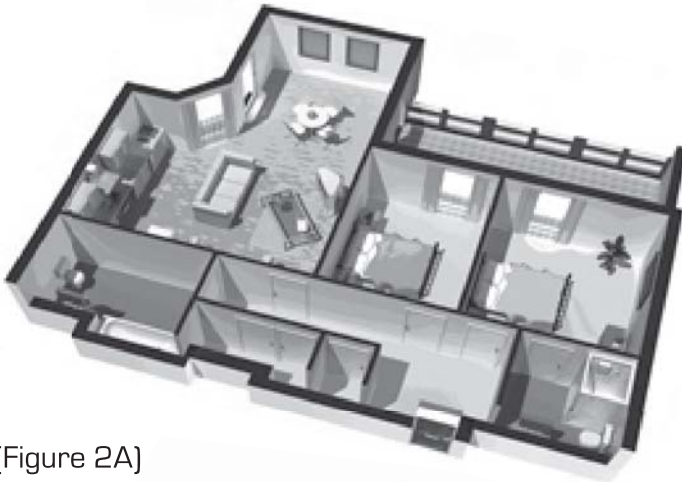

(Figure 2A)

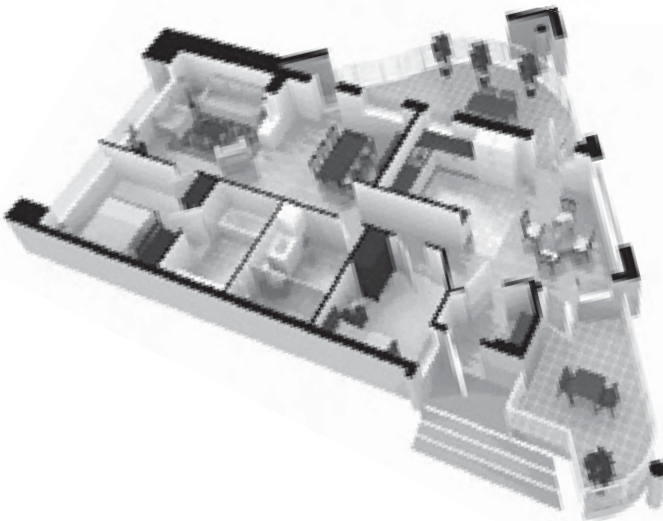



Tech Support: 1-800-KLIPSCH

LIGHT
Speaker

Assign Zone 1 to one area and Zone 2 to the other unique area. (See Figure 2B)

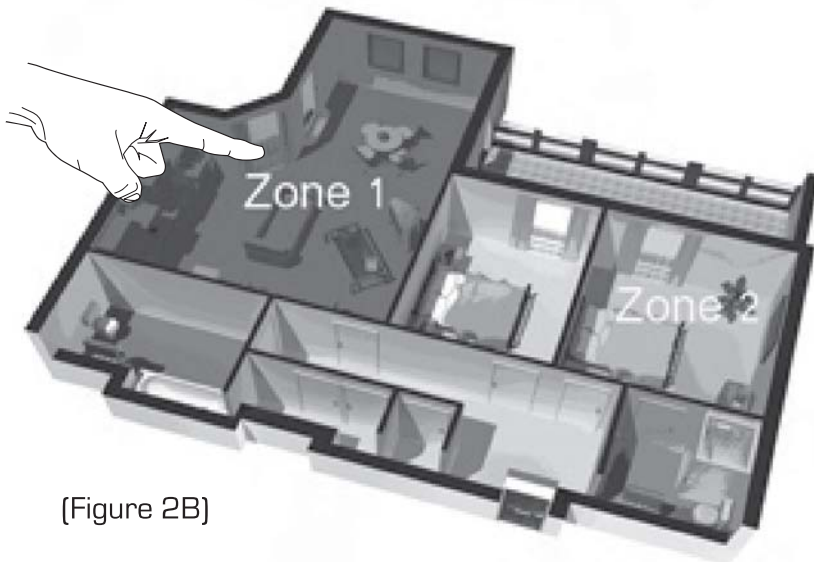

(Figure 2B)

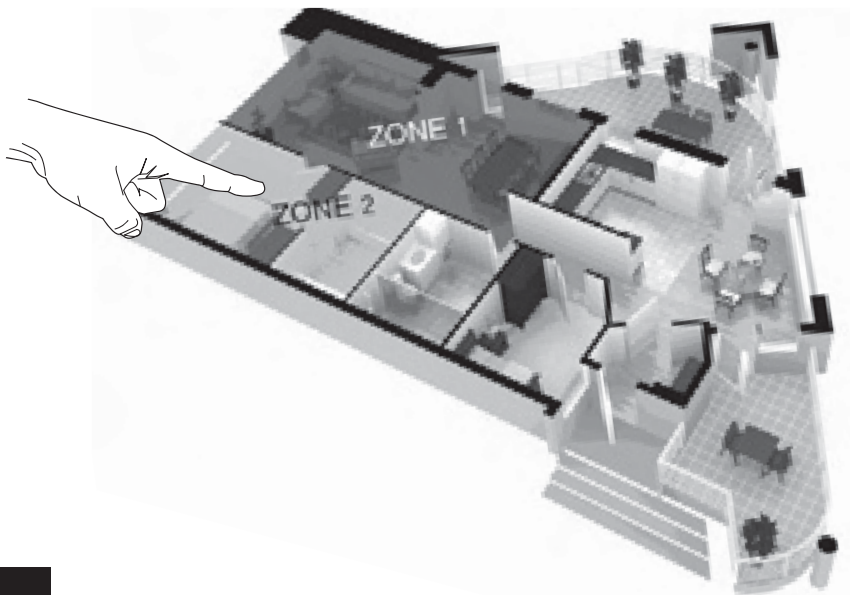



Tech Support: 1-800-KLIPSCH



Here we have assigned Zone 1 to the family room, and Zone 2 to the kitchen area; these are areas where, even though you are listening to the same music (the same source), you may still want to control lighting brightness and speaker volume separately. For example persons listening to music in the kitchen may want to turn the music volume lower while those in the family room may want to turn the music louder and dim the lights. With two zones each group can have the music and lights the way they want them without affecting the other group.

Two-Zone System: Assign each LightSpeaker® to the zone where it will be installed.

- A)** Create a sketch of your anticipated zones (ie. Figures 2A and 2B above).
- B)** Decide what zone the speaker will go into.
- C)** Place the LightSpeakers® in their respective zones. Set the zone switch, on the back of each LightSpeaker®, to the zone it will be placed.

This LightSpeaker® will be used in Zone 1 and is the right side of a stereo pair.

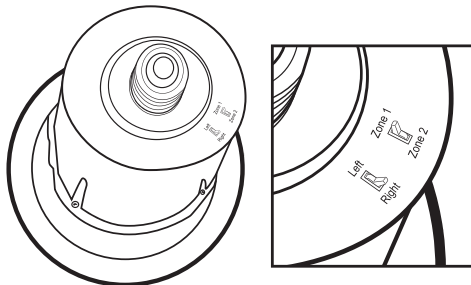



Tech Support: 1-800-KLIPSCH



Step 8: Installing your LightSpeaker® into the recessed light fixture:

A) Simple Install: If you skipped steps 4-6, and your LightSpeaker® fits with no modifications, screw it into the lighting fixture. Test your circuit by turning on the circuit breaker and light switch from Step 1. If the LED light does not come on after 5 seconds remove and reinstall the LightSpeaker®, check your circuit breaker and try the switch again. You can now skip to Step 9.

B) Simple Tab Install: If you did not skip steps 4-6, here's how to use the SimpleTabs™ to install your LightSpeaker®:

1) Grasp the Edison Socket with one hand, and with the other hand screw the LightSpeaker® into the socket on the pigtail. Be careful: Always turn the speaker not the socket. Turning the socket will twist up the pigtail and put unneeded stress on the connection.

2) Grasp the LightSpeaker® by the light bridge (see section titled "Removing the Lens" below) and while holding it level and steady, firmly push it back into the lighting fixture. It is not necessary to use the light bridge to install LightSpeaker®, so do so only if you find it helpful.



WARNING!

Be careful not to touch the speaker when grasping the light bridge.

Light Bridge

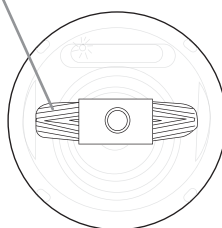



Tech Support: 1-800-KLIPSCH



3) Be certain this trim ring contacts the ceiling uniformly all of the way around your LightSpeaker® and that the LightSpeaker® itself is seated securely into the electrical socket. Note: sometimes the metal clip that holds the Edison socket to the socket plate prevents the LightSpeaker® from seating completely and making a good electrical connection. If this occurs simply bend the tabs out and up 1/8" - 1/4".

Step 8B: Removing your LightSpeaker® from a recessed lighting fixture.

Remove the lens (See Installing and Removing the Lens), and while pushing up lightly apply a 1/4" turn in a clockwise direction. Gently pull down on the light bridge. See "Removing the lens" below.

Step 9: Pairing The Transmitter to the speakers

A) Attach the power cord at the "DC IN" connector on the back of the Transmitter.

B) Turn on the Power Switch.

C) Pairing - This fully automated process will tell the transmitter where each LightSpeaker® is located, allow you to control each zone separately and make your LightSpeaker® system secure from other nearby systems. After you have set the zone switch on each speaker to the correct zone and you have installed your light speakers into the correct sockets in the correct zones (i.e. Zone 1 speakers in Zone 1, Zone 2



Tech Support: 1-800-KLIPSCH

LIGHT
Speaker

LightSpeakers™ in Zone 2] the job is nearly finished all that remains is allowing the transmitter discover where each of the installed LightSpeakers® is located.

- 1) To pair your LightSpeakers® to your transmitter, turn off all of the light switches in the areas where LightSpeakers® are located.

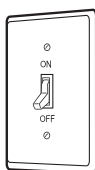

- 2) Be sure Transmitter is plugged in and the power button is on.

- 3) Push the button marked “PAIRING”. The PAIRING LED on the transmitter will begin flashing RED.

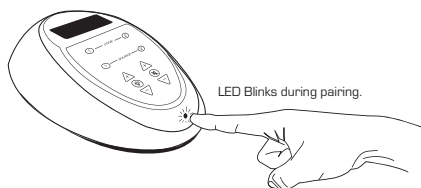

- 4) Turn on all light switches that your LightSpeakers® are connected to. The Small LED light on the speakers will begin to flash red and will turn green when the pairing is complete. The transmitter will automatically find each speaker and assign it to its proper zone.

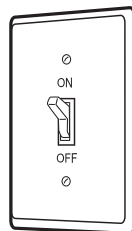



Tech Support: 1-800-KLIPSCH



5) If after 1 minute the LED on the LightSpeaker® has not turned “GREEN”, repeat steps 1-4.

a) If after 2 attempts the LED on the LightSpeaker® fails to turn green, try relocating the Transmitter closer to the LightSpeaker®

Step 10: Plugging in your sources.

Using the supplied audio cords, plug your MP3, CD Player, television or other desired sources to the back of the transmitter.

Attach 1 or 2 audio sources.

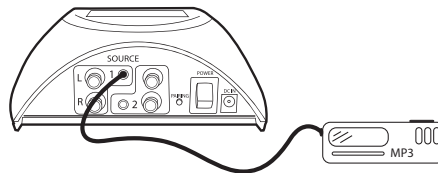

A) Locate the sources you want to use. They will have audio level outputs on them. Typically these are RCA or stereo headphone type jacks. You will need to have the proper cable from the source you want to attach to the Transmitter. You have two choices:

1) RCA to RCA cable

2) RCA to Stereo Mini Plug Cable



Tech Support: 1-800-KLIPSCH



CAUTION!

Do not use the speaker outputs as this can damage the transmitter!

B) If you are attaching only one source it may be attached to either input but may be convenient to attach to source one.

1) You may use either the mini-plug or the RCA inputs on either source but only one input may be used at a time.

The remote control and the transmitter are controlled in exactly the same manner. When you push a button on the remote control the small LED next to the button will light up and remain lit until you push another button affecting either that zone or that source. The LEDs that are lit will tell what action the remote or transmitter is currently set to control.

Step 11: Enjoy your LightSpeakers®!



Tech Support: 1-800-KLIPSCH



Operating the Transmitter and Remote Control:

The remote control and the transmitter are controlled in exactly the same manner. When you push a button on the remote control the small LED next to the button will light up and remain lit until you push another button affecting either that zone or that source. The LEDs that are lit will tell what action the remote or transmitter is currently set to control.



Here are the steps to take to operate the Transmitter and Remote Control:

- A)** Press the zone you want to control
- B)** When the LED next to the button lights, that zone is active and will be playing the source that is currently lit. To change to a different source simply press the source with the “unlit” LED until the LED next to the source you are choosing lights.
- C)** Pressing Light once makes the light go On/Off
- D)** Pressing the + arrow above the light “on” button will increase the brightness of the light. Pressing the “-” arrow below the light on/off button will dim the



Tech Support: 1-800-KLIPSCH



light. The LED will flash when the arrows are pushed and will turn red and flash quickly when either the maximum or minimum brightness is reached.

E) Pressing and holding the ON/OFF button turns ON or OFF all Zones with source 1 playing if turned ON.

F) When Power is applied to a LightSpeaker® by the wall switch the light defaults to the ON state. This allows the LightSpeaker's LED to function like a light bulb.

NOTE: If your remote does not operate, or you have purchased additional remotes to be used with the same transmitter, please see Trouble shooting on page 41 of this manual.



Tech Support: 1-800-KLIPSCH



Helpful Hints

Types of Recessed Ceiling Light Fixtures

The most important step you can take to simplify the installation of your LightSpeakers® is to know, before you purchase, which type of ceiling light fixtures are installed in your ceilings. The two most common recessed lighting fixtures, and the ones that your LightSpeakers™ are designed to best fit into, are the R30 and the R40 fixtures. These designations are intended to let you know that these recessed fixtures are suitable for use with either a 3" (R30) light bulb or a 4" (R40) bulb. As you might expect, the R30 light fixture is smaller than the R40 and most importantly the mounting systems are usually quite different. One way to tell the difference between the two lighting fixtures is to measure the diameter of the metal lighting fixture at the point its rim exits the ceiling. An R30 can is very close to 5" across and an R40 can is closer to 6" across. The makers of these fixtures do not adhere to a fixed standard so there is some variation between the measurements of the various manufacturers.

In the R30 lighting fixture the Edison connector is most often attached to a "pigtail"; a short piece of electrical wiring which allows the connector to hang loose in the can. In the R40 lighting fixture the Edison connector is nearly always attached to a "Socket Plate" which can be adjusted up or down by loosening a wing nut on the side of the fixture.

The R40 lighting fixture nearly always has its Edison connector firmly attached to a sliding plate which can be moved up or down in the can by loosening a wing nut.



Tech Support: 1-800-KLIPSCH



When installing in an R40 light fixture you will want to loosen this nut and move the plate as far back as possible. If this wing nut is properly tightened, it will be sufficient to securely hold your LightSpeaker® permanently in place.

The R30 light fixture uses another entirely different method to secure the LightSpeaker® to the down lighting fixture. It is held by means of two wire “V springs”. These are sometimes but not always the springs that hold the trim ring to the light fixture; more often they are the two wing shaped springs that when viewed out of the light fixture form, as the name implies, a spread out letter “V”. If you have removed the existing trim ring and any included reflector, then you will have already encountered these “V springs” and know how they operate. Do not confuse these springs with the “coil springs” which attach the reflector to the down lighting fixture.

Installing and Removing the Lens:

A) Removal BEFORE your LightSpeaker® is installed.

- 1)** While holding the LightSpeaker® in the palm of your hand rotate the unit until one of the holding tabs is facing up.
- 2)** Using a fingernail, common screwdriver or other small flat object, gently push down and then out on the tab, easing it out through the opening in the LightSpeaker® housing.





Tech Support: 1-800-KLIPSCH



CAUTION: Do not touch the LED or Speaker Baffle with the lens off when the unit is hot, allow the unit to cool down before touching the baffle.

3) When the lens pops up, gently pry it away from the housing, being gentle and making sure not to break the tabs.



B) Removal of the lens **AFTER** your LightSpeaker® has been installed.

1) There are three small indentations around the lens; with a small tip common screwdriver, nail file, paper clip or similar object, gently slip the tip into the indentation and pry the lens outward until the retaining tabs pull free.

2) To re-install the lens, align the tabs and the hole for the pairing LED, then push gently until the locking tabs snap into place.



Tech Support: 1-800-KLIPSCH



More About Removing Trim Rings

The trim ring is the narrow ring of plastic (usually) that contacts the ceiling and gives your ceiling light, and your LightSpeaker® a finished look when butted against the ceiling drywall. Your LightSpeaker® comes equipped with its own paintable trim ring. If your LightSpeakers® do not fit directly into the recessed lighting fixture, you may need to remove the trim ring and any included reflector. This is not a difficult process however exercising a little care will make the job look better when you are finished. We suggest that you turn off the light switch and the circuit breaker prior to beginning any work.

With the old light bulb removed determine whether your hand will fit easily through the hole into the interior of the lighting fixture. If it does, you will likely not require any special tools to complete the process. Simply grasp one end at a time of each of the two coil springs and lift them free of the retaining clips in the fixture housing. See figure below for the various ways that these springs may be attached to the housing.

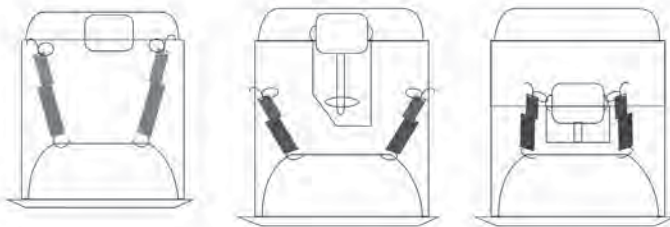



Tech Support: 1-800-KLIPSCH

LIGHT
Speaker

A) If your hand does not fit easily through the hole you may find the job easier if you have either a “spring removal tool” or even a “long nose pliers”. Both are available at your local hardware store.



Klein Spring Removal Tool



Long Nosed Pliers

B) If your hand does not fit through the opening, one of these tools can be used to remove the coil springs that are used to hold the trim ring and reflector to the recessed light housing.

Coil Spring



C) The trim ring may have been previously painted to match the color of the ceiling, and this paint may be gluing or otherwise bonding the trim ring to the ceiling drywall. If this is the case, you may want to break the paint bond by carefully cutting around the edge with a utility knife.



1) After you have cut the paint bond at the edge of the trim ring use a small blade (1" or smaller) putty knife to gently slide under the trim ring and lift it free of the underlying surface.





Tech Support: 1-800-KLIPSCH



D) V Springs. Another method of holding various parts to a recessed lighting fixture, is the use of “V” springs. Like the name implies they are shaped in the form of a V. When compressed (pinching the two legs of the V) and fitted into the “V Spring Clip” on the side of the metal lighting fixture they form a spring that will slide up and down several inches. When attached to the trim ring (and or reflector) the trim ring can be pulled away from the ceiling 3” or 4”, allowing you to reach in, pinch the two “legs of the V” and release the spring, trim ring and reflector from the recessed housing.

1) Once the coil springs (or “V” springs) are removed from the clip on the lighting fixture, the trim ring, reflector, and the springs should easily drop free and can be placed aside.

E) How to remove coil springs: By gently pulling on the spring and a slight twist, maneuver the end of the spring out of the retaining clip. Remove both springs. Quite often this is easily done with your fingers but is made easier with a spring removal tool or sometimes a pair of long nose pliers.



We recommend you store all parts, so that they can be replaced should you ever wish to remove your LightSpeaker®, for example when taking them with you during a move.



Tech Support: 1-800-KLIPSCH



Where to put the transmitter?

Typically, the perfect place for your transmitter is near your home entertainment system, if you have one. If you don't have a home audio system then you can choose a place that is centrally located to the rooms you will be transmitting the audio to. Remember the range of the system is approximately 50' radius circle of the transmitter, so as long as the distance from the transmitter to the farthest speaker in any direction is less than 50', the placement of the transmitter is up to you.

Note: There is a maximum of two transmitters in one home and they need to be 25' apart.

Attaching the remote wall bracket

- 1)** Identify where on the wall you want the remote to hang.
- 2)** Place the remote in this position and mark a small line in pencil where the top of the hanging bracket on the remote hits the wall.
- 3)** Mount the Remote Wall Hanging Bracket to the wall using the two (2) supplied screws.
- 4)** You are now ready to use the Wall Hanging Bracket to keep your remote in an easily accessible position as you enter or exit a room.



Tech Support: 1-800-KLIPSCH



Selecting LightSpeaker® Locations

Survey your home to determine the location of 5" and 6" recessed lighting fixtures. As long as these are wired to the home's electricity through a common light switch, they should work perfectly. If you have multiple locations within one room, try to space the speakers as far as part as possible, this will provide the best stereo image and the best sound. In general, the maximum spacing of the speakers is determined by ceiling height. Using the table below, try to space speakers at the distances stated or closer together. If you cannot place them closer than the recommended maximum spacing, do not worry, your sound quality will still be good. In some large rooms you may need more than one pair of speakers.

Ceiling Height	Recommended Max Speaker Spacing
8'	8'
10'	13'
12'	20'
14' & higher	25'

NOTE: There are no direct controls for the sources. From the remote we cannot turn them on or off or control what they are playing.



Tech Support: 1-800-KLIPSCH



To illustrate how the Transmitter and Remote work, here are a few examples:

To play Source 1 in Zone 1

Press Zone 1

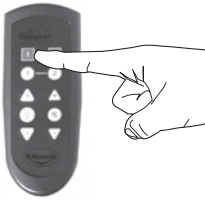

Press Source 1



To play Source 2 in Zone 1 after the source 1 is playing

Press Zone 1



Press Source 2



To play Source 2 in Zone 2

Press Zone 2

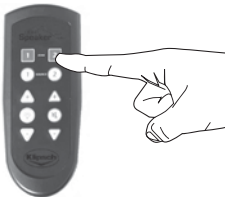

Press Source 2





Tech Support: 1-800-KLIPSCH

To play Source 1 in Zone 2 after already playing source 2

Press Zone 2



Press Source 1



To turn off lights in Zone 1

Press Zone 1

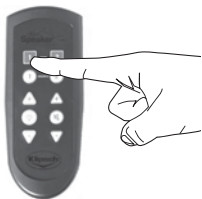

Press light button once



To Dim/Brighten
lights in Zone 1

Press Zone 1

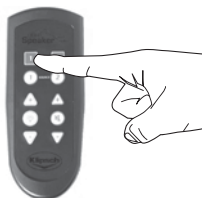

Press light button up arrow and hold it, the light will increase in brightness, and when the light is at the level you want, release the button. When you reach maximum brightness the lighting LED will flash quickly. To decrease the brightness press the light button down arrow and hold till the desired brightness is reached.



Remember: First Zone, then Action and you will be able to use the Remote and Transmitter functions intuitively.



Tech Support: 1-800-KLIPSCH



Specifications

LED Light

- 10W super bright LED provides a sharp crisp light that is easy on the eyes.
- LED outputs the light suitable to replace up to a 65W incandescent bulb
- Long Lasting LED is rated for over 25,000 to 40,000 hours of use (15 to 20 years average use)
- LED Light is fully dimmable and is controlled from either the remote or the light button on the transmitter

Wireless Transmitter

Receives a 2.4 GHz wireless stereo signal broadcast from the Transmitter and depending on the zone assigned to the speaker and the left or right audio channel selected, the receiver sends the correct signal to each LightSpeakers® on-board digital amplifier.

Digital Amplifier & Switch Mode Power Supply

- The E26 standard Edison Screw allows the unit to attach to any standard light fixture socket.
- The high efficiency switch mode power supply delivers power to the LED and the digital amplifier without generating a lot of heat.
- 20W high performance low distortion digital amplifier provides energy efficient sound
- The on-board Digital Signal Processing delivers customized audio to each LightSpeaker® giving big speaker sound in a small speaker.



Tech Support: 1-800-KLIPSCH



Loud Speaker

- 3.125" high performance custom engineered woofer with Micro Cellulose Polymer treated cone material provides even coverage and smooth natural sounding audio reproduction
- Integrated high frequency disperser.

Accessories

- Optional flange allows LightSpeaker® to fit into either 5" (R30) or 6" (R40) recessed lighting fixtures.
- Frosted Lens is acoustically transparent

Transmitter

- 2 sets of RCA or 3.5mm stereo jack line level audio inputs allows 2 separate sources to be used
- Wireless simultaneous transmission to two separate zones of loudspeakers
- Controls LED light in each zone independently
- Controls Audio level and source in each zone independently
- Simple front panel controls allow easy adjustment of the speakers' sound
- Wireless transmitter can send audio to loudspeakers 50' to 100' in any direction

Accessories

- RF remote allows control of sound 50' to 100' away from transmitter depending on the environment
- RF Remote allows selection of zone and source which allows you to adjust audio in each zone
- DC power supply for transmitter



Tech Support: 1-800-KLIPSCH



5" LightSpeaker® Specifications

Woofer 3.125" Micro Cellulose

Light Brightness 10W LED

Wireless Reception 2.4 GHz proprietary signal

Frequency Response (+/- 3 dB) 90 Hz - 20 kHz

Amplifier Power 20W

Max SPL 93 dB SPL

Dimensions

LightSpeaker® depth (w/out Edison Screw) 5.3" (135.3 mm)

LightSpeaker® diameter (without Flange) 5.1" (130.0 mm)

LightSpeaker® diameter (with Flange) 7.2" (182.8 mm)

Depth without socket - no lens 5.5" (140.0 mm)

Depth with Socket - no lens 6.6" (167.2 mm)

Depth without socket with lens 6.1" (153.8 mm)

Depth with Socket with lens 7.1" (181.0 mm)

OD of 6" Flange 7.6" (192.0 mm)

OD of 5" Flange 6.7" (171.2 mm)

Weight 2.51 lbs (1.14 kg)

Transmitter & Remote Specifications

Transmitter Sources 2

Discrete Transmitter Zones 2

Audio Transmission Frequency 2.4 GHz proprietary

RF Remote Transmission Frequency 908 Mhz

Audio Transmitter range (omni-directional) 50' to 100'
depending on environment

RF Remote range (omni-directional) 50' to 100'
depending on environment

AC Power 90 VAC to 240 VAC

Dimensions

Transmitter 5.9" (151 mm) W x 7" (177 mm) L x 2.4" (60 mm) H

Remote: 2" (52 mm) W x 5.1" (130 mm) L x 1.2" (30 mm) H



Tech Support: 1-800-KLIPSCH



Possible causes of interference with your LightSpeaker® System

- A)** Metal studs, in fact any metal wall material, can cause the signal to be diminished or lost. This may also be a problem if your wall paper happens to be a foil type or have metal fibers in it.
- B)** Microwave ovens, when operating, may degrade or interrupt the signal from your transmitter. Usually this will only be a problem for those speakers in close proximity to the microwave. For best results, do not locate the transmitter near your microwave.
- C)** Certain portable phones operating in the 2.4 Ghz range, wireless computer routers, and other consumer electronics and toys using 2.4 Ghz may cause interference when operated too close to either the transmitter or the speakers.



Tech Support: 1-800-KLIPSCH



Troubleshooting the Remote

If your remote does not operate when any of the buttons are pushed:

A) Check the batteries to be certain that they have a charge. Replace them if necessary.

The remote may need to be paired to the transmitter.
To pair the transmitter:

A) Press the pairing button on the back of the transmitter. Five lights on the transmitter keypad (Zone 1, Zone 2, Source 1, Source 2 and the pairing light in the front) will light up and begin flashing;

B) Stand 2' - 4' away from the transmitter with the remote. Press and hold the Zone 2 key on the remote for about 4 seconds. All lights will stop flashing, then pairing is complete. In the event this does not work, try again, beginning at Step A.

If the remote still does not operate, try pairing one more time or contact us at www.Klipsch.com.



Tech Support: 1-800-KLIPSCH



Warranty - Home and Commercial Audio (U.S.)

The Warranty below is valid only for sales to consumers in the United States.

KLIPSCH, LLC ("KLIPSCH") warrants this product to be free from defects in materials and workmanship (subject to the terms set forth below) for a period of two (2) years from the date of purchase for the LED light and one (1) year from the date of purchase for the rest of the components. During the Warranty period, KLIPSCH will repair or replace (at KLIPSCH's option) this product or any defective parts (excluding electronics and amplifiers). For products that have electronics or amplifiers, the Warranty on those parts is for a period of one (1) year from the date of purchase.

To obtain Warranty service, please contact the KLIPSCH authorized dealer from which you purchased this product. If your dealer is not equipped to perform the repair of your KLIPSCH product, it can be returned, freight paid, to KLIPSCH for repair. Please call KLIPSCH at 1-800-KLIPSCH for instructions. You will need to ship this product in either its original packaging or packaging affording an equal degree of protection.

Proof of purchase in the form of a bill of sale or receipted invoice from an authorized dealer, which is evidence that this product is within the Warranty period, must be presented or included to obtain Warranty service.

This Warranty is invalid if (a) the factory-applied serial number has been altered or removed from this product or (b) this product was not purchased from a KLIPSCH authorized dealer. You may call 1-800-KLIPSCH to confirm that you have an unaltered serial number and/or you purchased from a KLIPSCH authorized dealer.

This Warranty is only valid for the original purchaser and will automatically terminate prior to expiration if this product is sold or otherwise transferred to another party.

This Warranty does not cover cosmetic damage or damage due to misuse, abuse, negligence, acts of God, accident, commercial use or modification of, or to any part of, the product. This Warranty does not cover damage due to improper operation, maintenance or installation, or attempted repair by anyone other than KLIPSCH or a KLIPSCH dealer which is authorized to do KLIPSCH warranty work. Any unauthorized repairs will void this Warranty.



Tech Support: 1-800-KLIPSCH

This Warranty does not cover product sold AS IS or WITH ALL FAULTS.

REPAIRS OR REPLACEMENTS AS PROVIDED UNDER THIS WARRANTY ARE THE EXCLUSIVE REMEDY OF THE CONSUMER. KLIPSCH SHALL NOT BE LIABLE FOR ANY INCIDENTAL OR CONSEQUENTIAL DAMAGES FOR BREACH OF ANY EXPRESS OR IMPLIED WARRANTY ON THIS PRODUCT. EXCEPT TO THE EXTENT PROHIBITED BY LAW, THIS WARRANTY IS EXCLUSIVE AND IN LIEU OF ALL OTHER EXPRESS AND IMPLIED WARRANTIES WHATSOEVER, INCLUDING BUT NOT LIMITED TO, THE WARRANTY OF MERCHANTABILITY AND FITNESS FOR A PRACTICAL PURPOSE.

Some states do not allow the exclusion or limitation of incidental or consequential damages or implied warranties so the above exclusions may not apply to you. This Warranty gives you specific legal rights, and you may have other rights, which vary from state to state.

OUTSIDE THE UNITED STATES AND CANADA

The warranty on this product if it is sold to a consumer outside of the United States or Canada shall comply with applicable law and shall be the sole responsibility of the distributor that supplied this product. To obtain any applicable warranty service, please contact the dealer from which you purchased this product, or the distributor that supplied this product.

Questions? Call us!

Have a question about your Klipsch speakers? Talk to the people who know them best! We're waiting to hear from you!

1-800-KLIPSCH

Email us!

If you prefer, your questions and comments can be submitted by email, too; you can count on rapid response and clear, concise answers.

support@klipsch.com

WRITE THE PART NUMBER AND SERIAL NUMBER FROM YOUR PRODUCT BOX HERE AND RETAIN FOR PRODUCT REGISTRATION

Part Number: _____

Serial Number: _____

**Register your product online
at www.klipsch.com/register.**



Tech Support: 1-800-KLIPSCH



THIS DEVICE COMPLIES WITH FCC RULES PART 15.

Operation is subject to the following two conditions:

- (1) this device may not cause harmful interference and
- (2) This device must accept any interference received including that may cause undesired operation.

This equipment has been tested and found to comply with the limits for a Class B digital device, pursuant to Part 15 of the FCC Rules. These limits are designed to provide reasonable protection against harmful interference in a residential installation. This equipment generates, uses and can radiate radio frequency energy and, if not installed and used in accordance with the instructions, may cause harmful interference to radio communications. However, there is no guarantee that interference will not occur in a particular installation. If this equipment does cause harmful interference to radio or television reception, which can be determined by turning the equipment off and on, the user is encouraged to try to correct the interference by one or more of the following measures:

- Reorient or relocate the receiving antenna.
- Increase the separation between the equipment and receiver.
- Connect the equipment into an outlet on a circuit different from that to which the receiver is connected.
- Consult the dealer or an experienced radio/TV technician for help.

THIS DEVICE COMPLIES WITH THE CANADIAN ICES-003 CLASS B SPECIFICATION

CET APPAREIL EST CONFORME AVEC LE CIEM-003 DU CANADA CLASSE B SPÉCIFICATION

CAUTION:

Changes or modifications not expressly approved by the party responsible for compliance could void the user's authority to operate the equipment

ATTENTION:

Les changements ou modifications non expressément approuvés par la partie responsable de la conformité pourraient annuler l'autorité de l'utilisateur à faire fonctionner l'équipement



Tech Support: 1-800-KLIPSCH

FCC RF Exposure Warning

This equipment complies with FCC RF radiation exposure limits set forth an uncontrolled environment. This equipment should be installed and operated with a minimum distance of 20 centimeters between the radiator and your body. This transmitter must not be co-located or operating in conjunction with any other antenna or transmitter

CAUTION:

Changes or modifications not expressly approved by the party responsible for compliance could void the user's authority to operate the equipment

ATTENTION:

Les changements ou modifications non expressément approuvés par la partie responsable de la conformité pourraient annuler l'autorité de l'utilisateur à faire fonctionner l'équipement This device has been designed to operate with the antennas listed below, and having a maximum gain of [1.1]dB. Antennas not included in this list or having a gain greater than [1.1] dB are strictly prohibited for use with this device. The required antenna impedance is [50] ohms.

(1) this device may not cause interference, and

(2) this device must accept any interference, including interference that may cause undesired operation of the device. To reduce potential radio interference to other users, the antenna type and its gain should be so chosen that the equivalent isotropically radiated power (e.i.r.p.) is not more than that permitted for successful communication.



Tech Support: 1-800-KLIPSCH



NOTES:



Tech Support: 1-800-KLIPSCH



NOTES:



LIGHT[®] Speaker

Klipsch Worldwide Corporate Headquarters
3502 Woodview Trace, Suite 200
Indianapolis, IN 46268

For more detailed installation instructions go to
www.klipsch.com

Klipsch Technical Support
Toll Free: 1-800-KLIPSCH (1-800-554-7724)
Monday - Friday, 8:00 AM - 5:30 PM EST
E-mail: technicalsupport@klipsch.com

If you want to expand your light and sound system to additional rooms, replace existing lights with LED lights only or enjoy the same music outdoors as well as indoors, visit www.klipsch.com.

Protected under multiple US and or international issued and pending patents



Revision: D
Date: 3/29/10