

Introduction	2
IMPORTANT NOTICE	2
Disclaimer	2
About the Withings U•Scan Reader	2
About the Withings U•Scan System	2
Warnings & safety notice	3
1. The Withings U•Scan System	4
Overview	4
Content of the Withings U•Scan Reader packaging	4
Component names and functions	5
Withings U•Scan Reader	5
Status Light	5
Button	6
2. Setup Process	6
1. Download the Withings App and create a Withings account	7
2. Open your Withings U•Scan Reader	7
3. Charge your Withings U•Scan Reader	8
4. Pair and link your U•Scan Reader	9
5. Cartridge installation	10
6. Toilet installation	11
2. How to perform a urinalysis	14
Measurement Plan	14
a. Using the automatic measurement	15
b. Launching a manual measurement	15
3. Maintenance	16
Cleaning and maintenance	16
Storing the Withings U•Scan System	17
Troubleshooting	18
4. General information	18
Wireless Information	18
Technical specifications	20
European Union - Declaration of Conformity	20
Disposal	21
Warranty	22
Security	22
Equipment symbol description	23

Introduction

IMPORTANT NOTICE

Thank you for choosing Withings U•Scan. Before using Withings U•Scan Reader, review the information in this guide. You may also find this guide online at <https://www.withings.com/guides>. Retain this documentation for future reference. Installation instructions are available within the Quick Start Guide provided alongside this Product Guide. Please contact Withings when in need of assistance for setting up, using, or maintaining the device or to report unexpected operations or events. Any serious incident that has occurred in relation to the Withings U•Scan Reader should be reported to Withings and competent authorities in your country of residence.

Disclaimer

Information in this guide may change without notice.

You will need an iOS (15.0 or higher) or Android (8.0 and higher) tablet or smartphone to install your Withings U•Scan Reader. Thereafter, the device can be used without your mobile device on you, thanks to the Wi-Fi and Bluetooth® connections. While it is possible to launch a measurement without a mobile device, the use of a mobile device is required for the installation of the Withings U•Scan Reader, and to synchronize and consult your results.

About the Withings U•Scan Reader

The Withings U•Scan Reader is an automatic at-home urine analyzer. Used in conjunction with Withings U•Scan Cartridges, it is intended to be used for tracking levels of a variety of urinary parameters.

Measurement results are displayed in the Withings App.

About the Withings U•Scan System

In order to use the Withings U•Scan System, you need to have the Withings U•Scan Reader and a Withings U•Scan Cartridge.

Then, you must create an account on the Withings App. Once you have installed the Withings App and created your account, you will need to connect/pair your device via Bluetooth. Once

the device is connected, please follow the installation instructions. Please refer to the “Setup Process” section for details on how to accomplish the steps above.

The Withings U•Scan Reader is equipped with Bluetooth Low Energy (BLE) and Wi-Fi connectivity. The test results are transmitted by Wi-Fi, as a result, the Withings U•Scan Reader cannot be used without a functional Wi-Fi connection.

Warnings & safety notice

Before using this equipment, be sure to read this manual carefully.

Withings U•Scan Reader is not a medical device and is not intended for use in the diagnosis, treatment, or monitoring of any control of disease or medical condition.

Self-diagnosis and self-treatment can be dangerous. Always consult your doctor in case of questions or doubts.

- Withings U•Scan Reader is only compatible with Withings U•Scan Cartridges.
- The data provided is for informational purposes only and is not intended to replace traditional diagnostic methods.
- This device is intended for adults only.
- Samples to be used with the Withings U•Scan Reader device are exclusively human urine.
- Do not use Withings U•Scan Reader if it is damaged. The use of a damaged device could cause injury or equipment failure.
- Do not try to repair or modify this equipment yourself. Do not open or disassemble the device for battery replacement.
- Follow the cleaning and maintenance instructions provided in this guide. Use of cleaning agents other than those specified in this manual may damage the device.
- The power cord of the charger may cause strangulation due to excessive length. Keep it away from children and pets.
- Follow the operational and storage conditions indicated in the technical specifications section of this manual. Otherwise, measurement accuracy may be impacted.
- Do not use accessories, detachable parts, or materials that are not described in this guide. Use of parts and components other than those specified or provided by Withings could result in increased electromagnetic emissions or decreased electromagnetic immunity of this equipment and result in improper operation. To recharge the battery, use the provided power cord.
- Do not conduct a test when the Withings U•Scan Reader is charging.
- Do not conduct a test when the Withings U•Scan Reader is not properly closed.
- Do not conduct tests while having periods. Blood might contaminate the fluidic circuit.
- Certain substances or intakes can affect the accuracy of the results, so please refer to the Withings U•Scan Cartridge instruction manual.
- Do not expose the Withings U•Scan Reader to strong impact or vibrations (ie: dropping or shaking).

1. The Withings U•Scan System

Overview

Content of the Withings U•Scan Reader packaging

The Withings U•Scan Reader packaging includes the following components. If something is missing, please contact support.withings.com

U-SCAN READER Box content



Withings U-Scan Reader



Toilet Clip (sizes: S, M, L)



Quick start guide
and product guide

U-SCAN CARTRIDGE Box content



Withings U-Scan Cartridge



Protective gloves



Cleanser powder



Product guide

U-SCAN STATION Box content



Withings U-Scan Station



USB-C Power cable

Component names and functions

Withings U•Scan Reader

YOUR U-SCAN

VOTRE U-SCAN | IHR U-SCAN



BACK VIEW

VUE ARRIÈRE | RÜCKANSICHT

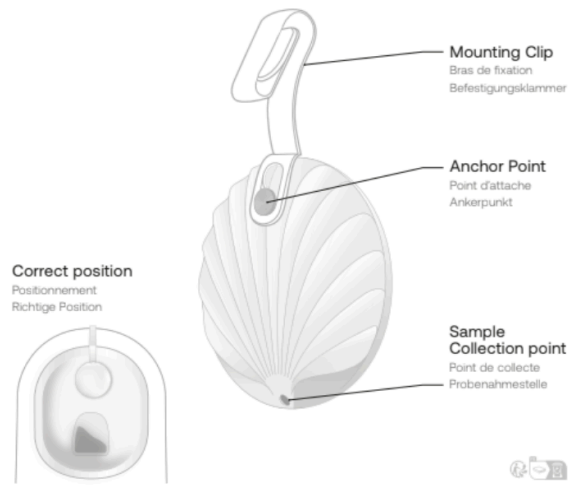

Status Light

Blue breathing ~ Waiting for App installation

Blue continuous — Installation ongoing

Red continuous — Error

Green blinking ... Synchronization

Green continuous — Success

Orange blinking ... Low battery

Manual Launch

Green slow blinking  Ready to collect

Green continuous for 20s  Measurement ongoing

Charge (when plugged)

Orange continuous  Battery charging

Green continuous  Battery charged

Button

Here are the possible actions, 1 second equals one led flash on the device:

1-Second press: Wake up, press the button, led flashes green

5-Second press: Restart, press the button until led turns orange (5 seconds)

10-Second press: Factory reset, press the button until the led turns red (10 seconds)

15-Second press: No action, led turned off again

2. Setup Process

1. Download the Withings App and create a Withings account

Download and install the Withings App on your phone before the first use. Follow the on-screen instructions to (1) sign in with your existing Withings account or (2) create a new Withings account.



2. Open your Withings U•Scan Reader

To open the Reader, hold it between your two palms with the smooth side facing up, press and rotate the cover in a counterclockwise direction with your upper palm.

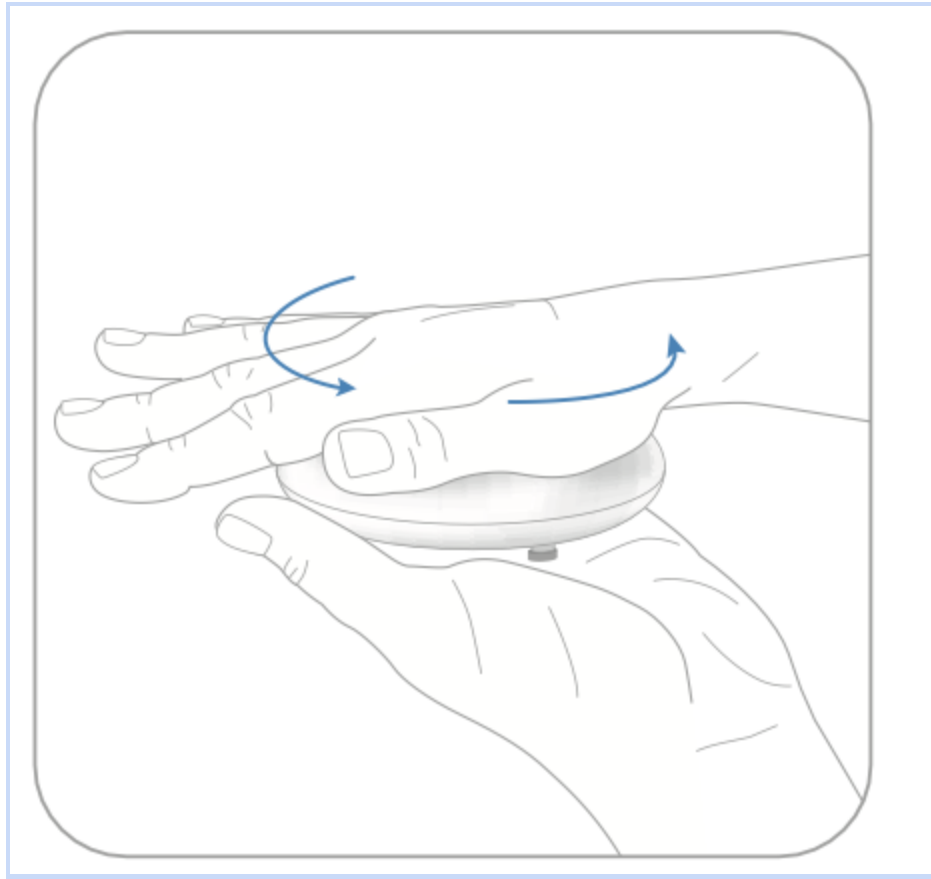

3. Charge your Withings U•Scan Reader

To charge the Reader, first plug in the U•Scan station with the supplied USB-C cable and follow these steps:

1. Place the U•Scan inside of the U•Scan station,
 - a. The sample collection point should face downward with the shell side aligned with the charging wall of the U•Scan station
2. Close the U•Scan station.
3. The status light will turn orange as it charges and you will receive a notification once your device is fully charged.

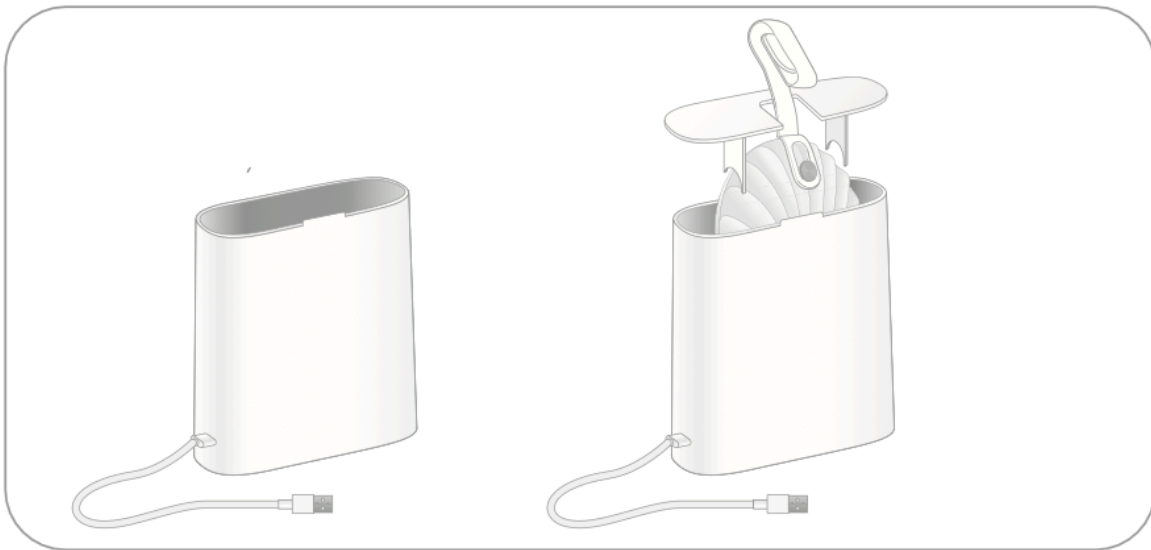

4. Pair and link your U•Scan Reader

Once connected to your Withings account, you must install your device via the Withings App.

To install your device, follow these steps:

1. Open the Withings App.
2. Go to the Devices tab and click on the “+” icon in the top right corner.
3. Tap U•Scan and then “Install.”
4. The status light of your device will start to glow blue when the device is ready to connect with your phone.
5. The Withings App will search for your device via Bluetooth and once it is found, you will be offered to pair your Withings U•Scan Reader with your mobile device.
6. Tap “Accept” to pair your device.
The status light will turn solid blue when the device is connected.
7. Once you have agreed to pair the Withings U•Scan Reader, it will update its internal firmware. Wait for the update to complete and you will then be prompted to connect your device to your Wi-Fi network.

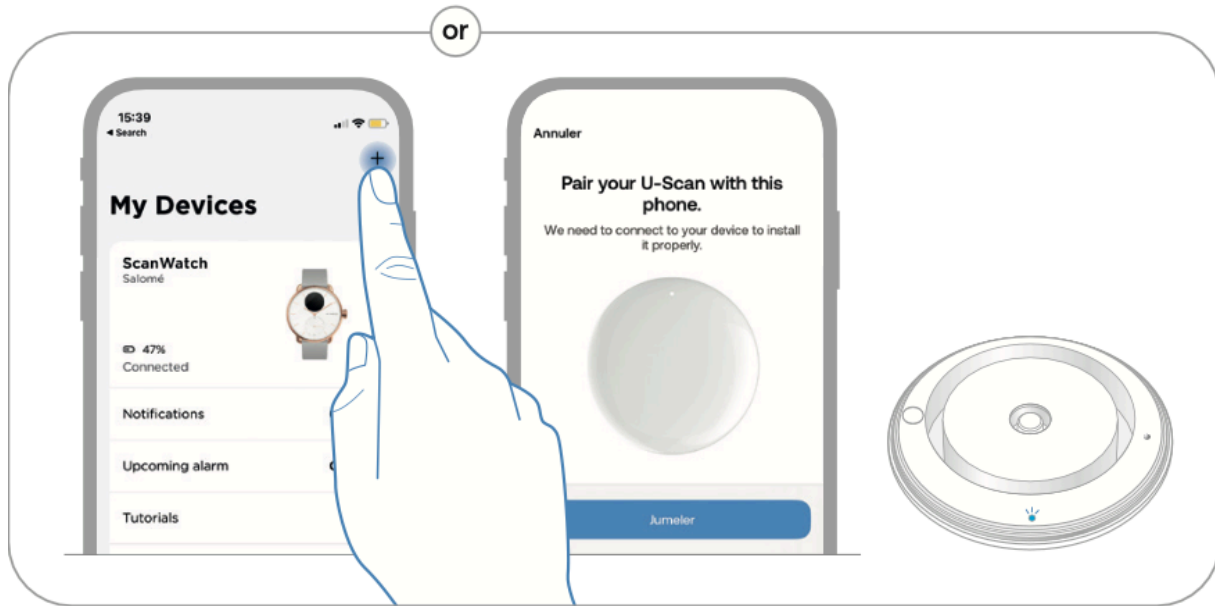

5. Cartridge installation

To install the Cartridge, follow these steps:

1. Open the Withings U•Scan Reader.
2. Remove your Withings U•Scan Cartridge from its packaging and insert the Cartridge into the Reader.
3. While gently pushing down, rotate the Cartridge in either direction until you feel it lock in place with the Reader.

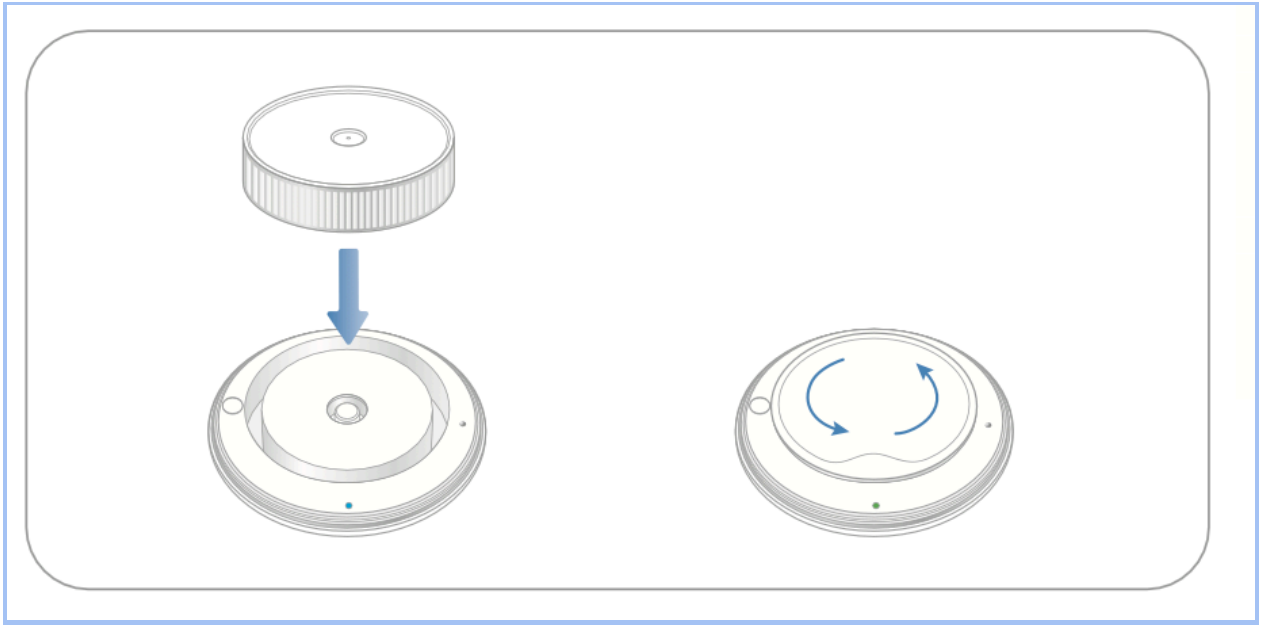

4. The status light will change from blue to green to confirm that the Cartridge has been activated and ready to use.
5. To close the device, hold it in your palm with the smooth side facing up and turn the Reader cover clockwise.

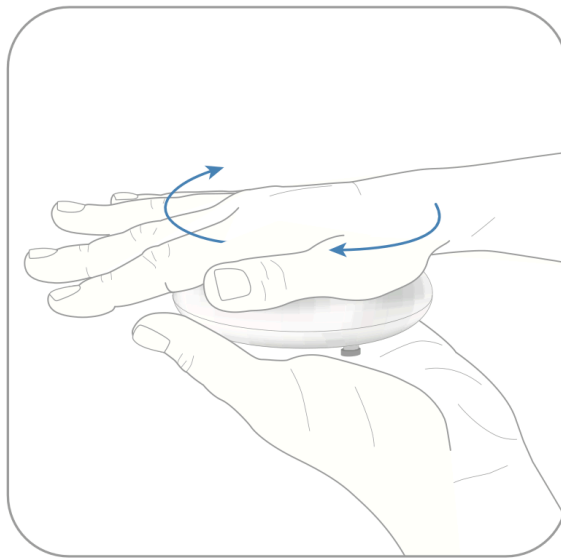

6. Toilet installation

To install the U•Scan with your toilet, follow these steps:

1. Hold the Withings U•Scan Reader in your palm, with the smooth side facing up and the metal anchor point facing inward.

2. Close the device by turning the Reader cover clockwise.
The Withings U•Scan Cartridge is now properly installed in the Reader.

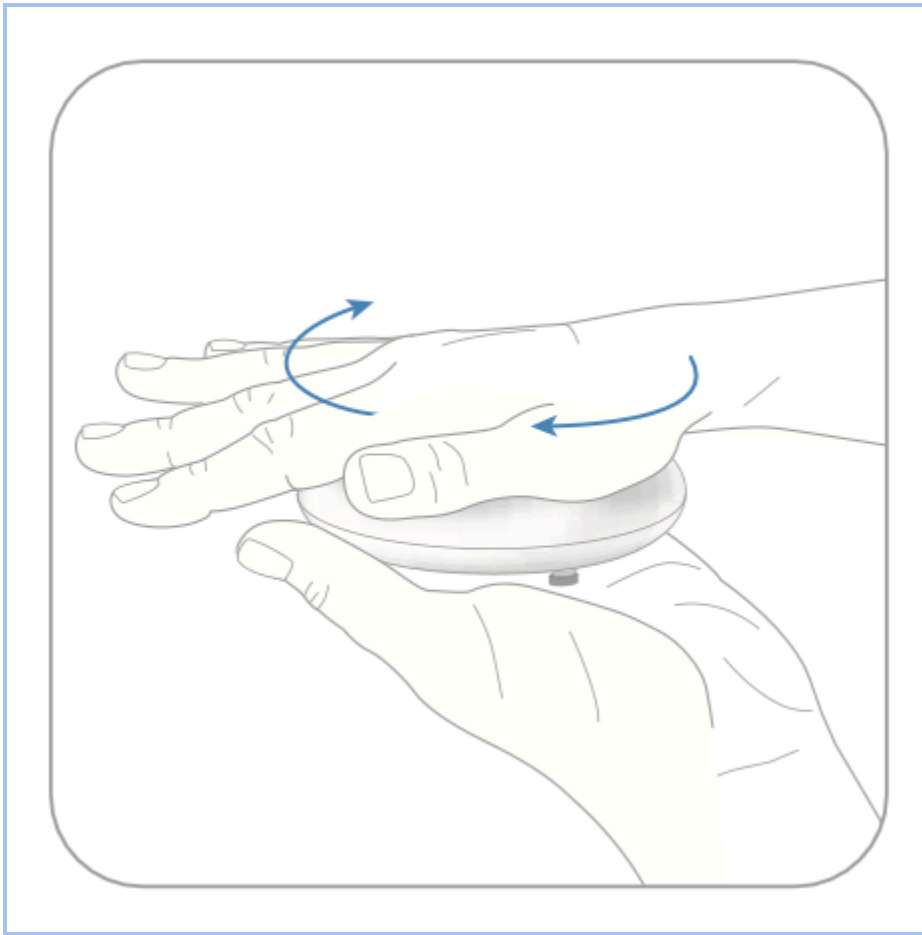

3. The Withings App will ask you what type of toilet you have. This information will allow you to define which size toilet clip you will have to use.

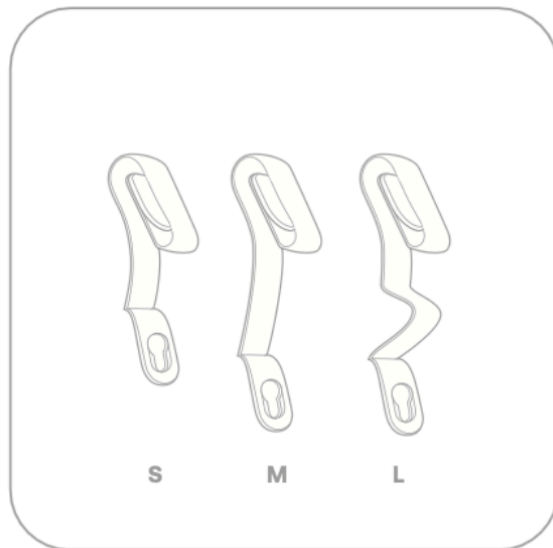

4. Attach the toilet clip to the metal anchor point by sliding the anchor point into the smaller slot of the clip to ensure a secure fit. If the device doesn't slide then the clip is facing the wrong direction.

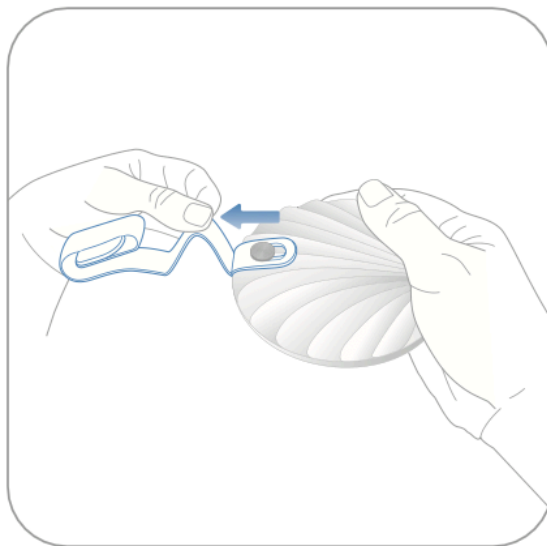

5. Once the toilet clip has been correctly attached, lift up the toilet seat and attach the clip to the front/center of the toilet rim.



2. How to perform a urinalysis

Measurement Plan

Upon purchasing the Withings U•Scan Reader, you will gain access to various subscription models that determine the frequency of measurements you can perform each week.

During the onboarding process, you will be prompted to complete your U•Scan Health Profile. This allows the Withings U•Scan to better understand your health and lifestyle, which will assist you in achieving your health goals. Depending on the Cartridge you are using and your Health Goal, we will suggest you perform measurements on specific days of the week and specific times of the day. Some tests will need to be carried out as soon as you wake up or at the end of the day after your last meal.

Using your habits information and the information you provide on your Health Profile, a personalized measurement plan will be created to best respond to your needs. The frequency of the measurements to perform per week has been designed to perfectly match the frequency of Cartridge delivery so you never miss a measurement.

We recommend adhering to the measurement plan provided in the Withings App. Nevertheless, you will still have the flexibility to launch manual measurements outside of your prescribed plan.

There are two different ways to launch a measurement with the Withings U•Scan System: automatic and manual. You will receive the results 20 minutes after the end of the sample collection for either measurement method. Depending on your results, nutritional and exercise-related advice will be available to you in the App in order to improve your routine.

a. Using the automatic measurement

When you choose the automatic measurement option, the U•Scan will activate to receive a sample based on the measurement windows that you have chosen in the app. The mode can be activated either at the end of the Cartridge installation process or in the settings of your device in the Withings App.

U•Scan samples will be collected only during the measurement windows chosen in your measurement plan. Make sure that you are aware of these measurement windows before using the toilet to collect a sample. If you are unsure, please check the Withings App to view the details of your measurement windows.

Please note that the U•Scan's automatic measurement can distinguish between two individuals of opposite sexes based on differences in urine stream patterns. Therefore, we recommend not using this mode if you share your toilet with someone of the same sex.

b. Launching a manual measurement

We recommend that U•Scan measurements be taken during the measurement windows chosen in your Measurement Plan, but you always have the option to launch a manual measurement at any given time. Please note that, by launching the manual measurement, you will cancel the next measurement window scheduled on the same day. The schedule will resume as normal after the next measurement window is skipped.

To manually launch a measurement, follow these steps:

1. Open the Withings App.
2. Tap your U•Scan Mission card on the Home tab.
3. Select "Launch Measurement."

Make sure that you keep your mobile device close to the Withings U•Scan Reader during this process.

4. Once the Reader is found via Bluetooth, confirm your selection of tests and proceed to urinate.
5. When you start a manual measurement, your device will be able to collect a test sample for a maximum window of 5 minutes. The status light will be green **continuously** while waiting for the test sample and turn green **blinking** while it is performing the measurement.

3. Maintenance

Cleaning and maintenance

Warning:

Please only use mild soap, water, and the cleaning solution provided with the Cartridge to clean the U•Scan. Do not apply any other cleaning products, as they may affect the U•Scan's lifespan and accuracy. Be cautious when cleaning the toilet bowl to avoid accidentally applying any unwanted cleaning products to the U•Scan.

How to daily clean Withings U•Scan Reader

Daily cleaning

- The device surface is designed to be rinsed with each toilet flush.
- If necessary, you can clean the device with a mild soap. Please avoid any products containing bleach, as they **will** deteriorate your device.

Deep cleaning

Deep cleaning of the device is highly recommended and will be suggested by the app after 3 months of use and before each cartridge change. To deep clean your Withings U•Scan, follow the cleaning device process from your app:

1. Use the U•Scan arm fixation to remove the device from the toilets.
2. Put the provided cleaning detergent* from the pouch and $\frac{2}{3}$ cup (150mL) of water inside the U•Scan station, according to the level line drawn in the station.
3. Plug in the U•Scan station.
4. Place the U•Scan Reader with the right position in the U•Scan station for 5 hours for it to be cleaned (see picture).
5. Take out the U•Scan reader, rinse it under running water for 10 seconds. You should hear the device pumping.

6. Dry it with a kitchen or paper towel. Be careful not to use paper toilets, which may block the pumping inlet.
7. Follow the instructions to change the cartridge if necessary.
8. Place the device back in the toilets.

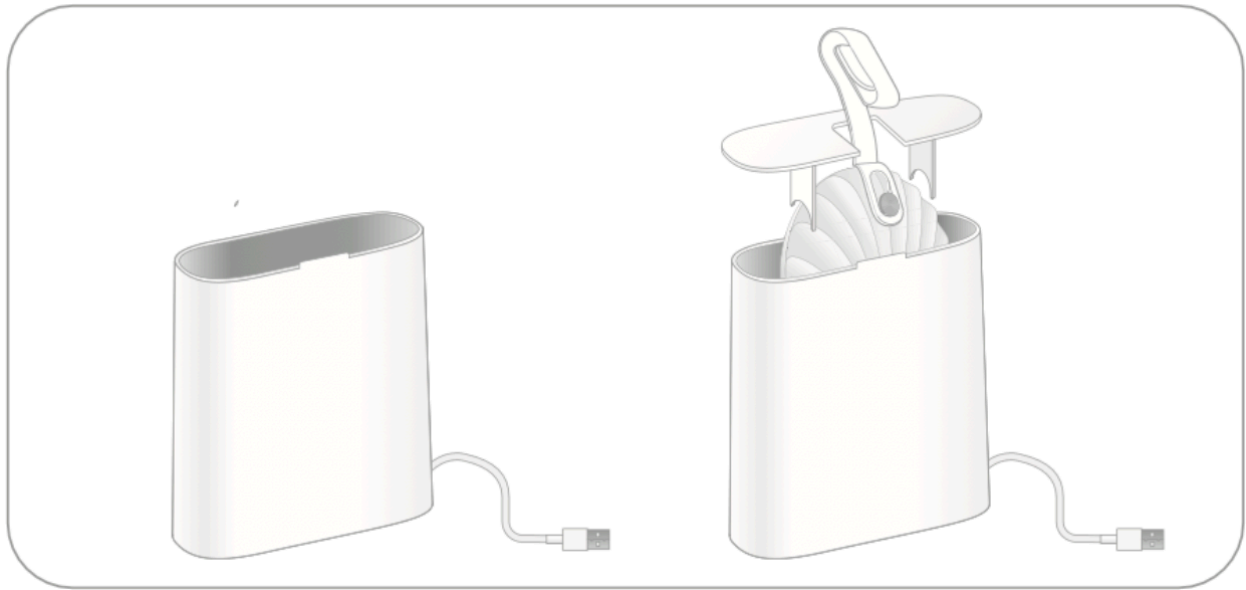

Storing the Withings U•Scan System

Please follow the deep cleaning instructions provided in your app before storing the device. After completing the deep cleaning process with the U•Scan station, rinse your product under running water for 10 seconds. Ten minutes later, the device will purge the rinsing water, after this step you will be able to store the U•Scan according to the storage conditions - in a dry place and out of direct sunlight.

Troubleshooting

If you cannot fix the problem using the following troubleshooting instructions, please contact Withings or visit: withings.com/support.

Problem	Solution
WiFi does not seem to work	Device is out of range from the Wi-Fi source. Please get your smartphone and device closer to your Wi-Fi source.
Arm fixture does not fit my toilet	3 different sizes of arms fixtures are provided. Try a different size if the one selected does not seem correct.
Bluetooth does not seem to work	Smartphone is out of range. Please bring your smartphone closer to your device. Smartphone's Bluetooth is OFF. Please switch your smartphone's Bluetooth ON.
My results seem incorrect.	Your results may vary depending on the medication, food or activities you take. See the list of interferences that can affect the results.
The device does not detect my urine.	Make sure to urinate on the device. If it is not responding, try to charge your product thanks to the U•Scan Station.
The device does not recognize me.	If Automatic recognition always fail, you might prefer using the manual measurement.
I have missed my testing window.	You can launch a manual measurement or wait until your testing window is open. Your test will be automatically rescheduled.

4. General information

Wireless Information

Mode	Frequency Band (MHz)	Maximum Output Power (dBm)
BT LE	2402-2480	TO BE MEASURED
WLAN	2412-2472	TO BE MEASURED

Wireless Specifications:

Wireless Technology	Bluetooth BLE
Version	Supported BT5.1
Operation Frequency	2402MHz - 2480MHz
Transmission power	-0.65 (max)
Modulation	GFSK
Receiver sensitivity	-96dBm

The wireless communication of the device is supported by BLE and Wi-Fi communication. The communication is encrypted through an exchange of a paired key and established between the device and the Withings Application for BLE and Wi-Fi.

The communication latency between the device and the Withings Application takes less than 10 seconds when the device and the smartphone are less than 16 feet (5 meters) apart.

The communication between the device and the Withings Application is not modified with sources of interference located within 5 meters. Wireless coexistence has been tested in accordance with the following standards:

- ANSI C63.27:2017 and,
- AAMI TIR69:2017

Technical specifications

Product Name	Withings U•Scan Reader
Model	WPA02
Dimension	90 x 32 mm
Weight	110 grams
Power source	Powered by a 3.8 Vdc Lithium-ion battery (use the wireless charging station included) and a DC 5V power adapter with a minimum power of 3W and a maximum power of 5W (not included).
Battery life	3 months battery life after fully charged
Operating Conditions	<ul style="list-style-type: none">- indoor use;- altitude up to 2,000 m;- temperature 5 °C to 40 °C;- maximum relative humidity of 80% for temperatures up to 31 °C decreasing linearly to 50 % relative humidity at 40 °C;
Water and splash resistant	Yes
Storage Conditions	<ul style="list-style-type: none">- Temperature range: -25°C to 70°C- Humidity range: 20% to 90- %Pressure range: 700-1060hPa
Expected product life	2 years
IP protection level	IP46

European Union - Declaration of Conformity

Withings hereby declares that the device Withings U•Scan Reader is in conformity with the essential requirements of applicable EU Directives. The full text of the declaration of conformity can be found at: withings.com/compliance.

Disposal



Actuation of European directive 2012/19/EU, for a reduction in the use of dangerous substances in the electric and electronic devices and for garbage disposal.



The symbol applied on the device or its packaging means that at the end of its useful life, the product must not be disposed of with domestic waste.

At the end of the device's useful life, the user must deliver it to a collection center for electric and electronic garbage, or return it to the retailer when purchasing a new device. Disposing of the product separately prevents possible negative environmental and health consequences deriving from inadequate disposal.

It also allows the recovery of materials it is composed of to save energy and resources and avoid negative effects on the environment and health.

In case of abusive disposal of devices by the user, will be applied administrative endorsements in compliance with current standards. The device and its parts must be disposed of as appropriate, in accordance with national or regional regulations.



Points de collecte sur www.quefairede mesdechets.fr



Need help?

→ withings.com/support

Federal Communication Commission interference statement

FCC ID: XNAWPA02 TO BE MODIFIED

This device complies with part 15 of the FCC Rules. Operation is subject to the following two conditions: (1) This device may not cause harmful interference, and (2) this device must accept any interference received, including interference that may cause undesired operation.

FCC Caution: Changes or modifications not expressly approved by the party responsible for compliance could void the user's authority to operate the equipment.

This equipment has been tested and found to comply with the limits for a Class B digital device, pursuant to part 15 of the FCC Rules. These limits are designed to provide reasonable protection against harmful interference in a residential installation. This equipment generates, uses and can radiate radio frequency energy and, if not installed and used in accordance with the instructions, may cause harmful interference to radio communications. However, there is no guarantee that interference will not occur in a particular installation. If this equipment does cause harmful interference to radio or television reception, which can be determined by turning the equipment off and on, the user is encouraged to try to correct the interference by one or more of the following measures:

- Reorient or relocate the receiving antenna.
- Increase the separation between the equipment and receiver.
- Connect the equipment into an outlet on a circuit different from that to which the receiver is connected.
- Consult the dealer or an experienced radio/TV technician for help.

IMPORTANT NOTE:

Radiation Exposure Statement:

This equipment complies with FCC radiation exposure limits set forth for an uncontrolled environment. This equipment should be installed and operated with a minimum distance of 20 cm between the radiator & your body.

This transmitter must not be co-located or operating in conjunction with any other antenna or transmitter. Country Code selection feature to be disabled for products marketed to the US/CANADA

Warranty

Withings Two (2) Years Limited Warranty - Withings U•Scan Reader

Withings, 2 rue Maurice Hartmann, 92130 Issy-les-Moulineaux, FRANCE (“Withings”) warrants the Withings-branded product (“Withings Product”) against defects in materials and workmanship when used normally in accordance with Withings’ published guidelines for a period of TWO (2) YEARS from the date of original retail purchase by the end-user purchaser (“Warranty Period”). Withings’ published guidelines include, but are not limited to, information contained in this guide or Quick Start Guide. Withings does not warrant that the operation of the Withings Product will be uninterrupted or error-free. Withings is not responsible for damage arising from failure to follow instructions relating to the Withings Product’s use.

AU: Our goods come with guarantees that cannot be excluded under the Australian Consumer Law. You are entitled to a replacement or refund for a major failure and compensation for any other reasonably foreseeable loss or damage. You are also entitled to have the goods repaired or replaced if the goods fail to be of acceptable quality and the failure does not amount to a major failure.

Security

Withings recommends that you add a passcode (personal identification number [PIN]), Face ID or Touch ID (fingerprint) to your phone to add a layer of security. It is important to secure your phone since it will be storing personal health information. Users should follow the password and two-factor authentication guidelines when logging into the Withings App. Users will also receive additional update notifications on the device via the Withings App, and updates are delivered wirelessly, encouraging rapid adoption of the latest security fixes. Users are able to see the currently installed firmware on the Withings App, under Devices > U•Scan. This tab also indicates if an update is available.

Do not install the device on a smartphone that you do not own.





Do not use a public Wi-Fi network you are unfamiliar with. Use a trusted Wi-Fi network with your device.









Withings also recommends upgrading your Withings App when an upgrade is available.

The Withings Mobile App is not intended to be used on a computer. No anti-virus software is needed.

Only use official app stores to download the Withings App. If in doubt, use the link go.withings.com.

Equipment symbol description

	Catalogue number
	Manufacturer
	Unique Device Identifier
	Consult instructions for use or consult electronic instructions for use
	This product complies with the essential requirements of applicable EU Directives

	Humidity limitation
	Temperature limit
	Atmospheric pressure limitation
	Direct Current
	Do not dispose of this product as unsorted municipal waste, take it to electronic recycling.
IP47	Ingress protection rating
	Model Number
	Date of manufacture
	Do not use if the package is damaged and consult instructions for use

	California Energy Commission (CEC) compliant
---	---

AW_IFU_WPA02_ALL_INT_A

Withings U•Scan System | Proactive Health Tracking
2023 Withings. All rights reserved.

Jun. 2023

support.withings.com - 2 rue Maurice Hartmann,
92130 Issy-les-Moulineaux France

WITHINGS