



APOS A8

User Guide



www.ingenico.com
9 avenue de la gare Rovaltain TGV Valence 26958 France

● SEAMLESS PAYMENT

Contents

1_Introduction	4
2_Presentation	5
2.1 Content of the box	5
2.2 Overview of the APOS A8	6
2.3 Keypad Functions	8
2.4 Touch Panel	8
3_Use of the terminal	9
3.1 Power on/Power off the terminal	9
3.2 Readings cards	10
3.3 Usage of Front Camera	11
3.4 Headphone jack and MicroUSB	12
4_Installation	12
4.1 Recommendations	12
4.2 Installing modules	13
4.2.1 SAM1 / SAM2 / SIM	13
4.2.2 MicroSD memory card	14
4.3 Paper roll	15
4.3.1 Main characteristics of ingenico paper roll	15
4.3.2 Installing paper roll	16

● SEAMLESS PAYMENT

4_4	Battery	17
4_4.1	Charging the battery	17
4_4.2	Installing the battery	17
4_5	Visual Impaired Accessory	18
5	Recommendations	19
5_1	Safety	19
5_2	Security of your terminal	24
5_3	Fixed installation	24
5_4	Cleaning the terminal	26
5_5	Transport and storage	26
6	Standard	27
7	Troubleshooting	30

1_Introduction

We hope that you will be fully satisfied with your new APOS A8 terminal.

Read this guide to understand and make the best use of your terminal. It presents you the necessary information about use , installation, maintenance, safety and security recommendations.



WARRANTY / SECURITY/GARANTIE / SÉCURITÉ

Use only the power supply included with the product to ensure best performance and safety. Maintenance should only be provided by Ingenico authorized technician. Failure to comply with these instructions will void the manufacturer's responsibility.

Afin d'assurer les meilleures performances et votre sécurité, utiliser seulement le bloc d'alimentation livré par le fabricant avec le produit. La maintenance doit être réalisée seulement par un technicien agréé et autorisé par Ingenico.

Le non-respect de ces instructions dégage la responsabilité du fabricant.



This symbol indicates there are warnings or cautions need to be checked in the user guide. Ce symbole indique que des avertissements ou des mises en garde doivent être vérifiés dans le manuel de l'utilisateur.



This symbol indicates an important Warning. Ce symbole indique un avertissement important.



This symbol indicates a piece of advice.

● SEAMLESS PAYMENT

2_Presentation

2_1 Content of the box

- > **APOS A8 terminal unit equipped with a paper roll**
- > **Power adapter**
- > **A battery pack**
- > **This user guide**



WARNING/ATTENTION

The power supply unit provided with your equipment is specially designed for ingenico terminals. Do not use any other power supply. The use of a power supply with apparently similar voltage/current characteristics may damage your terminal.

Le bloc d'alimentation fournit avec votre équipement est spécialement conçu pour les terminaux de paiement Ingenico. Ne pas utiliser d'autres sources d'alimentation. L'utilisation d'une alimentation électrique ayant des tensions et courant similaires peut endommager votre équipement.



ADVICE

Keep the packaging. It must be re-used whenever the terminal is shipped.

2_2 Overview of the APOS A8

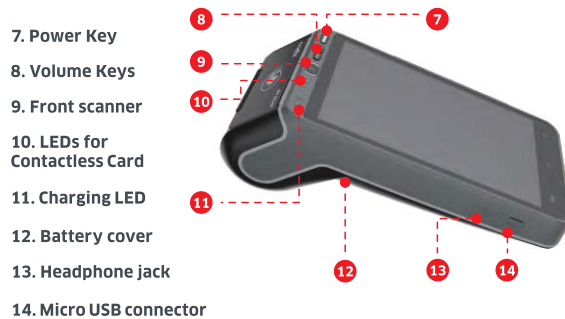

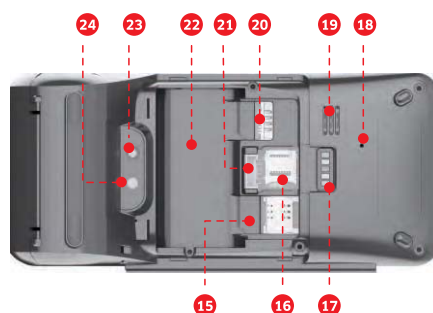

● SEAMLESS PAYMENT



- | | |
|------------------------|-------------------------|
| 15. SIM card slot | 20. SAM cards slots |
| 16. MicroSD slot | 21. Battery socket |
| 17. Extended interface | 22. Battery compartment |
| 18. Buzzer | 23. Flash |
| 19. Speaker | 24. Rear camera |

Weight	473g (including battery)
Dimension (L x W x H)	185mm x 86mm x 64mm
Electrical mains network	100-240VAC/50-60Hz Class II

2_3 Keypad Functions

The terminal has three physical keys at the upper right at the top of the screen, a power button and two volume keys, and three touch keys at the bottom, Menu , Home  and Back  keys.



2_4 Touch Panel

The APOS A8 device is equipped with touch panel that allows you capture functions and menus by your finger or use a stylus.

3_Use of the terminal



ADVICE

Before using the terminal, always check if the roll of paper is present.

3_1 Power on/ Power off the terminal

To power on: Make sure the terminal battery is correctly installed and Press <Power> button for about 1s until the display is turned up.

To power off: Press <Power> button for more than 2s until the display show the following figure, then press <Power off>.

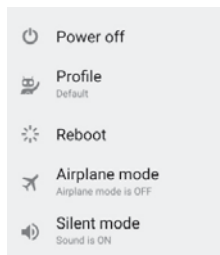

If the battery is empty, the terminal automatically shuts off.

Abnormal power off :

When the device works abnormally, for example, it is crashed and no actions menu popped out while pressing the power button, please long-press the power button for 6s, the device will be automatically powered off.

Screen saver mode :

Short-press the power button for about 0.5s, the terminal display will be turned on or off.

3_2 Reading cards

Magnetic stripe card

The card can be read bi-directionally, with the stripe facing the terminal. Use a regular movement in order to ensure a reliable card reading.



Contactless card

Bring the card firmly up to the active zone.

Keep the card close to the reader during the transaction.

On the front, LEDs are displayed to indicate transaction processing.



Smart card

Insert the card horizontally with the metal chip facing upward and leave in position throughout the transaction.

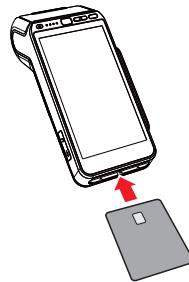

● SEAMLESS PAYMENT

3_3 Usage of Front Camera

- The brightness of the mobile phone must be set to the brightest or not less than 2/3 of the maximum brightness.
- The screen of the mobile phone must face the front scanning head above the terminal screen and keep it stationary.
- The screen of the mobile phone must be parallel to the front scanning head.
- The vertical distance between the screen of the mobile phone and the front scanning head should be between 10~ 30 cm; 20 cm would be the best.
- The terminal will beep with a successful scanning.

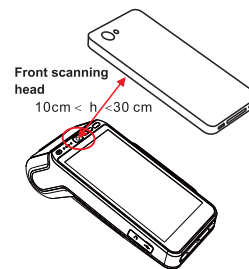

3_4 Headphone jack and Micro USB

There are a 3.5mm headphone jack and a Micro USB connector on the left side of the terminal.

The connector manages Host and Slave connections.

The headphone jack is used for assisting the visual impaired person to entry the pin code.



● SEAMLESS PAYMENT



WARNING/ATTENTION

To prevent possible hearing damage, do not listen at high volume levels for long periods.

Afin d'éviter d'éventuels dommages auditifs, ne pas écouter à des volumes élevées pendant de longues périodes.

4_Installation

4_1 Recommendations

Operating conditions

Ambient temperature*	from -10° C to +50° C
Max relative humidity	from 10% to 90 % , Non-condensing

(*) Excluding battery charging

Battery charging conditions

Ambient temperature	from 0° C to +40° C
---------------------	---------------------

Storage conditions

Ambient temperature*	from -20° C to +70° C
Max relative humidity	from 5% to 90% , Non-condensing

● SEAMLESS PAYMENT

4_2 Installing modules

4_2_1 SAM1 / SAM2 / SIM



WARNING/ATTENTION

Switch off the terminal before opening the trapdoor.
Mettre hors tension le terminal avant d'ouvrir la trappe.

The SAM/SIM connectors are located inside the terminal, in a closed compartment.

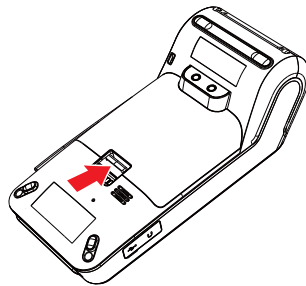

- > Turn the terminal and remove the trapdoor.
- > SAM1 , SAM2 and SIM are identified by the engraved marks on the lower housing.
- > When introducing a SAM / SIM in its slot, be sure to put the cut corner as indicated on the picture.
- > Close the trapdoor.

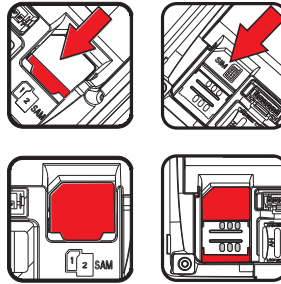

● SEAMLESS PAYMENT



ADVICE

APOS A8 is equipped with a dual SAM slot.

When using two SAM cards, it is recommended to insert the bottom one first, then the top one.

When using only one SAM card, it is recommended to insert SAM1 slot (bottom).



ADVICE

SIM and SAM cards share the same form factor, please do be careful to the SIM card socket position.

4_2_2 MicroSD memory card



WARNING/ATTENTION

Switch off the terminal before opening the trapdoor.
Mettre hors tension le terminal avant d'ouvrir la trappe.

MicroSD connector is located inside the terminal, in a closed compartment.

- > Turn the terminal and remove the trapdoor.
- > MicroSD are identified by the engraved marks on the lower housing.
- > Slide the cover to the right and pull to open it. Insert MicroSD card, push the cover to close and slide it to the left to lock it. Be sure to put the MicroSD contacts downside and the cut corner as indicated on the figure.
- > Close the trapdoor.

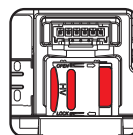
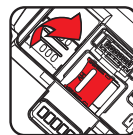

The terminal supports MicroSD up to 32GB.

● SEAMLESS PAYMENT

4_3 Paper roll

4_3_1 Main characteristics of INGENICO paper roll

R40 paper roll characteristics	Precisions
Color	White
Width	58 mm
Diameter	40 mm
Length	About 18 meters

The thermal paper can be deteriorated by poor storage conditions, so we recommend you to avoid:

- > Storage in hot wet places (near air-conditioner, humidity higher than 85%).
- > Exposure to sunlight or ultraviolet for long periods.
- > Contact with organic solvents (solvent type adhesive).
- > Direct contact with materials containing plasticizers (PVC transparent folders or envelopes).
- > Direct contact with « diazo » papers.
- > Direct contact with water
- > Rubbing or pressing the paper too strongly



WARNING/ATTENTION

For best product performance, only use heat sensitized paper approved by Ingenico.

Pour les meilleures performances du produit, utilisez uniquement du papier sensibilisé à la chaleur approuvé par ingenico.

● SEAMLESS PAYMENT

4_3_2 Installing paper roll

- > Open the paper cover by lifting the catch located at the top of APOS A8 and pull the cover to the rear of the terminal.
- > Insert the paper roll in the compartment following the directions shown on the below picture.
- > Pull the paper up to the top of terminal, maintain the paper and close the cover
- > Press simultaneously on both upper corners of the paper flap until it clips into position.

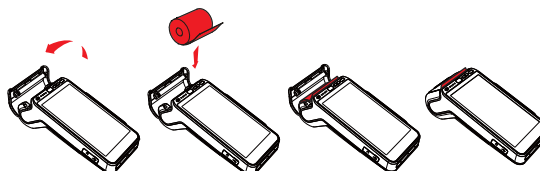

ADVICE

If you insert a new R40 paper roll, tear off the first length (one complete turn to avoid printing on adhesive footprint).



WARNING/ATTENTION

Switch off the terminal prior to installing a paper roll. Use only paper approved by Ingenico. The use of no-approved paper is likely to damage the printer of your terminal.

Mettre hors tension le terminal avant d'installer un rouleau de papier. N'utiliser que du papier approuvé par Ingenico. L'utilisation d'un papier non approuvé par Ingenico peut endommager votre imprimante.

● SEAMLESS PAYMENT

4_4 Battery

4_4_1 Charging the battery

- > When does the battery need to be charged?
 - When used daily, the terminal charges its battery each time the power adapter is connected. Charging starts automatically.
- > How can the battery be charged?

Using the power adaptor

 - Connect the power adapter to the terminal micro USB type A connector located on the left side of the terminal.
 - Connect the power adapter to the power supply mains network.
 - Check if the Red LED at the top of front is lighted (it means battery charging).

4_4_2 Installing the battery



WARNING/ATTENTION

Check that the terminal is not connected to the main electric network.
Vérifier que le terminal n'est pas connecté au secteur.

- > Turn your terminal and unclip the battery trapdoor by pushing the clips as shown with the arrow on the picture.
- > Disengage the trapdoor.
- > Take the battery pack included in the box.
- > Locate the battery pack connector beside the battery compartment.
- > Plug the battery pack connector according to the connector locating system.
- > Place the battery pack in its compartment.

● SEAMLESS PAYMENT

- Close the battery trapdoor.

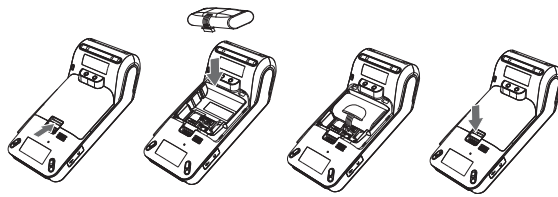

4_5 Visual Impaired Accessory

- 1. Install the VI accessory on the screen.

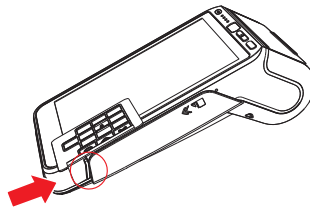

- 2. Take out the VI accessory.

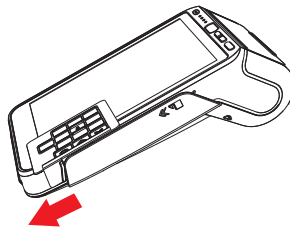

● SEAMLESS PAYMENT

➤ 3. Store the VI accessory.

- ➊ Put the VI accessory flat on the battery .
- ➋ Roll the VI accessory and put in the gap.

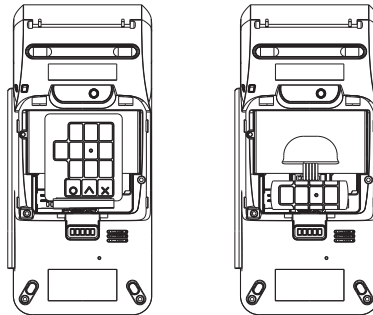

5_Recommendation

5_1 Safety

Powering down the APOS A8

Disconnect the APOS A8 power supply block adapter from the electrical mains network.

Lithium cell

The APOS A8 is fitted with an internal lithium cell which should only be accessed by a qualified technician.

Battery

- APOS A8 is fitted with battery specially designed for this terminal.
- Only use the appropriate chargers and batteries listed in the Ingenico's catalogue.
- Do not short-circuit the battery.
- Do not attempt to open the battery container.
- Used batteries must be disposed of at the appropriated sites.

The lifespan of battery depends on :

- Features used
- Number of charge and discharge cycles
- Use temperature



CAUTION/MISE EN GARDE

RISK OF EXPLOSION BATTERY IS REPLACED BY AN INCORRECT TYPE.
DISPOSE OF USED BATTERIES ACCORDING TO THE INSTRUCTIONS.
Il existe un risque d'explosion, si la batterie est remplacée par une batterie incorrecte.
Recycler les batteries usagées selon les règles en vigueur.

Electrical power supply network

The electrical outlet must meet the following criteria :

- Must be installed near the equipment and easily accessible.
- Do not short-circuit the battery.
- Do not attempt to open the battery container.

● SEAMLESS PAYMENT

The power supply label contains seventeen symbols:



CCC (China Compulsory Certificate) Mark



The Regulatory Compliance Mark (RCM)



International Efficiency Marking Protocol (Energy Star Level 6)



In door use only



“Conformité Européenne” or CE Mark



Double insulation symbol



5 Years China RoHS symbol



10 Years China RoHS symbol



BSMI (Taiwan)



PSE Mark (Japan)

● SEAMLESS PAYMENT



Recycle in accordance with the waste electronic & electrical equipment directive



Underwriters Laboratories Inc (US Compliance)



Made from recyclable material



Low density version of Polyethylene (LDPE)



Chlorinated Polyethylene (CPE)



Risk of explosion if the battery is incorrectly replaced or is placed in a fire



Dispose of batteries at a hazardous waste collection site or recycling facility

SAM1/SAM2/SIM Readers compartment

The trapdoor for battery, SAM1/SAM2/SIM, readers located underneath the terminal, must be in place during the normal operation of the terminal. See sections "Installing modules" and "installing the battery".

On airplanes

Your terminal must be switched off by removing the battery pack. Remove the battery from the terminal when on an airplane.

Non-compliance with these safety rules may result in legal action and/or a ban on later access to cellular network services.

Explosion areas

Some regulations restrict the use of radio equipment in chemical plants, fuel depots and any site where blasting is carried out. You are urged to comply with these regulations. The terminal shall be protected by a specially fitted and certified cover enabling use in proximity to a fuel pump.

Thunderstorm weather

According to some relevant reports, the mobile phone electromagnetic wave is good conductor of lightning. It is much easier to suffer lightning strike when the damp atmosphere from a magnetic conductivity, especially in open areas. Do not use wireless terminals under thunderstorm weather.

Electronic health appliances

Your terminal is a radio transmitter which may interfere with health appliances, such as hearing aids, pacemaker, hospital equipment, etc.

Your doctor or the equipment manufacturer will be able to provide you with appropriate advice.

5.2 Security of your terminal

Your device fulfils current applicable PCI PTS security requirements.

Upon receipt of your terminal you should check for signs of tampering of the equipment. It is strongly advised that these checks are performed regularly after receipt. You should check, for example: that the keypad is firmly in place; that there is no evidence of unusual wires that have been connected to any ports on your terminal or associated equipment, the chip card reader, or any other part of your terminal. Such checks would provide warning of any unauthorized modifications to your terminal, and other suspicious behaviour of individuals that have access to your terminal. Your terminal detects any "tampered state". In this state the terminal will repeatedly flash the message "Warning Detected" and further use of the terminal will not be possible. If you observe the "Warning Detected" message, you should contact the terminal helpdesk immediately.

You are strongly advised to ensure that privileged access to your terminal is only granted to staff that have been independently verified as being trustworthy. The terminal must never be put in or left at a location where it could be stolen or replaced by another device.

5.3 Fixed installation

If the device is to be used in a situation where it is not possible for the cardholder to pick up and shield their PIN entry themselves, the device may be used, but it must be installed in the following manner:

- The device must be angled at 45 or more, so that oversight of the PIN entry from the rear of the device is not possible.
- The device must either be fitted in a swivel stand – so that the customer can position the device in the best angle to prevent oversight – or the device must be fixed in the best possible position to prevent oversight if such a generic position exists in the specific environment to which the device is installed.
- The device environment must be accompanied with conspicuous notices and educational material which informs the customer to shield their PIN during PIN entry.

- The device must be deployed so that oversight from other customers, either in different payment lanes, or in other areas of the shopping environment, is prevented. This may be achieved through the placement of the lanes and device, so that the customer is automatically positioned between the device keypad and other customers. Alternatively, it may be achieved by the environment in which the device is installed, so that the checkout itself shields the PIN entry process.
- The terminal is exclusively made for indoor use.

ADVICE

Positioning of the terminal on check stand must be in such a way to make cardholder PIN (Personal Identification Number) spying infeasible.



Installing device on an adjustable stand must be in such a way that consumers can swivel the terminal sideways and/or tilt it forwards/backwards to a position that makes visual observation of the PIN-entry process difficult.

Positioning of in-store security cameras such that the PIN-entry keypad is not visible.

NEVER ask the customer to divulge their PIN Code. Customers should be advised to ensure that they are not being overlooked when entering their PIN Code.

● SEAMLESS PAYMENT

5_4 Cleaning the terminal

Unplug all the wires from terminal.

Good rules for proper cleaning of the terminal are:

- Use a soft cloth that is very slightly soaked with soapy water to clean the outside of terminal.
- Do not clean the electrical connections.
- Do not use in any case, solvents, detergents or abrasive products: Those materials might damage the plastic or electrical contacts.
- Avoid exposing the terminal to the direct rays of the sun.
- Do not put anything into the slot of the smart card reader.

5.5 Transport and storage

Adopt general transportation mode, and prevent the goods from sunlight, snow, shower and mechanical impact. Transport the devices with care, do not throw it forcibly. Prevent the packaging from extrusion during transportation, to avoid breakage.

The product should be stored in the original packing box. The warehouse is not allowed to have all sorts of harmful gases, inflammable, explosive, corrosive chemical goods, strong mechanical vibration and strong magnetic field. Packing box should be at least 15cm above the ground, and be away from heat, cold, window or air inlet source at least 50cm.

6_Standard

FCC WARNING

This device complies with part 15 of the FCC Rules. Operation is subject to the following two conditions:

- (1) This device may not cause harmful interference, and
- (2) this device must accept any interference received, including interference that may cause undesired operation.

Any Changes or modifications not expressly approved by the party responsible for compliance could void the user's authority to operate the equipment

Note: This equipment has been tested and found to comply with the limits for a Class B digital device, pursuant to part 15 of the FCC Rules. These limits are designed to provide reasonable protection against harmful interference in a residential installation. This equipment generates, uses and can radiate radio frequency energy and, if not installed and used in accordance with the instructions, may cause harmful interference to radio communications. However, there is no guarantee that interference will not occur in a particular installation. If this equipment does cause harmful interference to radio or television reception, which can be determined by turning the equipment off and on, the user is encouraged to try to correct the interference by one or more of the following measures:

- Reorient or relocate the receiving antenna.
- Increase the separation between the equipment and receiver.
- Connect the equipment into an outlet on a circuit different from that to which the receiver is connected.
- Consult the dealer or an experienced radio/TV technician for help.

SAR tests are conducted using standard operating positions accepted by the FCC with the device transmitting at its highest certified power level in

all tested frequency bands, although the SAR is determined at the highest certified power level, the actual SAR level of the device while operating can be well below the maximum value. Before a new device is available for sale to the public, it must be tested and certified to the FCC that it

does not exceed the exposure limit established by the FCC. Tests for each

● SEAMLESS PAYMENT

device are performed in positions and locations as required by the FCC. For handheld worn operation, this device has been tested and meets the FCC RF exposure guidelines when used with an accessory designated for this product or when used with an accessory that contains no metal.

For body worn operation, this device has been tested and meets the FCC RF exposure guidelines when used with an accessory designated for this product or when used with an accessory that Contains no metal and that positions the handset a minimum of 10 mm from the body.

Non - compliance with the above restrictions may result in violation of RF exposure guidelines.

RSS warning

This device complies with ISED licence - exempt RSS standard (s). Operation is subject to the following two conditions: (1) this device may not cause interference, and (2) this device must accept any interference, including interference that may cause undesired operation of the device

Le présent appareil est conforme aux CNR d'ISED applicables aux appareils radio exempts de licence.

L'exploitation est autorisée aux deux conditions suivantes:

- (1) l'appareil ne doit pas produire de brouillage, et
- (2) l'appareil doit accepter tout brouillage radioélectrique subi, même si le brouillage est susceptible d'en compromettre le fonctionnement.

Under Innovation, Science and Economic Development Canada regulations, this radio transmitter may only operate using an antenna of a type and maximum (or lesser) gain approved for the transmitter by Innovation, Science and Economic Development Canada. To reduce potential radio interference to other users, the antenna type and its gain should be so chosen that, the equivalent isotropically radiated power (e.i.r.p.) is not more than that necessary for successful communication.

Conformément à la réglementation ISED, le présent émetteur radio peut fonctionner avec une antenne d'un type et d'un gain maximal (ou inférieur) approuvé pour l'émetteur par Industry Canada. Dans le but de réduire les risques de brouillage radioélectrique à l'intention des autres utilisateurs, il faut choisir le type d'antenne et son gain de sorte que la puissance isotrope rayonnée équivalente (p.i.r.e.) ne dépasse pas l'intensité nécessaire à l'établissement d'une communication satisfaisante.

● SEAMLESS PAYMENT

SAR tests are conducted using standard operating positions accepted by the ISED with the device transmitting at its highest certified power level in all tested frequency bands, although the SAR is determined at the highest certified power level, the actual SAR level of the device while operating can be well below the maximum value. Before a new device is available for sale to the public, it must be tested and certified to the ISED that it does not exceed the exposure limit established by the ISED, tests for each device are performed in positions and locations as required by the ISED.

For body worn operation, this model device has been tested and meets the ISED RF exposure guidelines when used with an accessory designated for this product or when used with an accessory that Contains no metal and that positions the handset a minimum of 10mm from the body.

Non-compliance with the above restrictions may result in violation of RF exposure guidelines.

Les tests SAR sont effectués à l'aide de positions d'exploitation standard acceptées par l'ISED avec la transmission de l'appareil à son niveau de puissance certifié le plus élevé dans toutes les bandes de fréquences testées, bien que le SAR soit déterminé au niveau de puissance certifié le plus élevé, le niveau SAR réel de l'appareil pendant l'exploitation peut être bien inférieur à la valeur maximale, avant qu'un nouvel appareil soit disponible à la vente au public, il doit être testé et certifié à l'ISED qu'il ne dépasse pas la limite d'exposition établie par l'ISED, les tests pour chaque appareil sont effectués dans des positions et des emplacements comme l'exige l'ISED.

Pour le fonctionnement du corps usé, ce dispositif modèle a été testé et répond aux directives d'exposition ISED RF lorsqu'il est utilisé avec un accessoire désigné pour ce produit ou lorsqu'il est utilisé avec un accessoire qui ne contient pas de métal et qui positionne le combiné à un minimum de 10mm de l'organisme.

Le non-respect des restrictions ci-dessus peut entraîner une violation des lignes directrices sur l'exposition aux radiofréquences.

Environment (WEEE, Batteries and packaging)

This product is labeled in accordance with European Directives 2013/56/EU concerning Waste Electrical and Electronic Equipment (WEEE) and 2013/56/EC concerning Batteries and Accumulators. Those provisions are requiring producers and manufacturers to become liable for take-back, treatment and recycling upon end of life of equipment and batteries.

● SEAMLESS PAYMENT

BATTERIES

If your product contains batteries, they must be disposed of at appropriate collection points.

THE PRODUCT



The crossed-out waste bin stuck on the product or its accessories means that the product belongs to the family of electrical and electronic equipment, and waste batteries must not be thrown away but collected separately and recycled.

Please contact your retailers for more detailed information about the compliance solution in place for disposing of your old product and used batteries.

Packaging waste must also be collected separately to assure a proper disposal and recycling.

In this way you can participate in the re-use and upgrading of Electrical and Electronic Equipment Waste, which can have an effect on the environment and human health.

● SEAMLESS PAYMENT

7_Troubleshooting

Q: The terminal cannot be started.

A: The device might be under low energy status or the program may be damaged. Please make sure the power is enough and then restart your device. If it still fails, please contact our customer service department for help.

Q: Printer cannot work.

A: This may be caused by abnormal power supply or incorrect paper installation.

Check the battery status or the terminal power connection. If the remaining battery power is insufficient for a complete printing operation, the printer will not print the paper.

Check the printer roller and if the paper dust cover is correctly installed.

If the problem still exists, please contact our customer service centre.

Q: Transaction Processing Failure

A: Following reasons are likely to cause transaction failure : damaged magnetic card or smart card SAM card, damaged card reader, improper operation of card swiping, damaged or unconnected, unconnected phone line, etc.

- Try to use more than one magnetic card to test the transaction, to confirm the failure is not caused by magnetic card.
- Make sure card swiping is operated correctly.
- Manually process the transaction instead of card reader. If manual transaction works, the failure may be caused by magnetic card reader.
- Use more than one smart card to test the transaction, to confirm the failure is not caused by smart card. Make sure the SAM card is correctly inserted into the card slot.
- Check if the SIM card is installed correctly and local wireless communication network functions or not.

If there is still problem, please contact our customer service centre.

" This Document is Copyright © 2019 by ingenico Group . ingenico retains full copy right ownership , rights and protection in all material contained in this document . The recipient can receive this document on the condition that he will keep the document confidential and will not use its contents in any form or by any means , except as agreed beforehand , without the prior written permission of ingenico . Moreover , nobody is authorized to place this document at the disposal of any third party without the prior written permission of ingenico . If such permission is granted , it will be subject to the condition that the recipient ensures that any other recipient of this document , or information contained therein , is held responsible to ingenico for the confidentiality of that information .

Care has been taken to ensure that the content of this document is as accurate as possible . ingenico however declines any responsibility for inaccurate , incomplete or outdated information . The contents of this document may change from time to time without prior notice , and do not create , specify , modify or replace any new or prior contractual obligations agreed upon in writing between ingenico and the user .

ingenico is not responsible for any use of this device , which would be non-consistent with the present document .

All trademarks used in this document remain the property of their rightful owners ."

www.ingenico.com

9 avenue de la gare Rovaltain TGV Valence 26958 France

● SEAMLESS PAYMENT



YS01000428