



# LEVAN 電撃レース

1:52 Radio Control Racing Car

**Changes or modifications not expressly approved by the party responsible for compliance could void the use's authority to operate the equipment**

**Name of product: SHEN QI WEI  
simulated car series.  
PRODUCT FEATURES:**

Longer time: 6 to 10 minutes(equipped with large-capacity battery,it can reach the best effect after charging and discharging sereval times.);

Longer distance: 6 to 20 meters;

Better performamnce: reliable frequency seletion and strong anti-interference ability.

**Preparation:**

- 1.Rip the paster,and take up the cover with the arrowhead direction.

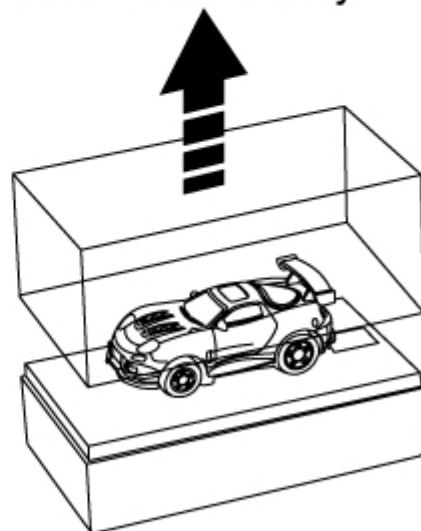

2. Open the cover of pedestal,  
take out the controller and  
the antenna.

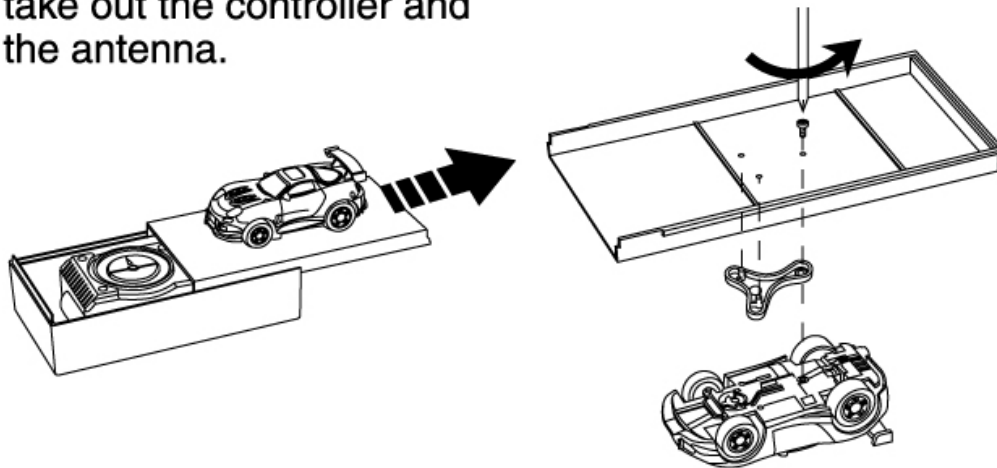

3. Undo the screws of the  
cover in the pedestal with  
the phillips screwdriver, and  
you can get a fine racing  
car.

4. Insert the antenna into the hole at the top of the controller, and tighten it.

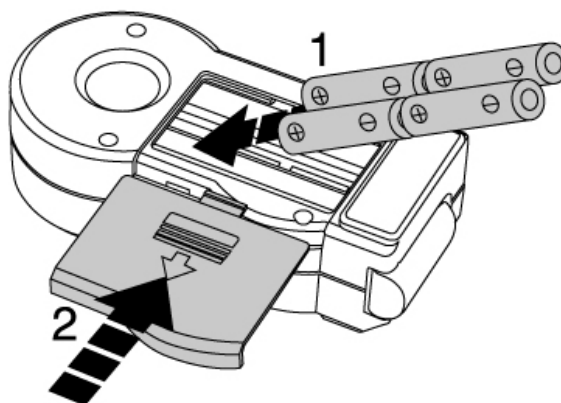
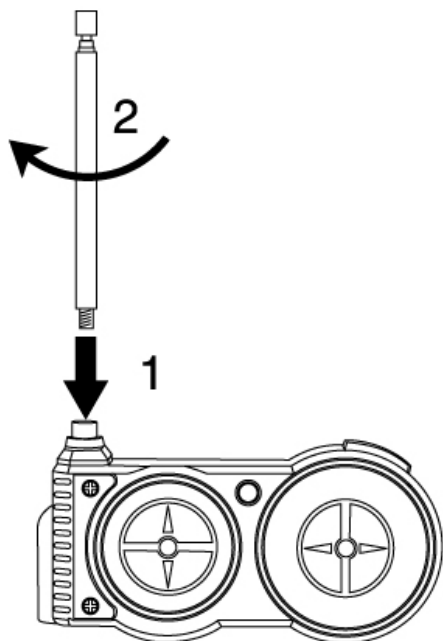

5. Push away the battery cover after the controller, install 4x "AA" batteries with the correct polarity, then replace the battery cover.

## **CHARGE:**

Open the transparent cover, take out the plug of charge from the button of transparent cover, then insert the plug of charge into the charge to connect on the tail of racing car, the indicator lamp lights. It goes out when the car was fully charged, then pull out the plug of charge. The car should be charged for about 5 minutes.

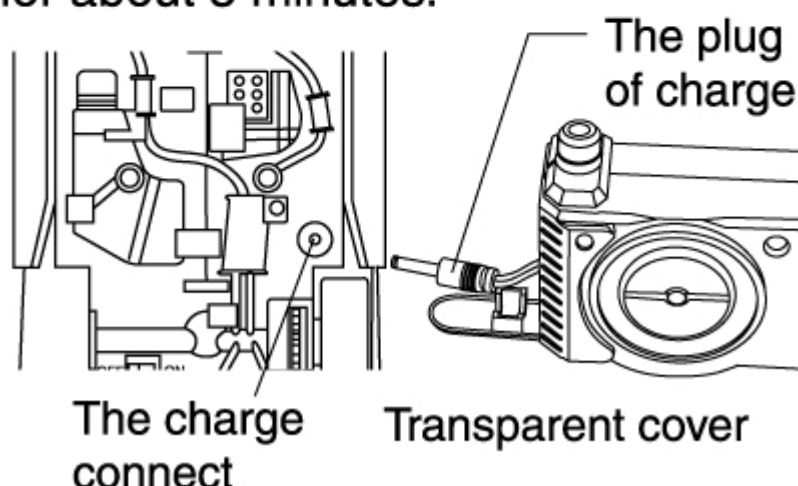

## OPERATION:

1. Fully extend the antenna when playing.; turn the power of racing car switch to "ON" position.
2. Press the button of the controller, the car works. The operation indicator lamp shines as pressing the button of the controller. (CAUTION: Because pressing the accelerated button, press the front and rear button invalidation, so the front and rear indicator light is not shined.) When pressing the forward/backward button, the car moves forward/backward; the front/rear lamp also along with shines. the car may turn left/right while pressing the forward/backward button and the left/right turn button at the same time. pressing the accelerated button when the car forward, the car rapidity will speed, when press the left/right button again, the car will automatically decelerate to decrease turns over the car is trouble.
3. Adjust the trim machine in the front of the bottom of the racing car, which can adjust car runs functions.

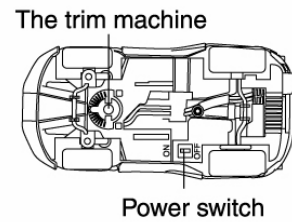
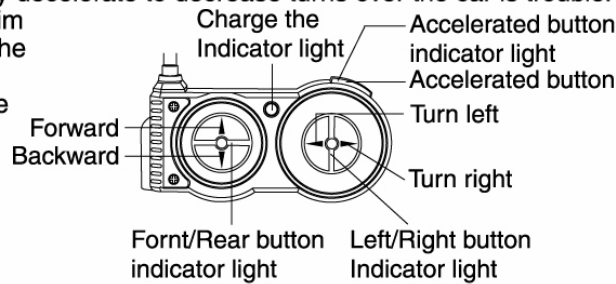

## **CAUTION:**

- a). Do not touch the antenna during operating, or the controlled distance may be affected;The antenna breaks to need adult is processing.
- b). If the car becomes apparently slower during operation,it might due to insufficient power,please charge the car follow the illustration.
- c). The car should decelerate when turning rapidly or reversing, or the car may turn over.
- d). Replace the new batteries of the controller if they lack of power, the car can't be charge the indicator lamp turns dim.
- e). Pay attention to the plug of charge & the charge position when charging.
- f ). Please remove the battery of the controller and turn the power of racing car switch to "OFF" position when it is not used for a long time.
- g).Non rechargeable batteries are not to be recharged.
- h).Old and new batteries or Different types of batteries are not to be mixed.
- i).Batteries are to be inserted with the correct polarity,,avoid install of mistake.
- j).Do not short circuit the batteries terminals.
- k).Remove the packing under adult supervision.
- l).Please retain the above information for future reference.