

110mm

80mm

Bluetooth keyboard User Operation Manual

Welcome to use the Bluetooth keyboard

It is composed of 87 function keys; built in Bluetooth 3.0; suitable for three systems use, multimedia hotkeys, comfortable handle, Ergonomic Design; The key surface can be washed, also can roll for storage.

1.0 Package contains:

Your Bluetooth keyboard package contains the following:
Bluetooth Keyboard-----1
User Manual-----1

2.0 How to use the Bluetooth Keyboard:

Bluetooth Keyboard is applies to the following conditions:
It is suitable for various workplaces: It can be used in a wet environment and even is shallow water(expect for silicon part); it can be used in an acidic and alkaline environment; it can be used in a dirty and dusty condition and even in the dust. It can be cleaned by alcohol or disinfectant.

Bluetooth Keyboard is not available for the following conditions:

The product can not come into contact with sharp objects.

The product can not come into contact with oil or chemicals.

When folded, the product can not be squeezed.

Do not put heavy objects on the top of the product.

Do not expose the product to fire source.

Do not stretch hard or distort the product.

3.0 Keyboard Specification:

1. Bluetooth 3.0 interface standard
2. Operating Distance: 0~10 meters, 360 degree centigrade
3. Modulation System: GFSK
4. Operation Voltage: DC 3.0V
5. Working Current: <3mA
6. Sleeping Current: <300uA
7. Operating Temperature: -5~45°C
8. Carrier Frequency: 2402-2480 MHz

4.0 Product Features:

1. Suitable for IOS/Android/Windows system platform.
2. Ergonomic Design, comfortable operating by silicon keys.
3. The key surface can be washed.
4. The keyboard can be rolled for storage.
5. Built-in wireless Bluetooth 3.0.
6. Using two 7# (AAA) battery.
7. The indicator light: Blue for matching status, when match successfully, the light will be out automatically, Low battery will be warning.

5.0 System Support:

Support for iPad / iPad 2 / NEW iPad / iPhone, Support for Samsung Android Tablet devices and other Android devices, Support for Windows system platform.

6.0 Hot Key:

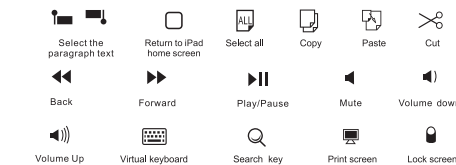

7.0 Bluetooth Keyboard Connect iPad Instruction:

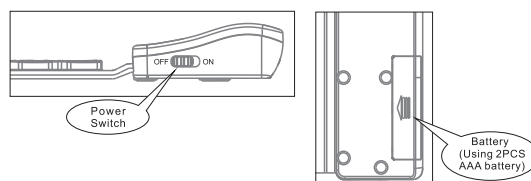

1. Pairing:

For the first time use, put the Bluetooth keyboard power switch on, pairing light long bright 5 seconds and then turns off. Press the first key of the upper left corner + the last key of lowest right corner at the same time, the indicator will flash, enter the search mode, if three minutes are not connected, the keyboard will go into sleep mode. For new device, follow the Bluetooth pairing steps and finish pairing. Once the connection is established successfully, the pairing light will stop flashing. If more than 10 minutes without using keyboard, it comes into sleeping mode. Pressing any key can wake up.
Re-use; turn the power switch on in Bluetooth keyboard, the pairing light bright 5 seconds, the keyboard will automatically search for the last time priority with machine equipment. No need to pair operating, if failure connection, while press the first key in upper left corner+ the last key in lower right corner, manual pairing, re-pairing.

2. Mode Switch:

Even machines successfully connection, still hold the FN key, there have 3 different system modes under the Q/W/E key respectively, corresponding to the device model you choose, the first row of multimedia hotkeys on the keyboard can be models for the hotkeys function.
Such as: if you use the keyboard on the IPAD, press FN+Q to enter the IOS platform, the first row of each corresponding hotkey shortcuts to the IOS. And if you choose the other platforms, useless cause hotkeys will not match the IOS platform.

3. iPad setting.



8.0 Troubleshooting:

If the keyboard is not working with the iPad (or other Bluetooth devices) make sure:

- 1.)The Bluetooth function on the iPad (or other Bluetooth devices) is synced correctly.
- 2.)The distance of the Bluetooth keyboard and device within 10 meters.
- 3.)The Pin code is entered correctly.
- 4.)Restart your device.
- 5.)Please confirm whether the alkaline battery voltage is too low. Replace the battery as soon as possible.
- 6.)To solve the issue simply restart the keyboard by turning it OFF and then ON again.

The function keys on the keyboard may operate differently depending on the tablet that you are using.

iPad, iPhone, iPod Touch are trademarks of Apple Inc.



蓝牙键盘 用户说明书

谢谢你选择了我们的键盘！

键盘由87个物理按键组成: 支持蓝牙3.0; 三种常见平台切换, 多媒体热键, 随平台自由变换, 硅胶按键操作舒适, 符合人体工学设计; 键盘按键面可水洗; 键盘可卷曲存放。

1. 包装内容:

您的蓝牙键盘包包含以下内容:
蓝牙键盘-----1个
用户说明书-----1份

2. 怎么使用蓝牙键盘:

蓝牙键盘可以适用于以下情况:
它可以在潮湿的环境被使用, 甚至是在浅水区(除了塑胶部分), 它可以在酸碱环境中使用, 它可以在一个肮脏又或者成尘土飞扬的环境下被使用, 甚至是在尘土中, 它可以通过消毒液和酒精来清洗。

蓝牙键盘不能用于下列条件:



该产品不能与锋利物体接触。

不能和油或化学物品接触。

折叠时不能挤压产品。

不要把重物放在上面。

不要接触火源。

不要用力拉伸或扭曲。

3. 规格参数:

1. 蓝牙标准: 蓝牙3.0
2. 操作距离和范围: 0~10米, 360度
3. 调制方式: GFSK;
4. 工作电压: DC 3.0
5. 工作电流: <3mA
6. 睡眠模式: <300uA
7. 工作温度: -5~45°C
8. 载波频率: 2402-2480MHz

4. 产品特点:

1. 三种平台模式切换, 适用IOS/Android/Windows系统平台。
2. 人体工学设计, 硅胶按键操作舒适。
3. 键盘按键面可水洗。
4. 工作电压: DC 3.0
5. 键盘可卷曲存放。
6. 支持蓝牙3.0无线接口。
7. 使用两节7号(AAA)干电池。
8. 指示灯描述: 蓝色为对码状态, 连机成功自动熄灭; 低电时报警指示。

5. 系统支持:

支持 iPad / iPad 2 / NEW iPad / iPhone、三星Android平台设备及其它部分Android设备, 全面兼容WINDOWS系列平台。

6. 多功能键说明:



7. 蓝牙键盘连接iPad说明:

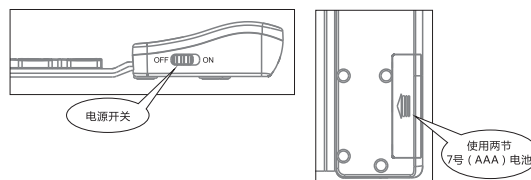

1. 对码:

首次使用, 打开蓝牙键盘的电源开关, 对码灯长亮5秒然后熄灭, 同时按左上角第一个键+右下角最后一个键, 对码指示灯会闪烁, 进入搜索状态, 对码指示灯闪烁, 3分钟无连接自动熄灭进入休眠状态; 新设备请操作设备端蓝牙配对步骤按提示完成对码, 对码成功, 对码指示灯熄灭; 连接后键盘10分钟内无操作进入休眠状态, 按键盘任意键可唤醒。

再次使用, 打开蓝牙键盘的电源开关, 对码灯长亮5秒, 键盘会优先自动搜寻最后一次连机设备, 无需对码操作, 如连机失败, 同时按左上角第一个键+右下角最后一个键, 进行强制对码, 重新配对。

2. 模式切换:

连机成功, 按住Fn键不放, 在Q/W/E下分别有三个系统模式, 选择你设备对应的模式, 键盘上第一排多媒体热键, 即可对应该模式热键功能。如: 你如iPad上使用该键盘时, 按FN+Q进入IOS平台, 第一排热键即可对应IOS的各快捷功能。而你选的是其它平台, 热键会与IOS不匹配而无作用。

3. iPad设置:



8.0 故障排除:

如果键盘不能在iPad (或其他蓝牙设备上) 操作, 请确保:

1. iPad (或其他蓝牙设备) 的蓝牙功能与键盘的蓝牙是否同步正常。
2. 确保蓝牙键盘和设备的有效距离在10米之内。
3. Pin 码输入正确。
4. 重新启动你的设备。
5. 请确认电池电压是否过低, 尽快更换电池。
6. 解决这个问题最简单的办法就是重新启动一下键盘电源。

键盘的功能键位操作不同取决于你使用的电脑的不同。

iPad, iPhone, iPod touch 是苹果公司的注册商标。



尺寸: 110*80mm, 100g书纸, 正反面单黑印刷, 八折页

Federal Communications Commission (FCC) Interference Statement

This equipment has been tested and found to comply with the limits for a Class B digital device, pursuant to Part 15 of the FCC Rules.

These limits are designed to provide reasonable protection against harmful interference in a residential installation. This equipment generate, uses and can radiate radio frequency energy and, if not installed and used in accordance with the instructions, may cause harmful interference to radio communications.

However, there is no guarantee that interference will not occur in a particular installation. If this equipment does cause harmful interference to radio or television reception, which can be determined by turning the equipment off and on, the user is encouraged to try to correct the interference by one of the following measures:

- Reorient or relocate the receiving antenna.
- Increase the separation between the equipment and receiver.
- Connect the equipment into an outlet on a circuit different from that to which the receiver is connected.
- Consult the dealer or an experienced radio/TV technician for help.

This device complies with Part 15 of the FCC Rules. Operation is subject to the following two conditions:

(1) This device may not cause harmful interference, and (2) this device must accept any interference received, including interference that may cause undesired operation.

FCC Caution: Any changes or modifications not expressly approved by the party responsible for compliance could void the user's authority to operate this equipment.

RF exposure warning

This equipment complies with FCC radiation exposure limits set forth for an uncontrolled environment.

The equipment must not be co-located or operating in conjunction with any other antenna or transmitter.