

Production Model: 1GD-868Mn

Controller is portable, which is compatible with the receiver.

Signal is transferred by Radio wave (868 MHz).

Remote control function specification

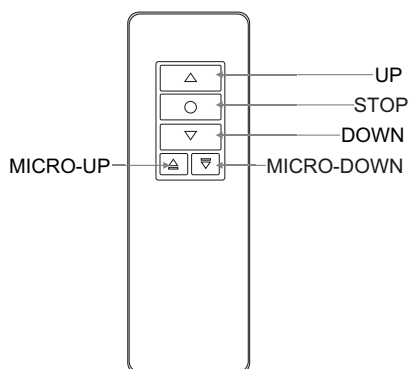

Model: 1GD-868Mn

Specification for controller

1. Push the Up button, the screen will go upwards.
2. Push the Down button, the screen will go downwards.
3. Push the stop button, the screen will stop.
4. Push the MICRO-UP button, the screen will go upwards slightly to achieve the desired spot.
5. Push the MICRO-DOWN button, the screen will go downwards slightly to achieve the desired spot.

Notes for controller:

1. Working temperature: -5°C - $+40^{\circ}\text{C}$
2. Batteries for controller: 1.5V x 2, Model: A AA
3. Working properly in the generally pollution environment
4. To protect the controller, please take out of the batteries to avoid the battery's leak when you don't use the controller for long time.

Set up for controller's batteries

Please change the batteries according to the following steps when the signal of remote control becomes weak.

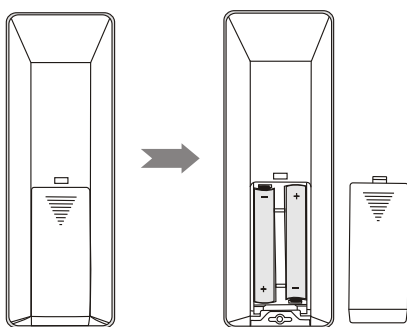

1. Counter turn the remote controller and open the battery cover according to the direction of arrow.
2. Fix in the batteries according to the figure on the left side.
3. Close the battery cover.



WARNIN

Warning: Changes or modifications to this unit not expressly approved by the party responsible for compliance could void the user's authority to operate the equipment.

This equipment has been tested and found to comply with the limits for a Class B digital device, pursuant to Part 15 of the FCC Rules. These limits are designed to provide reasonable protection against harmful interference in a residential installation. This equipment generates, uses and can radiate radio frequency energy and, if not installed and used in accordance with the instructions, may cause harmful interference to radio communications. However, there is no guarantee that interference will not occur in a particular installation. If this equipment does cause harmful interference to radio or television reception, which can be determined by turning the equipment off and on, the user is encouraged to try to correct the interference by one or more of the following measures:

- reorient or relocate the receiving antenna.
- Increase the separation between the equipment and receiver.
- Connect the equipment into an outlet on a circuit different from that to which the receiver is connected.
- Consult the dealer or an experienced radio /TV technician for help.

Grandview Crystal Screen Canada Ltd.

#11- 3751 North Fraser Way, Marine Way Business Centre,
Burnaby, BC, Canada V5J 5G4
Tel: 1-604-412-9777 Fax: 1-604-412-9796
Website: www.grandviewscreen.ca

Guangzhou Grandview Crystal Screen Co., Ltd.

P.O. 511400 Federal Ind. Zone No. 363, Yushan West Road,
Shiqiao, Panyu District, Guangzhou, Guangdong, China
Tel: +8620-8489-9499 Fax: +8620-8480-3343
Website: www.grandviewscreen.com