

1 Introduction

This document describes the FCC label and warning language for the Compass Auto Finder Beacon (FCC ID: XDJ-BEACON-01) and the Compass Auto Finder Pointer Remote (FCC ID: XDJ-PNTRREM-01).

2 Beacon

The Beacon FCC label language is as follows:

Finder Technologies Inc	
Model	IC ID
FTI-188-20050	FCC ID XDJ-BEACON-01
www.findertechnologies.com	Made in China

The overall dimensions of the Beacon device are shown to the right in inches:

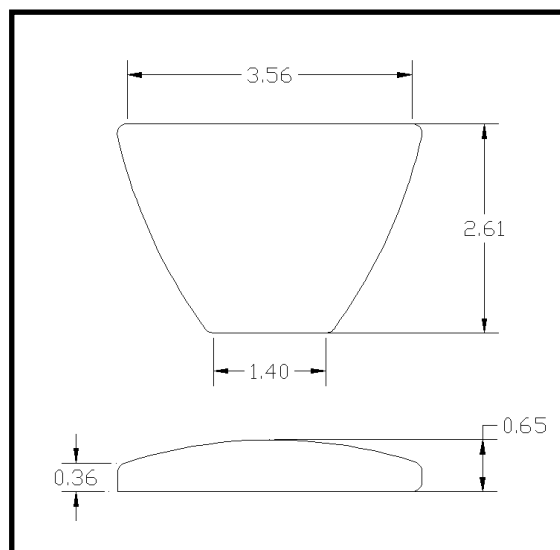

The FCC label is located on the Beacon bottom as shown in the below pictures:



3 Pointer Remote

The Pointer Remote FCC label language is as follows:

Finder Technologies Inc	
Model	IC ID
FTI-188-30050	FCC ID XDJ-PNTRREM-01
www.findertechnologies.com	Made in China

The overall dimensions of the Pointer Remote device are shown to the right in inches:

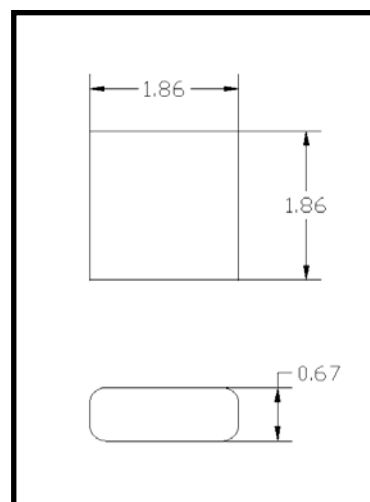

The FCC label is located on the rear of the Pointer Remote as shown in the picture to the right:

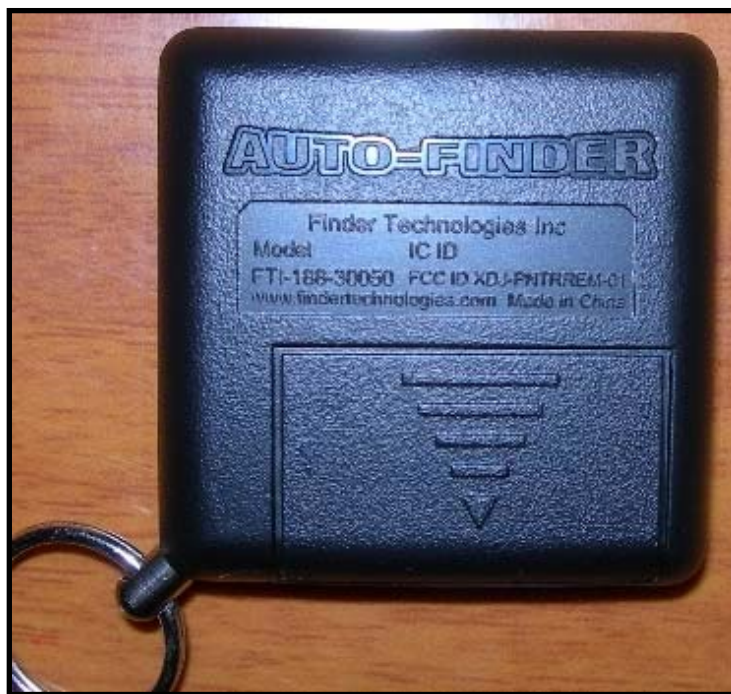

3 User Manual Language

The following statement will be placed in the user manual:

INFORMATION TO USER

This device complies with Part 15 of the FCC Rules. Operation is subject to the following two conditions: (1) This device may not cause harmful interference, and (2) This device must accept any interference received, including interference that may cause undesired operation.

This equipment has been tested and found to comply with the limits for Class B Digital Device, pursuant to Part 15 of the FCC Rules. These limits are designed to provide reasonable protection against harmful interference in a residential installation. This equipment generates and can radiate radio frequency energy and, if not installed and used in accordance with the instructions, may cause harmful interference to radio communications. However, there is no guarantee that interference will not occur in a particular installation. If this equipment does cause harmful interference to radio or television reception, which can be determined by turning the equipment off and on, the user is encouraged to try to correct the interference by one or more of the following measures.

- Reorient or relocate the receiving antenna
- Increase the separation between the equipment and receiver
- Connect the equipment into an outlet on a circuit different from that to which the receiver is connected
- Consult the dealer or an experienced radio/TV technician for help

Any changes or modifications not expressly approved by the party responsible for compliance could void the user's authority to operate the equipment.