

S5

Quick Start Guide

viliv 빌립

200-11 Anyang-dong, Manan-gu, Anyang-si,
Gyeonggi-do, South Korea
E-mail : help@myviliv.com



Intel Atom Silverthorne 1.33Ghz
Superfine 4.8" Touch LCD with Virtual Haptic Keyboard
200 hours Standby Time
6 hours continuous movie Playback
Bluray HD Video Playback
HDD 30G/60G, Windows XP

This guide is subject to change for product improvement without prior notice.



Thank you for purchasing viliv.
Please read the Precautions before using the product.

viliv 빌립

→ Copyright

Yukyung Technologies Corp. has the copyright for this guide.

The contents of this guide may not be copied for use in any way without prior authorization from Yukyung Technologies Corp.

©2009 Yukyung Technologies Corp. All rights reserved.

→ Certificate

This device is properly registered for home use (Grade B) and is designed for use not only in residential areas but also anywhere else.



→ Registered Trademark

viliv is Yukyung Technologies' registered trademark.

Windows 2000, Windows XP and Windows CE are Microsoft Corporation's registered trademarks.

→ Exemption

Infringement of Intellectual Property Rights: Playing, copying, or distributing any part or all of any copyrighted content such as software, music, and video, using this device, may infringe on a third party's legitimate intellectual property rights or violate the copyright law. All legal responsibilities for infringement of copyright or intellectual property rights arising from the use of this device lie with the user.

Improper Use: The manufacturer of this device will not be held responsible for any damage caused by user's improper use, operation of the device under inappropriate environments, infringement of copyright, or right of likeness by the user.

Data Loss: Any audio, video and photo file can be deleted due to damage, operational error, or malfunction caused by the user's neglect, or when the device is turned in for warranty repair. Please make back-up files elsewhere. The manufacturer of the device will not be held responsible for loss of or damage to the data stored in the device.

Specifications Change: The dimensions of, the accessories to, the embedded software in and the manual for this device may be changed or modified without the user's prior consent or prior notice to the user.

Contents...

Safety Precautions for Use	4
Names of Parts	6
Basic Components	6
Front View	7
Top View	8
Left/Right View	9
Back View	10
Installation and Cable Connection	11
Connection of Earphones and External Speakers	11
Multi-I/O Jack.	12
USB Host Connection	13
USB Link Connection	13
Power Connection (with Rechargeable Adapter for Home).	14
Battery Separation/Placement	15
Battery Separation.	15
Battery Placement.	15
Directions to Insert/Remove USIM Card	16
Basic Operations	17
Power On/Off.	17
Setting/Cancelling Hold Function	17
Volume Control	18
Mute.	18
Resetting	18
Turning On/Off the LCD Screen	19
Touch Screen.	19
Virtual Keyboard	20
FAQ	21
Specifications	23



Safety Precautions for Use

The following precautions are provided to protect you from possible danger and to prevent any damage to property. Please observe them.

Precautions on Power

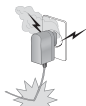

- Do not touch the power cord with wet hands.
- Be sure to plug the power cord in an outlet with a grounded jack.
- Be sure the plug goes in all the way so that it is not loose.
- If the device is damaged, including the power cord being worn out or damaged, do not use the device.
- In case of a thunderstorm, or in case you will be away for a long time, unplug it from the outlet.

Precautions on Battery



- Do not let it receive a strong impact, or strike it, or make a hole with a sharp object.
- Do not take it to or leave it at a hot place like a sauna.
- Do not let it get wet.
- Do not let the battery charging terminal contact a metal substance.
- Do not allow children or pets bite it or play with it.
- When you dispose of the battery, do not burn it or throw in the garbage can. Take it to your nearest battery disposal place. (Call the local agency for locations.)

Precautions on the Device



- Do not leave it in a location where the temperature is either too high (above 35°C) or too low (below -5°C).
- Do not leave it in direct sunlight or in a closed car.
- Do not leave it in a dusty or humid place, or a bathroom.
- Do not leave credit cards (or any other materials with magnetic strip on) near it.
- Do not use accessories that are not provided with this device.
- Do not touch the LCD screen with a sharp object.

Precautions on Use



- Do not listen to music at a high volume for a long period.
- Do not watch video for too long at a time.
- Do not use the headphones/earphones while driving, walking or using public transportation.
- Do not allow the LCD screen to receive any impact.
- If the device begins to smoke, or if it becomes heated and looks deformed, stop using it immediately, and contact your nearest Customer Service.
- Do not use it while driving or on a plane.
- Turn it off while filling your fuel tank.
- Do not use it in a hospital.
- Do not leave the device or the power adapter on your bare skin for a long time when in use. The device can heat up in normal use; touching your bare skin for a long period when in use will make you uncomfortable and could even cause burns.

Other Precautions



- If the device is wet, do NOT turn on the power. Separate the battery and dry it with a soft, dry cloth and contact Customer Service.
- When cleaning the device, use a soft, dry cloth. Do not use benzene or thinners.
- Do not repair, disassemble or alter the device on your own.
- Take care not to let any liquid or foreign matter get inside the device.
- Do not drop the device.



Safety Precautions on Use

Different models have different features.

Read the precautions related to the features included before using the device.

Precautions for GPS



- For initial operation of the device, it is recommended to warm it up for over 15 minutes in a wide open place.
- If the automobile with this device installed is not used for over 7 days, the data storage recharger inside the GPS may be discharged, and may require over 15 minutes of warming up.
- GPS signals are high frequency at 1575 MHz, and can be affected by weather conditions like rain or fog or some other electromagnetic disruption, in which case the reception may be bad.
- Under an overpass, inside a tunnel, in an area densely occupied by tall buildings, and near high-tension wires, the reception can be bad.
- The GPS receiver may not work properly in some vehicles with UV coating, sun-block coating, or electromagnetic disruption.
- The GPS receiver works well between 0°C and 50°C. In the middle of summer or in the dead of winter, problems may occur, so try to keep the temperature from 0°C to 50°C to use the device.
- On some roads running parallel to other roads or on an overpass, the information on speed limits and on dangerous areas for speeding may not be accurate.

Precautions for Bluetooth



- Don't try to operate Bluetooth while driving. The driver shall be held responsible for any accident arising from trying to operate Bluetooth.
- Turn off the Bluetooth setting where its use is not allowed for prevention of electromagnetic problems or other dangers.
- If you use a certain medical device (such as a pacemaker or a hearing aid), contact its manufacturer and make sure that it is cut off from an energy source before using it. You may need some assistance from your doctor.
- Our product meets Bluetooth Standards 2.0. Some Bluetooth devices may not be compatible with our product. For more information on compatibility, contact the manufacturer of the pertinent Bluetooth device or our Customer Service.
- This wireless equipment may experience electromagnetic interruption, so it cannot be used for services related to saving lives.

Precautions When Using Navigation



- Placing the device where it blocks the driver's view or where it gets in the way of driving a vehicle can cause accidents.
- Adjust the volume to an appropriate level so that it won't interfere with driving.
- Fix the device rack securely so that it won't fall or move while driving.
- If you fix the rack onto the windshield, the adhesion may become weak after a long time, and the device rack may fall. So, if you are not using it over a long period, separate the device and keep it in a safe place.
- Do not disassemble the device on your own and fix it inside the vehicle. It can affect the electrical system and the GPS reception, and may cause a fire.
- Be careful not to unplug the device from the cigarette jack while it is on. It can cause a malfunction.
- Set it up where it does not block the driver's view or where it is not in the way of an air bag.



Names of Parts

The pictures of the components below may differ from the actual components, and some components may be changed depending on the situation.

Basic Components



The main body

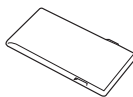

The standard slip-in/out battery



A hand strap and a stylus pen in one

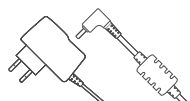

An AC/DC power adapter

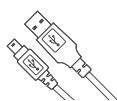

A USB cable

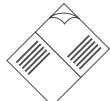

Quick Start Guide



Names of Parts

Front View

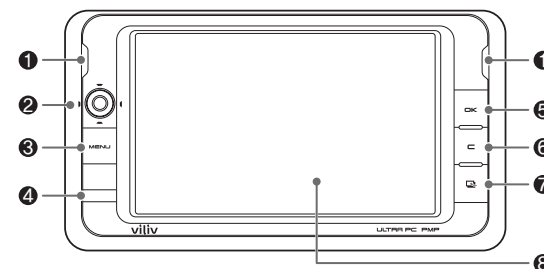

1	Built-in speakers	Stereo speakers are built in.
2	Jog dial	<p>Dial to move Left/Right/Top/Bottom (◀/▶/⬆/⬇)</p> <p>To move Left/Right/Top/Bottom on screen. (If it is pressed, continuous movement occurs on the screen.)</p> <p>Tab button (⊙)</p> <p>When pressed, the status bar appears.</p>
3	Menu button	Displays the menu.
4	IR Receiver	Used when the wireless remote control is used.
5	OK (Run) button	<p>With a quick click</p> <p>The selected menu item or the icon function is executed.</p> <p>When pressed for a bit longer</p> <p>The LCD comes on or goes off.</p>
6	Right-Click button	Displays the properties. (the same function as the right-click of a PC mouse.)
7	Shortcut button	<p>The initial value is set to the virtual keyboard.</p> <p>User can make shortcuts to programs.</p> <p>※ Same as pressing Ctrl+Alt+h at the same time on a keyboard.</p> <p>※ For detailed information how to make shortcuts, refer to the detailed User's guide.</p>
8	TFT LCD/Touch Screen	User can operate the device on the touch screen.



Names of Parts

Top View



1	Heat emission hole	Emits heat generated by the device. ※ If the heat emission hole is blocked, the device can overheat, which can be dangerous. Take care not to allow this to be blocked. ※ Take care not to allow water into this hole.
2	Earphone jack	Connect the earphone or speakers through this.
3	Volume button	- Adjust the volume with this. Pressing the center of the volume button turns on the Mute function.
4	Built-in DMB antenna	This is a built-in antenna for terrestrial DMB reception. ※ Some models do not have this built in. ※ Only available in Korea



Names of Parts

Left/Right View

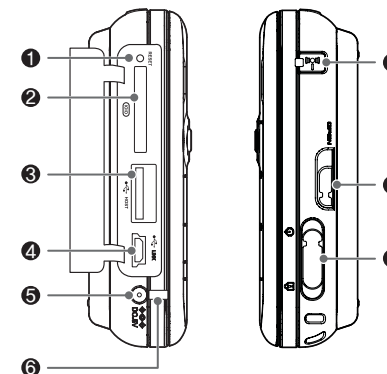

1	Reset button	Pressing this with a pointed object turn off the device.
2	Multi-I/O jack	Used for Component/ S-VIDEO output.
3	USB host jack	Used to connect an external device to the device through USB connection.
4	USB link jack	Used to connect the device to a computer. (It will work as an external storage device.) ※ For details on connection, refer to the detailed guide. ※ Do not use this before reading the detailed guide carefully.
5	Power adapter jack	Used when connecting a power adapter to the advice or when recharging the battery
6	Power indicator	Displays the battery status. (When charging: red; when fully charged: blue)
7	External DMB antenna jack	Used when connecting an external DMB antenna. ※ Some models may not have this. ※ Only available in Korea
8	Battery separation/lock	Separates/ Holds in the battery.
9	Power/lock switch	Used when locking the power on / off (locking all the functions) status.



Names of Parts

▶ Back View

The picture above shows the main body without the battery.
(Refer to page 15 for the battery separation/ placement.)

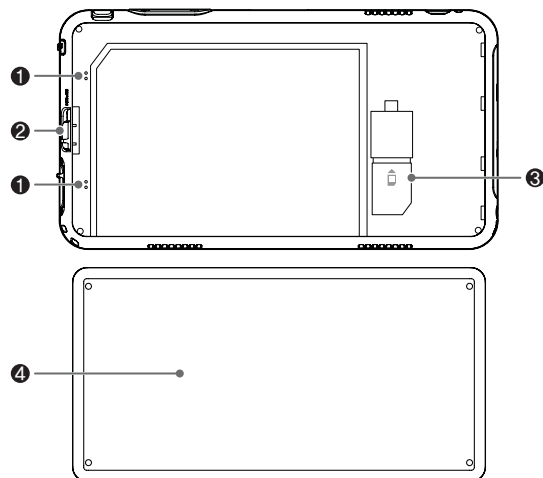

1	Battery recharging contact	Battery jack's contact area.
2	Battery separation/ Hold	Lift the battery up in the direction indicated in the picture; then the battery is separated.
3	USIM card slot (Optional)	USIM card insertion slot. (Refer to page 16 for USIM card insertion/separation.)
4	Battery	



Installation and Cable Connection

▶ Connection of Earphones and External Speakers

Connect earphones and external speakers to the earphone jack at the top of the device.

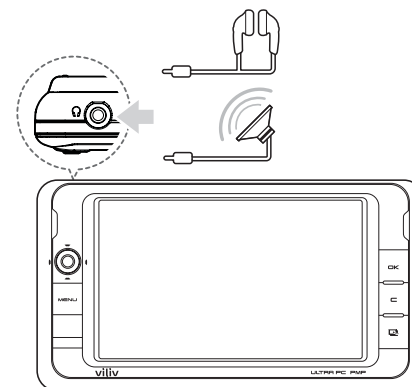

Notice

- When connecting external speakers, be sure to connect the standard 3.5-pi stereo cable of the speakers to the earphone jack.



Installation and Cable Connection

▶ Multi-I/O Jack

This can be used to connect an LCD monitor or a digital TV.
(The icon on the back of a monitor may be different depending on the product.)

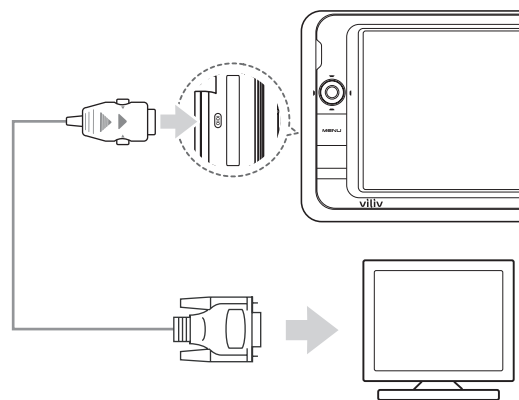
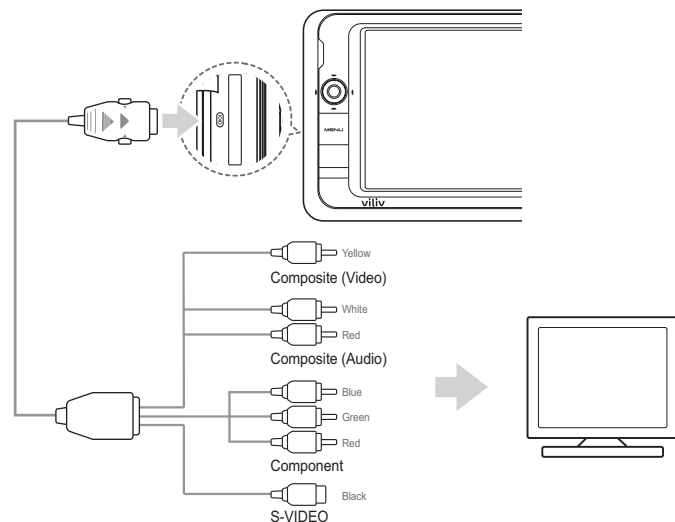

Installation and Cable Connection

External devices may have different connecting parts depending on products.

▶ USB Host Connection

This is used when connecting an external device such as a digital camera or an external HDD.

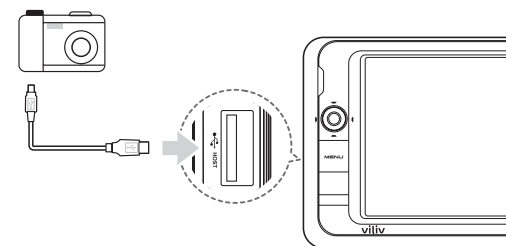

▶ USB Link Connection

Connect a USB cable to the USB Link jack on the left side of the device.

※ **Do not use this before reading the detailed guide carefully.**

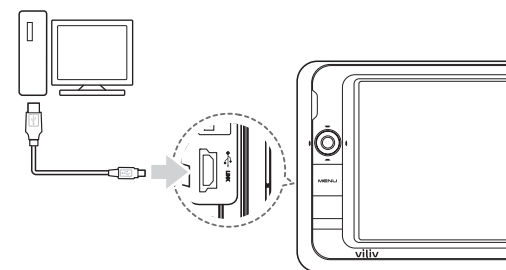





Installation and Cable Connection

▶ Power Connection (with Rechargeable Adapter)

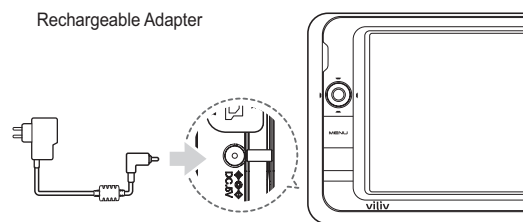
Connect the rechargeable adapter to the power adapter jack on the left side of the device.



Notice

- The recharging status of the battery is as follows:
The device's power indicator: When charging - red, When fully charged - blue.
The battery icon: When charging - , When fully charged - 



Battery Separation/Placement

▶ Battery Separation

Turn the battery separation/placement button on the right side of the device toward Open as in the illustration below. Then, separate the battery.

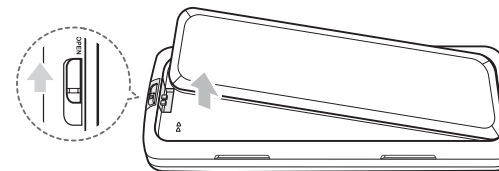

Notice

- Make sure that the power of the device is off before separating the adapter. You could get an electric shock due to the area around the battery's power being short-circuited.

▶ Battery Placement

Adjust the battery into the groove as in the illustration below, and press it until it clicks.

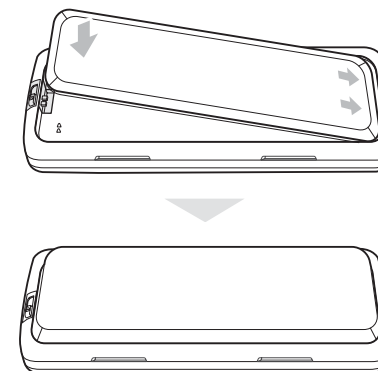

Notice

- If you do not insert the battery properly and place it by force, the device can be damaged.



Battery Separation/Placement

▢ Directions to Insert/Remove USIM Card

To insert ↑ : Place the front part of the USIM card into the USIM card slot, and insert it in the direction of the arrow until it clicks.
(When inserting a USIM card, pushing it too hard may damage the card.)

To take out ↓ : It is one-touch type, so pressing the end of a USIM card lightly will eject it.
(When part of the USIM card is ejected out, remove the card in the direction of the arrow.)

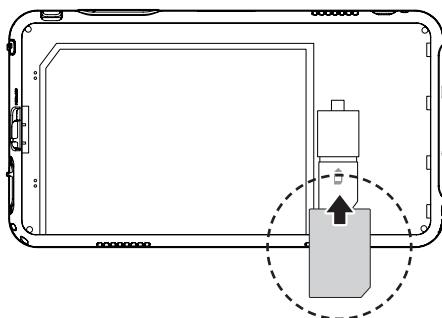

↑ : Direction of insertion
↓ : Direction of removal

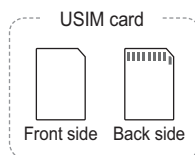
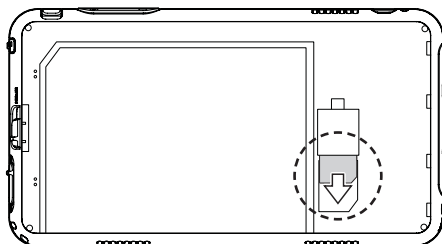

Notice

■ Be sure to turn the power off before removing the USIM card.



Basic Operations

▢ Power On/Off

1 Turning the Power On

With the power off, push the power button on the right side of the device up to turn it on.

The main screen displays on the LCD screen.



2 Turning the Power Off

From the On position, push the power button on the right side of the device up all the way to turn it off.

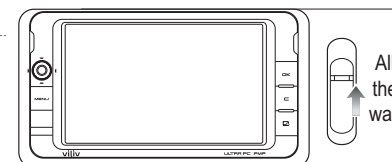

▢ Setting/Cancelling Hold Function

1 Setting the Hold Function

Push down the Hold button on the right side of the device.

Once it is set to Hold, none of the buttons including the touch screen functions will work except for the Hold button.



2 Cancelling the Hold Function

Push up the Hold button on the right side of the device to the middle.

Once the Hold setting is cancelled, all of the buttons, including the touch screen functions, will work.





Basic Operations

> Volume Control

1 Volume Control

Adjust volume by pressing the VOL button on the upper area of the device.



> Mute

1 Mute

Press the middle of the VOL button on the upper area of the device.

The MUTE function is on.



> Resetting

Use the Reset button if the touch screen and/or the buttons on the device do not work.

1 Reset

Lightly press the Reset button on the left side of the device with the Touch Pen.

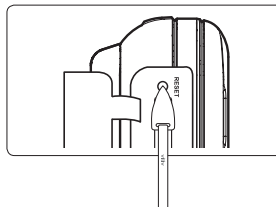

Basic Operations

> Turning On/Off the LCD Screen

1 Turning off the LCD Screen

When it is on, press and hold the [OK] button; then the screen goes off.

2 Turning on the LCD Screen

When it is off, press and hold the [OK] button; then the screen comes on.



> Touch Screen

1 Touch

Click any place on the LCD screen with the Touch Pen.
(If you keep it pressed, it will work like a right click.)

2 Double Touch

This works the same way as the double-click with a PC mouse.

Just double-touch any place on the LCD screen.

3 Drag

With the Touch Pen, press any place on the screen and drag it to the final destination on the screen.

(It works the same way as dragging with a PC mouse.)

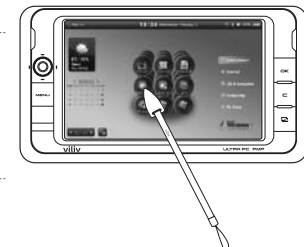



Basic Operations

Virtual Keyboard

1 Running the Virtual Keyboard

Click the [vilivSoftKeyboard] icon on the screen to run the Virtual Keyboard.
(You can also press the [] button.)

2 Hiding the Virtual Keyboard

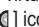
Clicking the [Hide] icon on the virtual keyboard will minimize the virtual keyboard into the [] icon.

Pressing the [] icon brings it back to its original form.

3 Ending the Virtual Keyboard

Right-click the [] icon on the task bar and select 'Exit'.

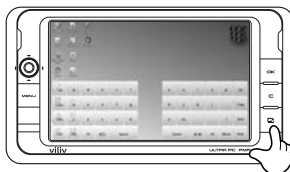

FAQ

The following are Frequently Asked Questions and the answers to them concerning viliv usage.
Check them before contacting Customer Service.

Q The power does not come on, and nothing appears on the LCD screen.

A Check that the power is connected. If it is not connected, check the charge status of the battery. If the battery is completely discharged, it will take more than 10 minutes to recharge it.

Q During use, the power or the LCD screen goes off on its own.

A Check that the power is connected. If it is not connected, check the charge status of the battery.

A If the battery is completely discharged, even if the power cable is connected, it can run erratically, or it may not work at all. Charge it for more than 10 minutes.

Q The buttons do not work.

A Check if there is the Hold icon on the screen. If it is 'locked' (i.e., there is the Hold icon on the screen), 'unlock' it (i.e., cancel the Hold status). If it is not 'locked' and still no buttons work, press the Reset button with a pointed pin.

Q Video subtitles do not appear.

If the format of the video subtitle is SMI, the extension on the file name that is the same as the video file being played should be 'SMI' or 'smi'. If the file name is long or if the video is divided into several files, the file names should be in order.

For example, if there is a file name like "This video file name is very long," the following should be in the directory:

A

- This file name is very long_1.avi
- This file name is very long_1.smi
- This file name is very long_2.avi
- This file name is very long_2.smi

Caution

Modifications not expressly approved by the party responsible for compliance could void the user's authority to operate the equipment.

FCC Compliance Information

This device complies with Part 15 of FCC Rules.
Operation is subject to the following two conditions:

- (1) This device may not cause harmful interference, and
 - (2) This device must accept any interference received.
- Including interference that may cause undesired operation.

Information to User

This equipment has been tested and found to comply with the limits for a Class B digital device, pursuant to part 15 of the FCC Rules. These limits are designed to provide reasonable protection against harmful interference in a residential installation. This equipment generates, uses and can radiate radio frequency energy and, if not installed and used in accordance with the instructions, may cause harmful interference to radio communications. However, there is no guarantee that interference will not occur in a particular installation. If this equipment does cause harmful interference to radio or television reception, which can be determined by turning the equipment off and on, the user is encouraged to try to correct the interference by one or more of the following measures:

- Reorient or relocate the receiving antenna.
- Increase the separation between the equipment and receiver.
- Connect the equipment into an outlet on a circuit different from that to which the receiver is connected.
- Consult the dealer or an experienced radio/ tv technician for help.

FCC RF Exposure Information

In August 1996 the Federal Communications Commission(FCC) of the United States with its action in Report and order 96-326 adopted an updated safety standard for human exposure the ra-dio frequency electromagnetic energy emitted by FCC regulated transmitters. Those guidelines are consistent with the safety standard previously set by both U.S. and international standards bodies. The design of 'S5 PREMIUM H' complies with the FCC guidelines and those international standards. Use only the supplied or an approved antenna. Unauthorized antennas, modifications, or attachments could impair call quality, damage your 'S5 PREMIUM H', or result in violation of FCC regulations.

'S5 PREMIUM H' was tested for typical body-worn operation using the optional belt-clip / holster placed touch(0cm) from the body. The use of non-tested accessories or other body-worn operations may not comply with FCC exposure requirements and should be avoided.