

Quick Guide

1. Before Installing

Congratulations on purchasing your **AudioCodes 425HD for Microsoft Teams IP Phone!**
Before installing your phone, make sure the following items are included in the shipped box:

- ✓ 425HD IP Phone
- ✓ AC power adapter (optional)
- ✓ Cat 5e Ethernet cable
- ✓ Handset
- ✓ Handset cord
- ✓ Desktop stand with two screws

2. Physical Description



3. Cabling the Phone

To cable the phone:

1. Connect the short, straight end of the handset cord to the handset, and the longer straight end of the cord, to the handset jack on the phone.
2. (Optional) Connect a headset to the USB port.
3. Connect the RJ-45 LAN port to your LAN network (LAN port or LAN switch/router) with a CAT 5 / 5e Ethernet cable.
4. Connect the RJ-45 PC port to a computer with a CAT 5 / 5e straight-through Ethernet cable.
5. Connect the DC plug of the supplied PS to the phone's DC 12V power jack, and then connect the PS to the electrical wall outlet. When the phone powers up, all the LEDs momentarily light up.

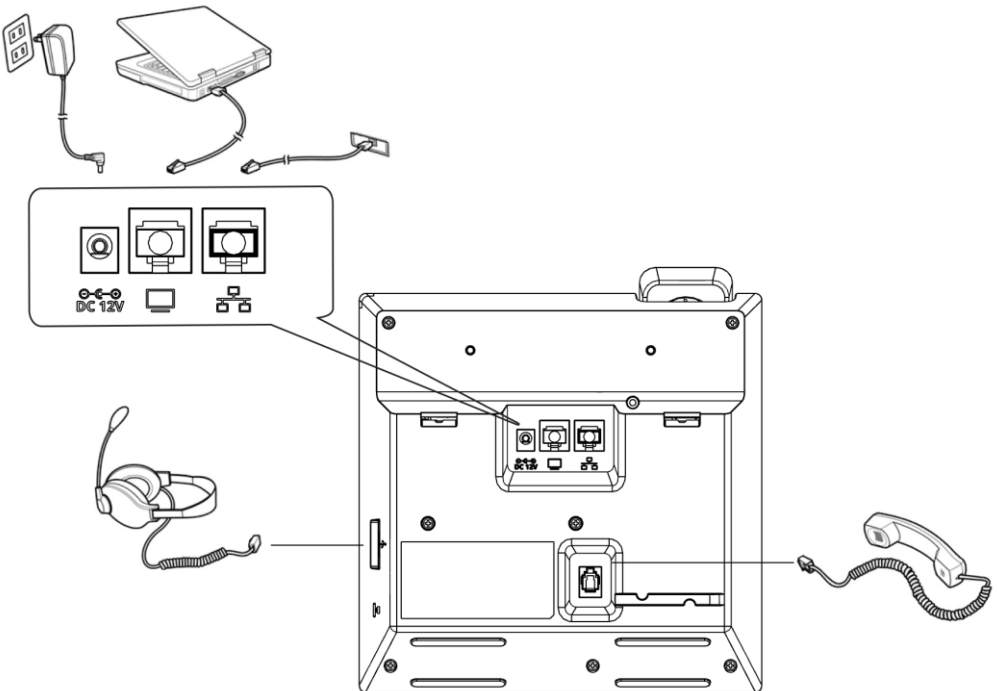

4. Mounting Phone on Desktop

Your phone is shipped with a desk stand.

To desk mount phone:

1. Align the two hooks of the desk stand (supplied) with the corresponding slots on the phone base.
2. Gently push the stand down until it snaps securely into place.
3. Secure the stand to the phone by fastening the two screws (supplied).

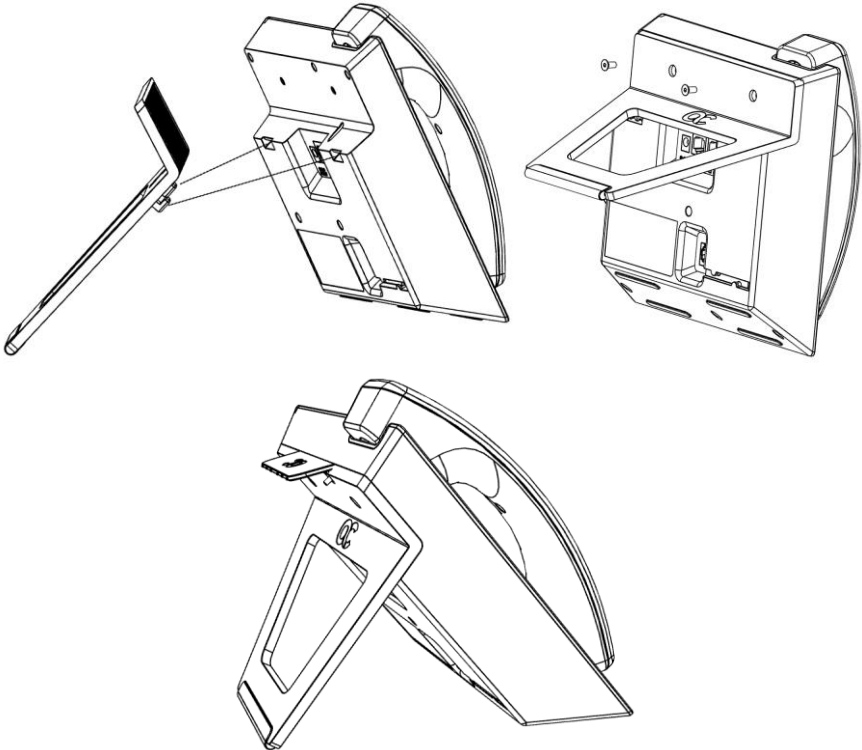

5. Mounting Phone on Wall

Use AudioCodes wall-mounting bracket kit (separate orderable item) to mount the phone on a wall. It allows you to mount the phone anywhere on a wall or to hang it on your Ethernet wall plate.

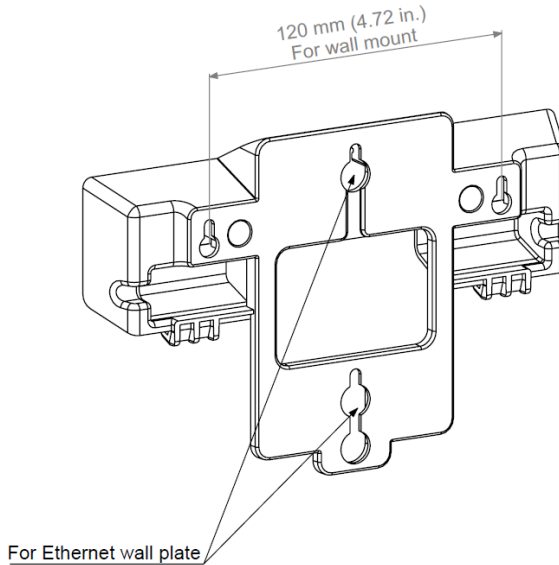

To wall-mount the phone:

1. Align the two clips of the wall-mounting bracket (separate orderable item) with the corresponding slots on the bottom of the phone.
2. Gently push the bracket down until it snaps securely into place.
3. Secure the bracket to the phone by inserting the two screws.

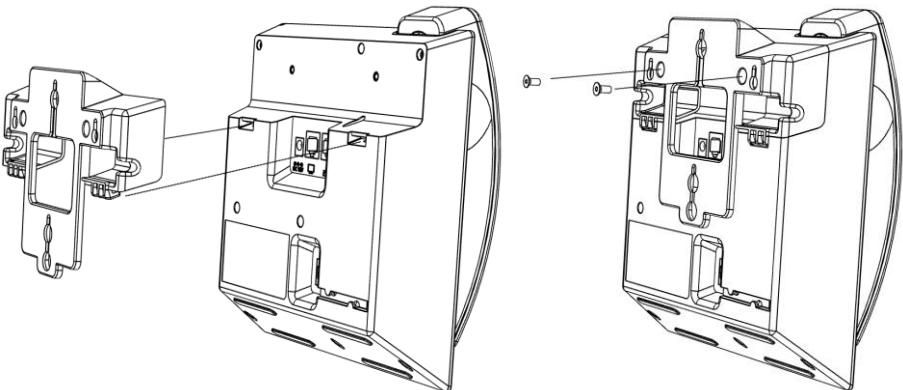

4. Mount anywhere on a wall

- a. Mark the locations of the screw holes on the wall.
- b. Drill a hole in the wall for each location.
- c. Insert wall anchors (not supplied) into the holes and insert screws (not supplied) into them.
- d. Leave a gap (approx. 5 mm) between screw head and wall for hanging the mounting bracket.
- e. Hang the bracket (attached to phone) on the screw heads and tighten the screws if necessary.

5. Hang on an Ethernet wall plate

- a. On the Ethernet wall plate, locate its two mounting standoffs used to wall-mount an IP phone:

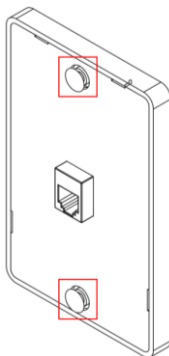

- b. Align the bracket's holes (attached to the phone) over the Ethernet wall plate's mounting standoffs shown in the preceding figure.



Note: The holes in the bracket (attached to the phone) comply with multiple mounting standoffs on Ethernet wall plates available in the market.

- c. Press the phone to hang it on the standoffs.

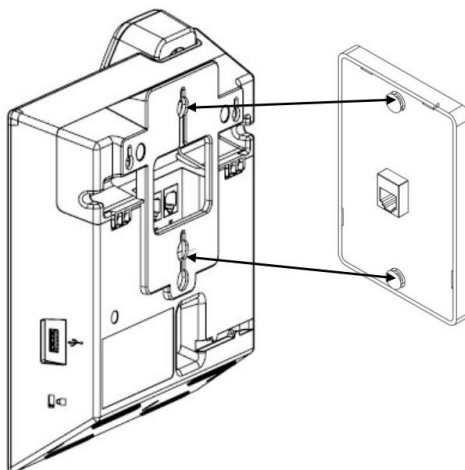

6. Signing in

To sign in with your username and password:

1. After connecting the phone to the network, it starts up and the following is displayed:



2. Open your web browser and navigate to <https://microsoft.com/devicelogin>

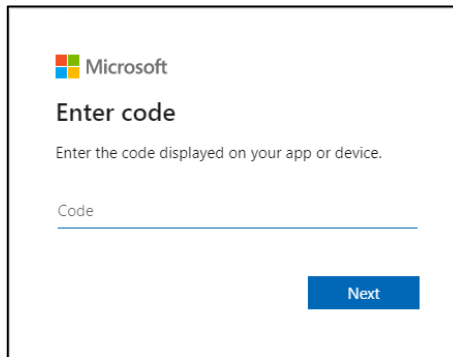

3. Enter the code provided by the phone and click **Next**.
4. In the 'Pick an account' screen, double-click the account (or click + to use another).

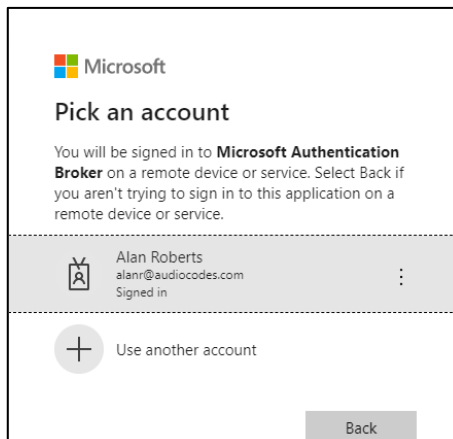

5. Enter your password (the same as the password for your pc) and then click **Sign in**.

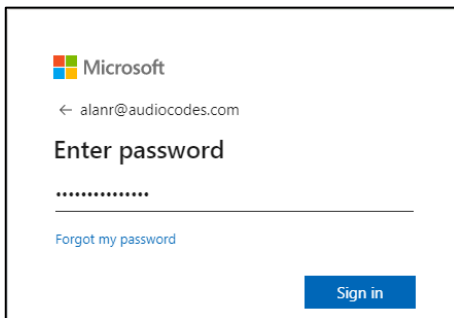

6. Navigate to and select **Got it**; the 'home' screen is displayed; you've successfully signed in to the phone.

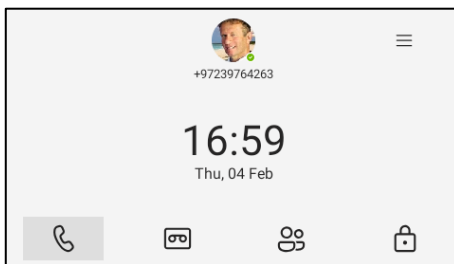

To sign out:

1. Navigate to and select , navigate to and select **Settings** and then the **Sign out** option.

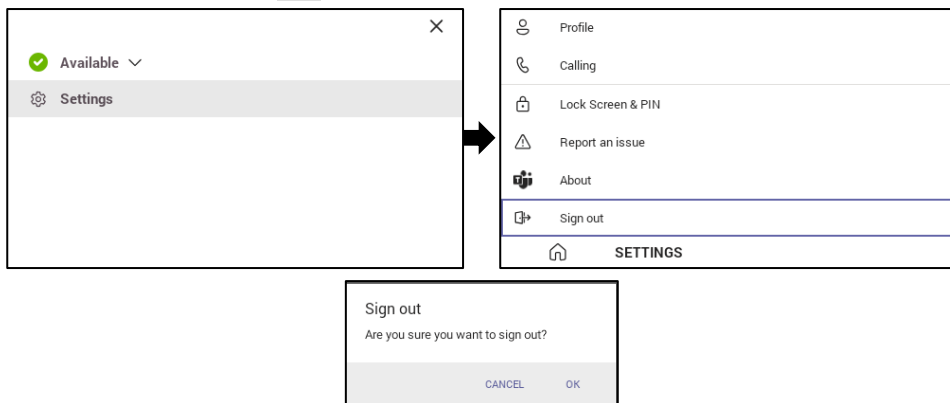

2. Navigate to and select **OK**; you're signed out of the phone.

7. Changing your Presence Status

 **To change your presence status:**

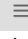
1. Navigate to and select  and then navigate to and select the current presence status displayed (**Available** in the figure below).

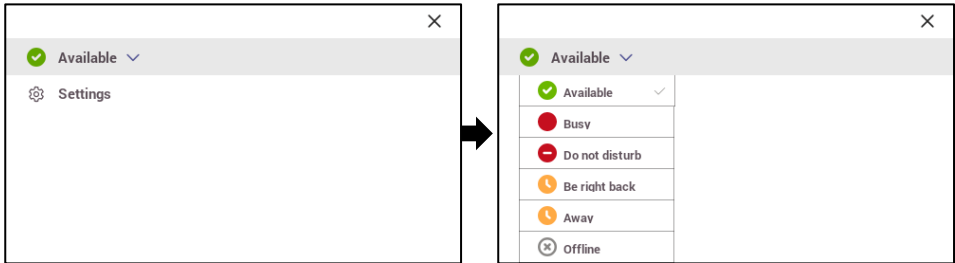

2. Navigate to and select the status you want.

8. Configuring Bluetooth



Note: You can use Bluetooth to connect the phone to a wireless headset or speaker.

 **To configure Bluetooth:**

1. Open the Bluetooth screen (in the phone's home screen touch your picture > **Settings** > **Device Settings** > **Bluetooth**).

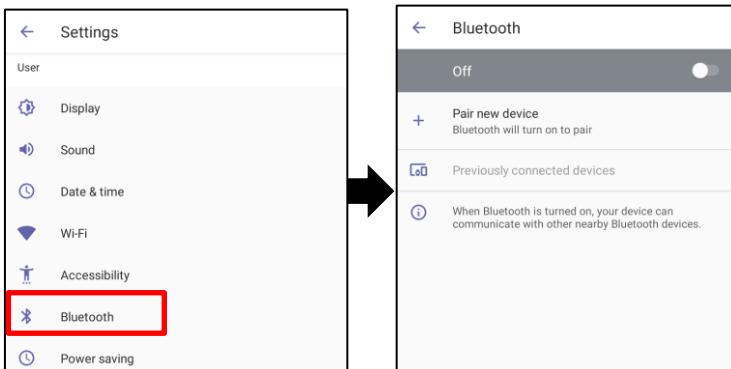

2. Touch **Off** (by default the feature is switched off).

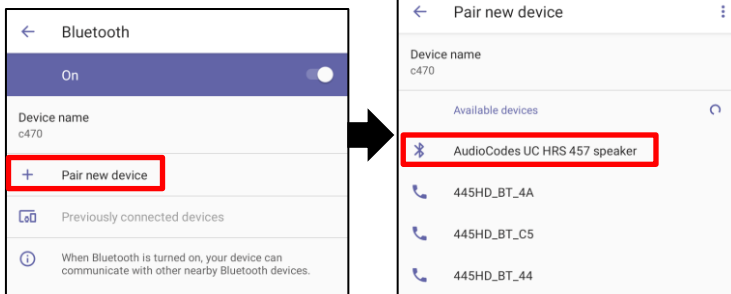

3. Touch **Pair new device** (see figure above left) and under 'Available devices' scanned (see figure above right), touch the device to pair with.

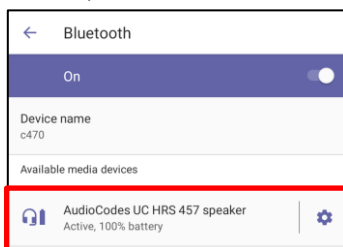

4. To unpair a device, open the Bluetooth screen (**Settings > Bluetooth**) shown in the preceding figure, and touch  adjacent to the device.

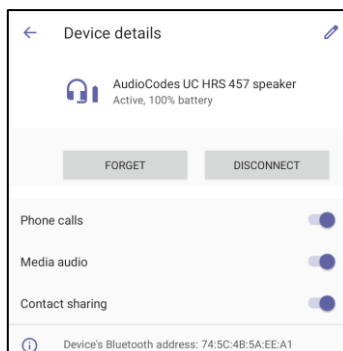

5. In the 'Device details' screen, touch **FORGET**.
6. Touch **FORGET DEVICE**; the 425HD is no longer paired with the Bluetooth device.

9. Basic Phone Operations

For basic phone operations, refer to Microsoft documentation, and AudioCodes' *425HD User's and Administrator's Manual*.

10. Warnings

FCC Caution

Part 15.21

Any Changes or modifications not expressly approved by the party responsible for compliance could void the user's authority to operate the equipment.

Part 15.19

This device complies with part 15 of the FCC Rules. Operation is subject to the following two conditions:

(1) This device may not cause harmful interference, and (2) this device must accept any interference received, including interference that may cause undesired operation.

Part 15.105

Note: This equipment has been tested and found to comply with the limits for a Class B digital device, pursuant to part 15 of the FCC Rules. These limits are designed to provide reasonable protection against harmful interference in a residential installation. This equipment generates, uses and can radiate radio frequency energy and, if not installed and used in accordance with the instructions, may cause harmful interference to radio communications. However, there is no guarantee that interference will not occur in a particular installation. If this equipment does cause harmful interference to radio or television reception, which can be determined by turning the equipment off and on, the user is encouraged to try to correct the interference by one or more of the following measures:

- Reorient or relocate the receiving antenna.
- Increase the separation between the equipment and receiver.
- Connect the equipment into an outlet on a circuit different from that to which the receiver is connected.
- Consult the dealer or an experienced radio/TV technician for help.

FCC RF Radiation Exposure Statement

1. This Transmitter must not be co-located or operating in conjunction with any other antenna or transmitter.
2. This equipment complies with RF radiation exposure limits set forth for an uncontrolled environment.
3. This equipment should be installed and operated with minimum distance 20cm between the radiator & your body.

User manuals for license-exempt radio apparatus shall contain the following or equivalent notice in a conspicuous location in the user manual or alternatively on the device or both.

This device complies with Industry Canada license-exempt RSS standard(s). Operation is subject to the following two conditions:

- (1) this device may not cause interference, and
- (2) this device must accept any interference, including interference that may cause undesired operation of the device.

Le présent appareil est conforme aux CNR d'Industrie Canada applicables aux appareils radio exempts de licence. L'exploitation est autorisée aux deux conditions suivantes :

- (1) l'appareil nedit pas produire de brouillage, et
- (2) l'utilisateur de l'appareil doit accepter tout brouillage radioélectrique subi, même si le brouillage est susceptible d'en compromettre le fonctionnement.

Radio apparatus containing digital circuitry which can function separately from the operation of a transmitter or an associated transmitter, shall comply with ICES-003. In such cases, the labelling requirements of the applicable RSS apply, rather than the labelling requirements in ICES-003. This Class B digital apparatus complies with Canadian ICES-003.

Cet appareil numérique de la classe B est conforme à la norme NMB-003 du Canada.

IC SAR Warning

This equipment should be installed and operated with minimum distance 20 cm between the radiator and your body.

Lors de l'installation et de l'exploitation de ce dispositif, la distance entre le radiateur et le corps est d'au moins 20 cm.

Notice Information

Information contained in this document is believed to be accurate and reliable at the time of printing. However, due to ongoing product improvements and revisions, AudioCodes cannot guarantee accuracy of printed material after the Date Published nor can it accept responsibility for errors or omissions. Updates to this document can be downloaded from <https://www.audiocodes.com/library/technical-documents>.

This document is subject to change without notice.

Date Published: October-28-2024

