

HUB External Photo's

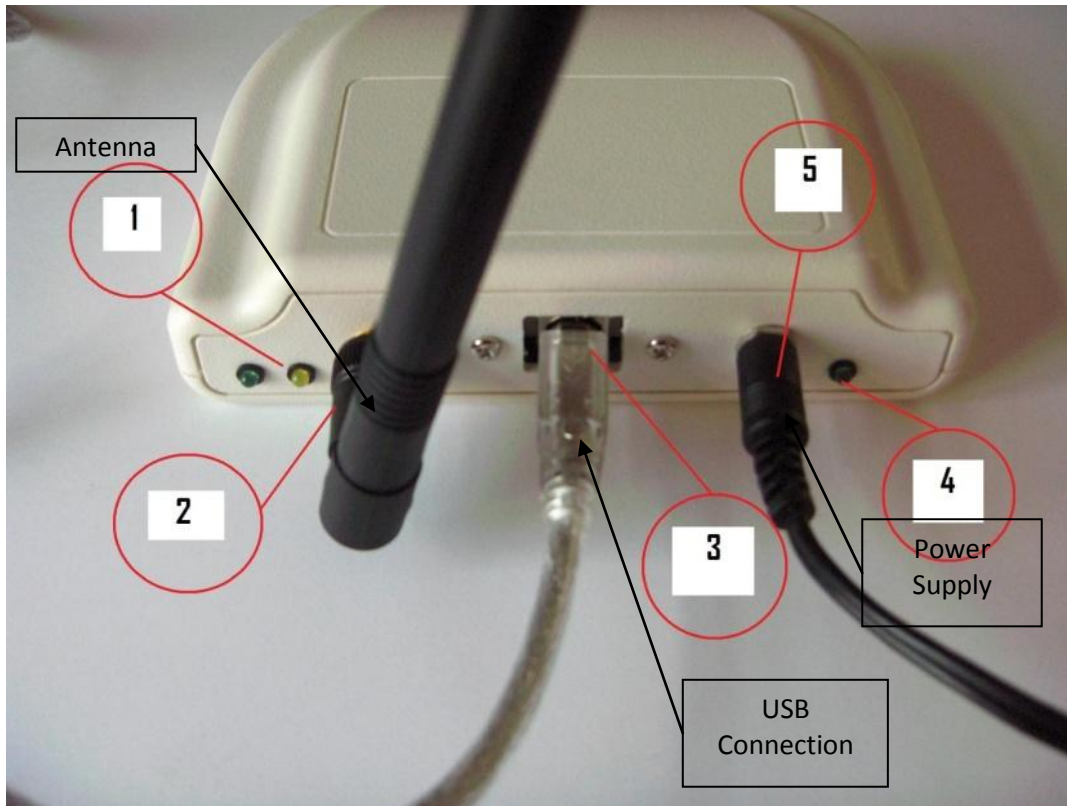

HUB External



- 1** – Green status indicator light / yellow status indicator light
- 2** – Flexible 1/2 wave center-fed dipole antenna with articulated knuckle
- 3** – USB cable type-B end, plugged into the HUB assembly
- 4** – Green power indicator light – this should illuminate whenever the HUB is correctly connected to a power source
- 5** – Barrel jack plug of *HUB Power Supply* (**Error! Reference source not found.**), plugged into the barrel jack of the HUB assembly

