

1 Appearance

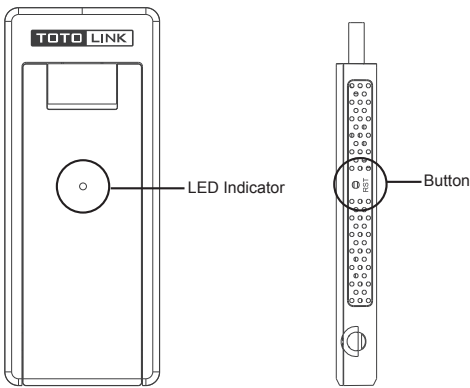

LED Status Description

Status	Description
Solid Red	The extender is starting or extending
Solid Orange	The extender finished starting or Wi-Fi extension failed
Solid Green	Wi-Fi extension is successful
Blinking Red/Orange	WPS is enabled
Blinking Orange	The RST button has been pressed for more than 5 seconds

Button

RST	Press the RST button for about 2 seconds, WPS function enabled. Press the RST button for more than 5 seconds until the LED indicator blinks orange, the device will restore to factory default settings.
-----	---

2 Quick Setup by Smart Phone

1 Power on. Plug the device into any USB Adapter supplied 5V 1A that near the router.Wait until the LED turns to solid orange.

2 Connect to the Extender. Using your smart phone to search and connect Wi-Fi TOTOLINK_EX200U. (Settings—Wi-Fi)

3 Login. The Setting page will turn up automatically. Click **Extender Mode**. If below window doesn't appear, please open a browser and enter **192.168.0.254** manually.

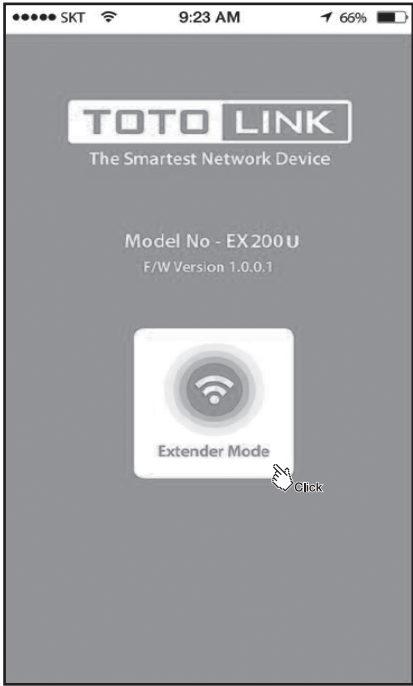
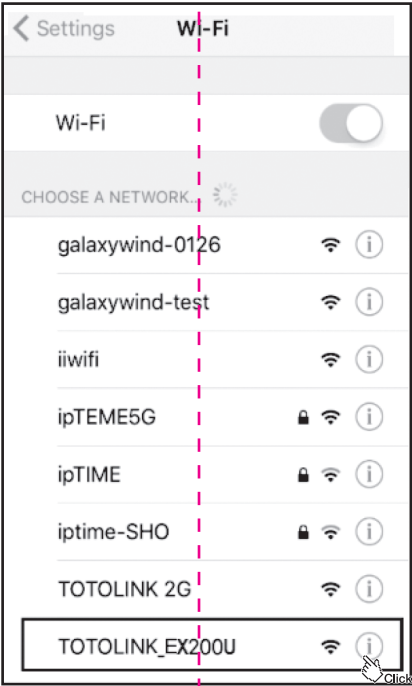

2 Quick Setup by Smart Phone

4 Extend Wi-Fi. Choose your router's 2.4GHz SSID.

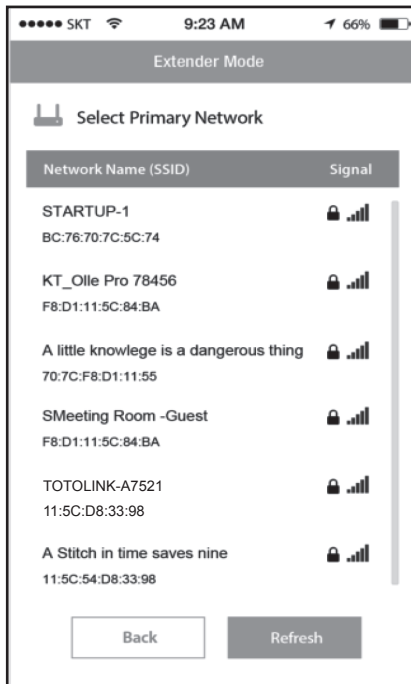

5 Configure. Enter its wireless password. Either keep the default SSID or customize it for extended 2.4GHz wireless network. Verify your settings and click **Connect**.

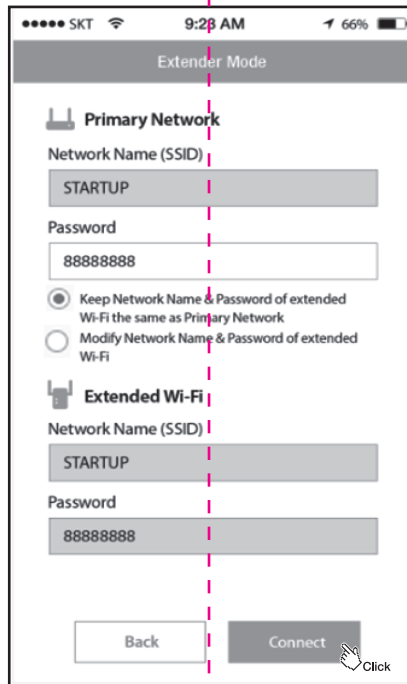

6 Verify. Check the LED status to verify whether the Wi-Fi extension is successful.

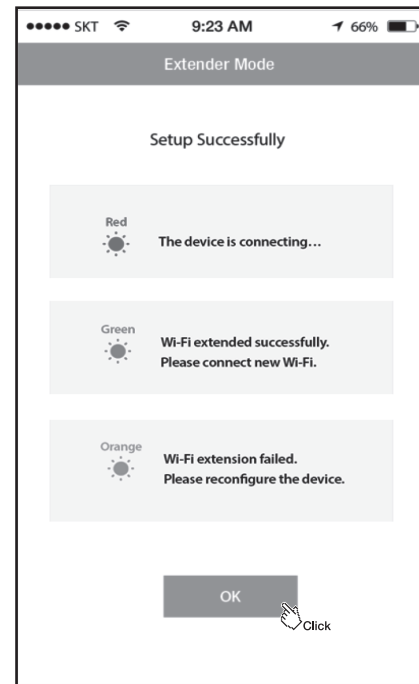

3 Relocate

1 Plug the extender into USB port that halfway between your router and the Wi-Fi dead zone. Wait about 30 seconds until the LED light turns to solid green. If not, please relocate it closer to your router to achieve better signal quality.

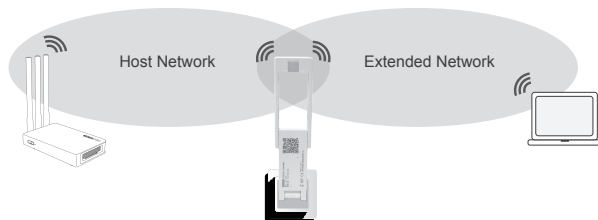

2 In order to make full use of extender, please keep the antennas of the extender perpendicular to the horizontal plane. See blow:

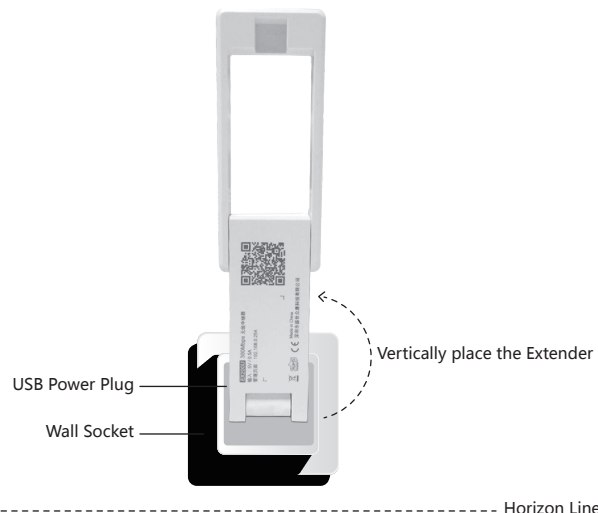

4 FAQ (Frequently Asked Questions)

1 What should I do if I cannot access the extender's web management page?

A1: Make sure you have connected to the wireless network of the extender.

A2: Open any browser, enter **192.168.0.254** in the address bar and press **Enter**.

A3: Reset the extender and connect to it again.

2 How to reset the extender to factory default settings?

Keep the extender power on, use a pin to press the RST button on the side of device. When the LED blinks orange, release the button.

FCC warning:

This device complies with Part 15 of the FCC Rules. Operation is subject to the following two conditions: (1) this device may not cause harmful interference, and (2) this device must accept any interference received, including interference that may cause undesired operation. changes or modifications not expressly approved by the party responsible for compliance could void the user's authority to operate the equipment.

NOTE: This equipment has been tested and found to comply with the limits for a Class B digital device, pursuant to Part 15 of the FCC Rules. These limits are designed to provide reasonable protection against harmful interference in a residential installation. This equipment generates, uses and can radiate radio frequency energy and, if not installed and used in accordance with the instructions, may cause harmful interference to radio communications. However, there is no guarantee that interference will not occur in a particular installation. If this equipment does cause harmful interference to radio or television reception, which can be determined by turning the equipment off and on, the user is encouraged to try to correct the interference by one or more of the following measures:

- Reorient or relocate the receiving antenna.
- Increase the separation between the equipment and receiver.
- Connect the equipment into an outlet on a circuit different from that to which the receiver is connected.
- Consult the dealer or an experienced radio/TV technician for help.

For this device, SAR tests are conducted using standard operating positions accepted by the FCC with the device transmitting at its highest certified power level in all tested frequency bands, although the SAR is determined at the highest certified power level, the actual SAR level of the device while operating can be well below the maximum value,

For body worn operation, this device has been tested and meets the FCC RF exposure guidelines when used with an accessory designated for this product or when used with an accessory that contains no metal and that positions the handset a minimum of 5 mm from the body.