



USER'S GUIDE

V:1457-0312-09

IS819B

Wireless Music System with Dock for iPod

CONTENTS

WARNINGS AND PRECATIONS	2
PRODUCT INFORMATION	4
FEATURES.....	4
IN THE BOX	4
POWERING THE UNIT & REMOTE	5
AC POWER CORD	5
REMOTE BATTERIES	5
POWERING THE SPEAKERS	5
AC POWER CORD	5
BATTERY POWER.....	5
BATTERY BACKUP.....	5
WIRELESS CONNECTIVITY	6
PAIRING SPEAKERS WITH THE UNIT	6
LINK INDICATOR.....	6
USING THE WIRELESS REMOTE.....	6
IPOD OPERATIONS	7
DOCKING AN IPOD	7
PLAYING AN IPOD	7
CLOCK OPERATIONS	8
SETTING THE TIME	8
SETTING THE TIMER.....	8
IPOD OPERATIONS	9
TUNING THE AM/FM RADIO.....	9
SAVING A RADIO STATION TO THE UNIT'S MEMORY	9
USING THE AUXILIARY INPUT	9
CLOCK OPERATIONS	10
IPOD OPERATIONS	11
CLOCK OPERATIONS	12
IPOD OPERATIONS	13
CLOCK OPERATIONS	14
IPOD OPERATIONS	15
COMPANY INFORMATION	16
GREEN INITIATIVE	16
INTERNATIONAL SUPPORT	16
SERVICE INFORMATION.....	16

For the most up-to-date version of this User's Guide, go to www.ilive.net





WARNINGS AND PRECATIONS

- **CAUTION:** TO PREVENT ELECTRIC SHOCK, MATCH WIDE BLADE OF PLUG TO WIDE SLOT, FULLY INSERT.
- **WARNING:** To prevent fire or shock hazards, do not expose this unit to rain or moisture.
- **CAUTION:** Use of controls or adjustments or performance of procedures other than those specified may result in hazardous radiation exposure.
- **WARNING:** Changes or modifications to this unit not expressly approved by the party responsible for compliance could void the user's authority to operate the equipment.
- **WARNING:** Do not place the unit on top of any soft, porous, or sensitive surfaces to avoid damaging the surface. Use a protective barrier between the unit and surface to protect the surface.
- **WARNING:** Use of this unit near fluorescent lighting may cause interference regarding use of the remote. If the unit is displaying erratic behavior move away from any fluorescent lighting, as it may be the cause.
- **CAUTION:** Danger of explosion if battery is incorrectly replaced. Replace only with the same or equivalent type.
- **PRÉCAUTION:** *Danger d'explosion si les piles sont remplacées de façon incorrect. Remplacer les piles seulement par le même type de pile ou l'équivalent.*
- **WARNING:** There is a danger of explosion if you attempt to charge standard Alkaline batteries in the unit. Only use rechargeable NiMH batteries.
- **WARNING:** The remote control's button cell battery contains mercury. Do not put in the trash, instead recycle or dispose of as hazardous waste
- **WARNING:** Lithium ion batteries, like all rechargeable batteries are recyclable and should be recycled or disposed of in normal household waste. Contact your local government for disposal or recycling practices in your area. They should never be incinerated since they might explode.

Do not mix old and new batteries.
Do not mix alkaline, standard (carbon-zinc), or rechargeable (ni-cad, ni-mh, etc) batteries. Tum que omante, vid pecesim aximei igingultum pubitere comant. Casta,



The lightning flash with arrowhead symbol, within an equilateral triangle, is intended to alert the user to the presence of uninsulated "dangerous voltage" within the product's enclosure that may be of sufficient magnitude to constitute a risk of electric shock to persons.

CAUTION

RISK OF ELECTRIC SHOCK
DO NOT OPEN

WARNING: TO REDUCE THE RISK OF ELECTRIC SHOCK, DO NOT REMOVE COVER (OR BACK). NO USER-SERVICEABLE PARTS INSIDE. REFER SERVICING TO QUALIFIED SERVICE PERSONNEL.



The exclamation point within an equilateral triangle is intended to alert the user to the presence of important operating and maintenance (servicing) instructions in the literature accompanying the appliance.



This product utilizes a Class 1 laser to read Compact Discs. This laser Compact Disc Player is equipped with safety switches to avoid exposure when the CD door is open and the safety interlocks are defeated. Invisible laser radiation is present when the CD Player's lid is open and the system's interlock has failed or been defeated. It is very important that you avoid direct exposure to the laser beam at all times. Please do not attempt to defeat or bypass the safety switches.





IMPORTANT SAFETY INSTRUCTIONS

1. Read these Instructions.
2. Keep these Instructions.
3. Heed all Warnings.
4. Follow all instructions.
5. Do not use this apparatus near water.
6. Clean only with a dry cloth.
7. Do not block any ventilation openings. Install in accordance with the manufacturer's instructions.
8. Do not install near any heat sources such as radiators, heat registers, stoves, or other apparatus (including amplifiers) that produce heat.
9. Do not defeat the safety purpose of the polarized or grounding - type plug. A polarized plug has two blades with one wider than the other. A grounding type plug has two blades and a third grounding prong. The wide blade or the third prong are provided for your safety. When the provided plug does not fit into your outlet, consult an electrician for replacement of the obsolete outlet.
10. Protect the power cord from being walked on or pinched particularly at plugs, convenience receptacles, and the point where they exit from the apparatus.
11. Only use attachments/accessories specified by the manufacturer.
12. Use only with a cart, stand, tripod, bracket, or table specified by the manufacturer, or sold with the apparatus. When a cart is used, use caution when moving the cart/apparatus combination to avoid injury from tip-over.



13. Unplug this apparatus during lightning storms or when unused for long periods of time.
14. Refer all servicing to qualified service personnel. Servicing is required when the apparatus has been damaged in any way, such as power-supply cord or plug is damaged, liquid has been spilled or objects have fallen into the apparatus, the apparatus has been exposed to rain or moisture, does not operate normally, or has been dropped.

Additional Warnings

- The apparatus shall not be exposed to dripping or splashing and that no objects filled with liquids, such as vases, shall be placed on apparatus.
L'appareil ne doit pas être exposé aux écoulements ou aux éclaboussures et aucun objet ne contenant de liquide, tel qu'un vase, ne doit être placé sur l'objet.
- Main plug is used as disconnect device and it should remain readily operable during intended use. In order to disconnect the apparatus from the mains completely, the mains plug should be disconnected from the mains socket outlet completely.
La prise du secteur ne doit pas être obstruée ou doit être facilement accessible pendant son utilisation. Pour être complètement déconnecté de l'alimentation d'entrée, la prise doit être débranchée du secteur.
- Battery shall not be exposed to excessive heat such as sunshine, fire or the like.
Les piles ne doivent pas être exposées à de forte chaleur, tel qu'à la lumière du soleil, au feu ou autres choses de semblable.
- Caution marking is located at the bottom of apparatus.
Les précautions d'emploi sont inscrites en bas de l'appareil.
- The marking information is located at the bottom of apparatus.
Les marquages sont inscrits en bas de l'appareil.

FCC Warnings

NOTE: This equipment has been tested and found to comply with the limits for a Class B digital device, pursuant to Part 15 of the FCC Rules. These limits are designed to provide reasonable protection against harmful interference in a residential installation. This equipment generates, uses, and can radiate radio frequency energy and, if not installed and used in accordance with the instructions, may cause harmful interference to radio communications. However, there is no guarantee that interference will not occur in a particular installation. If this equipment does cause harmful interference to radio or television reception, which can be determined by turning the equipment off and on, the user is encouraged to try to correct the interference by one or more of the following measures:

- Reorient or relocate the receiving antenna.
- Increase the separation between the equipment and receiver.
- Connect the equipment into an outlet on a circuit different from that to which the receiver is connected.
- Consult the dealer or an experienced radio/TV technician for help.





PRODUCT INFORMATION

FEATURES

Dock plays and charges iPod

Wireless speakers

AM/FM radio

Supports multiple speakers

Advanced hi-fi sound with Channel Purity®

Remote

Digital volume control

Pairing button

Left, right, or mono selections

Weather resistant

Digital 2.4GHz ISM wireless transmitter

LCD display with white backlight

Digital clock

Play/pause, skip up/down functions for iPod

On/Off, mute, function and pairing controls

Independent volume settings for each speaker

Transmission range: 200ft line of sight, 90ft indoors

Auxiliary input for iPod shuffle and other audio devices

AC power: built-in AC cord

DC power: requires 6 AA batteries per speaker, not included

Includes: remote control, docking brackets for iPod

IN THE BOX

IS819B

RF Wireless Remote Control

Docking Brackets for iPod

Documentation



POWERING THE UNIT & REMOTE

AC POWER CORD

Plug the included AC cord into a standard AC outlet (120V~60Hz)

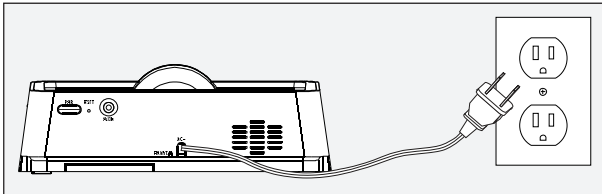

BATTERY BACKUP

Requires 2 AA batteries, not included.

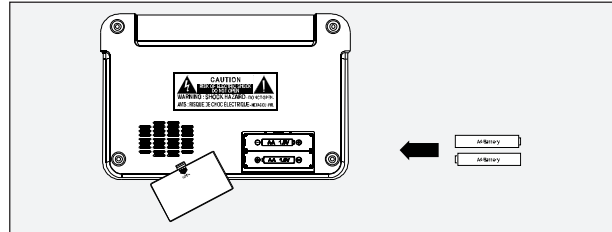

The battery backup is meant for short, unexpected power outages. The unit cannot fully function off of the backup batteries alone.

REMOTE BATTERIES

Requires 2 AA batteries, not included.

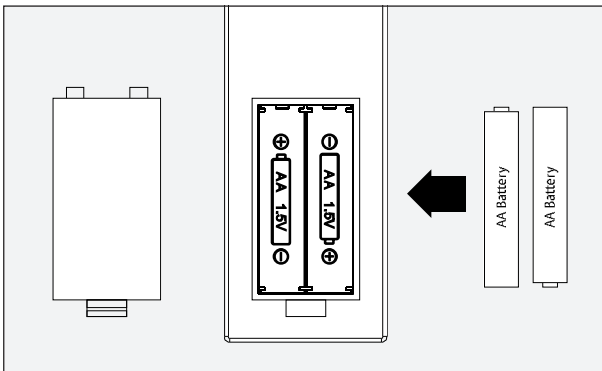

POWERING THE SPEAKERS

AC POWER CORD

Plug the included AC cord into a standard AC outlet (120V~60Hz)

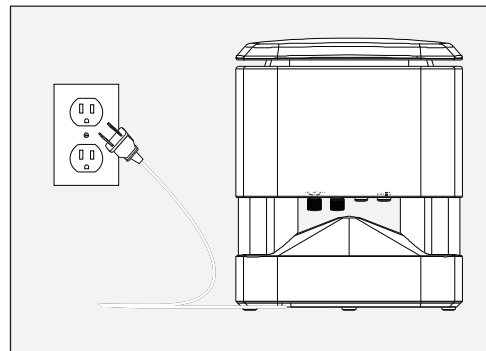

BATTERY POWER

Battery Power (Requires 6 D batteries, not included)

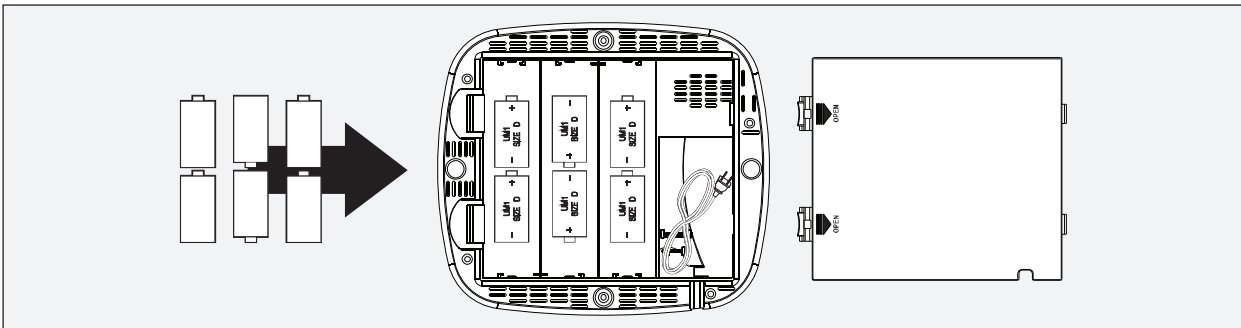



WIRELESS CONNECTIVITY

PAIRING SPEAKERS WITH THE UNIT

Note: The speakers need to be paired with the unit before any audio can be heard.

1. Press the Power Button on the unit to turn the unit on.
2. Press the Power Button on the speakers to turn the speakers on.
3. Press and hold the Pair Button on the unit until the Link Indicator begins blinking.
4. Note: The Link Indicators will flash when the unit is in Standby Mode.
5. Press and hold the Pair Button on the speakers until the Link Indicator begins blinking.
6. The Link Indicator will shine solid on both the unit and speaker once they are paired together.

Transmission range: 200ft line-of-sight, 90ft indoors (please consider these numbers estimates, as results will vary depending on location).

Caution: The included speakers are not designed for use outdoors. Any exposure to precipitation may ruin the speakers.

LINK INDICATOR

Off- The unit is powered off.

Flashing- The unit is in *Standby Mode*.

Blinking- The unit is attempting to pair with nearby wireless speakers.

Solid- The unit is paired with one or more nearby wireless speakers and playing.

USING THE WIRELESS REMOTE

The included remote is wireless and does not require line-of-sight to control the unit.

The wireless remote can control the unit from approximately half the distance of the speaker reception. (Approximately 100ft line-of-sight, or 45ft indoors depending on location)

The **Volume Buttons** on the remote control will adjust the master volume of the unit, affecting all linked speakers.

The included speakers have independent volume controls that can be used to fine tune the volume of the individual speakers.





IPOD OPERATIONS

DOCKING AN IPOD

1. Locate the numbered bracket that fits the iPod that will be docked.

Each included Bracket has a number on it, indicating which iPod model that bracket is compatible with. See the separate bracket chart page to identify which bracket is needed.

2. Snap the bracket into place over the **iPod Connector** in the dock.
3. Connect the iPod to the **iPod Connector** inside the dock.

When the unit is plugged in, using AC power, the docked iPod will charge.

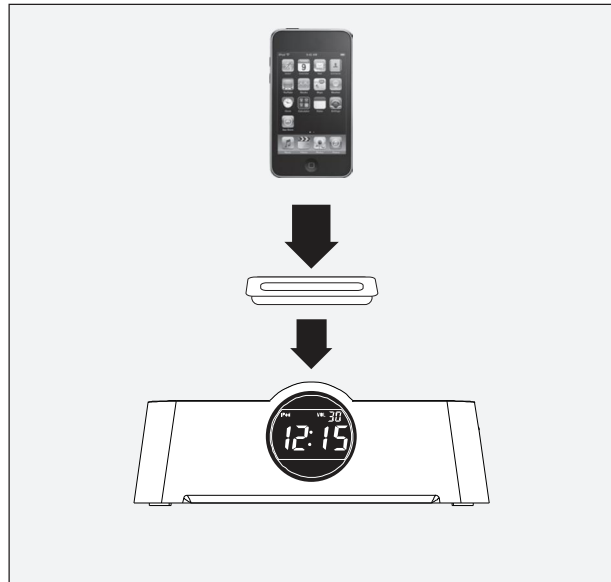

PLAYING AN IPOD

1. After Docking an iPod, press the **Power Button** to turn the unit on.
2. Press the **Source Button** to switch to *iPod Mode*.
3. Press the **Play/Pause Button** to begin playing audio from the docked iPod.
 - Press the **iPod Menu/Mem Button** to move back to previous menus on a docked iPod.

This button works exactly like the menu button on an iPod.
 - Press the **Select Button** to make selections on a docked iPod.

This button works exactly like the select button on an iPod.
 - Press the **Menu/Presets +** and **Menu/Presets - Buttons** to move up and down in any of the iPod menus.
 - Press the **Skip/Tun -** and **Skip/Tun+ Buttons** to skip between tracks on a docked iPod.
 - Press and hold the **Skip/Tun -** and **Skip/Tun+ Buttons** to search and individual track on a docked iPod.



CLOCK OPERATIONS

SETTING THE TIME

1. Press the **Power Button** to turn the unit off.
2. Press and hold the **Time/Dimmer Button**.
3. While holding the **Time/Dimmer Button**, press the **Skip/Tun- Button** to adjust the hour, and the **Skip/Tun+ Button** to adjust the minutes.

A “PM” indicator will appear on the display when the time is set in the PM.

4. Release the **Time/Dimmer Button** to finish setting the time.

SETTING THE TIMER

1. Press the **Power Button** to turn the unit on.
2. Press and hold the **Timer On/Off Button**.
3. While holding the **Timer On/Off Button**, press the **Skip/Tun- Button** to adjust the hour, and the **Skip/Tun+ Button** to adjust the minutes.

A “PM” indicator will appear on the display when the time is set in the PM.

4. Press the **Source Button** to adjust the timer source.

The Timer Source is the function that the unit will power on to when the set time is reached.

5. Release the **Timer On/Off Button** to finish setting the timer.
6. Press the **Power Button** to turn the unit off.
7. Press the **Timer On/Off Button** to activate or deactivate the timer.

The text “Timer On” will appear on the display when the timer is activated.



IPOD OPERATIONS

TUNING THE AM/FM RADIO

1. Press the **Power Button** to turn the unit on.
2. Press the **Source Button** to switch to *AM* or *FM Radio Mode*.
3. Press the **Skip/Tun-** and **Skip/Tun+** **Buttons** to adjust the AM or FM radio station.

SAVING A RADIO STATION TO THE UNIT'S MEMORY

1. After tuning the radio to the desired station, press the **iPod Menu/Mem Button**.
2. Press the **Menu/Preset +** and **Menu/Preset - Buttons** to select the memory slot to save the current station to.
Up to 20 AM and 20 FM stations can be saved.
3. Once the desired memory slot is selected, press the **iPod Menu/Mem Button** to save the current AM or FM station to that memory slot.
4. Press the **Menu/Preset +** and **Menu/Preset - Buttons** to cycle through saved AM and FM radio stations.

USING THE AUXILIARY INPUT

1. Connect an MP3 Player or other audio source to the **Auxiliary Input**.
2. Press the **Power Button** to turn the unit on.
3. Press the **Source Button** to switch the unit to *Aux Mode*.
Use the connected device's controls to control the audio playing through the unit.



CLOCK OPERATIONS

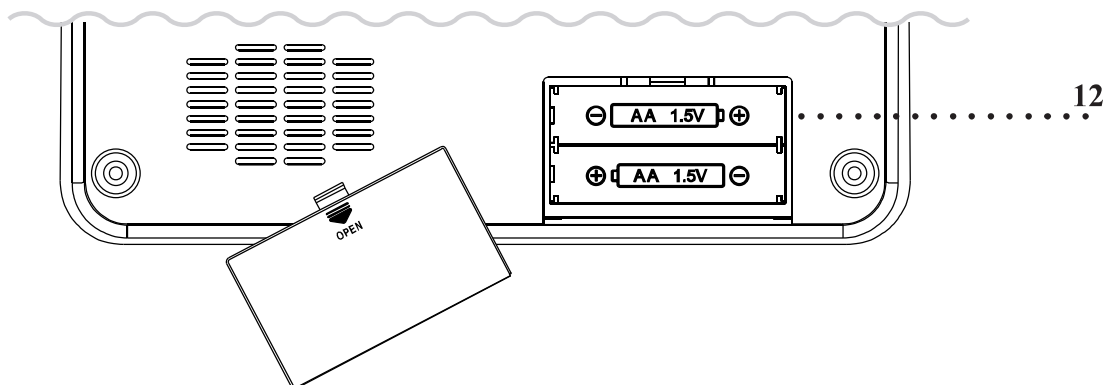
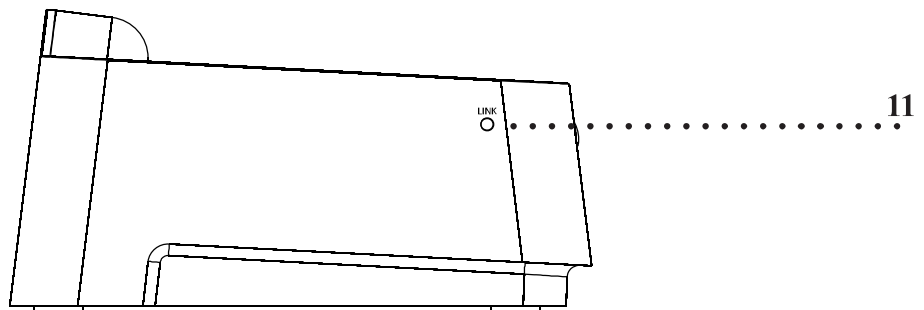
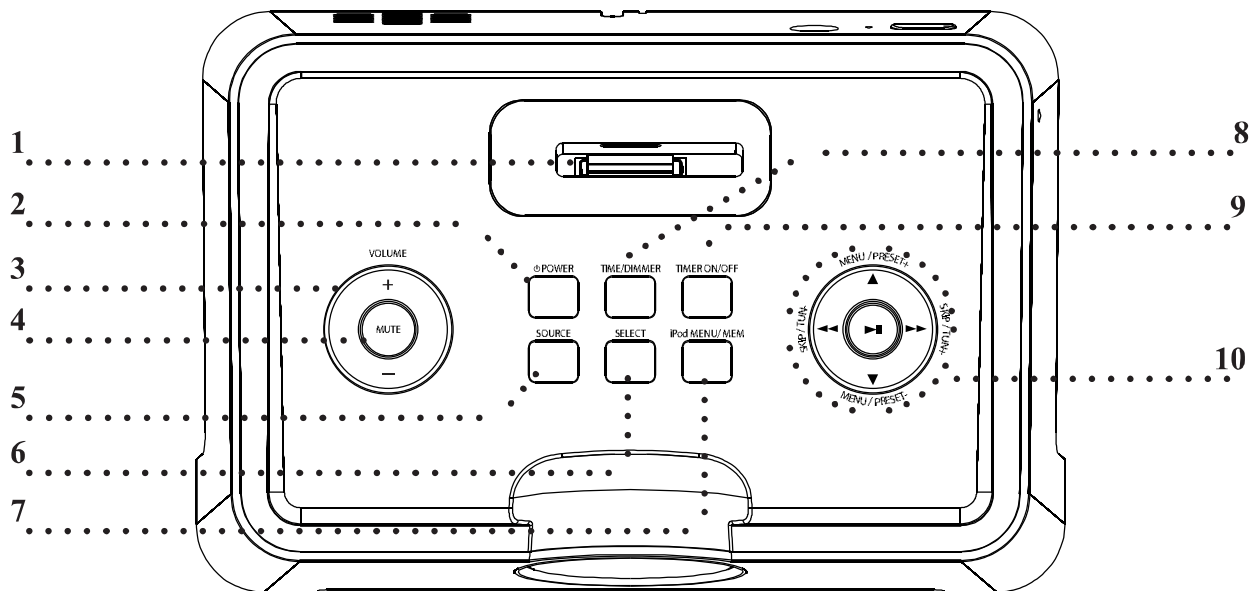



IPOD OPERATIONS

01. iPod Connector

Use the iPod Connector to dock an iPod onto the unit.

02. Power Button

Press the Power Button to turn the unit off and on.

03. Volume Buttons

Press the Volume Buttons to adjust the volume of the unit.

04. Mute Button

Press the Mute Button to mute the volume of the unit.

05. Source Button

Press the Source Button to switch between *iPod*, *AM*, *FM*, and *Aux Modes*.

06. Select Button

Press the Select Button to make selections on a docked iPod.

07. iPod Menu/Mem Button

Press the iPod Menu Button to move to the previous menu on a docked iPod.

This button works exactly like the menu button on an iPod.

Press the Mem Button to save the current AM or FM radio station to the unit's memory.

Up to 20 AM and 20 FM stations can be programmed.

08. Time/Dimmer Button

With the unit powered off, press the Time Button to set the unit's time.

With the unit powered on, press the Dimmer Button to adjust the brightness of the display.

09. Timer On/Off Button

With the unit powered on, press the Timer On/Off Button to set the timer.

With the unit powered off, press the Timer On/Off Button to activate or deactivate the timer.

10. Menu/Preset+ & Menu/Preset- Button

Press the Menu + and Menu - Buttons to move up and down through the menus on a docked iPod

Press the Preset+ and Preset - Buttons to move through the preset AM and FM radio stations.

• Skip/Tun- & Skip/Tun+ Buttons

Press the Skip Buttons to skip through tracks on a docked iPod.

Press and hold the Skip Buttons to search through an individual track on a docked iPod.

Press the Tun- and Tun+ Buttons to tune the AM or FM radio.

• Play/Pause Button

Press the Play/Pause Button to play or pause a docked iPod.

11. Link Indicator

Off- The unit is powered off.

Flashing- The unit is in *Standby Mode*.

Blinking- The unit is attempting to pair with nearby wireless speakers.

Solid- The unit is paired with one or more nearby wireless speakers and playing.

12. Battery Compartment

Requires 2 AA batteries, not included.



CLOCK OPERATIONS

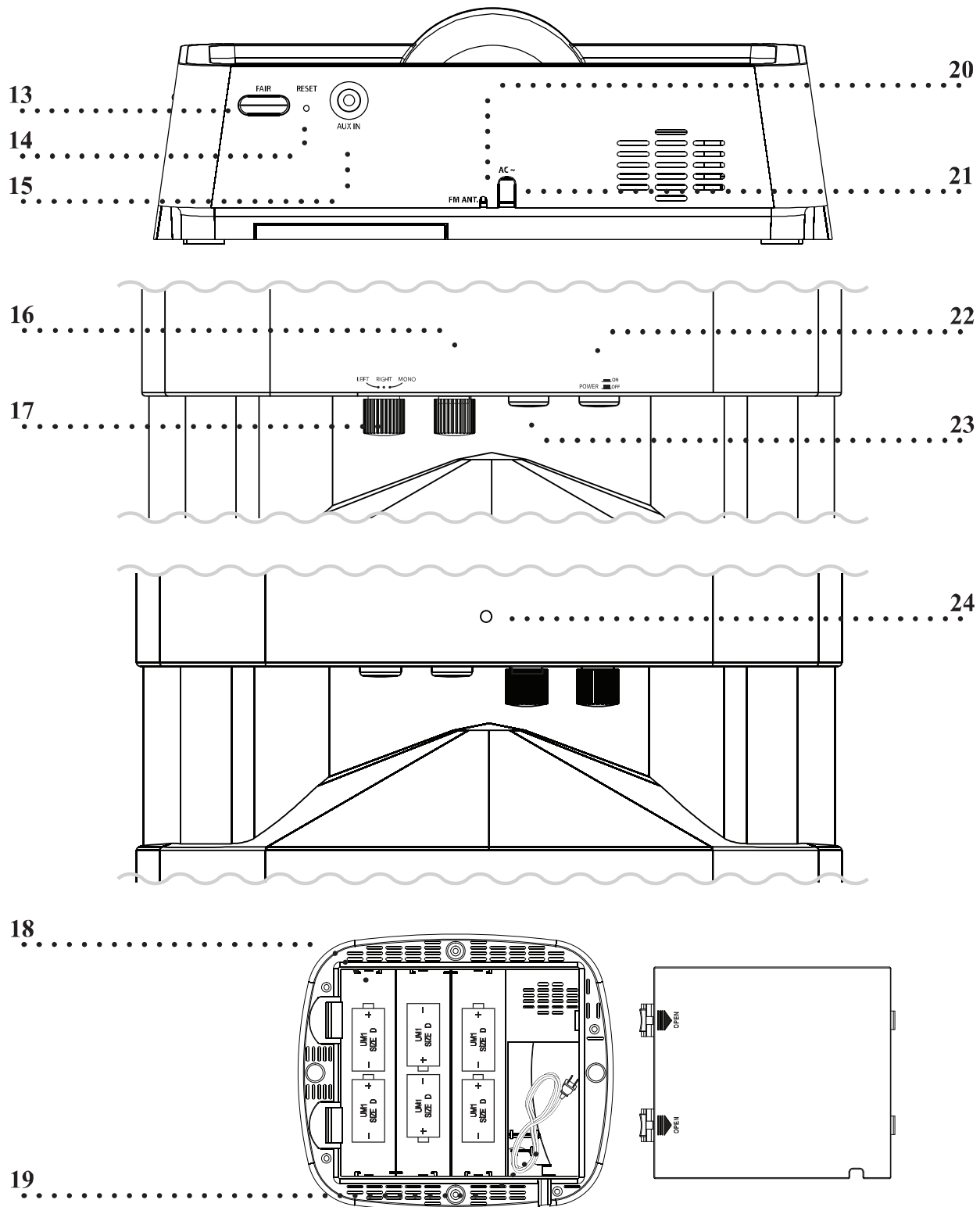

Caution: The included speakers are not designed for use outdoors. Any exposure to precipitation may ruin the speakers.





IPOD OPERATIONS

13. Pair Button

Press the Pair Button to pair the unit to wireless speakers.

14. Reset Button

Use a paperclip or like object to press the Reset Button and reset the unit to its default settings.

15. Auxiliary Input

Use the Auxiliary Input to connect an MP3 player or other audio source to the unit.

16. Volume Dial

Turn the Volume Dial to adjust the volume of the speaker.

The included speakers have independent volume controls that can be used to fine tune the volume of the individual speakers.

*The **Volume Buttons** on the remote control will adjust the master volume of the unit, affecting all linked speakers.*

17. Left/Right/Mono Button

Turn the Left/Right/Mono Button to switch between *left*, *right*, and *mono speaker modes*.

18. Battery Compartment (Requires 6 D batteries, not included)

19. AC Power Cord

Use the AC Power Cord to power the speakers as an alternative to using battery power.

20. FM Wire Antenna

Use the FM Wire Antenna to improve FM radio reception

An AM antenna is built into the unit. Adjust the position of the unit to improve AM radio reception.

21. AC Power Cord

Use the AC Power Cord to power the speakers as an alternative to using battery power.

22. Power Button

Press the Power Button to turn the speakers on and off.

23. Pair Button

Press and hold the Pair Button to have the speaker search for a nearby unit to link to.

24. Link Indicator

Off- The unit is powered off.

Flashing- The unit is in *Standby Mode*.

Blinking- The unit is attempting to pair with nearby wireless speakers.

Solid- The unit is paired with one or more nearby wireless speakers and playing.



CLOCK OPERATIONS

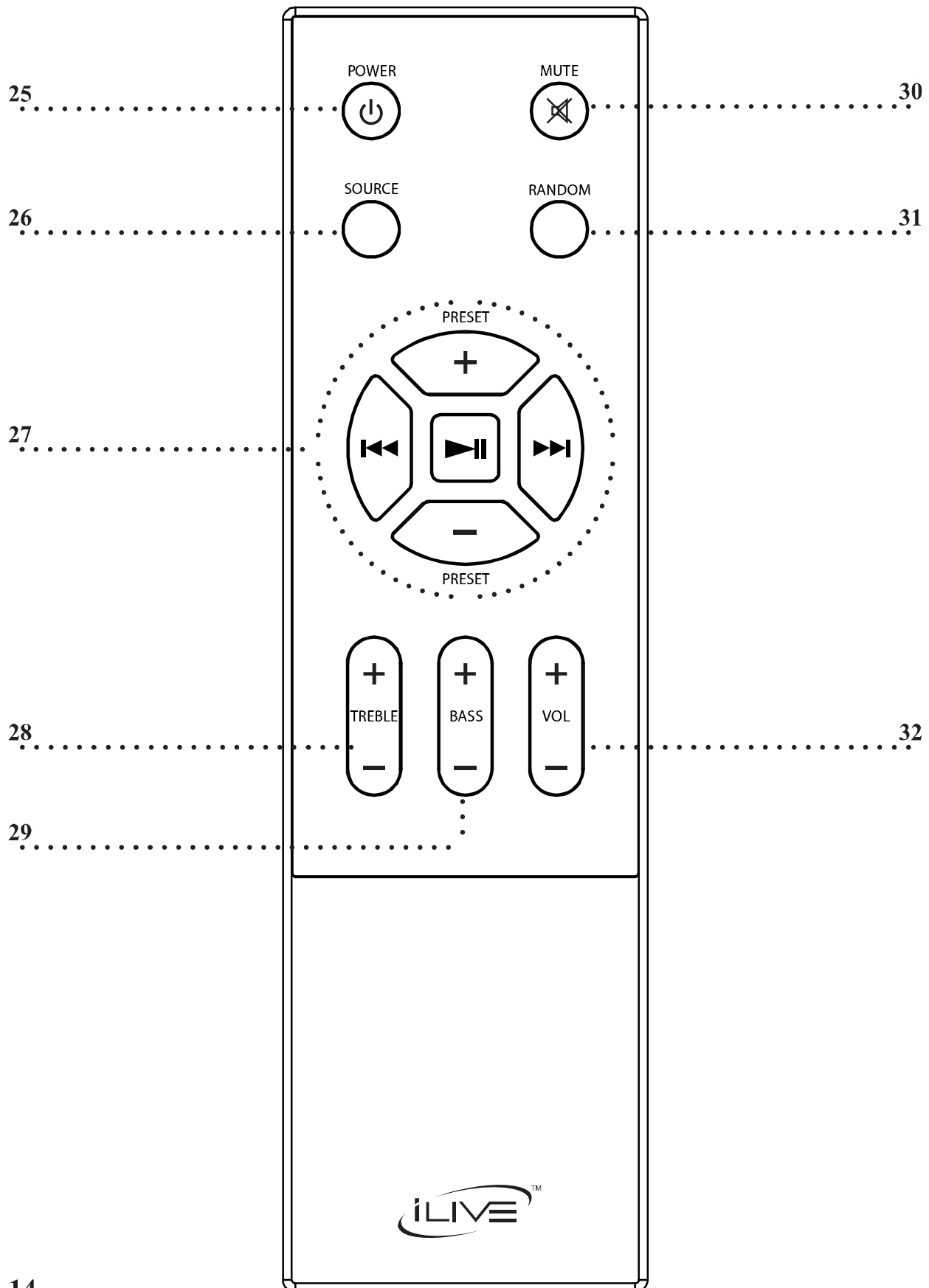



IPOD OPERATIONS

25. Power Button

Press the Power Button to turn the unit off and on.

26. Source Button

Press the Source Button to switch between *iPod*, *AM*, *FM*, and *Aux Modes*.

27. Skip/Search Buttons

Press the Skip/Search Buttons to skip between tracks on a docked iPod

Press and hold the Skip/Search Buttons to search through an individual track on a docked iPod.

- **Preset + & Preset - Buttons**

Press the Preset + & Preset - Buttons to cycle through AM and FM radio stations saved to the unit's memory.

- **Play/Pause Button**

Press the Play/Pause Button to play or pause a docked iPod.

28. Treble Buttons

Press the Treble Buttons to adjust the level of treble output from the unit.

29. Bass Buttons

Press the Bass Buttons to adjust the level of bass output from the unit.

30. Mute Button

Press the Mute Button to mute the volume of the unit.

31. Random Button

Press the Random Button to activate the *Shuffle Mode* and play tracks on a docked iPod in random order.

This activates the native Shuffle Mode on the docked iPod.

32. Volume Buttons

Press the Volume Buttons to adjust the volume of the unit.



COMPANY INFORMATION

GREEN INITIATIVE

Environmental Commitment to ‘Protect for Today and Sustain for Tomorrow’

2009 marks the official launch of DPI, Inc.’s corporate campaign for a greener and cleaner world. DPI and its four brands, iLive, WeatherX, Capri, and GPX, are building upon environmental initiatives introduced at all of their facilities to help formulate and sustain significant and important conservation efforts within its manufacturing and marketing communities. In addition to targeting and selecting energy efficient product features, and structuring ‘green office’ procedures, other initial program efforts include:

- Reduction of all packaging sizes
- Recyclable plastics for clamshell packages, with a plan to eventually replace plastic with recyclable paper
- Recycled fiber board in place of the polyfoam in packing boxes
- Recycled plastics in place of the virgin material in product construction

INTERNATIONAL SUPPORT

To download this User’s Guide in English, Spanish, or French, visit the support section at www.ilive.net.

Para transferir esta guía de usuario en inglés, español, o francés, visite la sección de la ayuda en www.ilive.net.

Pour télécharger ce guide de l’utilisateur en anglais, espagnol, ou français, visitez la section de soutien chez www.ilive.net.

SERVICE INFORMATION

Address: 2116 Carr Street, St. Louis MO, 63106

Phone: 1-314-621-2881

Fax: 1-314-588-1805

Email: customerservice@ilive.net

Parts Email: partsinfo@dpi-global.com

Website: www.ilive.net