

**·faurecia clarion**

## **Owner's Manual**

**P2401**

## Table of contents

<b>1. System Overview</b>	<b>2</b>
Control of This Unit	2
Steering Remote Control	3
<b>2. Shortcut Operations</b>	<b>4</b>
<b>3. Home Main Menu</b>	<b>5</b>
Customize Home Main Menu	5
<b>4. Home Menu</b>	<b>6</b>
<b>5. Media Playback</b>	<b>7</b>
Switching Media Source	7
Listening to AM/FM	7
Other Medias Playback	7
<b>6. Device Management (Bluetooth, Apple CarPlay, Android Auto)</b>	<b>9</b>
About Device Management and Connection	9
Using Bluetooth	9
Using Apple CarPlay	10
Using Android Auto	10
<b>7. Settings System</b>	<b>11</b>
<b>8. Specifications</b>	<b>12</b>
Declaration of conformity	12
Operation radio frequency	12
Operation frequency	12
Max RF output power	12
About symbols	13

# 1. System Overview

## Control of This Unit

- ① [-] button: volume down.
- ② [+] button: volume up.
- ③ [↶] button: press to switch to the Bluetooth phone menu screen.
- ④ [HOME] button: press to enter the home menu screen.
- ⑤ [AUDIO] button: press to enter the audio source or audio playback screen.
- ⑥ [POWER] button: short press to turn audio playback on/off. Long press to turn screen on/off.



- ① [POWER] button: short press to turn audio playback on/off. Long press to turn screen on/off.
- ② [+] button: volume up.
- ③ [-] button: volume down.
- ④ [HOME] button: press to enter the home menu screen.

## Steering Remote Control

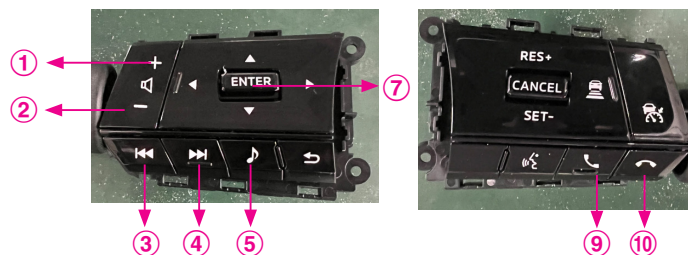

- ① [+ ] button: volume up.
- ② [- ] button: volume down.
- ③ [◀◀] button: track / folder down
- ④ [▶▶] button: track / folder up.
- ⑤ [SOURCE 🎵] button: press to return switch the audio source.(FM-->AM-->Bluetooth-->USB-->..)
- ⑥ [BACK] button: press to return to the previous screen.
- ⑦ [ENTER] button: press to enter the audio source or audio playback screen.
- ⑧ [VR] button: start Siri.
- ⑨ [📞] button: press to answer the calling.
- ⑩ [📞] button: press to hang up the calling.

## 2. Shortcut Operations

On the general screen, shortcut keys are always displayed on both sides.

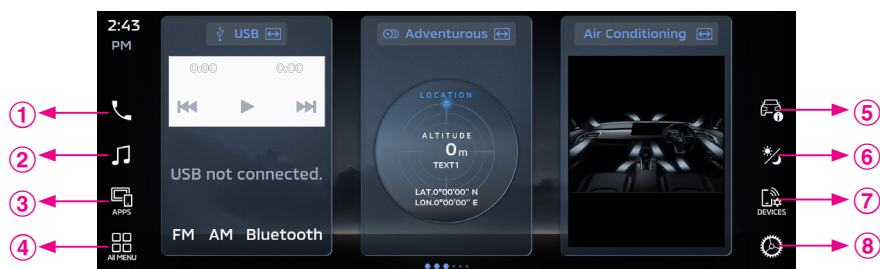

- ① Phone key: Tap to enter the Phone menu screen.
- ② Audio key: Tap to enter Audio Source screen.
- ③ APPS key: Tap to enter APPS screen.
- ④ ALL MENU key: Tap to enter All Menu screen.
- ⑤ Vehicle Info key: Tap to enter Vehicle Information screen.
- ⑥ Day/Night key: Tap to switch day night mode;
- ⑦ DEVICES key: Tap to enter device list screen.
- ⑧ Settings key: Tap to enter All Settings screen.

### 3. Home Main Menu

Press the [HOME] button on the control panel to enter the Home Main Menu screen.

The unit are total of 8 widgets can be displayed. You can choose 6 favorite widgets to display on the home screen. (There are 2 widgets for P2401.)

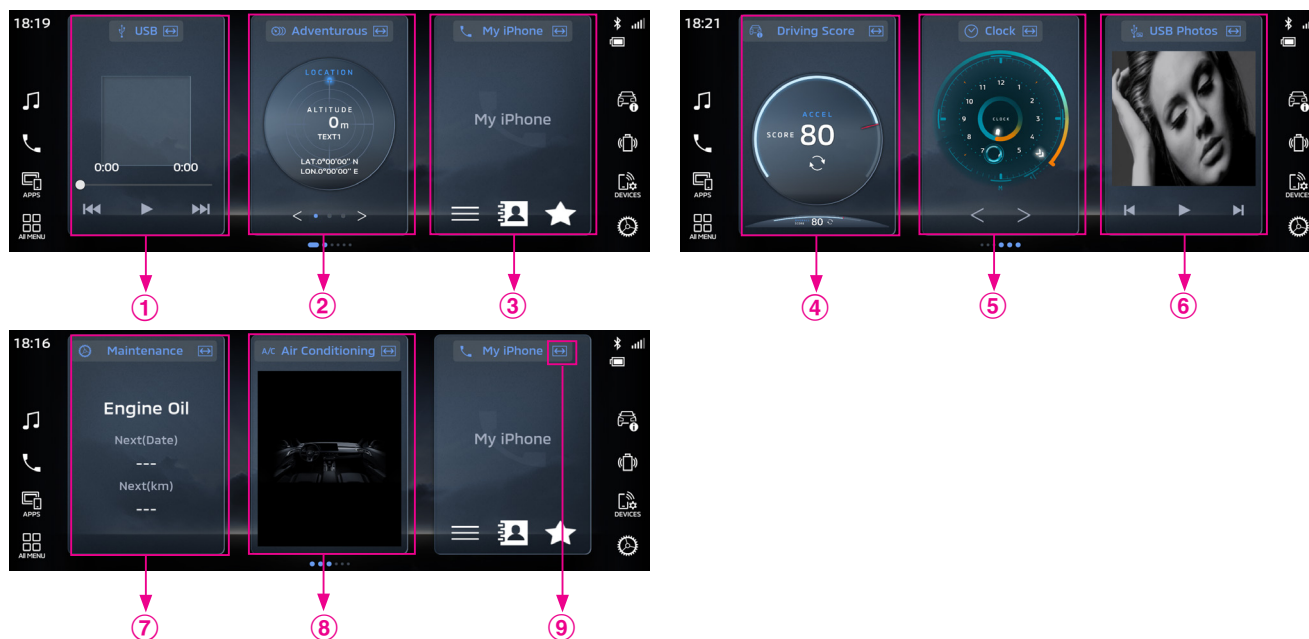

- ① The currently playing media panel including Radio, USB/iPod, BT Audio, Android Auto or Apple CarPlay.
- ② The currently Multi Mete panel including Adventurous, Responsive, Reliable, Driving Score, Customize.
- ③ The currently Phone panel.
- ④ The currently Vehicle Information panel including Avionics, Altitude, Driving Score, Fuel Economy, Eco Score, Tire Pressure.
- ⑤ The currently Clock panel.
- ⑥ The currently USB Photos Frame panel.
- ⑦ The currently Maintenance panel.
- ⑧ The currently Air Conditioning panel.
- ⑨ Tap to expand small widget to large widget and large widget to full screen.

#### Customize Home Main Menu

In the Home Main Menu screen, long touch the position under the widget title to enter the Home widget customize screen.

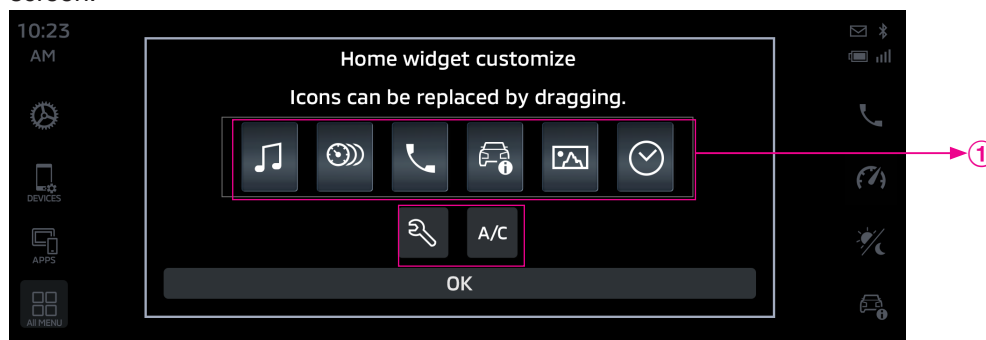

- ① widget icons

Drag an icon from the bottom area to the top area to customize the home menu.

## 4. Home Menu

Press the [ALL MENU] key on shortcut menu to enter the Home Menu screen.

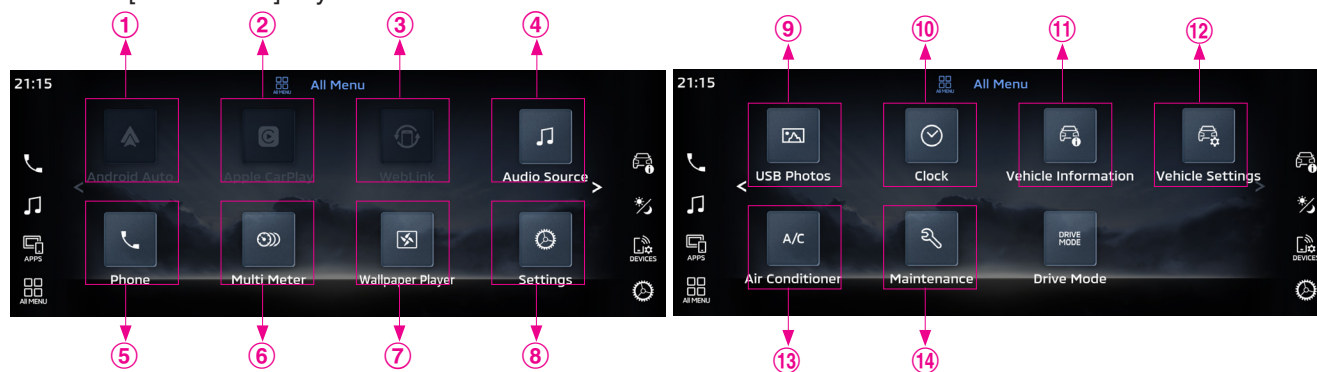

- ① Tap to enter the Android Auto Projection Screen.
- ② Tap to enter the Apple CarPlay Projection Screen.
- ③ Tap to enter the WebLink Projection Screen.
- ④ Tap to enter Audio Source screen.
- ⑤ Tap to enter the Phone menu screen.
- ⑥ Tap to enter the Multiple meter screen to view and edit Adventurous, Responsive, Reliable, Driving Score, Customize.
- ⑦ Tap to enter the Wallpaper player screen.
- ⑧ Tap to enter the Settings screen.
- ⑨ Tap to enter the USB Photo screen to view USB Photos.
- ⑩ Tap to enter the Clock screen.
- ⑪ Tap to enter the Vehicle Information screen view and edit Avionics, Altitude, Driving Score, Fuel Economy, Eco Score, Tire Pressure.
- ⑫ Tap to enter the Vehicle Settings screen.
- ⑬ Tap to enter the Air Conditioner screen.
- ⑭ Tap to enter the Maintenance screen.

## 5. Media Playback

### Switching Media Source

The supported Media Sources are FM/AM, USB/iPod, Bluetooth Audio, Android Auto (audio), Apple CarPlay (audio). There are two ways of audio sources switch.

- ① After entering Audio Source screen, you can switch the audio source.
- ② Press the custom button on the steering wheel when it is set to media source switching.

### Listening to AM/FM

Tap the [FM]/[AM] key on the Audio Source screen to enter the FM/AM playback screen.

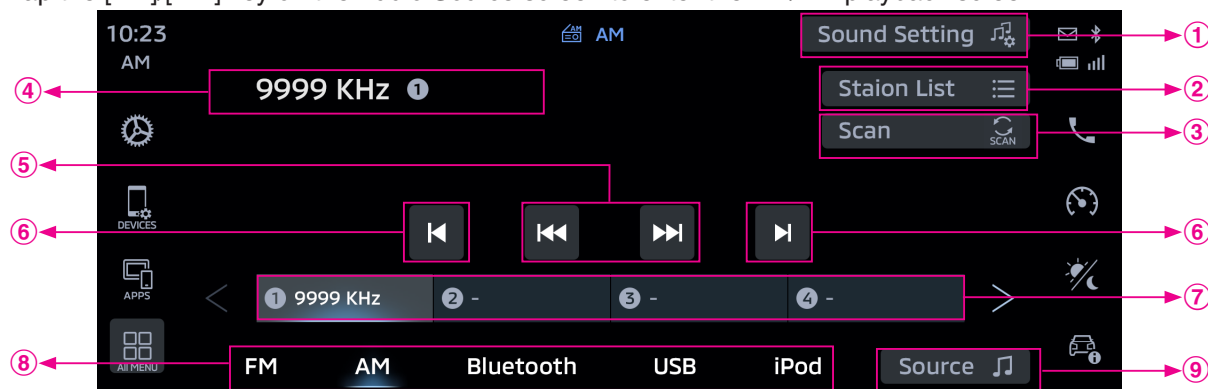

- ① Sound Setting key: Tap to enter the Sound Setting screen.
- ② Station list key: Tap to enter the Station list screen.
- ③ Scan key: Search for a station and play for 10 seconds after searching a station.
- ④ Station information display area: According to the radio station you listen to, it can display the preset station number, station frequency and stereo indication; when RBDS it can display PS name and Radio Text.
- ⑤ Tune up, down: Tap to manually tune up, down.
- ⑥ Seek up, down: Tap to automatically seek up, down.
- ⑦ Preset Channel List: Short tap each preset radio button to listen to the selected preset radio station. Long tap each preset radio button to save the current frequency to the selected preset radio station.
- ⑧ Audio Tab: Tap to switch audio sources.
- ⑨ Source key: Tap to enter Audio Source screen.

### Other Medias Playback

#### ■ Audio Playback

Switch to (USB, iPod, BT Audio) playback screen following the Media Source switching way.

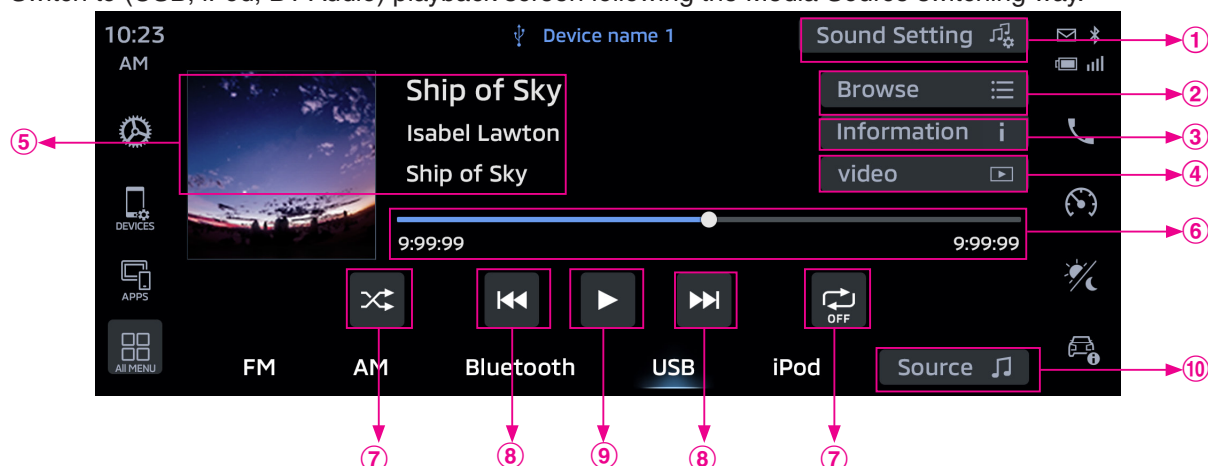

- ① Sound Setting key: Tap to enter the Sound Setting screen.
- ② Browse key: Tap to enter the Browse screen.
- ③ Information key: Tap to enter the track Information screen.
- ④ Video Key: Tap to switch to video playback screen
- ⑤ Information display area: According to the data information of the track, it displays the album artwork, title, track number/total number of tracks (USB/iPod mode), album name, artist name and album cover of the currently playing track. In Bluetooth Audio mode, the name of the currently connected Bluetooth device can be displayed.
- ⑥ Progress bar : In USB mode, you can drag the progress bar to quickly switch the current track playback position directly.



- ⑦ Play mode switch: In USB mode, Tap to switch between one track repeat, folder repeat and random playback. For modes other than USB, there are repeat and random keys available depending on the connected device.
- ⑧ Up, Down keys: Tap to skip to the previous/next song; long press to fast forward/rewind.
- ⑨ Play/Pause key
- ⑩ Source key: Tap to enter Audio Source screen.

### ■ Video Playback (USB)

Tap the screen or press function buttons, touch keys will be displayed. If no operation within 5 seconds, the touch keys will automatically hide.

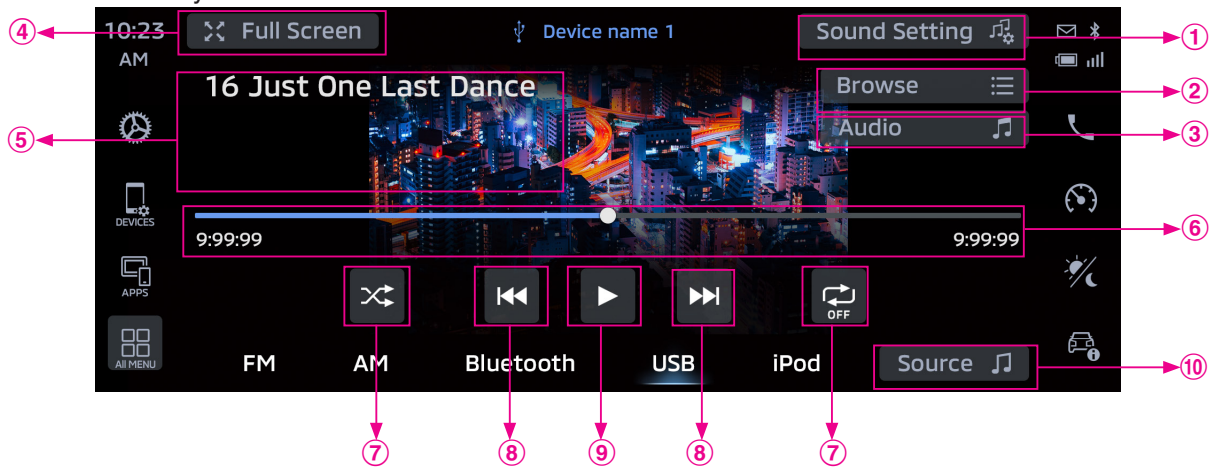

#### Attention:

When you are driving, the video can not be watched, and you can only enjoy the audio.

- ① Sound Setting key: Tap to enter the Sound Setting screen.
- ② Browse key: Tap to enter the Browse screen.
- ③ Audio Key: Tap to switch to Audio playback screen.
- ④ Full screen/original size switch: Tap to switch between Full scree and original size.
- ⑤ Information display area: Displays the information of Video Name.
- ⑥ Progress bar: Drag the progress bar to quickly switch to current video play position.
- ⑦ Play mode switching: Tap to switch between one repeat, folder repeat and random playback.
- ⑧ Up, Down key: Tap to go to previous video or next video. Tap and hold to fast-forward or fast-backward by 4 times speed. Continuously Tap the key, run the high speed (16 times) to fast-forward or fast-backward after 3 seconds.
- ⑨ Play/Pause key.
- ⑩ Source key: Tap to enter Audio Source screen.

## 6. Device Management (Bluetooth, Apple CarPlay, Android Auto)

### About Device Management and Connection

You can connect to Bluetooth, Apple CarPlay and Android Auto.

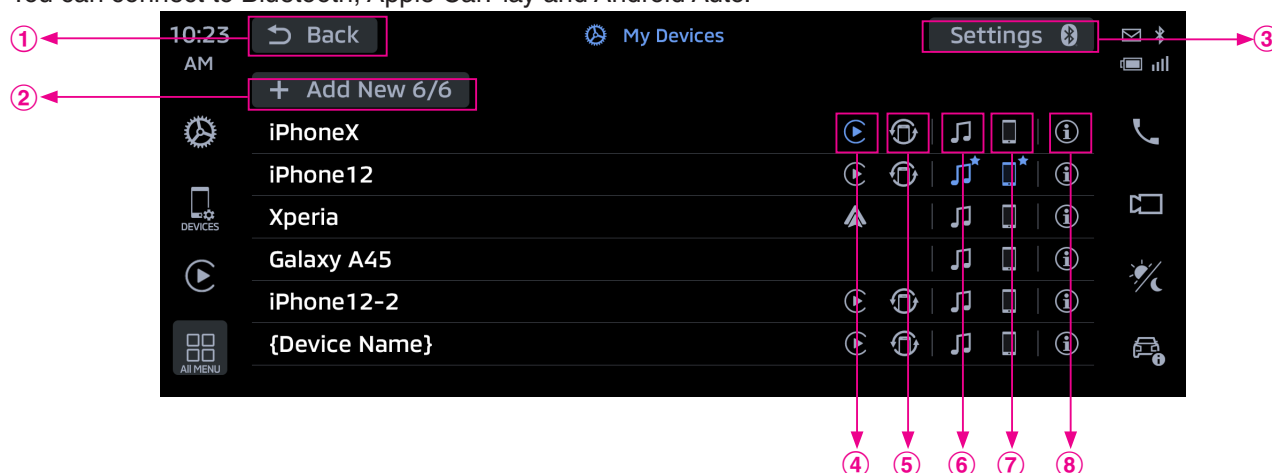

- ① Return to previous screen.
- ② Tap to enter the Bluetooth pairing screen, you can connect to Bluetooth, Apple CarPlay or Android Auto.
- ③ Tap to enter the Bluetooth Settings screen to turn Bluetooth on or off, edit your favorite items, Device Name and PIN code etc.
- ④ CP/AA Icon
- ⑤ WebLink Icon
- ⑥ AVP Icon
- ⑦ HFP Icon
- ⑧ Info Icon

### Using Bluetooth

#### ■ Device Connection

- ① Tap **[Add New]** on the device management screen to display the Bluetooth pairing prompt.
- ② Turn on Bluetooth from the Bluetooth settings menu of your Bluetooth device and select this unit to pairing. For mobile phones that need to enter a PIN code, please enter "0000".
- ③ Confirm that the same PIN code is displayed on your Bluetooth device and then confirm pairing. If "Call History Sync" is set to on, this unit will require to synchronize the call history of the mobile phone when paired.
- ④ After the pairing is successful, tap the back key to return to the device list screen, and the paired devices will be displayed on the list.

#### ■ Bluetooth Phone

In shortcut menu, tap Phone key to enter phone menu screen, when mobile phone is connected, you can check the Favorites, Recents, Contacts, Keypad, Message, Phone Settings and so on.

## ■ During Calling

The calling screen is displayed as follows, which can display the current Bluetooth device name, call time, name of the other party (if there is a saved contact name), phone number type icon, and phone number. Call volume can be adjusted with steering wheel volume button or shuttle knob on central control panel.

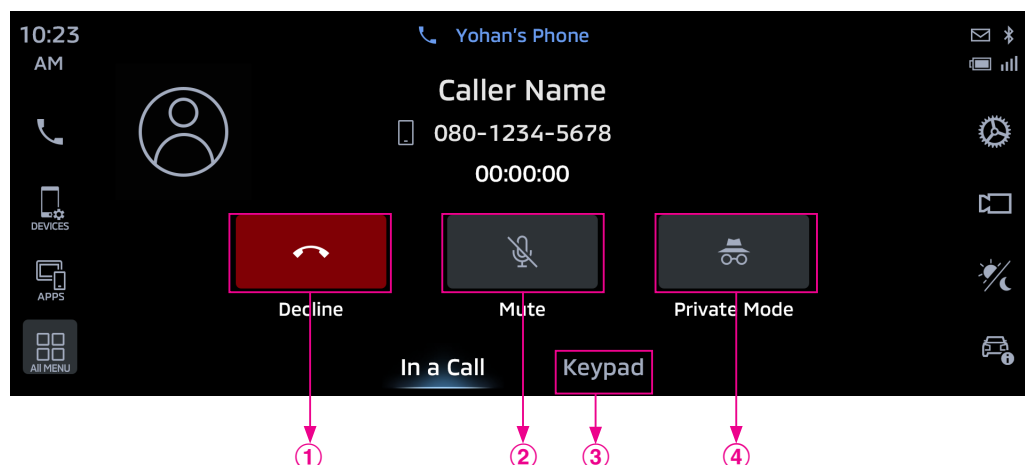

- ① Tap to end the current calling.
- ② Tap to mute the microphone sound and turn off the sound output.
- ③ Tap to switch to private conversation mode, the voice of the other calling party is not transmitted by speaker.
- ④ Tap to open dial pad.

## Using Apple CarPlay

### ■ Using Apple CarPlay

Using Apple CarPlay, you can use some functions of iPhone such as map navigation, dialing and answering phone call, send or receive message, music play or voice function.

### ■ Preparation on iPhone before Connecting

- ① Make sure that Siri is on.
- ② If your iPhone isn't detected by Apple CarPlay, make sure that Apple CarPlay isn't restricted. Go to Settings > Screen Time > Content & Privacy Restrictions, Tap Allowed Apps and make sure that Apple CarPlay is enabled.

### ■ Connection

You can use Apple CarPlay by wired or wireless connection.

- Wired connection

Connect your iPhone to the USB interface by the data cable supplied with your iPhone.

## Using Android Auto

### ■ Using Android Auto

Using Android Auto, some functions of Android smartphone can be used, such as map navigation, dialing and connecting phone call, send or receive short message, music play or voice function.

- Compatible models: Android smartphone
- Compatible OS: Android OS 5.0 above
- Compatible Bluetooth protocol: HFP (Hands-Free Profile)

### ■ Preparation on the Android smartphone before connecting

Use your Android smartphone to download and install the Android Auto application from the Google Play store.

### ■ Connection

Android Auto can be used through wired or wireless connection.

-Wired connection: Connect this Android smartphone to the USB interface of this machine through the data cable it is equipped with.

## 7. Settings System

Tap the [**Settings**] key of the right shortcut menu to enter the Settings screen.

Page 1

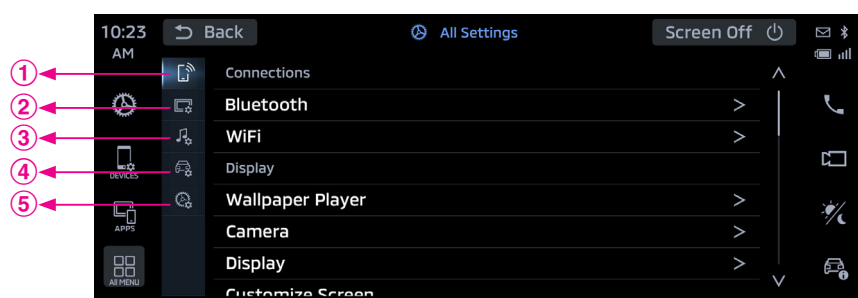

- ① Connections key - Tap to display the item of Connections on the top line.
- ② Display key - Tap to display the item of Display on the top line.
- ③ Audio key - Tap to display the item of Audio on the top line.
- ④ Vehicle key - Tap to display the item of Vehicle on the top line.
- ⑤ System key - Tap to display the item of System on the top line.

Page 2

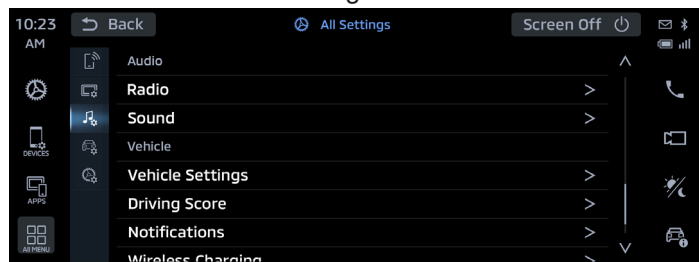

Page 3

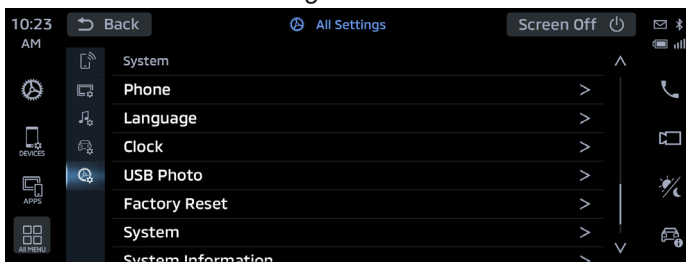

Note:

The keys are different depending on the vehicle configuration.

- ① Tap [**Bluetooth**] to enter the device management screen to perform operations such as Bluetooth pairing, Android Auto connection, and Apple CarPlay connection.
- ② Tap [**WiFi**] to enter the user network connection setting status display and refresh the WiFi screen.
- ③ Tap [**Wallpaper Player**] to enter the Wallpaper browse and Adjust screen.
- ④ Tap [**Camera**] to enter the Camera setting screen.
- ⑤ Tap [**Display**] to enter the Display setting screen.
- ⑥ Tap [**Customize Screen**] to enter the Customize Screen setting screen, you can set the customize of Home Screen, Launcher, Audio Screen Footer, Phone Screen Footer, Vehicle Information Screen Footer, Multi Meter Screen Footer.
- ⑦ Tap [**Radio**] to enter the Radio Settings screen.
- ⑧ Tap [**Sound**] to enter the Sound screen to adjust various sound levels.
- ⑨ Tap [**Vehicle Settings**] to enter the Vehicle Settings screen. You can set the Keyless Operation System, Wipers, Exterior Lights/Interior Lights, Theft Alarm, Turn Signal, Power Door Locks ect.
- ⑩ Tap [**Notifications**] to enter the Notifications settings screen. You can set the Air Conditioner and Driving Mode.
- ⑪ Tap [Phone] to enter the Phone settings screen. You can adjust the phone volume and Speech Quality Control. You can also edit Favorites, Contacts, Message.
- ⑫ Tap [Language] to enter the Select Language screen.
- ⑬ Tap [Clock] to enter the clock setting screen.
- ⑭ Tap [USB Photo] to enter the USB Photo screen. You can set the photo wallpaper and browse the Gallery.
- ⑮ Tap [Factory Reset] to restore the unit to factory settings.
- ⑯ Tap [System] to enter the System settings screen. You can set the System Volume and Source Volume.
- ⑰ Tap [System Information] to enter the System Information screen. You can view the software Information and license Information.

## 8. Specifications

### Declaration of conformity

Warning: Changes or modifications to this unit not expressly approved by the party responsible for compliance could void the user's authority to operate the equipment.

NOTE: This equipment has been tested and found to comply with the limits for a Class B digital device, pursuant to Part 15 of the FCC Rules. These limits are designed to provide reasonable protection against harmful interference in a residential installation. This equipment generates, uses and can radiate radio frequency energy and, if not installed and used in accordance with the instructions, may cause harmful interference to radio communications. However, there is no guarantee that interference will not occur in a particular installation. If this equipment does cause harmful interference to radio or television reception, which can be determined by turning the equipment off and on, the user is encouraged to try to correct the interference by one or more of the following measures:

- Reorient or relocate the receiving antenna.
- Increase the separation between the equipment and receiver.
- Connect the equipment into an outlet on a circuit different from that to which the receiver is connected.
- Consult the dealer or an experienced radio/ TV technician for help.

RF warning for Mobile device:

This equipment complies with FCC radiation exposure limits set forth for an uncontrolled environment. This equipment should be installed and operated with minimum distance 20cm between the radiator & your body.

This device complies with Part 15 of the FCC Rules. Operation is subject to the following two conditions: (1) this device may not cause harmful interference, and (2) this device must accept any interference received, including interference that may cause undesired operation.

Shielded cables must be used with this unit to ensure compliance with the Class B FCC limits.

The ventilation should not be impeded by covering the ventilation openings with items, such as newspapers, tablecloths, curtains, etc.;

Hereby, Faurecia Clarion declares that this [P2401/P2402] is in compliance with the essential requirements and other relevant provisions of Directive 2014/53/EU.

The full test of the EU declaration of conformity is available at the following internet address: <https://www.clarion.com/xe/en/product-compliance/mmc/re-doc/index.html>



**RECYCLING:** This product bears the selective sorting symbol for Waste electrical and electronic equipment (WEEE). This means that this product must be handled pursuant to European directive 2012/19/EU in order to be recycled or dismantled to minimize its impact on the environment.

This product max. operating ambient temperature is 45 degree C.

### Operation radio frequency

Reception frequency AM: 526.5 ~ 1606.5 KHz STEP:( 9 )KHz

Reception frequency FM: 87.5 ~ 108 MHz STEP:( 50)KHz

Reception frequency DAB: 174 ~ 240 MHz

### Operation frequency

Bluetooth: 2402 MHz to 2480 MHz

### Max RF output power

EIRP(MAX):1.65dBm

GPS: 1575.42 MHz±1.023 MHz

GLONASS: 1602 MHz + n × 0.5625 MHz

## About symbols

	SNI logo of Indonesia (safety)
	TRA logo of Oman
	NTC logo of Philippine
	Vietnam certification logo
	DC voltage
	CE logo
	CONATEL logo of Paraguay
	ARPCE logo of Congo
	IFETEL logo of Mexico
<p>เครื่องวิทยุคมนาคมนี้ ได้รับยกเว้น ไม่ต้องได้รับ ใบอนุญาตให้มี ใช้ซึ่งเครื่องวิทยุคมนาคม หรือตั้งสถานีวิทยุคมนาคมตามประกาศ กสทช. เรื่อง เครื่องวิทยุคมนาคม และสถานีวิทยุ คมนาคมที่ได้รับยกเว้นไม่ต้องได้รับใบอนุญาต วิทยุคมนาคม ตามพระราชบัญญัติวิทยุ คมนาคม พ.ศ. 2498</p>	Thailand NBTC logo